

\* Please note that  
report # 694 has  
detailed information  
concerning these  
Tsable River holes.

000 49

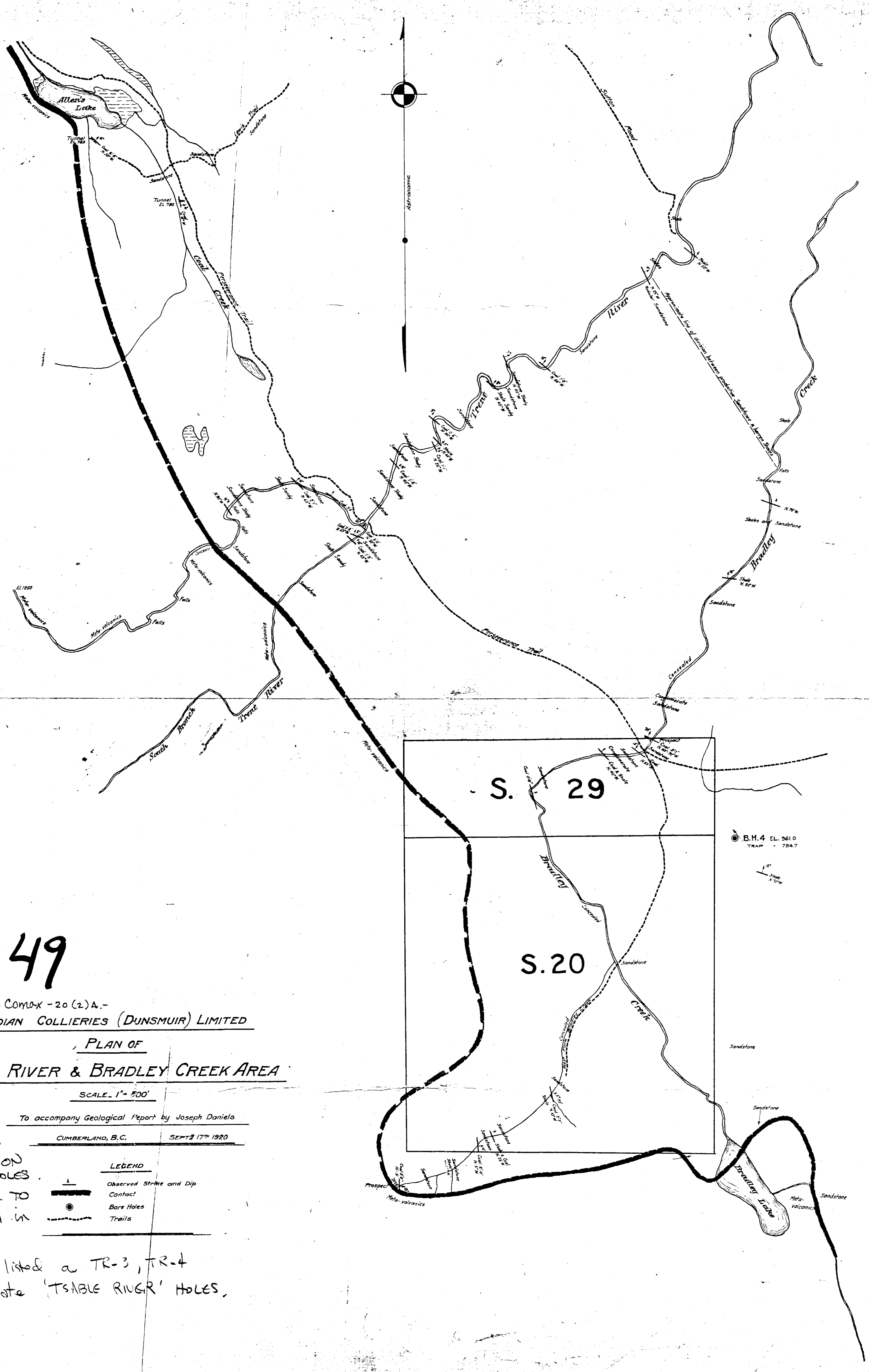

49

\*NOTE

-CX-COMOX-20(2)A-  
CANADIAN COLLIERIES (DUNSMUIR) LIMITED

PLAN OF  
TRENT RIVER & BRADLEY CREEK AREA

SCALE - 1" = 500'

To accompany Geological Report by Joseph Daniels

CUMBERLAND, B.C. SEPT 17<sup>th</sup> 1920

LEGEND	
	Observed Strike and Dip
	Contact
	Bore Holes
	Trails

FOR COMPLETE INFORMATION ON THESE BOREHOLES PLEASE REFER TO REPORT # 694 in

COALFIE  
These are listed as TR-3, TR-4 to indicate 'TSABLE RIVER' HOLES.

49  
MI

PERSEVERANCE  
CLAIM  
C.C.D. LTD.

CX-COMOX-20(2)A.  
CANADIAN COLLIERIES (DUNSMUIR) LTD.  
PLAN OF  
TSABLE RIVER DISTRICT

49

To accompany Geological Report by Joseph Daniels

SCALE 1" = 800'

CUMBERLAND, B.C. AUGUST 28<sup>th</sup> 1920

- LEGEND
- Observed strike and dip
  - Contact
  - Structure line of fault
  - Structure line showing general strike of lower seam at 500 ft contour
  - Rock bored
  - Proposed bore holes

FOR COMPLETE INFORMATION ON THESE BOREHOLES - PLEASE REFER TO REPORT NO. 694 in COALFIELD. These are listed as 'TRI-TRE' etc. to indicate 'TSABLE RIVER HOLES'



N E L S O N  
N E W C A S T L E

D I S T R I C T  
D I S T R I C T

49  
M2