

TK-COAL CREEK 29(2)A

COAL CREEK COAL PROPERTY

00 221

F. B. CHETTERBURGH

NOV. 1929

1. Volcanic.
  - A1. Fine grained Porphyry, either intensive or extensive.
  - A2. Aplite, appears to be a light colored granite rock, either a small dyke or margin of a larger body.
  - A.5 Appears to be a contact rock such as one finds on a granite contact and may be either sedimentary or igneous.
  - G. Appears to be a volcanic.
  3. Indeterminate. Looks like A2.
  4. Looks like a baked argillaceous rock from near a granite contact.
  5. Appears to be a volcanic.
  - C. Indeterminate. Looks as if it might be a contact phase of A1.
  6. Indeterminate, suggests volcanic origin.
-

# The Yorkshire & Canadian Trust, Limited

Head Office, Huddersfield, England

NATIONAL FINANCE COMPANY LIMITED IN LIQUIDATION

Yorkshire Building

525 Seymour Street

Vancouver, Canada

Cable Address  
Yorkshire Vancouver  
H. W. Dyson  
President  
F. H. Wright  
Vice President

6th December, 1929.

F. B. Chettleburgh, Esq.,  
Telkwa, B. C.

Dear Sir:

Re: Rock Samples

I attach hereto a list of the determination of rock samples as made by the Geological Survey. Their comment in regard to these was that the samples should be somewhat larger, say 2" x 3" x 1"

Yours faithfully,



Accountant

WFO/TF

Enc.



221

TK-TELKWA 29(2)A.

MAP.

PLAN OF WORKINGS

00 221

-1929-

GEOLOGICAL BRANCH  
ASSESSMENT REPORT

00 221

221a

Technical Column

1979

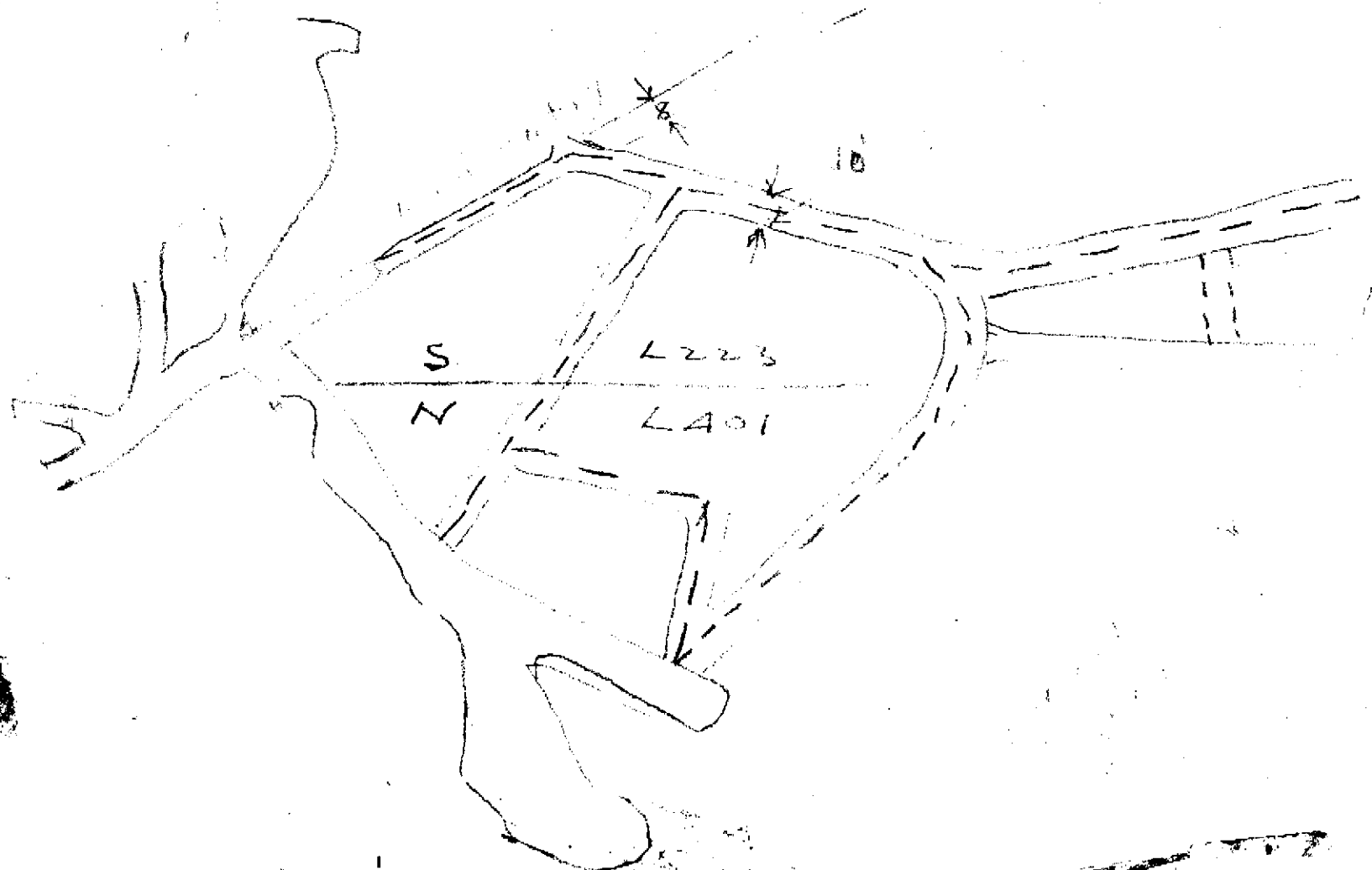

Scale ... 4 INCHES = 1 MILE

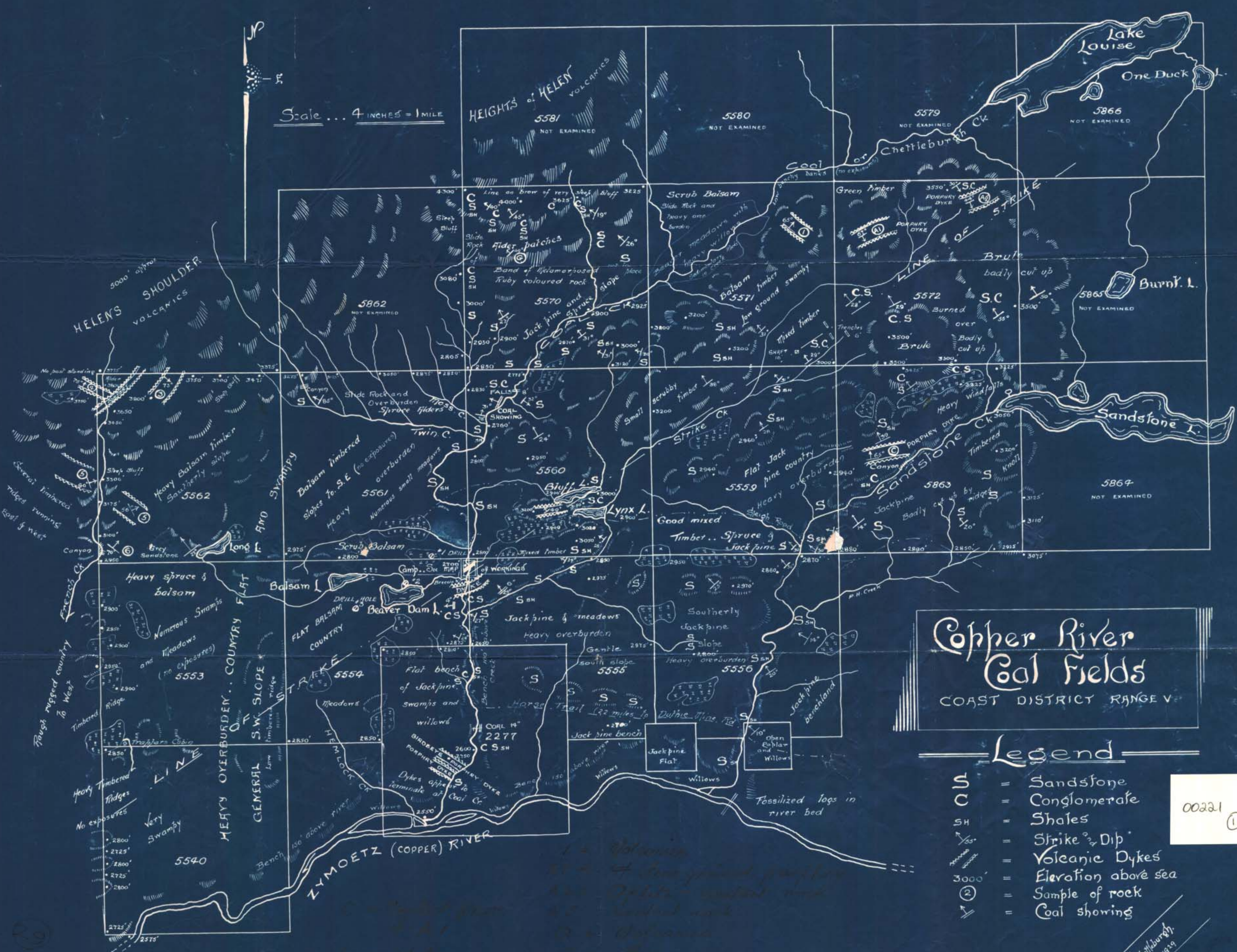

# Copper River Coal Fields

COAST DISTRICT RANGE V

- ## Legend
- S = Sandstone
  - CS = Conglomerate
  - SH = Shales
  - ↘ 35° = Strike & Dip
  - ||||| = Volcanic Dykes
  - 3000' = Elevation above sea
  - ⊙ = Sample of rock
  - ↖ = Coal showing

00221 ①

F.B. Charlton & Co.  
Nov. 1929