

00239

Maps #19-33

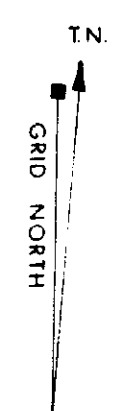
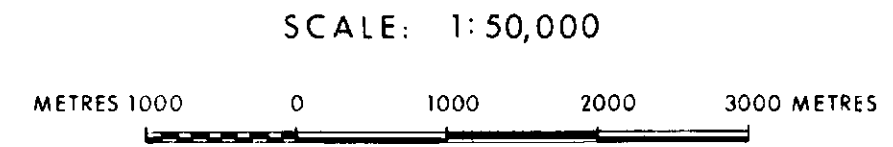
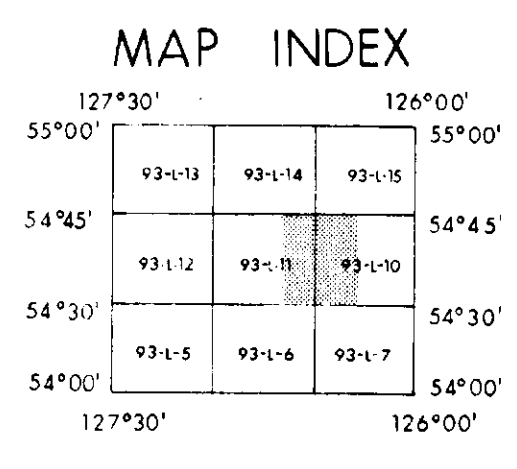
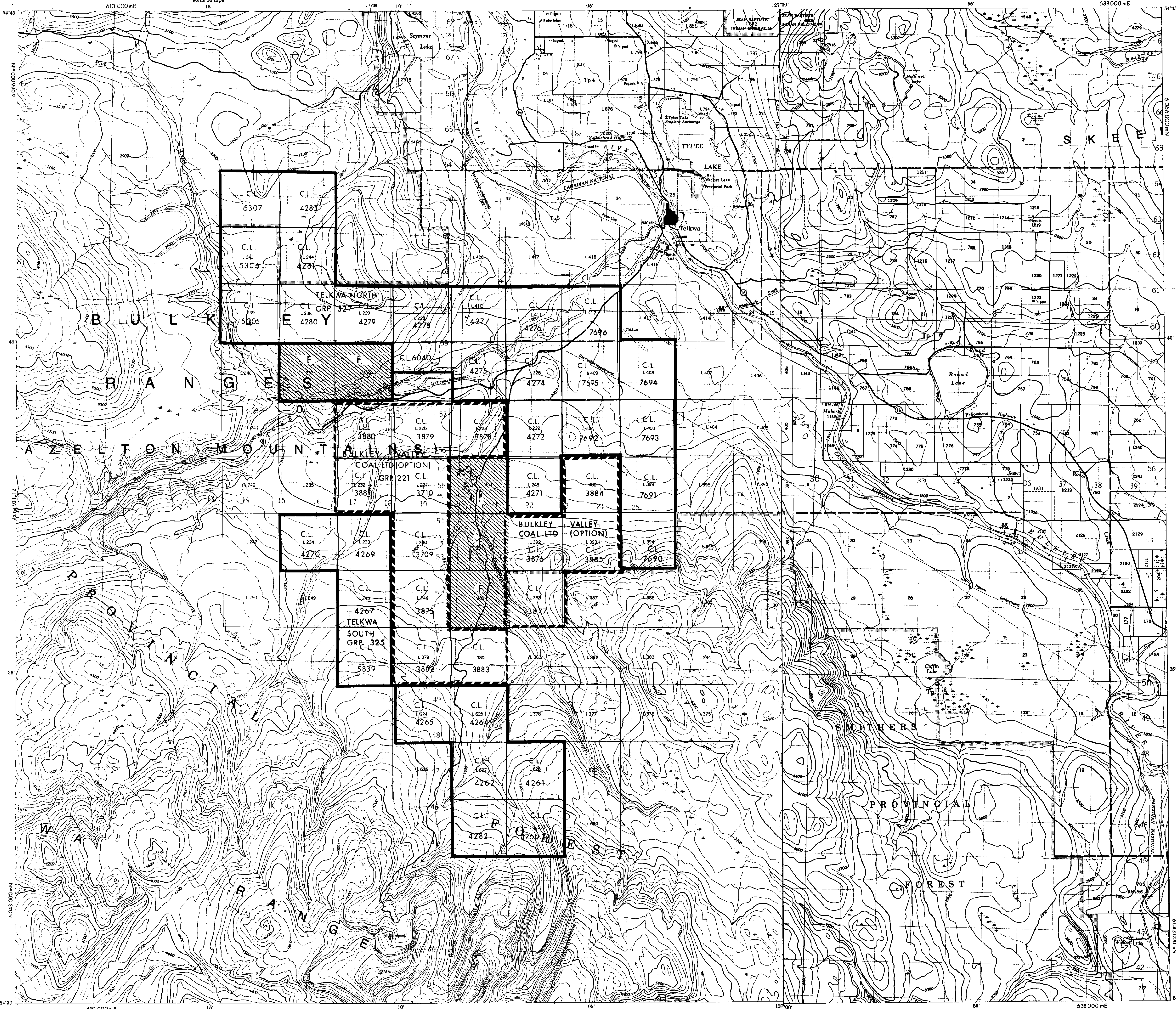

JK-TELKWA 93(2)A(4)

Crows Nest Resources Limited
EXPLORATION
WEST CENTRAL B.C.
TELKWA PROJECT

COAL LAND DISPOSITION MAP

SHELL - CNRL LICENCES TELKWA 93-L-11,10

APPENDIX 1 UTM Zone 9

AUTHOR: CNRL	SCALE: 1:50,000	ENCLOSURE No.
DATE: 82-12	REVISED: 83-10	DRAWING No. TW5H5
To: Acquire		

239

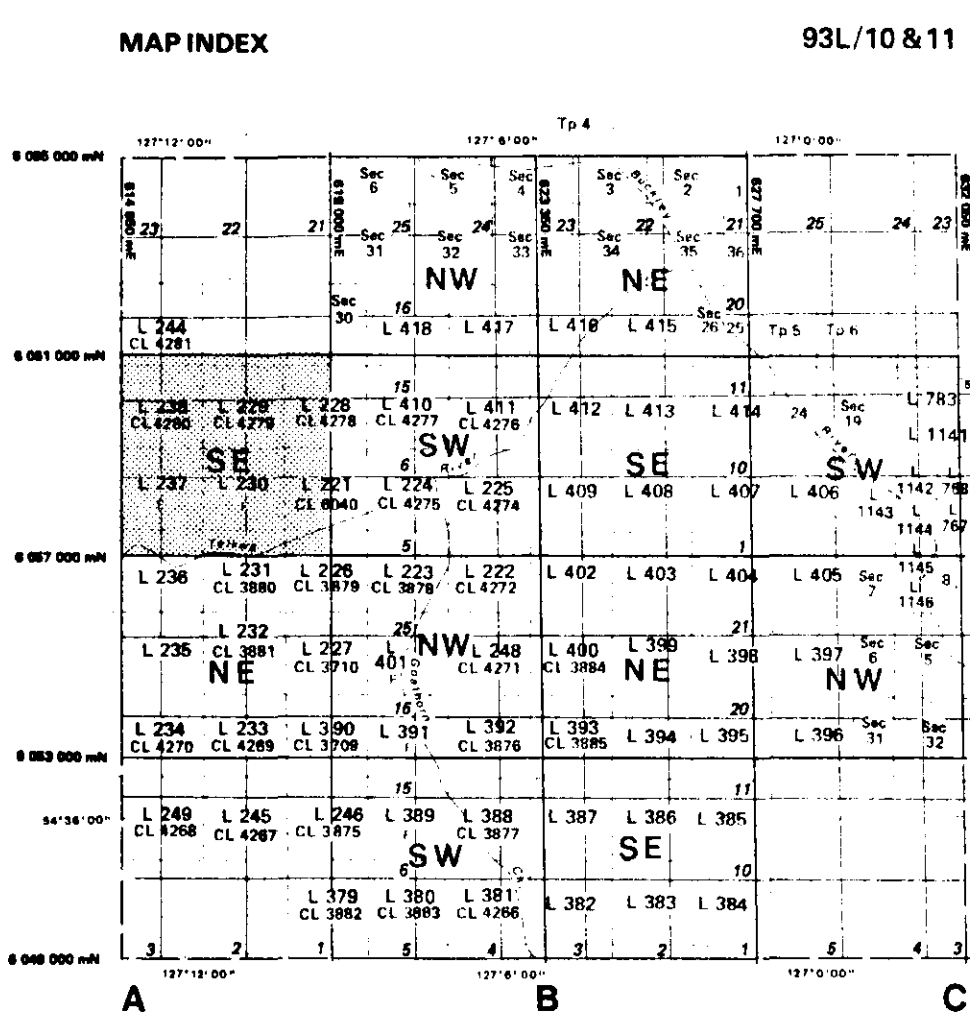

o	NAIL
x	20cm SPIKE
□	TRENCH
⬡	DRILL HOLE
⬢	CONTROL POINT OF NETWORK (GOV.)
●	IRON POST
⬢	1982 PHOTO TARGET OR PHOTO I.D. POINT MARKED WITH IRON POST
⬢	COMPASS TRAVERSE POINT

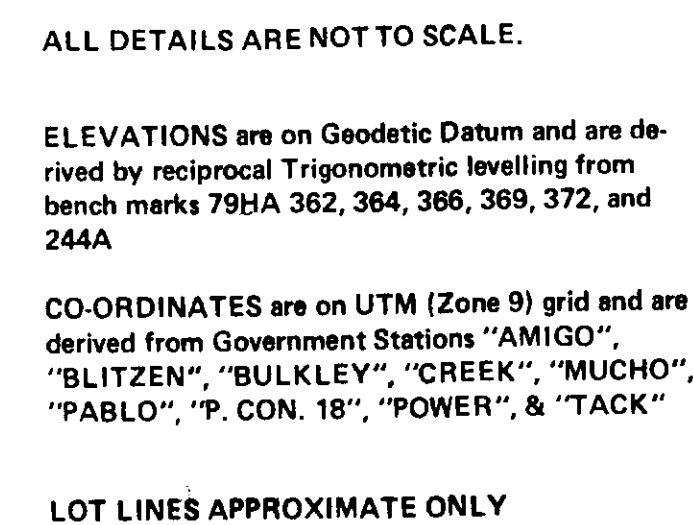

1K. 1 SURVEY 83/6A 239

 **Cross Nest Resources Limited**
 E X P L O R A T I O N

WEST CENTRAL, B.C.
 TELKWA

✓ TRAVERSE SURVEY MAP (20)

SHEET No. A2 SE
 U.T.M. ZONE 9

N.T.S. 93L/11	AUTHOR: WATSON	B.C.L.S.	SCALE: 1:5 000	DRAWN BY:
DATE: 82-11-22	To Accompany		REVISED:	DRAWING No. TW2V1

[illegible]

REFERENCE STATION							
TATION	DESCRIPTION	BEARING	GRID		STATION		
			DISTANCE	EASTING	NORTHING	EASTING	
2842	20m Spot						
	20m Spot	156.20 N	4.256	875.11	875.1	6,080,060.2	422,081.2
	20m Spot			877.21		6,080,078.9	422,035.9
	20m Spot						
	20m Spot						
2829	20m Spot						
	20m Spot	28.08 S	6.565	825.13	824.8	6,053,137.7	417,328.8
	20m Spot	284.36 S	69.33	375.64	824.1	6,053,142.1	417,325.9
	20m Spot	281.30 N	24.21	829.47		6,053,154.2	417,331.7
	20m Spot	281.20 N	24.23	829.47	235.5	6,053,166.2	417,336.46
2827	20m Spot						
	20m Spot	164.53 S	78.421	829.47		6,053,083.06	417,841.63
	20m Spot	284.33 S	8.236	862.97	861.8	6,053,085.23	417,633.16
	20m Spot	284.33 S				6,053,094.32	417,641.67
	20m Spot	284.32 S	85.472	228.16	861.2	6,053,115.32	417,873.18
2823	20m Spot						
	20m Spot	19.30 S	30.41	869.16	869.1	6,053,115.11	422,056.00
	20m Spot	284.33 S	75.241	870.47	869.4	6,053,114.44	422,057.84
	20m Spot	284.33 S	75.241	868.50	867.5	6,053,115.11	422,059.17

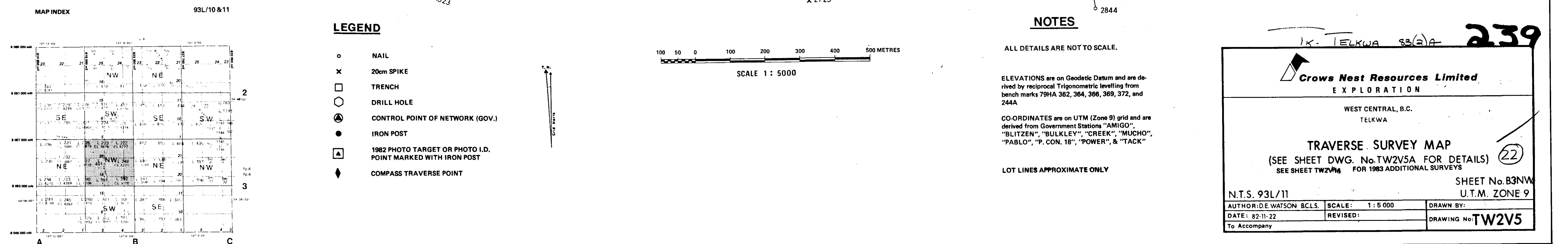

LOT LINES APPROXIMATE ONLY

1K TELKWA SS(2)A 239

 **Crows Nest Resources Limited**
E X P L O R A T I O N

WEST CENTRAL, B.C.
TELKWA

TRAVERSE SURVEY MAP (22)

(SEE SHEET DWG. No.TW2V5A FOR DETAILS)
SEE SHEET TW2V6 FOR 1983 ADDITIONAL SURVEYS

N.T.S. 93L/11

SHEET No. 83NW
U.T.M. ZONE 9

AUTHOR: D.E. WATSON B.C.L.S.	SCALE: 1:5 000	DRAWN BY:
DATE: 82-11-22	REVISED:	DRAWING No. TW2V5
To Accompany		

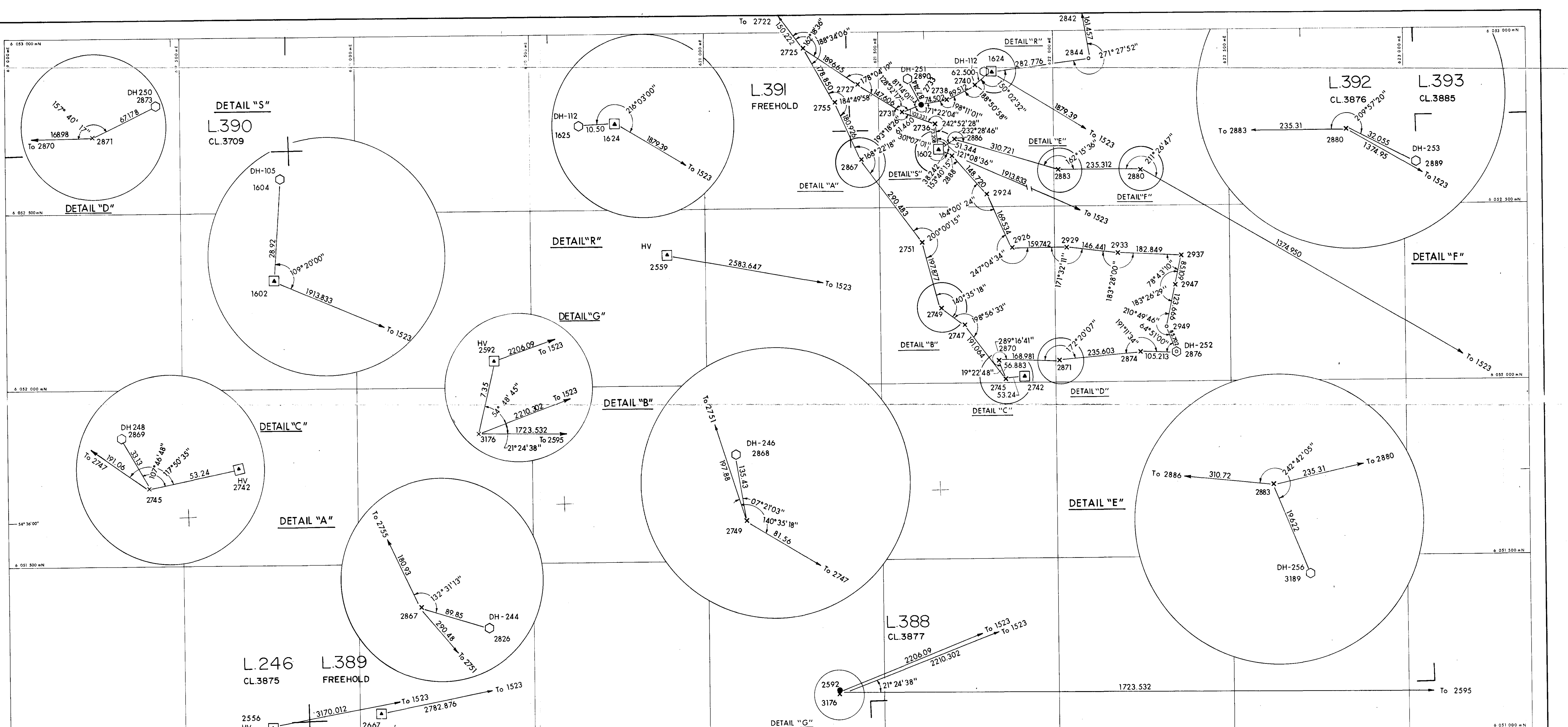

SURVEY TRAVERSE STATIONS				
STATION	DESCRIPTION	NORTHING	EASTING	GROUND ELEVATION
2595	75cm IP and Target	6051106.67	623092.53	861.80
2596	8cm Nail	6051121.11	623100.08	863.66
2597	75cm IP and Target	6051128.24	623170.86	862.50
2598	75cm IP and Target	6051345.39	620314.32	854.97
2599	75cm IP and Target	6051381.43	620701.44	858.12
2600	20cm Spike	6052958.07	621285.03	818.7
2601	20cm Spike	6052848.88	621441.57	840.76
2602	20cm Spike	6052769.78	621558.13	858.7
2603	20cm Spike	6052735.00	621663.75	864.84
2604	75cm IP and Target	6052663.40	621673.91	858.70
2605	20cm Spike	6052642.25	621675.84	860.34
2606	20cm Spike	6052633.37	621715.59	870.22
2607	20cm Spike	6052603.78	621733.12	870.3
2608	20cm Spike	6052584.50	621733.12	869.94
2609	20cm Spike	6052562.25	621733.12	869.94
2610	20cm Spike	6052535.30	621706.69	863.89
2611	20cm Spike	6052518.05	621706.69	863.89
2612	20cm Spike	6052485.51	621635.74	883.12
2613	20cm Spike	6052474.42	622342.08	898.2
2614	20cm Spike	6052453.52	622371.98	893.94
2615	20cm Spike	6052437.19	622366.72	896.09
2616	20cm Spike	6052422.98	622342.08	898.2
2617	20cm Spike	6052408.85	622007.53	864.28
2618	20cm Spike	6052388.16	622070.54	860.74
2619	20cm Spike	6052368.85	621838.66	856.36
2620	20cm Spike	6052353.30	621838.66	856.36
2621	20cm Spike	6052337.15	621838.66	856.36
2622	20cm Spike	6052321.09	621838.66	856.36
2623	20cm Spike	6052305.03	621838.66	856.36
2624	20cm Spike	6052288.97	621838.66	856.36
2625	20cm Spike	6052272.91	621838.66	856.36
2626	20cm Spike	6052256.85	621838.66	856.36
2627	20cm Spike	6052240.79	621838.66	856.36
2628	20cm Spike	6052224.73	621838.66	856.36
2629	20cm Spike	6052208.67	621838.66	856.36
2630	20cm Spike	6052192.61	621838.66	856.36
2631	20cm Spike	6052176.55	621838.66	856.36
2632	20cm Spike	6052160.49	621838.66	856.36
2633	20cm Spike	6052144.43	621838.66	856.36
2634	20cm Spike	6052128.37	621838.66	856.36
2635	20cm Spike	6052112.31	621838.66	856.36
2636	20cm Spike	6052096.25	621838.66	856.36
2637	20cm Spike	6052080.19	621838.66	856.36
2638	20cm Spike	6052064.13	621838.66	856.36
2639	20cm Spike	6052048.07	621838.66	856.36
2640	20cm Spike	6052032.01	621838.66	856.36
2641	20cm Spike	6052015.95	621838.66	856.36
2642	20cm Spike	6052000.00	621838.66	856.36
2643	20cm Spike	6051984.04	621838.66	856.36
2644	20cm Spike	6051968.08	621838.66	856.36
2645	20cm Spike	6051952.02	621838.66	856.36
2646	20cm Spike	6051936.06	621838.66	856.36
2647	20cm Spike	6051920.00	621838.66	856.36
2648	20cm Spike	6051904.04	621838.66	856.36
2649	20cm Spike	6051888.08	621838.66	856.36
2650	20cm Spike	6051872.02	621838.66	856.36
2651	20cm Spike	6051856.06	621838.66	856.36
2652	20cm Spike	6051840.00	621838.66	856.36
2653	20cm Spike	6051824.04	621838.66	856.36
2654	20cm Spike	6051808.08	621838.66	856.36
2655	20cm Spike	6051792.02	621838.66	856.36
2656	20cm Spike	6051776.06	621838.66	856.36
2657	20cm Spike	6051760.00	621838.66	856.36
2658	20cm Spike	6051744.04	621838.66	856.36
2659	20cm Spike	6051728.08	621838.66	856.36
2660	20cm Spike	6051712.02	621838.66	856.36
2661	20cm Spike	6051696.06	621838.66	856.36
2662	20cm Spike	6051680.00	621838.66	856.36
2663	20cm Spike	6051664.04	621838.66	856.36
2664	20cm Spike	6051648.08	621838.66	856.36
2665	20cm Spike	6051632.02	621838.66	856.36
2666	20cm Spike	6051616.06	621838.66	856.36
2667	20cm Spike	6051600.00	621838.66	856.36
2668	20cm Spike	6051584.04	621838.66	856.36
2669	20cm Spike	6051568.08	621838.66	856.36
2670	20cm Spike	6051552.02	621838.66	856.36
2671	20cm Spike	6051536.06	621838.66	856.36
2672	20cm Spike	6051520.00	621838.66	856.36
2673	20cm Spike	6051504.04	621838.66	856.36
2674	20cm Spike	6051488.08	621838.66	856.36
2675	20cm Spike	6051472.02	621838.66	856.36
2676	20cm Spike	6051456.06	621838.66	856.36
2677	20cm Spike	6051440.00	621838.66	856.36
2678	20cm Spike	6051424.04	621838.66	856.36
2679	20cm Spike	6051408.08	621838.66	856.36
2680	20cm Spike	6051392.02	621838.66	856.36
2681	20cm Spike	6051376.06	621838.66	856.36
2682	20cm Spike	6051360.00	621838.66	856.36
2683	20cm Spike	6051344.04	621838.66	856.36
2684	20cm Spike	6051328.08	621838.66	856.36
2685	20cm Spike	6051312.02	621838.66	856.36
2686	20cm Spike	6051296.06	621838.66	856.36
2687	20cm Spike	6051280.00	621838.66	856.36
2688	20cm Spike	6051264.04	621838.66	856.36
2689	20cm Spike	6051248.08	621838.66	856.36
2690	20cm Spike	6051232.02	621838.66	856.36
2691	20cm Spike	6051216.06	621838.66	856.36
2692	20cm Spike	6051200.00	621838.66	856.36
2693	20cm Spike	6051184.04	621838.66	856.36
2694	20cm Spike	6051168.08	621838.66	856.36
2695	20cm Spike	6051152.02	621838.66	856.36
2696	20cm Spike	6051136.06	621838.66	856.36
2697	20cm Spike	6051120.00	621838.66	856.36
2698	20cm Spike	6051104.04	621838.66	856.36
2699	20cm Spike	6051088.08	621838.66	856.36
2700	20cm Spike	6051072.02	621838.66	856.36
2701	20cm Spike	6051056.06	621838.66	856.36
2702	20cm Spike	6051040.00	621838.66	856.36
2703	20cm Spike	6051024.04	621838.66	856.36
2704	20cm Spike	6051008.08	621838.66	856.36
2705	20cm Spike	6050992.02	621838.66	856.36
2706	20cm Spike	6050976.06	621838.66	856.36
2707	20cm Spike	6050960.00	621838.66	856.36
2708	20cm Spike	6050944.04	621838.66	856.36
2709	20cm Spike	6050928.08	621838.66	856.36
2710	20cm Spike	6050912.02	621838.66	856.36
2711	20cm Spike	6050896.06	621838.66	856.36
2712	20cm Spike	6050880.00	621838.66	856.36
2713	20cm Spike	6050864.04	621838.66	856.36
2714	20cm Spike	6050848.08	621838.66	856.36
2715	20cm Spike	6050832.02	621838.66	856.36
2716	20cm Spike	6050816.06	621838.66	856.36
2717	20cm Spike	6050800.00	621838.66	856.36
2718	20cm Spike	6050784.04	621838.66	856.36
2719	20cm Spike	6050768.08	621838.66	856.36
2720	20cm Spike	6050752.02	621838.66	856.36
2721	20cm Spike	6050736.06	621838.66	856.36
2722	20cm Spike	6050720.00	621838.66	856.36
2723	20cm Spike	6050704.04	621838.66	856.36
2724	20cm Spike	6050688.08	621838.66	856.36
2725	20cm Spike	6050672.02	621838.66	856.36
2726	20cm Spike	6050656.06	621838.66	856.36
2727	20cm Spike	6050640.00	621838.66	856.36
2728	20cm Spike	6050624.04	621838.66	856.36
2729	20cm Spike	6050608.08	621838.66	856.36
2730	20cm Spike	6050592.02	621838.66	856.36
2731	20cm Spike	6050576.06	621838.66	856.36
2732	20cm Spike	6050560.00	621838.66	856.36
2733	20cm Spike	6050544.04	621838.66	856.36
2734	20cm Spike	6050528.08	621838.66	856.36
2735	20cm Spike	6050512.02	621838.66	856.36
2736	20cm Spike	6050496.06	621838.66	856.36
2737	20cm Spike	6050480.00	621838.66	856.36
2738	20cm Spike	6050464.04	621838.66	856.36
2739	20cm Spike	6050448.08	621838.66	856.36
2740	20cm Spike	6050432.02	621838.66	856.36
2741	20cm Spike	6050416.06	621838.66	856.36
2742	20cm Spike	6050400.00	621838.66	856.36
2743	20cm Spike	6050384.04	621838.66	856.36
2744	20cm Spike	6050368.08	621838.66	856.36
2745	20cm Spike	6050352.02	621838.66	856.36
2746	20cm Spike	6050336.06	621838.66	856.36
2747	20cm Spike	6050320.00	621838.66	856.36
2748	20cm Spike	6050304.04	621838.66	856.36
2749	20cm Spike	6050288.08	621838.66	856.36
2750	20cm Spike	6050272.02	621838.66	856.36
2751	20cm Spike	6050256.06	621838.66	856.36
2752	20cm Spike	6050240.00	621838.66	856.36
2753	20cm Spike	6050224.04	621838.66	856.36
2754	20cm Spike	6050208.08	621838.66	856.36
2755	20cm Spike	6050192.02	621838.66	856.36
2756	20cm Spike	6050176.06	621838.66	856.36
2757	20cm Spike	6050160.00	621838.66	856.36
2758	20cm Spike	6050144.04	621838.66	856.36
2759	20cm Spike	6050128.08	621838.66	856.36
2760	20cm Spike	6050112.02	621838.66	856.36
2761	20cm Spike	6050096.06	621838.66	856.36
2762	20cm Spike	6050080.00	621838.66	856.36
2763	20cm Spike	6050064.04	621838.66	856.36
2764	20cm Spike	6050048.08	621838.66	856.36
2765	20cm Spike	6050032.02	621838.66	856.36
2766	20cm Spike	6050016.06	621838.66	856.36
2767	20cm Spike	6049999.99	621838.66	856.36
2768	20cm Spike	6049983.93	621838.66	856.36
2769	20cm Spike	6049967.87	621838.66	856.36
2770	20cm Spike	6049951.81	621838.66	856.36
2771	20cm Spike	6049935.75	621838.66	856.36
2772	20cm Spike	6049919.69	621838.66	856.36
2773	20cm Spike	6049903.63	621838.66	856.36
2774	20cm Spike	6049887.57	621838.66	856.36
2775	20cm Spike	6049871.51	621838.66	856.36
2776	20cm Spike	6049855.45	621838.66	856.36
2777	20cm Spike	6049839.39	621838.66	856.36
2778	20cm Spike	6049823.33	621838.66	856.36
2779	20cm Spike	6049807.27	621838.66	856.36
2780	20cm Spike	6049791.21	621838.66	856.36
2781	20cm Spike	6049775.15	621838.66	856.36
2782	20cm Spike	6049759.09	621838.66	856.36
2783	20cm Spike	6049743.03	621838.66	856.36
2784	20cm Spike	6049726.97	621838.66	856.36
2785	20cm Spike	6049710.91	621838.66	856.36
2786	20cm Spike	6049694.85	621838.66	856.36
2787	20cm Spike	6049678.79	621838.66	856.36
2788	20cm Spike	6049662.73	621838.66	856.36
2789	20cm Spike	6049646.67	621838.66	856.36
2790	20cm Spike	6049630.61	621838.6	

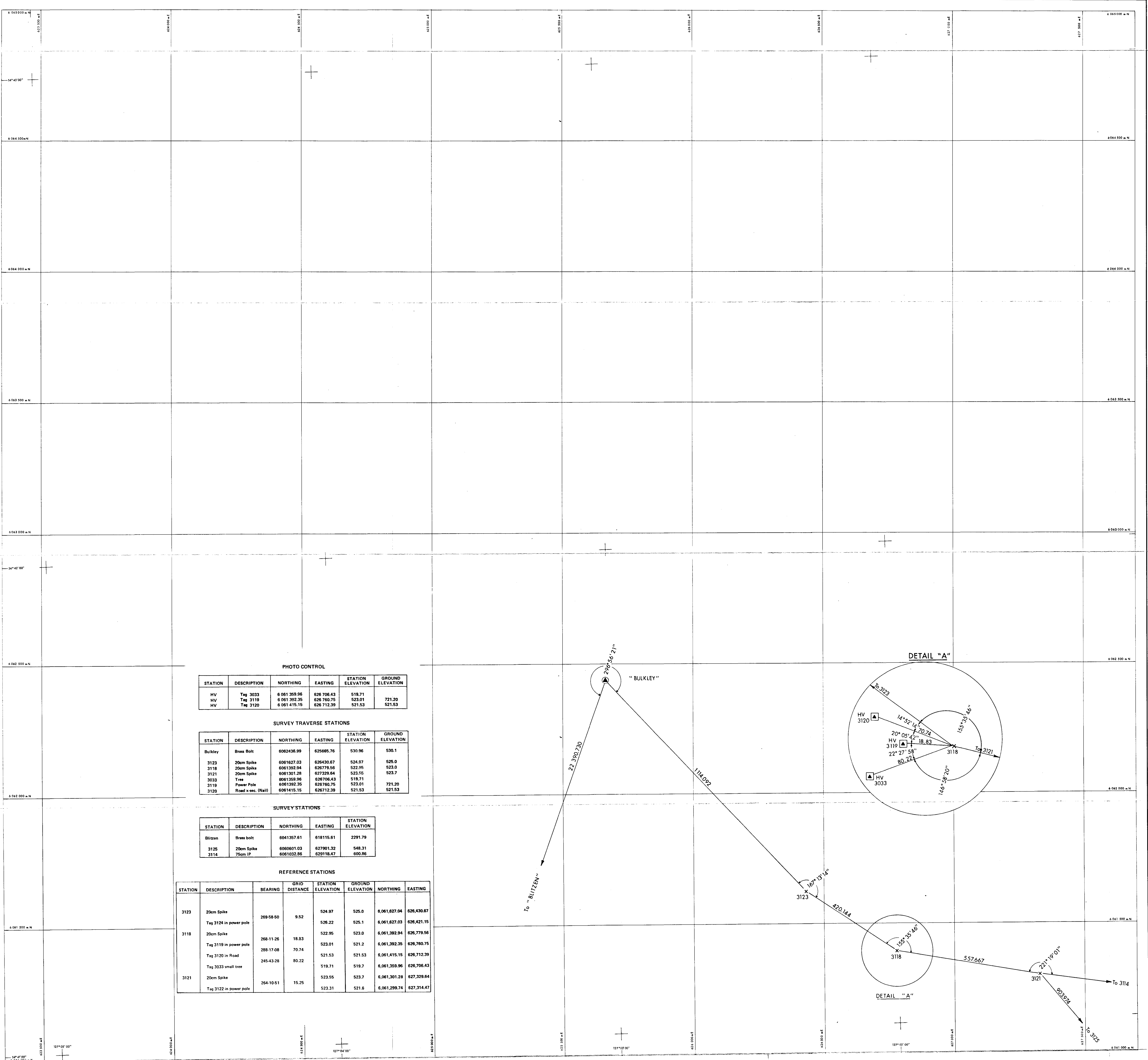

PHOTO CONTROL					
STATION	DESCRIPTION	NORTHING	EASTING	STATION ELEVATION	GROUND ELEVATION
HV 3123	Tag 3033	6 061 359.96	626 706.43	519.71	
HV 3119	Tag 3119	6 061 392.35	626 760.75	523.01	721.20
HV 3120	Tag 3120	6 061 415.15	626 712.39	521.53	521.53

SURVEY TRAVERSE STATIONS					
STATION	DESCRIPTION	NORTHING	EASTING	STATION ELEVATION	GROUND ELEVATION
Bulkley	Brass Bolt	6062436.99	625665.76	530.96	530.1
3123	20cm Spike	6061627.03	626430.67	524.97	525.0
3118	20cm Spike	6061392.94	626779.56	522.05	523.0
3121	20cm Spike	6061301.28	627329.64	523.55	523.7
3033	Tree	6061359.96	626706.43	519.71	
3119	Power Pole	6061392.35	626760.75	523.01	721.20
3120	Road x sec. (Nail)	6061415.15	626712.39	521.53	521.53

SURVEY STATIONS				
STATION	DESCRIPTION	NORTHING	EASTING	STATION ELEVATION
Blitzen	Brass bolt	6041357.61	618115.61	2291.79
3125	20cm Spike	6060601.03	627901.32	548.31
3114	75cm IP	6061032.86	629118.47	600.86

REFERENCE STATIONS						
STATION	DESCRIPTION	BEARING	GRID DISTANCE	STATION ELEVATION	GROUND ELEVATION	NORTHING
3123	20cm Spike			524.97	525.0	6,061,627.04
	Tag 3124 in power pole	269-58-50	9.52	526.22	525.1	6,061,627.03
3118	20cm Spike			522.05	523.0	6,061,392.94
	Tag 3119 in power pole	268-11-26	18.83	523.01	521.2	6,061,392.35
	Tag 3120 in Road	268-17-08	70.74	521.53	521.53	6,061,415.15
	Tag 3033 small tree	245-43-28	80.22	519.71	519.7	6,061,359.96
3121	20cm Spike			523.55	523.7	6,061,301.28
	Tag 3122 in power pole	264-10-51	15.25	523.31	521.6	6,061,299.74

MAP INDEX 93L/10 & 11

LEGEND

- NAIL
- ✕ 20cm SPIKE
- TRENCH
- DRILL HOLE
- CONTROL POINT OF NETWORK (GOV.)
- IRON POST
- ▲ 1982 PHOTO TARGET OR PHOTO I.D. POINT MARKED WITH IRON POST
- ◆ COMPASS TRAVERSE POINT

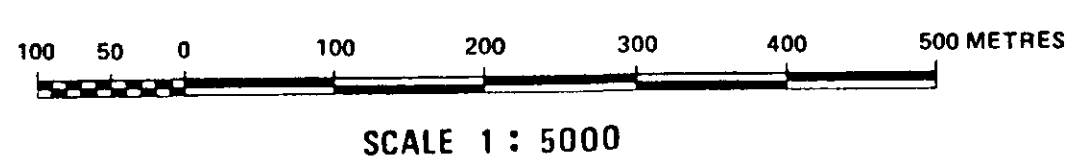

NOTES

ALL DETAILS ARE NOT TO SCALE.

ELEVATIONS are on Geodetic Datum and are derived by reciprocal Trigonometric levelling from bench marks 78HA 362, 364, 366, 369, 372, and 244A

CO-ORDINATES are on UTM (Zone 9) grid and are derived from Government Stations "AMIGO", "BLITZEN", "BULKLEY", "CREEK", "MUCHO", "PABLO", "P. CON. 18", "POWER", & "TACK"



Crows Nest Resources Limited
EXPLORATION

WEST CENTRAL, B.C.
TELKWA

TRAVERSE SURVEY MAP

(25)

SHEET No. 82 NE
U.T.M. ZONE 9

N.T.S. 93L/11

AUTHOR: DE WATSON B.C.L.S.

SCALE: 1:5 000

DRAWN BY:

DATE: 82.11.22

REVISED: 83.10

DRAWING No. TW2V7

To Accompany

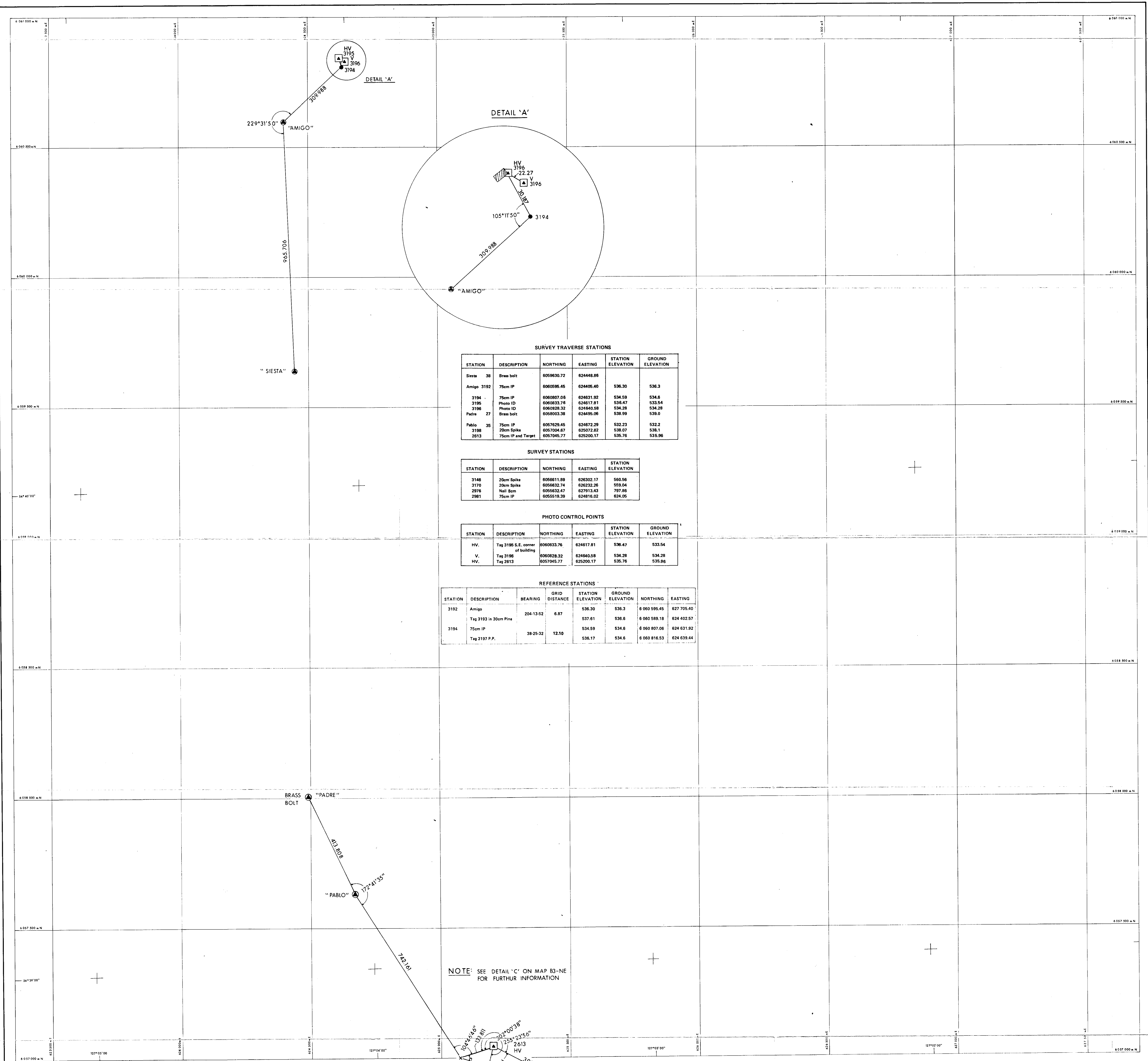

SURVEY TRAVERSE STATIONS					
STATION	DESCRIPTION	NORTHING	EASTING	STATION ELEVATION	GROUND ELEVATION
Sierra 38	Brass bolt	6059630.72	624448.86		
Amigo 3192	75cm IP	6060596.45	624446.40	536.30	536.3
3194	75cm IP	6060807.06	624631.92	534.59	534.6
3195	Photo ID	6060833.74	624617.81	536.47	536.54
3196	Photo ID	6060828.32	624640.58	534.28	534.28
Padre 27	Brass bolt	6060803.38	624495.06	538.99	539.0
Pablo 35	75cm IP	6057629.45	624672.29	532.23	532.2
3198	20cm Spike	6057004.47	625072.82	538.07	538.1
2613	75cm IP and Target	6057045.77	625200.17	535.76	535.86

SURVEY STATIONS				
STATION	DESCRIPTION	NORTHING	EASTING	STATION ELEVATION
3146	20cm Spike	6056611.89	626302.17	560.56
3170	20cm Spike	6056632.74	626232.26	559.04
2976	Nail 8cm	6055632.47	627913.43	797.86
2981	75cm IP	6055519.39	624816.02	624.05

PHOTO CONTROL POINTS					
STATION	DESCRIPTION	NORTHING	EASTING	STATION ELEVATION	GROUND ELEVATION
HV.	Tag 3196 S.E. corner of building	6060833.76	624617.81	536.47	533.54
V.	Tag 3196	6060828.32	624640.58	534.28	534.28
HV.	Tag 2613	6057045.77	625200.17	535.76	535.86

REFERENCE STATIONS					
STATION	DESCRIPTION	BEARING	GRID DISTANCE	STATION ELEVATION	GROUND ELEVATION
3192	Amigo	204°13'52"	6.87	536.30	536.3
	Tag 3193 in 30cm Pine			537.61	536.6
3194	75cm IP	39°25'32"	12.10	534.59	534.6
	Tag 3197 P.P.			536.17	534.6

NOTE: SEE DETAIL 'C' ON MAP B3-NE FOR FURTHER INFORMATION

NOTES

ALL DETAILS ARE NOT TO SCALE.

ELEVATIONS are on Geodetic Datum and are derived by reciprocal Trigonometric levelling from bench marks 79HA 362, 364, 366, 369, 372, and 244A.

CO-ORDINATES are on UTM (Zone 9) grid and are derived from Government Stations "AMIGO", "BLITZEN", "BULKLEY", "CREEK", "MUCHO", "PABLO", "P. CON. 18", "POWER", & "TACK"

LEGEND

- NAIL
- 20cm SPIKE
- TRENCH
- DRILL HOLE
- CONTROL POINT OF NETWORK (GOV.)
- IRON POST
- 1982 PHOTO TARGET OR PHOTO I.D. POINT MARKED WITH IRON POST
- COMPASS TRAVERSE POINT

MAP INDEX

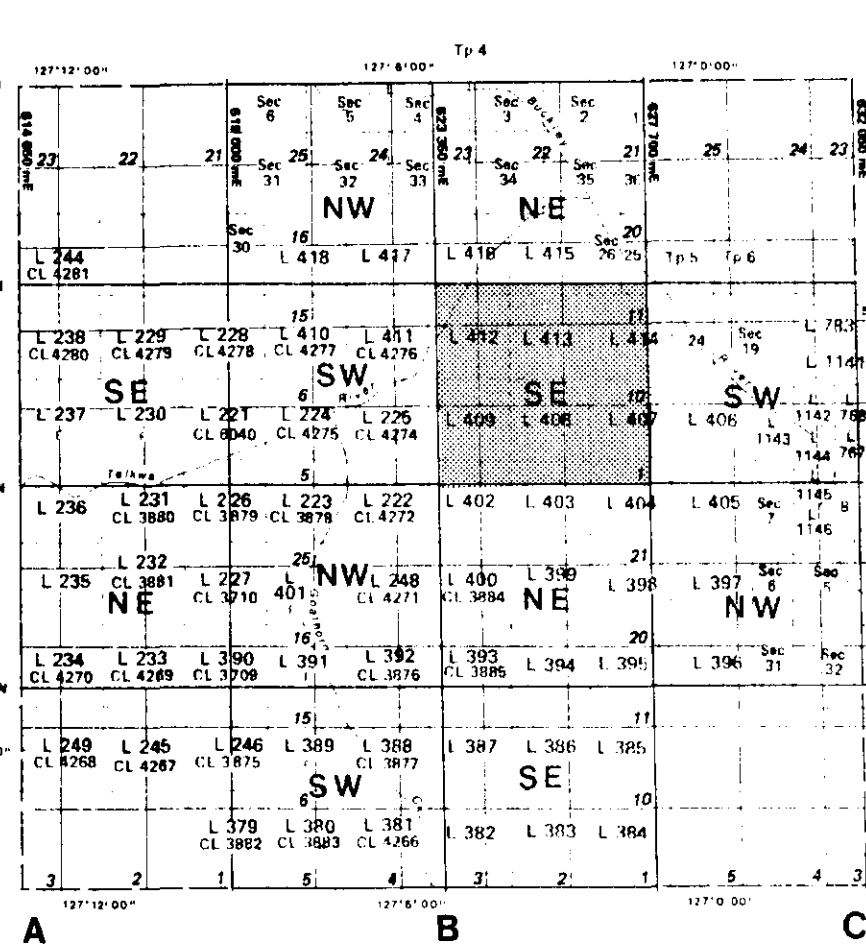

Crows Nest Resources Limited EXPLORATION	
WEST CENTRAL, B.C. TELKWA	
TRAVERSE SURVEY MAP	
SHEET No. 82 SE U.T.M. ZONE 9	
N.T.S. 93L/10 & 11	DATE: 82.11.22
AUTHOR: D.E. WATSON B.C.L.S.	SCALE: 1:5 000
REVISOR: 83.10	DRAWN BY:
To Accompany	DRAWING No: TW2V8

PLAN STATION NO.	DESCRIPTION	STATION ELEV.	GROUND ELEV.	NORTHING	EASTING
7026	OIP				
	S. Bdy of BCH & PA R/W; E. Bdy of D.L. 400	629.44	629.4	6 055 618.07	624 568.21
	Calculated S.E. Corner of D.L. 400			6 054 389	624 600
	Calculated N.W. Corner of D.L. 400			6 055 997	624 568

Calculated N.E. Corner of D.L. 400 by D.E. Watson B.C.L.S.
L.400
CL. 3884

Calculated S.E. Corner of D.L. 400 by D.E. Watson B.C.L.S.
L.393
CL. 3885

STATION	DESCRIPTION	NORTHING	EASTING	STATION ELEVATION	GROUND ELEVATION
2981	75cm IP	6055519.39	624816.02	624.05	624.2
3170	20cm Spike	6066632.74	626232.26	559.04	559.1
3199	20cm Spike	6066697.08	626357.30	561.62	561.7
2616	75cm IP and Target	6056469.73	626758.81	565.25	565.2
3146	20cm Spike	6066611.89	626302.17	560.58	560.5

STATION	DESCRIPTION	NORTHING	EASTING	STATION ELEVATION
2613	75cm IP and Target	6057045.77	625200.17	535.76
3198	75cm IP and Target	6057004.67	625072.82	538.07
2976	Nail Rem in rock	6056632.47	627913.43	797.85

STATION	DESCRIPTION	NORTHING	EASTING	STATION ELEVATION	GROUND ELEVATION
HV.	Tag 2616 75cm IP	6056469.73	626758.81	565.25	565.25
HV	Tag 2604 75cm IP and Target	6055544.71	624850.59	618.22	618.27

STATION	DESCRIPTION	BEARING	GRID DISTANCE	STATION ELEVATION	GROUND ELEVATION	NORTHING	EASTING
2981	75cm IP			624.06	624.2	6,055,519.39	624,816.05
	Tag 2606 in 20cm Birch	226-39-53	1.29	624.64		6,055,518.51	624,815.09
	Tag 2604 75cm IP and Target	53-46-57	42.85				
				618.27	618.3	6,055,544.71	624,850.59
2616	75cm IP and Target			565.25	565.2	6,056,469.73	626,758.81
	Tag 2617 in 30cm Poplar	235-30-22	15.46	568.85	564.5	6,056,460.96	626,744.07
	Tag 2618 in 30cm Birch	152-09-27	23.78	568.25	566.8	6,056,448.73	626,767.97
3170	20cm Spike						
	Tag 3171 in 40cm Spruce	224-01-53	4.83	562.62	561.2	6,056,629.27	626,228.91

MAP INDEX 93L/10 & 11

LEGEND

- NAIL
- 20cm SPIKE
- TRENCH
- DRILL HOLE
- CONTROL POINT OF NETWORK (GOV.)
- IRON POST
- 1982 PHOTO TARGET OR PHOTO I.D. POINT MARKED WITH IRON POST
- COMPASS TRAVERSE POINT

SCALE 1 : 5000

NOTES

ALL DETAILS ARE NOT TO SCALE.

ELEVATIONS are on Geodetic Datum and are derived by reciprocal Trigonometric levelling from bench marks 79HA 362, 364, 366, 368, 372, and 244A.

CO-ORDINATES are on UTM (Zone 9) grid and are derived from Government Stations "AMIGO", "BLITZEN", "BULKLEY", "CREEK", "MUCHO", "PABLO", "P. CON. 18", "POWER", & "TACK".

LOT LINES APPROXIMATE ONLY

1K-TELKWA 882A 239

Crows Nest Resources Limited
EXPLORATION

WEST CENTRAL, B.C.
TELKWA

TRAVERSE SURVEY MAP

SHEET No. B3NE
U.T.M. ZONE 9

N.T.S. 93L/11

AUTHOR: DE WATSON B.C.L.S. SCALE: 1 : 5 000 DRAWN BY: [Signature]

DATE: 82.11.22 REVISED: 83.10 To Accompany

DRAWING No: TW2V9

L393
CL.3885

1523
DETAIL 'A'

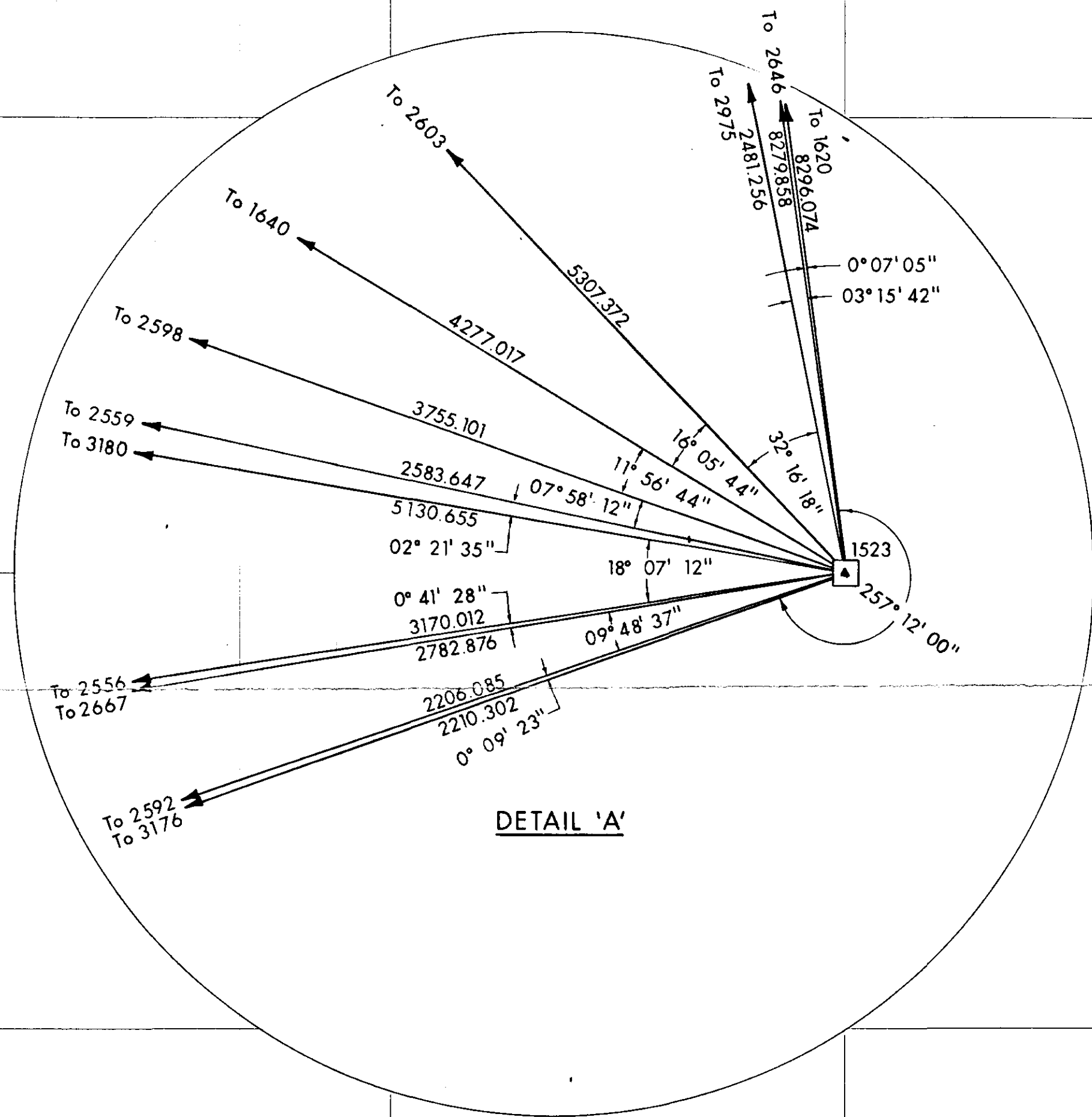

SURVEY TRAVERSE AND PHOTO CONTROL STATION

STATION	DESCRIPTION	NORTHING	EASTING	STATION ELEVATION	GROUND ELEVATION
1523	75cm IP and Target	6051910.71	623433.52	1216.59	1216.15

SURVEY STATIONS

STATION	DESCRIPTION	NORTHING	EASTING	STATION ELEVATION
1620	75cm IP	6060123.39	622280.23	585.65
2646	75cm IP and Target	6060194.91	622245.71	595.88
2975	20cm Spike	6054342.06	622938.40	755.52
2803	HV 75cm IP and Target	605742.52	618761.27	699.45
1640	75cm IP and Target	6054057.14	619734.10	760.39
2598	HV 75cm IP and Target	6053052.13	618605.81	792.94
2559	HV 75cm IP and Target	6052306.54	620890.76	779.92
3180	75cm IP and Target	6052811.21	618350.91	830.14
2556	HV 75cm IP and Target	6051345.39	620314.32	854.97
2687	HV 75cm IP and Target	6051381.44	620791.44	859.12
2592	HV 75cm IP and Target	6051129.25	621370.88	862.50
3176	Iron Nail	6051125.11	621259.05	853.65

REFERENCE STATIONS

STATION	DESCRIPTION	BEARING	GRID DISTANCE	STATION ELEVATION	GROUND ELEVATION	NORTHING	EASTING
1523	75cm IP	198-57-28	7.452	1216.59	1216.15	6,051,910.71	623,433.52
	Tag 1524 in 10cm Fir			1216.34	1214.9	6,051,903.86	623,431.10
	Tag 1525 in 20cm Pine	108-06-42	12.780	1217.89	1216.6	6,051,906.74	623,445.67

MAP INDEX

93L/10 & 11

LEGEND

- NAIL
- 20cm SPIKE
- TRENCH
- DRILL HOLE
- CONTROL POINT OF NETWORK (GOV.)
- IRON POST
- 1982 PHOTO TARGET OR PHOTO I.D. POINT MARKED WITH IRON POST
- COMPASS TRAVERSE POINT

100 50 0 100 200 300 400 500 METRES

SCALE 1 : 5000

NOTES

ALL DETAILS ARE NOT TO SCALE.

ELEVATIONS are on Geodetic Datum and are derived by reciprocal Trigonometric levelling from bench marks 79HA 362, 364, 366, 369, 372, and 244A.

CO-ORDINATES are on UTM (Zone 9) grid and are derived from Government Stations "AMIGO", "BLITZEN", "BULKLEY", "CREEK", "MUCHO", "PABLO", "P. CON. 18", "POWER", & "TACK".

LOT LINES APPROXIMATE ONLY

Crows Nest Resources Limited
EXPLORATION

WEST CENTRAL, B.C.
TELKWA

TRAVERSE SURVEY MAP

28

SHEET No.83 SE
U.T.M. ZONE 9

N.T.S. 93L/11

AUTHOR: DE. WATSON B.C.L.S. SCALE: 1:5,000
DATE: 8/11/22
REVISED: 8/3/10

DRAWN BY:
DRAWING No. TW2V10

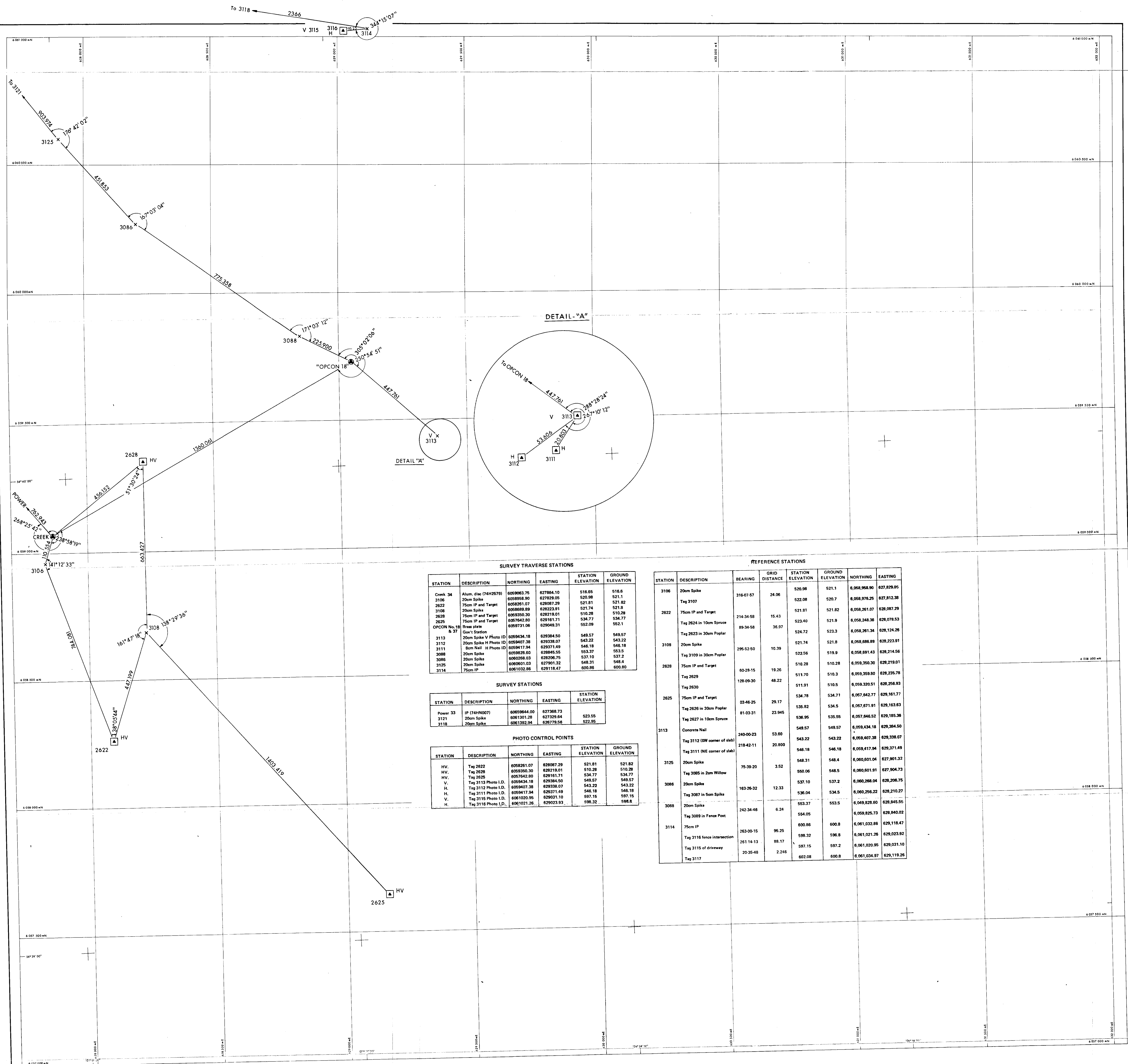

SURVEY TRAVERSE STATIONS

STATION	DESCRIPTION	NORTHING	EASTING	STATION ELEVATION	GROUND ELEVATION
Creek 34	Alum. disc (7412579)	6060002.75	627854.10	516.65	516.6
3106	20cm Spike	6058968.90	627829.05	520.98	521.1
2822	75cm IP and Target	6058261.07	628087.29	521.81	521.82
3108	20cm Spike	6058969.89	628223.91	521.74	521.8
2628	75cm IP and Target	6059350.30	628218.01	510.28	510.28
2625	75cm IP and Target	6057642.80	628161.71	534.77	534.77
3125	20cm Spike	6059731.06	628048.31	552.09	552.1
OPCON No. 18	Gov't Station				
3113	20cm Spike V Photo ID	6059434.18	628384.50	548.57	548.57
3112	20cm Spike H Photo ID	6059407.39	628338.07	543.22	543.22
3111	8cm Nail H Photo ID	6059417.94	628371.49	546.18	546.18
3088	20cm Spike	6058828.60	628445.55	553.37	553.5
3086	20cm Spike	6060268.03	628206.75	537.10	537.2
3125	20cm Spike	6060601.03	627901.32	548.31	548.4
3114	75cm IP	6061032.86	629118.47	600.86	600.86

SURVEY STATIONS

STATION	DESCRIPTION	NORTHING	EASTING	STATION ELEVATION
Power 33	IP (744N007)	6059644.00	627368.73	523.55
3121	20cm Spike	6061301.28	627328.64	523.55
3118	20cm Spike	6061392.94	626779.58	522.95

PHOTO CONTROL POINTS

STATION	DESCRIPTION	NORTHING	EASTING	STATION ELEVATION	GROUND ELEVATION
HV	Tag 2822	6058261.07	628087.29	521.81	521.82
HV	Tag 2628	6059350.30	628218.01	510.28	510.28
HV	Tag 2625	6057642.80	628161.71	534.77	534.77
V	Tag 3113 Photo I.D.	6059434.18	628384.50	548.57	548.57
H	Tag 3112 Photo I.D.	6059407.39	628338.07	543.22	543.22
V	Tag 3111 Photo I.D.	6059417.94	628371.49	546.18	546.18
H	Tag 3116 Photo I.D.	6061032.86	629118.47	597.15	597.15
H	Tag 3118 Photo I.D.	6061392.94	626779.58	522.95	522.95

REFERENCE STATIONS

STATION	DESCRIPTION	BEARING	GRID DISTANCE	STATION ELEVATION	GROUND ELEVATION	NORTHING	EASTING
3106	20cm Spike	316-07-57	24.06	520.98	520.1	6,058,968.90	627,829.05
	Tag 3107			522.08	520.7	6,058,976.25	627,812.38
2622	75cm IP and Target	214-34-58	15.43	521.81	521.82	6,058,261.07	628,087.29
	Tag 2624 in 10cm Spruce	89-34-58	36.97	523.40	521.9	6,058,248.36	628,078.53
	Tag 2623 in 30cm Poplar			524.72	523.3	6,058,261.34	628,124.26
3108	20cm Spike	295-62-50	10.39	521.74	521.8	6,058,969.89	628,223.91
	Tag 3109 in 30cm Poplar			522.56	519.9	6,058,691.43	628,214.58
2628	75cm IP and Target	60-28-15	19.26	510.28	510.28	6,059,350.30	628,219.01
	Tag 2629	128-09-30	48.22	511.70	510.3	6,059,359.80	628,235.78
	Tag 2630			511.91	510.5	6,059,320.51	628,256.93
2625	75cm IP and Target	03-46-25	29.17	534.78	534.71	6,057,642.77	629,161.77
	Tag 2626 in 30cm Poplar	81-03-31	23.945	536.82	534.5	6,057,671.91	629,163.63
	Tag 2627 in 10cm Spruce			536.95	535.55	6,057,646.52	628,185.36
3113	Concrete Nail	240-00-23	53.60	549.57	549.57	6,059,434.18	629,384.50
	Tag 3112 (SW corner of slab)	218-42-11	20.800	543.22	543.22	6,058,407.38	628,338.07
	Tag 3111 (NE corner of slab)			546.18	546.18	6,058,417.94	629,371.49
3125	20cm Spike	75-39-20	3.52	548.31	548.4	6,060,601.04	627,901.32
	Tag 3085 in 2cm Willow			550.06	548.5	6,060,601.91	627,904.73
3086	20cm Spike	163-26-32	12.33	537.10	537.2	6,060,268.04	628,206.75
	Tag 3087 in 5cm Spike			536.04	534.5	6,060,256.22	628,210.27
3088	20cm Spike	242-34-48	6.24	553.37	553.5	6,049,828.60	628,845.55
	Tag 3089 in Fence Post			554.05	6,059,825.73	628,840.02	
3114	75cm IP	263-00-15	96.25	600.86	600.8	6,061,032.86	629,118.47
	Tag 3116 fence intersection	261-14-13	88.17	598.32	598.8	6,061,021.26	629,023.92
	Tag 3115 of driveway	20-35-48	2.246	597.15	597.2	6,061,020.95	629,031.10
	Tag 3117			602.08	600.8	6,061,034.97	629,119.26

MAP INDEX

93L/10 & 11

LEGEND

- NAIL
- 20cm SPIKE
- TRENCH
- DRILL HOLE
- CONTROL POINT OF NETWORK (GOV.)
- IRON POST
- 1982 PHOTO TARGET OR PHOTO I.D. POINT MARKED WITH IRON POST
- ◆ COMPASS TRAVERSE POINT

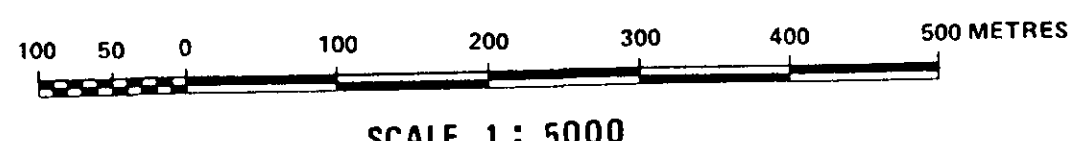

NOTES

ALL DETAILS ARE NOT TO SCALE.

ELEVATIONS are on Geodetic Datum and are derived by reciprocal Trigonometric levelling from bench marks 79HA 362, 364, 366, 369, 372, and 244A.

CO-ORDINATES are on UTM (Zone 9) grid and are derived from Government Stations "AMIGO", "BLITZEN", "BULKLEY", "CREEK", "MUCHO", "PABLO", "P. CON. 18", "POWER", and "TACK".

Crows Nest Resources Limited
EXPLORATION

WEST CENTRAL, B.C.
TELKWA

TRAVERSE SURVEY MAP

(29)

N.T.S. 93L 10/11
AUTHOR: DE WATSON, B.C.L.S.
DATE: 82.11.22
To Accompany

SCALE: 1: 5 000
REVISED: 83.10

DRAWN BY:
DRAWING No: TW2V11

SHEET No. C2 SW
U.T.M. ZONE 9

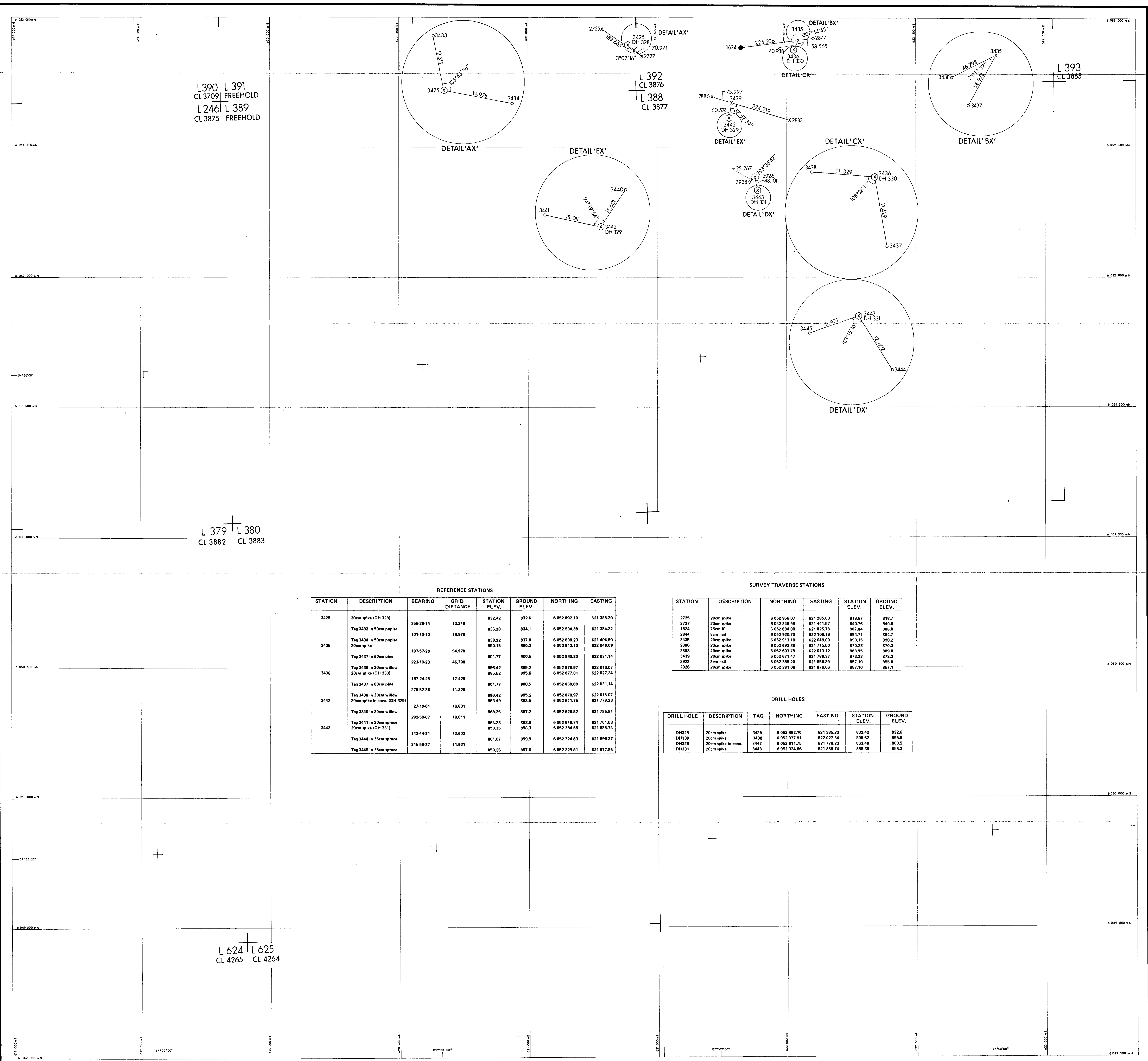

REFERENCE STATIONS							
STATION	DESCRIPTION	BEARING	GRID DISTANCE	STATION ELEV.	GROUND ELEV.	NORTHING	EASTING
3425	20cm spike (DH 328)	355-26-14	12.319	832.42	832.6	6 052 892.10	621 385.20
	Tag 3433 in 50cm poplar	101-10-10	19.978	835.28	834.1	6 052 904.38	621 384.22
3435	Tag 3434 in 50cm poplar			838.22	837.0	6 052 888.23	621 404.80
	20cm spike	197-57-26	54.978	890.15	890.2	6 052 913.10	622 048.08
	Tag 3437 in 60cm pine	223-10-23	46.798	901.77	900.5	6 052 880.80	622 031.14
3436	Tag 3438 in 30cm willow	167-24-25	17.429	896.42	895.2	6 052 878.97	622 016.07
	20cm spike (DH 330)	275-52-36	11.329	895.62	895.6	6 052 877.81	622 027.34
	Tag 3437 in 60cm pine			901.77	900.5	6 052 880.80	622 031.14
3442	Tag 3438 in 30cm willow			896.42	895.2	6 052 878.97	622 016.07
	20cm spike in conc. (DH 329)	27-10-01	18.601	863.49	863.5	6 052 611.75	621 778.23
	Tag 3340 in 30cm willow			868.36	867.2	6 052 626.52	621 785.81
3443	Tag 3441 in 30cm spruce	282-50-07	18.011	864.23	863.0	6 052 618.74	621 781.63
	20cm spike (DH 331)			858.35	858.3	6 052 334.66	621 888.74
	Tag 3444 in 35cm spruce	142-44-21	12.602	961.07	959.9	6 052 324.63	621 896.37
	Tag 3445 in 25cm spruce	245-59-37	11.921	859.26	857.6	6 052 329.81	621 877.85

SURVEY TRAVERSE STATIONS					
STATION	DESCRIPTION	NORTHING	EASTING	STATION ELEV.	GROUND ELEV.
2725	20cm spike	6 052 956.07	621 285.03	818.67	818.7
2727	20cm spike	6 052 848.98	621 441.57	840.76	840.8
2844	75cm IP	6 052 884.00	621 825.78	887.84	888.0
2844	8cm nail	6 052 920.70	622 106.16	894.71	894.7
3435	20cm spike	6 052 913.10	622 048.09	890.15	890.2
2886	20cm spike	6 052 693.38	621 715.60	870.23	870.3
2883	20cm spike	6 052 603.79	622 013.12	888.95	889.0
3439	20cm spike	6 052 671.47	621 788.37	873.23	873.2
2928	8cm nail	6 052 385.20	621 858.39	857.10	856.8
2928	20cm spike	6 052 381.06	621 876.06	857.10	857.1

DRILL HOLES						
DRILL HOLE	DESCRIPTION	TAG	NORTHING	EASTING	STATION ELEV.	GROUND ELEV.
DH328	20cm spike	3425	6 052 892.10	621 385.20	832.42	832.6
DH330	20cm spike	3436	6 052 877.81	622 027.34	895.62	895.6
DH329	20cm spike in conc.	3442	6 052 611.75	621 778.23	863.49	863.5
DH331	20cm spike	3443	6 052 334.66	621 888.74	858.35	858.3

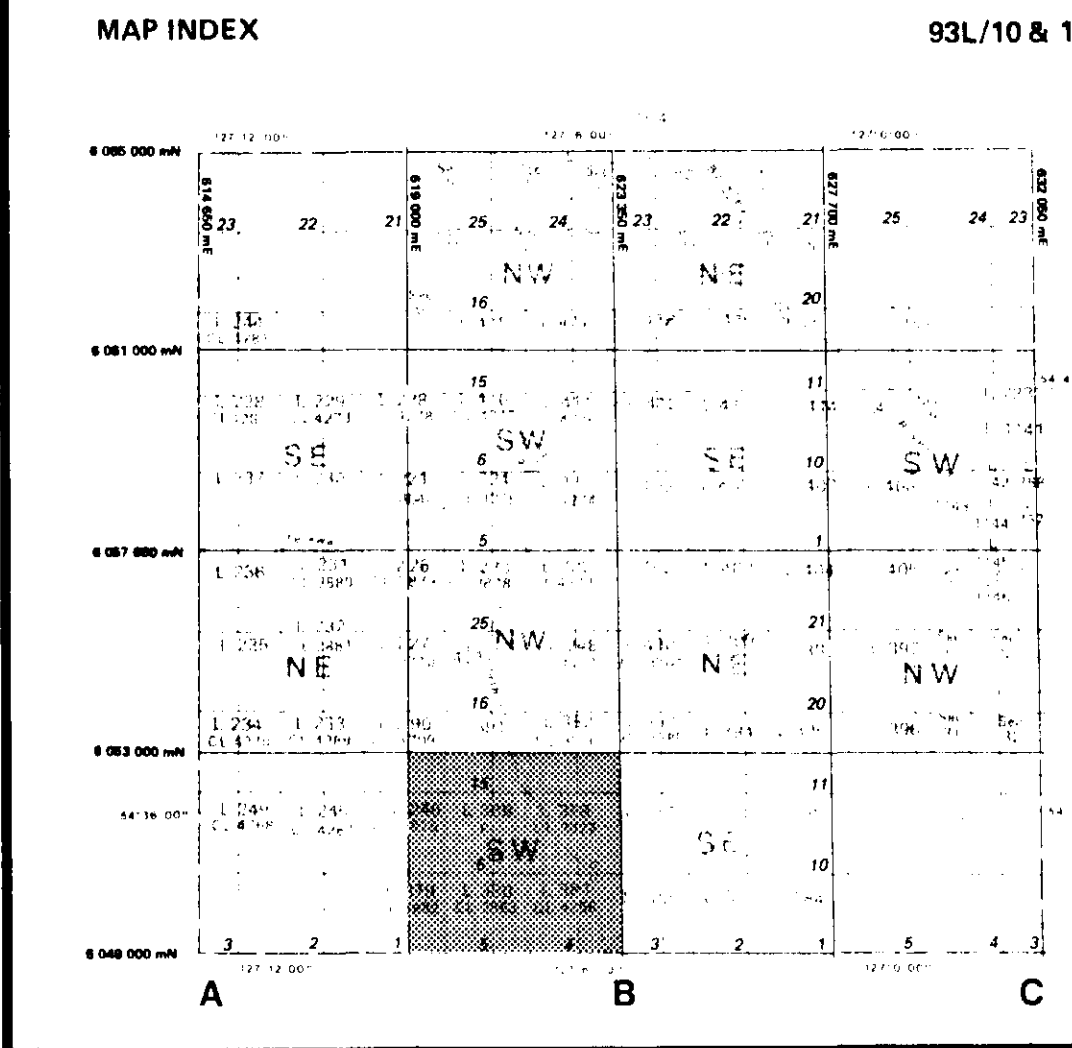

- LEGEND**
- NAIL
 - × 20cm SPIKE
 - TRENCH
 - DRILL HOLE
 - CONTROL POINT OF NETWORK (GOV.)
 - IRON POST
 - ▲ 1982 PHOTO TARGET OR PHOTO I.D. POINT MARKED WITH IRON POST
 - ◆ COMPASS TRAVERSE POINT

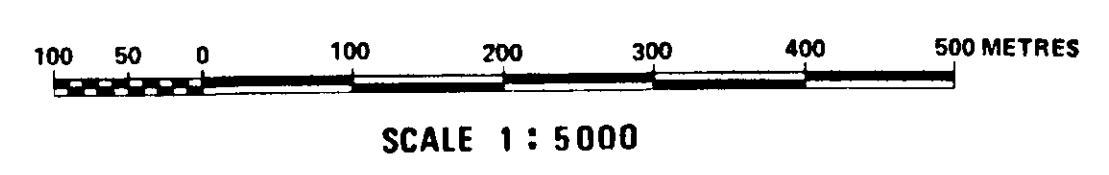

NOTES

ALL DETAILS ARE NOT TO SCALE.

ELEVATIONS are on Geodetic Datum and are derived by reciprocal Trigonometric levelling from bench marks 79HA 362, 364, 366, 369, 372, and 244A.

CO-ORDINATES are on UTM (Zone 8) grid and are derived from Government Stations "AMIGO", "BLITZEN", "BULKLEY", "CREEK", "MUCHO", "PABLO", "P. CON. 18", "POWER", & "TACK".

LOT LINES APPROXIMATE ONLY

Crows Nest Resources Limited
EXPLORATION

WEST CENTRAL, B.C.
TELKWA

TRAVERSE SURVEY MAP

SHEET No 83 SW
U.T.M. ZONE 9

N.T.S. 93L/11

AUTHOR: DE WATSON & CLS
DATE: 83 09
To: Accompany

SCALE: 1:5 000
REVISOR:

DRAWN BY: R.G.P.
DRAWING No: TW2V13

239

31

DILL HOLE	DESCRIPTION	TAG	NORTHING	EASTING	STATION ELEV.	GROUND ELEV.
DH159	20m well	3448	670,980.353	809,146.28	1172.8	1174
DH160	20m well	3449	670,980.353	809,146.28	1172.8	1174
DH176	20m well	3450	670,980.353	809,146.28	1172.8	1174
DH177	20m well	3451	670,980.353	809,146.28	1172.8	1174
DH234	20m well	3452	670,980.353	809,146.28	1172.8	1174
DH235	20m well	3453	670,980.353	809,146.28	1172.8	1174
DH236	20m well	3454	670,980.353	809,146.28	1172.8	1174
DH237	20m well	3455	670,980.353	809,146.28	1172.8	1174
DH238	20m well	3456	670,980.353	809,146.28	1172.8	1174
DH239	20m well	3457	670,980.353	809,146.28	1172.8	1174
DH240	20m well	3458	670,980.353	809,146.28	1172.8	1174
DH241	20m well	3459	670,980.353	809,146.28	1172.8	1174
DH242	20m well	3460	670,980.353	809,146.28	1172.8	1174
DH243	20m well	3461	670,980.353	809,146.28	1172.8	1174
DH244	20m well	3462	670,980.353	809,146.28	1172.8	1174
DH245	20m well	3463	670,980.353	809,146.28	1172.8	1174
DH246	20m well	3464	670,980.353	809,146.28	1172.8	1174
DH247	20m well	3465	670,980.353	809,146.28	1172.8	1174
DH248	20m well	3466	670,980.353	809,146.28	1172.8	1174
DH249	20m well	3467	670,980.353	809,146.28	1172.8	1174
DH250	20m well	3468	670,980.353	809,146.28	1172.8	1174
DH251	20m well	3469	670,980.353	809,146.28	1172.8	1174
DH252	20m well	3470	670,980.353	809,146.28	1172.8	1174
DH253	20m well	3471	670,980.353	809,146.28	1172.8	1174
DH254	20m well	3472	670,980.353	809,146.28	1172.8	1174
DH255	20m well	3473	670,980.353	809,146.28	1172.8	1174
DH256	20m well	3474	670,980.353	809,146.28	1172.8	1174
DH257	20m well	3475	670,980.353	809,146.28	1172.8	1174
DH258	20m well	3476	670,980.353	809,146.28	1172.8	1174
DH259	20m well	3477	670,980.353	809,146.28	1172.8	1174
DH260	20m well	3478	670,980.353	809,146.28	1172.8	1174
DH261	20m well	3479	670,980.353	809,146.28	1172.8	1174
DH262	20m well	3480	670,980.353	809,146.28	1172.8	1174
DH263	20m well	3481	670,980.353	809,146.28	1172.8	1174
DH264	20m well	3482	670,980.353	809,146.28	1172.8	1174
DH265	20m well	3483	670,980.353	809,146.28	1172.8	1174
DH266	20m well	3484	670,980.353	809,146.28	1172.8	1174
DH267	20m well	3485	670,980.353	809,146.28	1172.8	1174
DH268	20m well	3486	670,980.353	809,146.28	1172.8	1174
DH269	20m well	3487	670,980.353	809,146.28	1172.8	1174
DH270	20m well	3488	670,980.353	809,146.28	1172.8	1174
DH271	20m well	3489	670,980.353	809,146.28	1172.8	1174
DH272	20m well	3490	670,980.353	809,146.28	1172.8	1174
DH273	20m well	3491	670,980.353	809,146.28	1172.8	1174
DH274	20m well	3492	670,980.353	809,146.28	1172.8	1174
DH275	20m well	3493	670,980.353	809,146.28	1172.8	1174
DH276	20m well	3494	670,980.353	809,146.28	1172.8	1174
DH277	20m well	3495	670,980.353	809,146.28	1172.8	1

[illegible]

STATION	DESCRIPTION	NORTHING	EASTING	STATION ELEV.	GROUND ELEV.
2363	2nd Sta	9 054 406.020	400 000.000	72 891	72.8
2364	2nd Sta	9 054 410.172	400 000.000	72 891	72.8
2365	2nd Sta	9 054 414.324	400 000.000	72 891	72.8
2367	2nd Sta	9 054 418.476	400 000.000	72 891	72.8
2368	2nd Sta	9 054 422.628	400 000.000	72 891	72.8
2369	2nd Sta	9 053 426.780	400 000.000	72 891	72.8
2370	2nd Sta	9 053 430.932	400 000.000	72 891	72.8
2371	2nd Sta	9 053 435.084	400 000.000	72 891	72.8
2372	2nd Sta	9 053 439.236	400 000.000	72 891	72.8
2373	2nd Sta	9 053 443.388	400 000.000	72 891	72.8
2374	2nd Sta	9 053 447.540	400 000.000	72 891	72.8
2375	2nd Sta	9 053 451.692	400 000.000	72 891	72.8
2376	2nd Sta	9 053 455.844	400 000.000	72 891	72.8
2377	2nd Sta	9 053 460.000	400 000.000	72 891	72.8
2378	2nd Sta	9 053 464.152	400 000.000	72 891	72.8
2379	2nd Sta	9 053 468.304	400 000.000	72 891	72.8
2380	2nd Sta	9 053 472.456	400 000.000	72 891	72.8
2381	2nd Sta	9 053 476.608	400 000.000	72 891	72.8
2382	2nd Sta	9 053 480.760	400 000.000	72 891	72.8
2383	2nd Sta	9 053 484.912	400 000.000	72 891	72.8
2384	2nd Sta	9 053 489.064	400 000.000	72 891	72.8
2385	2nd Sta	9 053 493.216	400 000.000	72 891	72.8
2386	2nd Sta	9 053 497.368	400 000.000	72 891	72.8
2387	2nd Sta	9 053 501.520	400 000.000	72 891	72.8
2388	2nd Sta	9 053 505.672	400 000.000	72 891	72.8
2389	2nd Sta	9 053 509.824	400 000.000	72 891	72.8
2390	2nd Sta	9 053 513.976	400 000.000	72 891	72.8
2391	2nd Sta	9 053 518.128	400 000.000	72 891	72.8
2392	2nd Sta	9 053 522.280	400 000.000	72 891	72.8
2393	2nd Sta	9 053 526.432	400 000.000	72 891	72.8
2394	2nd Sta	9 053 530.584	400 000.000	72 891	72.8
2395	2nd Sta	9 053 534.736	400 000.000	72 891	72.8
2396	2nd Sta	9 053 538.888	400 000.000	72 891	72.8
2397	2nd Sta	9 053 543.040	400 000.000	72 891	72.8
2398	2nd Sta	9 053 547.192	400 000.000	72 891	72.8
2399	2nd Sta	9 053 551.344	400 000.000	72 891	72.8
2400	2nd Sta	9 053 555.496	400 000.000	72 891	72.8
2401	2nd Sta	9 053 559.648	400 000.000	72 891	72.8
2402	2nd Sta	9 053 563.800	400 000.000	72 891	72.8
2403	2nd Sta	9 053 567.952	400 000.000	72 891	72.8
2404	2nd Sta	9 053 572.104	400 000.000	72 891	72.8
2405	2nd Sta	9 053 576.256	400 000.000	72 891	72.8
2406	2nd Sta	9 053 580.408	400 000.000	72 891	72.8
2407	2nd Sta	9 053 584.560	400 000.000	72 891	72.8
2408	2nd Sta	9 053 588.712	400 000.000	72 891	72.8
2409	2nd Sta	9 053 592.864	400 000.000	72 891	72.8
2410	2nd Sta	9 053 597.016	400 000.000	72 891	72.8
2411	2nd Sta	9 053 601.168	400 000.000	72 891	72.8
2412	2nd Sta	9 053 605.320	400 000.000	72 891	72.8
2413	2nd Sta	9 053 609.472	400 000.000	72 891	72.8
2414	2nd Sta	9 053 613.624	400 000.000	72 891	72.8
2415	2nd Sta	9 053 617.776	400 000.000	72 891	72.8
2416	2nd Sta	9 053 621.928	400 000.000	72 891	72.8
2417	2nd Sta	9 053 626.080	400 000.000	72 891	72.8
2418	2nd Sta	9 053 630.232	400 000.000	72 891	72.8
2419	2nd Sta	9 053 634.384	400 000.000	72 891	72.8
2420	2nd Sta	9 053 638.536	400 000.000	72 891	72.8
2421	2nd Sta	9 053 642.688	400 000.000	72 891	72.8
2422	2nd Sta	9 053 646.840	400 000.000	72 891	72.8
2423	2nd Sta	9 053 650.992	400 000.000	72 891	72.8
2424	2nd Sta	9 053 655.144	400 000.000	72 891	72.8
2425	2nd Sta	9 053 659.296	400 000.000	72 891	72.8
2426	2nd Sta	9 053 663.448	400 000.000	72 891	72.8
2427	2nd Sta	9 053 667.600	400 000.000	72 891	72.8
2428	2nd Sta	9 053 671.752	400 000.000	72 891	72.8
2429	2nd Sta	9 053 675.904	400 000.000	72 891	72.8
2430	2nd Sta	9 053 680.056	400 000.000	72 891	72.8
2431	2nd Sta	9 053 684.208	400 000.000	72 891	72.8
2432	2nd Sta	9 053 688.360	400 000.000	72 891	72.8
2433	2nd Sta	9 053 692.512	400 000.000	72 891	72.8
2434	2nd Sta	9 053 696.664	400 000.000	72 891	72.8
2435	2nd Sta	9 053 700.816	400 000.000	72 891	72.8
2436	2nd Sta	9 053 704.968	400 000.000	72 891	72.8
2437	2nd Sta	9 053 709.120	400 000.000	72 891	72.8
2438	2nd Sta	9 053 713.272	400 000.000	72 891	72.8
2439	2nd Sta	9 053 717.424	400 000.000	72 891	72.8
2440	2nd Sta	9 053 721.576	400 000.000	72 891	72.8
2441	2nd Sta	9 053 725.728	400 000.000	72 891	72.8
2442	2nd Sta	9 053 729.880	400 000.000	72 891	72.8
2443	2nd Sta	9 053 734.032	400 000.000	72 891	72.8
2444	2nd Sta	9 053 738.184	400 000.000	72 891	72.8
2445	2nd Sta	9 053 742.336	400 000.000	72 891	72.8
2446	2nd Sta	9 053 746.488	400 000.000	72 891	72.8
2447	2nd Sta	9 053 750.640	400 000.000	72 891	72.8
2448	2nd Sta	9 053 754.792	400 000.000	72 891	72.8
2449	2nd Sta	9 053 758.944	400 000.000	72 891	72.8
2450	2nd Sta	9 053 763.096	400 000.000	72 891	72.8
2451	2nd Sta	9 053 767.248	400 000.000	72 891	72.8
2452	2nd Sta	9 053 771.400	400 000.000	72 891	72.8
2453	2nd Sta	9 053 775.552	400 000.000	72 891	72.8
2454	2nd Sta	9 053 779.704	400 000.000	72 891	72.8
2455	2nd Sta	9 053 783.856	400 000.000	72 891	72.8
2456	2nd Sta	9 053 788.008	400 000.000	72 891	72.8
2457	2nd Sta	9 053 792.160	400 000.000	72 891	72.8
2458	2nd Sta	9 053 796.312	400 000.000	72 891	72.8
2459	2nd Sta	9 053 800.464	400 000.000	72 891	72.8
2460	2nd Sta	9 053 804.616	400 000.000	72 891	72.8
2461	2nd Sta	9 053 808.768	400 000.000	72 891	72.8
2462	2nd Sta	9 053 812.920	400 000.000	72 891	72.8
2463	2nd Sta	9 053 817.072	400 000.000	72 891	72.8
2464	2nd Sta	9 053 821.224	400 000.000	72 891	72.8
2465	2nd Sta	9 053 825.376	400 000.000	72 891	72.8
2466	2nd Sta	9 053 829.528	400 000.000	72 891	72.8
2467	2nd Sta	9 053 833.680	400 000.000	72 891	72.8
2468	2nd Sta	9 053 837.832	400 000.000	72 891	72.8
2469	2nd Sta	9 053 841.984	400 000.000	72 891	72.8
2470	2nd Sta	9 053 846.136	400 000.000	72 891	72.8
2471	2nd Sta	9 053 850.288	400 000.000	72 891	72.8
2472	2nd Sta	9 053 854.440	400 000.000	72 891	72.8
2473	2nd Sta	9 053 858.592	400 000.000	72 891	72.8
2474	2nd Sta	9 053 862.744	400 000.000	72 891	72.8
2475	2nd Sta	9 053 866.896	400 000.000	72 891	72.8
2476	2nd Sta	9 053 871.048	400 000.000	72 891	72.8
2477	2nd Sta	9 053 875.200	400 000.000	72 891	72.8
2478	2nd Sta	9 053 879.352	400 000.000	72 891	72.8
2479	2nd Sta	9 053 883.504	400 000.000	72 891	72.8
2480	2nd Sta	9 053 887.656	400 000.000	72 891	72.8
2481	2nd Sta	9 053 891.808	400 000.000	72 891	72.8
2482	2nd Sta	9 053 895.960	400 000.000	72 891	72.8
2483	2nd Sta	9 053 900.112	400 000.000	72 891	72.8
2484	2nd Sta	9 053 904.264	400 000.000	72 891	72.8
2485	2nd Sta	9 053 908.416	400 000.000	72 891	72.8
2486	2nd Sta	9 053 912.568	400 000.000	72 891	72.8
2487	2nd Sta	9 053 916.720	400 000.000	72 891	72.8
2488	2nd Sta	9 053 920.872	400 000.000	72 891	72.8
2489	2nd Sta	9 053 925.024	400 000.000	72 891	72.8
2490	2nd Sta	9 053 929.176	400 000.000	72 891	72.8
2491	2nd Sta	9 053 933.328	400 000.000	72 891	72.8
2492	2nd Sta	9 053 937.480	400 000.000	72 891	72.8
2493	2nd Sta	9 053 941.632	400 000.000	72 891	72.8
2494	2nd Sta	9 053 945.784	400 000.000	72 891	72.8
2495	2nd Sta	9 053 949.936	400 000.000	72 891	72.8
2496	2nd Sta	9 053 954.088	400 000.000	72 891	72.8
2497	2nd Sta	9 053 958.240	400 000.000	72 891	72.8
2498	2nd Sta	9 053 962.392	400 000.000	72 891	72.8
2499	2nd Sta	9 053 966.544	400 000.000	72 891	72.8
2500	2nd Sta	9 053 970.696	400 000.000	72 891	72.8

STATION	SLOPE		NORTHING	EASTING	STATION ELEV.	GROUND ELEV.
	TO	FROM				
3264	From top of 3264	4.055 845 6	821 244	695 82		695 8
3265	From top of 3264	4.055 830 06	821 674	696 27		696 2
3310	From top of 3264	4.055 816 06	822 004	696 72		696 7
3312	From top of 3264	4.055 847 12	822 882	697		696 5
3313	From top of 3264	4.055 827 18	823 212	697 44		697 4
3307	From top of 3264	4.055 830 00	822 109	697 28		697 3
3314	From top of 3264	4.055 848 18	823 562	697 88		697 8
3315	From top of 3264	4.055 832 06	823 892	698 33		698 3
3316	From top of 3264	4.055 845 18	824 222	698 78		698 8
3317	From top of 3264	4.055 838 06	824 552	699 23		699 2
3318	From top of 3264	4.055 851 18	824 882	699 68		699 7
3319	From top of 3264	4.055 864 30	825 212	700 13		700 1
3320	From top of 3264	4.055 877 42	825 542	700 58		700 6
3321	From top of 3264	4.055 890 54	825 872	701 03		701 0
3322	From top of 3264	4.055 903 06	826 202	701 48		701 5
3323	From top of 3264	4.055 916 18	826 532	701 93		701 9
3324	From top of 3264	4.055 929 30	826 862	702 38		702 4
3325	From top of 3264	4.055 942 42	827 192	702 83		702 8
3326	From top of 3264	4.055 955 54	827 522	703 28		703 3
3327	From top of 3264	4.055 968 06	827 852	703 73		703 7
3328	From top of 3264	4.055 981 18	828 182	704 18		704 2
3329	From top of 3264	4.055 994 30	828 512	704 63		704 6
3330	From top of 3264	4.055 1007 42	828 842	705 08		705 1
3331	From top of 3264	4.055 830 78	827 146	702 62		702 6
3340	From top of 3264	4.055 843 84	827 480	702 92		702 9
3341	From top of 3264	4.055 856 96	827 814	703 22		703 2
3342	From top of 3264	4.055 870 06	828 148	703 52		703 5

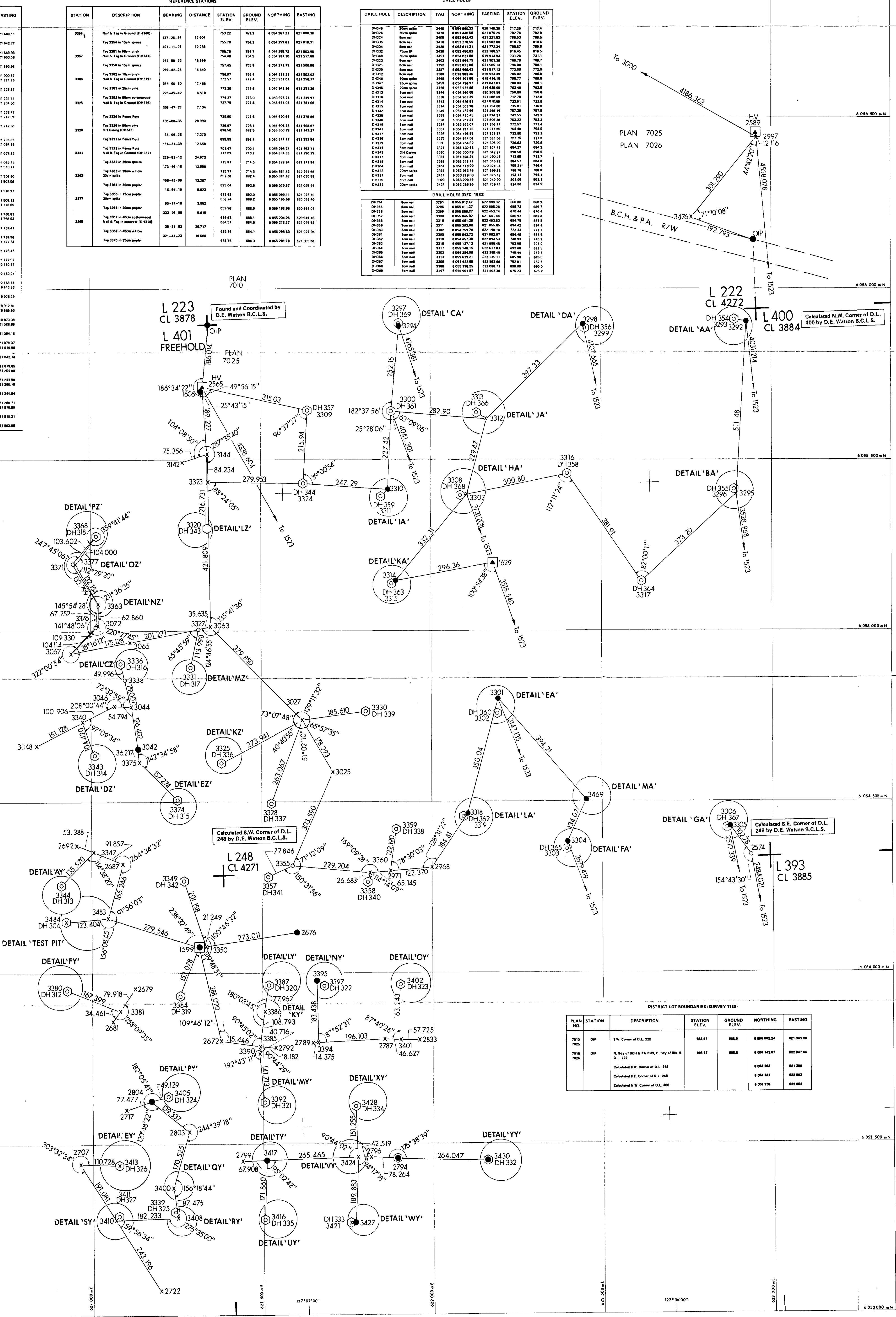

DISTRICT LOT BOUNDARIES (SURVEY TIES)						
PLAN NO.	STATION	DESCRIPTION	STATION ELEV.	GROUND ELEV.	NORTHING	EASTING
7019	QIP	S.W. Corner of D.L. 222	666.67	666.9	0.004 992.24	021 343.09
7026						
7019	QIP	N. Bay of SCH & P.W. E. Bay of Bk. S, D.L. 222	666.67	666.5	0.004 142.67	023 247.44
7026						
		Calculated S.W. Corner of D.L. 348			0.004 294	021 396
		Calculated S.E. Corner of D.L. 348			0.004 267	023 393
		Calculated N.W. Corner of D.L. 400			0.004 926	023 963

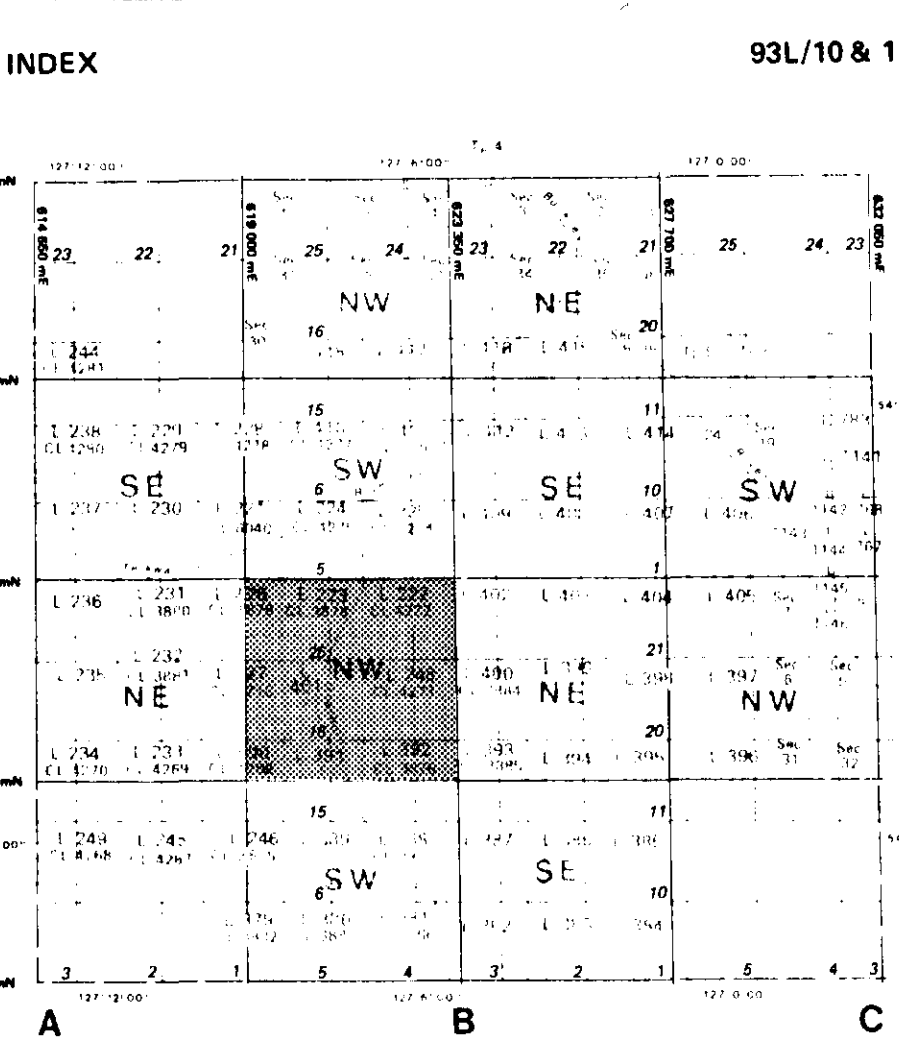

LEGEND

- | | |
|---|---|
| ○ | NAIL |
| ✕ | 20cm SPIKE |
| □ | TRENCH |
| ⬡ | DRILL HOLE |
| ⊙ | CONTROL POINT OF NETWORK |
| ● | IRON POST |
| ⊠ | 1982 PHOTO TARGET OR PHOTO
POINT MARKED WITH IRON POST |
| ◆ | COMPASS TRAVERSE POINT |

NOTES

ALL DIMENSIONS ARE NOT TO SCALE

ELEVATIONS are on Geodetic Datum and are derived by reciprocal Trigonometric levelling from bench marks 79HA 362, 364, 366, 369, 372, and 244A

CO-ORDINATES are on UTM (Zone 9) grid and are derived from Government Stations "AMIGO", "BLITZEN", "BULKLEY", "CREEK", "MUCHO", "PABLO", "P. CON. 18", "POWER", & "TACK"

LOT LINES APPROXIMATE ONLY

N.B. — SEE SHEET TW2V5 FOR SURVEY DATA PRIOR TO 1983.

 **IK-TELKWA 93(2)A**
Crows Nest Resources Limited
EXPLORATION

WEST CENTRAL, B.C. 23
TELKWA

TRAVERSE SURVEY MAP
(DECEMBER 1982)

SEE DRAWING No.TW2V14A FOR DETAILS

93L/11 SHEET
U.T.M.

D.E. WATSON B.C.L.S.	SCALE: 1:5 000	DRAWN BY:
83-02	REVISED: 84-02	DATE: 11-1-84

DRAWING No: 1	
---------------	--
