

**CONFIDENTIAL**  
SUMMARY REPORT - 1988 EXPLORATION  
APPENDIX 2 AND 3  
*Petrographic Analyses*

750

# Vitrinite Reflectance

FORDING COAL LIMITED  
Sample PG-88-153

Compo 440  
RHH 2097

## BASIC STATISTICS

|                                      |        |
|--------------------------------------|--------|
| Total Number of Observations.....    | 100    |
| Mean Maximum Reflectance (Romax)...% | 1.31   |
| Standard Error of the Mean.....      | .01    |
| Coefficient of Variation.....%       | 6.36   |
| Variance.....                        | .0069  |
| Standard Deviation.....              | .0833  |
| Skewness.....                        | .1940  |
| Kurtosis.....                        | 2.9278 |

## CELL STATISTICS

| Cell Number | Lower Limit | Number of Observations | Frequency (%) |
|-------------|-------------|------------------------|---------------|
| 4           | 1.10        | 3                      | 3.00          |
| 5           | 1.15        | 5                      | 5.00          |
| 6           | 1.20        | 16                     | 16.00         |
| 7           | 1.25        | 20                     | 20.00         |
| 8           | 1.30        | 22                     | 22.00         |
| 9           | 1.35        | 18                     | 18.00         |
| 10          | 1.40        | 12                     | 12.00         |
| 11          | 1.45        | 2                      | 2.00          |
| 12          | 1.50        | 2                      | 2.00          |

## VITRINITE TYPE DISTRIBUTION

| Vitrinite Type | Frequency (%) |
|----------------|---------------|
| V11            | 8.00          |
| V12            | 36.00         |
| V13            | 40.00         |
| V14            | 14.00         |
| V15            | 2.00          |

**OPEN FILE**

FORDING COAL LIMITED  
Sample PG-88-044

Compd 47

RH # 2128

### BASIC STATISTICS

|                                      |        |
|--------------------------------------|--------|
| Total Number of Observations.....    | 100    |
| Mean Maximum Reflectance (Romax)...% | 1.03   |
| Standard Error of the Mean.....      | 0.00   |
| Coefficient of Variation.....%       | 4.56   |
| Variance.....                        | .0022  |
| Standard Deviation.....              | .0469  |
| Skewness.....                        | -.0594 |
| Kurtosis.....                        | 3.3863 |

### CELL STATISTICS

| Cell Number | Lower Limit | Number of Observations | Frequency (%) |
|-------------|-------------|------------------------|---------------|
| 3           | 0.85        | 1                      | 1.00          |
| 4           | 0.90        | 2                      | 2.00          |
| 5           | 0.95        | 23                     | 23.00         |
| 6           | 1.00        | 36                     | 36.00         |
| 7           | 1.05        | 33                     | 33.00         |
| 8           | 1.10        | 4                      | 4.00          |
| 9           | 1.15        | 1                      | 1.00          |

### VITRINITE TYPE DISTRIBUTION

| Vitrinite Type | Frequency (%) |
|----------------|---------------|
| V8             | 1.00          |
| V9             | 25.00         |
| V10            | 69.00         |
| V11            | 5.00          |

FORDING COAL LIMITED  
Sample PG-88-045

Compo 48  
RH 2128

### BASIC STATISTICS

|                                      |        |
|--------------------------------------|--------|
| Total Number of Observations.....    | 100    |
| Mean Maximum Reflectance (Romax)...% | 1.06   |
| Standard Error of the Mean.....      | 0.00   |
| Coefficient of Variation.....%       | 4.06   |
| Variance.....                        | .0018  |
| Standard Deviation.....              | .0429  |
| Skewness.....                        | -.2075 |
| Kurtosis.....                        | 2.3050 |

### CELL STATISTICS

| Cell Number | Lower Limit | Number of Observations | Frequency (%) |
|-------------|-------------|------------------------|---------------|
| 3           | 0.95        | 8                      | 8.00          |
| 4           | 1.00        | 31                     | 31.00         |
| 5           | 1.05        | 41                     | 41.00         |
| 6           | 1.10        | 19                     | 19.00         |
| 7           | 1.15        | 1                      | 1.00          |

### VITRINITE TYPE DISTRIBUTION

| Vitrinite Type | Frequency (%) |
|----------------|---------------|
| V9             | 8.00          |
| V10            | 72.00         |
| V11            | 20.00         |

FORDING COAL LIMITED  
Sample PG-88-063

Compo 150

RH 2129

### BASIC STATISTICS

|                                           |        |
|-------------------------------------------|--------|
| Total Number of Observations.....         | 100    |
| Observations Selected for Statistics..... | 71     |
| Mean Maximum Reflectance (Romax)...%      | 1.18   |
| Standard Error of the Mean.....           | .01    |
| Coefficient of Variation.....%            | 5.04   |
| Variance.....                             | .0035  |
| Standard Deviation.....                   | .0596  |
| Skewness.....                             | .4318  |
| Kurtosis.....                             | 2.6141 |

### CELL STATISTICS

| Cell Number | Lower Limit | Number of Observations | Frequency (%) |
|-------------|-------------|------------------------|---------------|
| 1           | 1.05        | 3                      | 4.23          |
| 2           | 1.10        | 20                     | 28.17         |
| 3           | 1.15        | 21                     | 29.58         |
| 4           | 1.20        | 17                     | 23.94         |
| 5           | 1.25        | 7                      | 9.86          |
| 6           | 1.30        | 3                      | 4.23          |

### VITRINITE TYPE DISTRIBUTION

| Vitrinite Type | Frequency (%) |
|----------------|---------------|
| V10            | 8.45          |
| V11            | 57.75         |
| V12            | 33.80         |
| V13            | 4.23          |

FORDING COAL LIMITED  
Sample PG-88-064

Compo 151

RH #2129

### BASIC STATISTICS

|                                                  |        |
|--------------------------------------------------|--------|
| Total Number of Observations.....                | 100    |
| Mean Maximum Reflectance (R <sub>max</sub> )...% | 1.13   |
| Standard Error of the Mean.....                  | .02    |
| Coefficient of Variation.....%                   | 18.45  |
| Variance.....                                    | .0435  |
| Standard Deviation.....                          | .2085  |
| Skewness.....                                    | -.0485 |
| Kurtosis.....                                    | 1.3840 |

### CELL STATISTICS

| Cell Number | Lower Limit | Number of Observations | Frequency (%) |
|-------------|-------------|------------------------|---------------|
| 6           | 0.75        | 1                      | 1.00          |
| 7           | 0.80        | 4                      | 4.00          |
| 8           | 0.85        | 10                     | 10.00         |
| 9           | 0.90        | 13                     | 13.00         |
| 10          | 0.95        | 11                     | 11.00         |
| 11          | 1.00        | 7                      | 7.00          |
| 12          | 1.05        | 3                      | 3.00          |
| 13          | 1.10        | 1                      | 1.00          |
| 15          | 1.20        | 3                      | 3.00          |
| 16          | 1.25        | 14                     | 14.00         |
| 17          | 1.30        | 17                     | 17.00         |
| 18          | 1.35        | 11                     | 11.00         |
| 19          | 1.40        | 3                      | 3.00          |
| 20          | 1.45        | 2                      | 2.00          |

### VITRINITE TYPE DISTRIBUTION

| Vitrinite Type | Frequency (%) |
|----------------|---------------|
| V7             | 1.00          |
| V8             | 14.00         |
| V9             | 24.00         |
| V10            | 10.00         |
| V11            | 1.00          |
| V12            | 17.00         |
| V13            | 28.00         |
| V14            | 5.00          |

FORDING COAL LIMITED  
Sample PG-88-041

Compo 43

RH = 2130

### BASIC STATISTICS

|                                      |        |
|--------------------------------------|--------|
| Total Number of Observations.....    | 100    |
| Mean Maximum Reflectance (Romax)...% | 1.00   |
| Standard Error of the Mean.....      | 0.00   |
| Coefficient of Variation.....%       | 3.84   |
| Variance.....                        | .0015  |
| Standard Deviation.....              | .0385  |
| Skewness.....                        | -.0157 |
| Kurtosis.....                        | 2.5955 |

### CELL STATISTICS

| Cell Number | Lower Limit | Number of Observations | Frequency (%) |
|-------------|-------------|------------------------|---------------|
| 2           | 0.90        | 6                      | 6.00          |
| 3           | 0.95        | 37                     | 37.00         |
| 4           | 1.00        | 42                     | 42.00         |
| 5           | 1.05        | 15                     | 15.00         |

### VITRINITE TYPE DISTRIBUTION

| Vitrinite Type | Frequency (%) |
|----------------|---------------|
| V9             | 43.00         |
| V10            | 57.00         |

Vitrinite

FORDING COAL LIMITED  
Sample PG-88-042

Comp 45

RH → 2130

### BASIC STATISTICS

|                                      |        |
|--------------------------------------|--------|
| Total Number of Observations.....    | 100    |
| Mean Maximum Reflectance (Romax)...% | 1.09   |
| Standard Error of the Mean.....      | .01    |
| Coefficient of Variation.....%       | 5.41   |
| Variance.....                        | .0035  |
| Standard Deviation.....              | .0592  |
| Skewness.....                        | -.0747 |
| Kurtosis.....                        | 3.8064 |

### CELL STATISTICS

| Cell Number | Lower Limit | Number of Observations | Frequency (%) |
|-------------|-------------|------------------------|---------------|
| 4           | 0.90        | 1                      | 1.00          |
| 5           | 0.95        | 4                      | 4.00          |
| 6           | 1.00        | 14                     | 14.00         |
| 7           | 1.05        | 31                     | 31.00         |
| 8           | 1.10        | 31                     | 31.00         |
| 9           | 1.15        | 16                     | 16.00         |
| 10          | 1.20        | 2                      | 2.00          |
| 11          | 1.25        | 1                      | 1.00          |

### VITRINITE TYPE DISTRIBUTION

| Vitrinite Type | Frequency (%) |
|----------------|---------------|
| V9             | 5.00          |
| V10            | 45.00         |
| V11            | 47.00         |
| V12            | 3.00          |



FORDING COAL LIMITED  
Sample PG-88-043

Compo 46  
RH # 2130

### BASIC STATISTICS

|                                      |        |
|--------------------------------------|--------|
| Total Number of Observations.....    | 100    |
| Mean Maximum Reflectance (Romax)...% | 1.19   |
| Standard Error of the Mean.....      | .01    |
| Coefficient of Variation.....%       | 5.20   |
| Variance.....                        | .0038  |
| Standard Deviation.....              | .0618  |
| Skewness.....                        | -.4148 |
| Kurtosis.....                        | 2.8653 |

### CELL STATISTICS

| Cell Number | Lower Limit | Number of Observations | Frequency (%) |
|-------------|-------------|------------------------|---------------|
| 3           | 1.00        | 2                      | 2.00          |
| 4           | 1.05        | 7                      | 7.00          |
| 5           | 1.10        | 14                     | 14.00         |
| 6           | 1.15        | 27                     | 27.00         |
| 7           | 1.20        | 31                     | 31.00         |
| 8           | 1.25        | 16                     | 16.00         |
| 9           | 1.30        | 3                      | 3.00          |

### VITRINITE TYPE DISTRIBUTION

| Vitrinite Type | Frequency (%) |
|----------------|---------------|
| V10            | 9.00          |
| V11            | 41.00         |
| V12            | 47.00         |
| V13            | 3.00          |

FORDING COAL LIMITED  
Sample PG-88-024

Comp 10

RH # 2131

### BASIC STATISTICS

|                                      |        |
|--------------------------------------|--------|
| Total Number of Observations.....    | 100    |
| Mean Maximum Reflectance (Romax)...% | .90    |
| Standard Error of the Mean.....      | .01    |
| Coefficient of Variation.....%       | 5.67   |
| Variance.....                        | .0026  |
| Standard Deviation.....              | .0508  |
| Skewness.....                        | .5046  |
| Kurtosis.....                        | 3.1493 |

### CELL STATISTICS

| Cell Number | Lower Limit | Number of Observations | Frequency (%) |
|-------------|-------------|------------------------|---------------|
| 3           | 0.75        | 1                      | 1.00          |
| 4           | 0.80        | 9                      | 9.00          |
| 5           | 0.85        | 46                     | 46.00         |
| 6           | 0.90        | 26                     | 26.00         |
| 7           | 0.95        | 14                     | 14.00         |
| 8           | 1.00        | 4                      | 4.00          |

### VITRINITE TYPE DISTRIBUTION

| Vitrinite Type | Frequency (%) |
|----------------|---------------|
| V7             | 1.00          |
| V8             | 55.00         |
| V9             | 40.00         |
| V10            | 4.00          |

FORDING COAL LIMITED  
Sample PG-88-025

Compo 12

Q1 # 2131

### BASIC STATISTICS

|                                      |        |
|--------------------------------------|--------|
| Total Number of Observations.....    | 100    |
| Mean Maximum Reflectance (Romax)...% | .91    |
| Standard Error of the Mean.....      | .01    |
| Coefficient of Variation.....%       | 5.81   |
| Variance.....                        | .0028  |
| Standard Deviation.....              | .0530  |
| Skewness.....                        | -.0104 |
| Kurtosis.....                        | 3.6309 |

### CELL STATISTICS

| Cell Number | Lower Limit | Number of Observations | Frequency (%) |
|-------------|-------------|------------------------|---------------|
| 3           | 0.75        | 3                      | 3.00          |
| 4           | 0.80        | 7                      | 7.00          |
| 5           | 0.85        | 27                     | 27.00         |
| 6           | 0.90        | 39                     | 39.00         |
| 7           | 0.95        | 19                     | 19.00         |
| 8           | 1.00        | 4                      | 4.00          |
| 9           | 1.05        | 1                      | 1.00          |

### VITRINITE TYPE DISTRIBUTION

| Vitrinite Type | Frequency (%) |
|----------------|---------------|
| V7             | 3.00          |
| V8             | 34.00         |
| V9             | 58.00         |
| V10            | 5.00          |

Vitrinite Reflectance

**FORDING COAL LIMITED**  
 Sample PG-88-026

Comp 15

RH = 2131

**BASIC STATISTICS**

|                                      |        |
|--------------------------------------|--------|
| Total Number of Observations.....    | 100    |
| Mean Maximum Reflectance (Romax)...% | 1.01   |
| Standard Error of the Mean.....      | .01    |
| Coefficient of Variation.....%       | 4.95   |
| Variance.....                        | .0025  |
| Standard Deviation.....              | .0502  |
| Skewness.....                        | .4554  |
| Kurtosis.....                        | 2.7277 |

**CELL STATISTICS**

| Cell Number | Lower Limit | Number of Observations | Frequency (%) |
|-------------|-------------|------------------------|---------------|
| 3           | 0.90        | 8                      | 8.00          |
| 4           | 0.95        | 32                     | 32.00         |
| 5           | 1.00        | 31                     | 31.00         |
| 6           | 1.05        | 23                     | 23.00         |
| 7           | 1.10        | 6                      | 6.00          |

**VITRINITE TYPE DISTRIBUTION**

| Vitrinite Type | Frequency (%) |
|----------------|---------------|
| V9             | 40.00         |
| V10            | 54.00         |
| V11            | 6.00          |

FORDING COAL LIMITED  
Sample PG-88-027

Comp 18  
RH 2131

### BASIC STATISTICS

|                                      |        |
|--------------------------------------|--------|
| Total Number of Observations.....    | 100    |
| Mean Maximum Reflectance (Romax)...% | 1.10   |
| Standard Error of the Mean.....      | .01    |
| Coefficient of Variation.....%       | 4.60   |
| Variance.....                        | .0026  |
| Standard Deviation.....              | .0508  |
| Skewness.....                        | -.2114 |
| Kurtosis.....                        | 3.0155 |

### CELL STATISTICS

| Cell Number | Lower Limit | Number of Observations | Frequency (%) |
|-------------|-------------|------------------------|---------------|
| 3           | 0.95        | 1                      | 1.00          |
| 4           | 1.00        | 11                     | 11.00         |
| 5           | 1.05        | 31                     | 31.00         |
| 6           | 1.10        | 37                     | 37.00         |
| 7           | 1.15        | 17                     | 17.00         |
| 8           | 1.20        | 3                      | 3.00          |

### VITRINITE TYPE DISTRIBUTION

| Vitrinite Type | Frequency (%) |
|----------------|---------------|
| V9             | 1.00          |
| V10            | 42.00         |
| V11            | 54.00         |
| V12            | 3.00          |

FORDING COAL LIMITED  
Sample PG-88-028

Compo 19

RH → 2131

### BASIC STATISTICS

|                                      |        |
|--------------------------------------|--------|
| Total Number of Observations.....    | 100    |
| Mean Maximum Reflectance (Romax)...% | 1.16   |
| Standard Error of the Mean.....      | .01    |
| Coefficient of Variation.....%       | 4.50   |
| Variance.....                        | .0027  |
| Standard Deviation.....              | .0522  |
| Skewness.....                        | .0550  |
| Kurtosis.....                        | 4.2818 |

### CELL STATISTICS

| Cell Number | Lower Limit | Number of Observations | Frequency (%) |
|-------------|-------------|------------------------|---------------|
| 3           | 1.00        | 2                      | 2.00          |
| 4           | 1.05        | 9                      | 9.00          |
| 5           | 1.10        | 19                     | 19.00         |
| 6           | 1.15        | 48                     | 48.00         |
| 7           | 1.20        | 17                     | 17.00         |
| 8           | 1.25        | 4                      | 4.00          |
| 9           | 1.30        | 1                      | 1.00          |

### VITRINITE TYPE DISTRIBUTION

| Vitrinite Type | Frequency (%) |
|----------------|---------------|
| V10            | 11.00         |
| V11            | 67.00         |
| V12            | 21.00         |
| V13            | 1.00          |

Vitrinite Reflections

FORDING COAL LIMITED  
Sample PG-88-029

Compo 21

RH # 2131

**BASIC STATISTICS**

|                                      |        |
|--------------------------------------|--------|
| Total Number of Observations.....    | 100    |
| Mean Maximum Reflectance (Romax)...% | 1.17   |
| Standard Error of the Mean.....      | .01    |
| Coefficient of Variation.....%       | 5.87   |
| Variance.....                        | .0047  |
| Standard Deviation.....              | .0688  |
| Skewness.....                        | .2229  |
| Kurtosis.....                        | 2.8034 |

**CELL STATISTICS**

| Cell Number | Lower Limit | Number of Observations | Frequency (%) |
|-------------|-------------|------------------------|---------------|
| 3           | 1.00        | 3                      | 3.00          |
| 4           | 1.05        | 11                     | 11.00         |
| 5           | 1.10        | 20                     | 20.00         |
| 6           | 1.15        | 31                     | 31.00         |
| 7           | 1.20        | 19                     | 19.00         |
| 8           | 1.25        | 11                     | 11.00         |
| 9           | 1.30        | 5                      | 5.00          |

**VITRINITE TYPE DISTRIBUTION**

| Vitrinite Type | Frequency (%) |
|----------------|---------------|
| V10            | 14.00         |
| V11            | 51.00         |
| V12            | 30.00         |
| V13            | 5.00          |

FORDING COAL LIMITED  
Sample PG-88-019

Compo 1

RH 2132

### BASIC STATISTICS

|                                      |        |
|--------------------------------------|--------|
| Total Number of Observations.....    | 100    |
| Mean Maximum Reflectance (Romax)...% | .93    |
| Standard Error of the Mean.....      | .01    |
| Coefficient of Variation.....%       | 5.49   |
| Variance.....                        | .0026  |
| Standard Deviation.....              | .0509  |
| Skewness.....                        | -.1618 |
| Kurtosis.....                        | 3.4584 |

### CELL STATISTICS

| Cell Number | Lower Limit | Number of Observations | Frequency (%) |
|-------------|-------------|------------------------|---------------|
| 3           | 0.75        | 1                      | 1.00          |
| 4           | 0.80        | 4                      | 4.00          |
| 5           | 0.85        | 21                     | 21.00         |
| 6           | 0.90        | 39                     | 39.00         |
| 7           | 0.95        | 25                     | 25.00         |
| 8           | 1.00        | 9                      | 9.00          |
| 9           | 1.05        | 1                      | 1.00          |

### VITRINITE TYPE DISTRIBUTION

| Vitrinite Type | Frequency (%) |
|----------------|---------------|
| V7             | 1.00          |
| V8             | 25.00         |
| V9             | 64.00         |
| V10            | 10.00         |



FORDING COAL LIMITED  
Sample PG-88-020

Compo 4  
RH # 2132

### BASIC STATISTICS

|                                      |        |
|--------------------------------------|--------|
| Total Number of Observations.....    | 100    |
| Mean Maximum Reflectance (Romax)...% | 1.00   |
| Standard Error of the Mean.....      | 0.00   |
| Coefficient of Variation.....%       | 4.88   |
| Variance.....                        | .0024  |
| Standard Deviation.....              | .0488  |
| Skewness.....                        | .1831  |
| Kurtosis.....                        | 3.1681 |

### CELL STATISTICS

| Cell Number | Lower Limit | Number of Observations | Frequency (%) |
|-------------|-------------|------------------------|---------------|
| 3           | 0.85        | 2                      | 2.00          |
| 4           | 0.90        | 9                      | 9.00          |
| 5           | 0.95        | 37                     | 37.00         |
| 6           | 1.00        | 39                     | 39.00         |
| 7           | 1.05        | 9                      | 9.00          |
| 8           | 1.10        | 4                      | 4.00          |

### VITRINITE TYPE DISTRIBUTION

| Vitrinite Type | Frequency (%) |
|----------------|---------------|
| V8             | 2.00          |
| V9             | 46.00         |
| V10            | 48.00         |
| V11            | 4.00          |

FORDING COAL LIMITED  
Sample PG-88-021

Compo 6

RH # 2133

### BASIC STATISTICS

|                                      |        |
|--------------------------------------|--------|
| Total Number of Observations.....    | 100    |
| Mean Maximum Reflectance (Romax)...% | 1.14   |
| Standard Error of the Mean.....      | .01    |
| Coefficient of Variation.....%       | 4.67   |
| Variance.....                        | .0028  |
| Standard Deviation.....              | .0532  |
| Skewness.....                        | -.3204 |
| Kurtosis.....                        | 2.7962 |

### CELL STATISTICS

| Cell Number | Lower Limit | Number of Observations | Frequency (%) |
|-------------|-------------|------------------------|---------------|
| 3           | 1.00        | 7                      | 7.00          |
| 4           | 1.05        | 14                     | 14.00         |
| 5           | 1.10        | 30                     | 30.00         |
| 6           | 1.15        | 37                     | 37.00         |
| 7           | 1.20        | 11                     | 11.00         |
| 8           | 1.25        | 1                      | 1.00          |

### VITRINITE TYPE DISTRIBUTION

| Vitrinite Type | Frequency (%) |
|----------------|---------------|
| V10            | 21.00         |
| V11            | 67.00         |
| V12            | 12.00         |

FORDING COAL LIMITED  
Sample PG-88-022

Comp 8

RH # 2133

### BASIC STATISTICS

|                                      |        |
|--------------------------------------|--------|
| Total Number of Observations.....    | 100    |
| Mean Maximum Reflectance (Romax)...% | 1.14   |
| Standard Error of the Mean.....      | .01    |
| Coefficient of Variation.....%       | 4.46   |
| Variance.....                        | .0026  |
| Standard Deviation.....              | .0508  |
| Skewness.....                        | -.2071 |
| Kurtosis.....                        | 2.6830 |

### CELL STATISTICS

| Cell Number | Lower Limit | Number of Observations | Frequency (%) |
|-------------|-------------|------------------------|---------------|
| 3           | 1.00        | 2                      | 2.00          |
| 4           | 1.05        | 17                     | 17.00         |
| 5           | 1.10        | 30                     | 30.00         |
| 6           | 1.15        | 38                     | 38.00         |
| 7           | 1.20        | 12                     | 12.00         |
| 8           | 1.25        | 1                      | 1.00          |

### VITRINITE TYPE DISTRIBUTION

| Vitrinite Type | Frequency (%) |
|----------------|---------------|
| V10            | 19.00         |
| V11            | 68.00         |
| V12            | 13.00         |

FORDING COAL LIMITED  
Sample PG-88-023

Compo 9

RH = 2133

### BASIC STATISTICS

|                                      |        |
|--------------------------------------|--------|
| Total Number of Observations.....    | 100    |
| Mean Maximum Reflectance (Romax)...% | 1.25   |
| Standard Error of the Mean.....      | 0.00   |
| Coefficient of Variation.....%       | 3.67   |
| Variance.....                        | .0021  |
| Standard Deviation.....              | .0458  |
| Skewness.....                        | -.1022 |
| Kurtosis.....                        | 2.5913 |

### CELL STATISTICS

| Cell Number | Lower Limit | Number of Observations | Frequency (%) |
|-------------|-------------|------------------------|---------------|
| 3           | 1.10        | 1                      | 1.00          |
| 4           | 1.15        | 14                     | 14.00         |
| 5           | 1.20        | 32                     | 32.00         |
| 6           | 1.25        | 38                     | 38.00         |
| 7           | 1.30        | 14                     | 14.00         |
| 8           | 1.35        | 1                      | 1.00          |

### VITRINITE TYPE DISTRIBUTION

| Vitrinite Type | Frequency (%) |
|----------------|---------------|
| V11            | 15.00         |
| V12            | 70.00         |
| V13            | 15.00         |

FORDING COAL LIMITED  
Sample PG-88-037

Compo 37  
R1+ 213 F

### BASIC STATISTICS

|                                      |        |
|--------------------------------------|--------|
| Total Number of Observations.....    | 100    |
| Mean Maximum Reflectance (Romax)...% | 1.02   |
| Standard Error of the Mean.....      | .01    |
| Coefficient of Variation.....%       | 5.46   |
| Variance.....                        | .0031  |
| Standard Deviation.....              | .0554  |
| Skewness.....                        | .4956  |
| Kurtosis.....                        | 3.6725 |

### CELL STATISTICS

| Cell Number | Lower Limit | Number of Observations | Frequency (%) |
|-------------|-------------|------------------------|---------------|
| 3           | 0.85        | 1                      | 1.00          |
| 4           | 0.90        | 8                      | 8.00          |
| 5           | 0.95        | 31                     | 31.00         |
| 6           | 1.00        | 34                     | 34.00         |
| 7           | 1.05        | 18                     | 18.00         |
| 8           | 1.10        | 6                      | 6.00          |
| 9           | 1.15        | 2                      | 2.00          |

### VITRINITE TYPE DISTRIBUTION

| Vitrinite Type | Frequency (%) |
|----------------|---------------|
| V8             | 1.00          |
| V9             | 39.00         |
| V10            | 52.00         |
| V11            | 8.00          |

FORDING COAL LIMITED  
Sample PG-88-038

RH 2134  
Cmpo 39

### BASIC STATISTICS

|                                      |        |
|--------------------------------------|--------|
| Total Number of Observations.....    | 100    |
| Mean Maximum Reflectance (Romax)...% | 1.12   |
| Standard Error of the Mean.....      | .01    |
| Coefficient of Variation.....%       | 5.61   |
| Variance.....                        | .0039  |
| Standard Deviation.....              | .0627  |
| Skewness.....                        | -.1096 |
| Kurtosis.....                        | 2.8255 |

### CELL STATISTICS

| Cell Number | Lower Limit | Number of Observations | Frequency (%) |
|-------------|-------------|------------------------|---------------|
| 3           | 0.95        | 2                      | 2.00          |
| 4           | 1.00        | 11                     | 11.00         |
| 5           | 1.05        | 18                     | 18.00         |
| 6           | 1.10        | 35                     | 35.00         |
| 7           | 1.15        | 24                     | 24.00         |
| 8           | 1.20        | 7                      | 7.00          |
| 9           | 1.25        | 3                      | 3.00          |

### VITRINITE TYPE DISTRIBUTION

| Vitrinite Type | Frequency (%) |
|----------------|---------------|
| V9             | 2.00          |
| V10            | 29.00         |
| V11            | 59.00         |
| V12            | 10.00         |

FORDING COAL LIMITED  
Sample PG-88-039

Compo 40

RH 2134

### BASIC STATISTICS

|                                      |        |
|--------------------------------------|--------|
| Total Number of Observations.....    | 100    |
| Mean Maximum Reflectance (Romax)...% | 1.12   |
| Standard Error of the Mean.....      | .01    |
| Coefficient of Variation.....%       | 5.34   |
| Variance.....                        | .0036  |
| Standard Deviation.....              | .0600  |
| Skewness.....                        | -.0305 |
| Kurtosis.....                        | 3.1298 |

### CELL STATISTICS

| Cell Number | Lower Limit | Number of Observations | Frequency (%) |
|-------------|-------------|------------------------|---------------|
| 3           | 0.95        | 2                      | 2.00          |
| 4           | 1.00        | 6                      | 6.00          |
| 5           | 1.05        | 24                     | 24.00         |
| 6           | 1.10        | 33                     | 33.00         |
| 7           | 1.15        | 25                     | 25.00         |
| 8           | 1.20        | 9                      | 9.00          |
| 9           | 1.25        | 1                      | 1.00          |

### VITRINITE TYPE DISTRIBUTION

| Vitrinite Type | Frequency (%) |
|----------------|---------------|
| V9             | 2.00          |
| V10            | 30.00         |
| V11            | 58.00         |
| V12            | 10.00         |

Vitrinite

FORDING COAL LIMITED  
Sample PG-88-040

Compo 41  
RH #2134

### BASIC STATISTICS

|                                      |        |
|--------------------------------------|--------|
| Total Number of Observations.....    | 100    |
| Mean Maximum Reflectance (Romax)...% | 1.13   |
| Standard Error of the Mean.....      | .01    |
| Coefficient of Variation.....%       | 4.50   |
| Variance.....                        | .0026  |
| Standard Deviation.....              | .0511  |
| Skewness.....                        | -.2831 |
| Kurtosis.....                        | 2.6865 |

### CELL STATISTICS

| Cell Number | Lower Limit | Number of Observations | Frequency (%) |
|-------------|-------------|------------------------|---------------|
| 3           | 1.00        | 5                      | 5.00          |
| 4           | 1.05        | 16                     | 16.00         |
| 5           | 1.10        | 36                     | 36.00         |
| 6           | 1.15        | 32                     | 32.00         |
| 7           | 1.20        | 11                     | 11.00         |

### VITRINITE TYPE DISTRIBUTION

| Vitrinite Type | Frequency (%) |
|----------------|---------------|
| V10            | 21.00         |
| V11            | 68.00         |
| V12            | 11.00         |



FORDING COAL LIMITED  
Sample PG-88-046

Compo 49  
RH 2135

### BASIC STATISTICS

|                                      |        |
|--------------------------------------|--------|
| Total Number of Observations.....    | 100    |
| Mean Maximum Reflectance (Romax)...% | 1.13   |
| Standard Error of the Mean.....      | .01    |
| Coefficient of Variation.....%       | 5.61   |
| Variance.....                        | .0040  |
| Standard Deviation.....              | .0635  |
| Skewness.....                        | .0893  |
| Kurtosis.....                        | 3.7800 |

### CELL STATISTICS

| Cell Number | Lower Limit | Number of Observations | Frequency (%) |
|-------------|-------------|------------------------|---------------|
| 4           | 0.95        | 2                      | 2.00          |
| 5           | 1.00        | 5                      | 5.00          |
| 6           | 1.05        | 19                     | 19.00         |
| 7           | 1.10        | 35                     | 35.00         |
| 8           | 1.15        | 25                     | 25.00         |
| 9           | 1.20        | 10                     | 10.00         |
| 10          | 1.25        | 3                      | 3.00          |
| 11          | 1.30        | 1                      | 1.00          |

### VITRINITE TYPE DISTRIBUTION

| Vitrinite Type | Frequency (%) |
|----------------|---------------|
| V9             | 2.00          |
| V10            | 24.00         |
| V11            | 60.00         |
| V12            | 13.00         |
| V13            | 1.00          |

FORDING COAL LIMITED  
Sample PG-88-047

Compo 50

RH 2135

### BASIC STATISTICS

|                                      |        |
|--------------------------------------|--------|
| Total Number of Observations.....    | 100    |
| Mean Maximum Reflectance (Romax)...% | 1.18   |
| Standard Error of the Mean.....      | 0.00   |
| Coefficient of Variation.....%       | 4.21   |
| Variance.....                        | .0025  |
| Standard Deviation.....              | .0495  |
| Skewness.....                        | -.3232 |
| Kurtosis.....                        | 3.5998 |

### CELL STATISTICS

| Cell Number | Lower Limit | Number of Observations | Frequency (%) |
|-------------|-------------|------------------------|---------------|
| 3           | 1.00        | 1                      | 1.00          |
| 4           | 1.05        | 2                      | 2.00          |
| 5           | 1.10        | 23                     | 23.00         |
| 6           | 1.15        | 35                     | 35.00         |
| 7           | 1.20        | 32                     | 32.00         |
| 8           | 1.25        | 6                      | 6.00          |
| 9           | 1.30        | 1                      | 1.00          |

### VITRINITE TYPE DISTRIBUTION

| Vitrinite Type | Frequency (%) |
|----------------|---------------|
| V10            | 3.00          |
| V11            | 58.00         |
| V12            | 38.00         |
| V13            | 1.00          |

FORDING COAL LIMITED  
Sample PG-88-048

Compo 51  
RIT 2135

### BASIC STATISTICS

|                                      |        |
|--------------------------------------|--------|
| Total Number of Observations.....    | 100    |
| Mean Maximum Reflectance (Romax)...% | 1.20   |
| Standard Error of the Mean.....      | .01    |
| Coefficient of Variation.....%       | 4.87   |
| Variance.....                        | .0034  |
| Standard Deviation.....              | .0584  |
| Skewness.....                        | -.2015 |
| Kurtosis.....                        | 2.8816 |

### CELL STATISTICS

| Cell Number | Lower Limit | Number of Observations | Frequency (%) |
|-------------|-------------|------------------------|---------------|
| 3           | 1.05        | 5                      | 5.00          |
| 4           | 1.10        | 13                     | 13.00         |
| 5           | 1.15        | 31                     | 31.00         |
| 6           | 1.20        | 31                     | 31.00         |
| 7           | 1.25        | 16                     | 16.00         |
| 8           | 1.30        | 4                      | 4.00          |

### VITRINITE TYPE DISTRIBUTION

| Vitrinite Type | Frequency (%) |
|----------------|---------------|
| V10            | 5.00          |
| V11            | 44.00         |
| V12            | 47.00         |
| V13            | 4.00          |

FORDING COAL LIMITED  
Sample PG-88-049

Compo 52

RH 2135

### BASIC STATISTICS

|                                      |        |
|--------------------------------------|--------|
| Total Number of Observations.....    | 100    |
| Mean Maximum Reflectance (Romax)...% | 1.21   |
| Standard Error of the Mean.....      | 0.00   |
| Coefficient of Variation.....%       | 3.56   |
| Variance.....                        | .0019  |
| Standard Deviation.....              | .0432  |
| Skewness.....                        | -.1442 |
| Kurtosis.....                        | 2.8788 |

### CELL STATISTICS

| Cell Number | Lower Limit | Number of Observations | Frequency (%) |
|-------------|-------------|------------------------|---------------|
| 3           | 1.10        | 5                      | 5.00          |
| 4           | 1.15        | 32                     | 32.00         |
| 5           | 1.20        | 33                     | 33.00         |
| 6           | 1.25        | 25                     | 25.00         |
| 7           | 1.30        | 5                      | 5.00          |

### VITRINITE TYPE DISTRIBUTION

| Vitrinite Type | Frequency (%) |
|----------------|---------------|
| V11            | 37.00         |
| V12            | 58.00         |
| V13            | 5.00          |

Vertical text on the left margin, possibly a page number or reference code, appearing as a series of faint, vertically oriented characters.

FORDING COAL LIMITED  
Sample PG-88-033

Carpo 31

RH # 2136

### BASIC STATISTICS

|                                      |        |
|--------------------------------------|--------|
| Total Number of Observations.....    | 100    |
| Mean Maximum Reflectance (Romax)...% | 1.00   |
| Standard Error of the Mean.....      | .01    |
| Coefficient of Variation.....%       | 5.15   |
| Variance.....                        | .0027  |
| Standard Deviation.....              | .0517  |
| Skewness.....                        | .0087  |
| Kurtosis.....                        | 2.6855 |

### CELL STATISTICS

| Cell Number | Lower Limit | Number of Observations | Frequency (%) |
|-------------|-------------|------------------------|---------------|
| 3           | 0.85        | 2                      | 2.00          |
| 4           | 0.90        | 12                     | 12.00         |
| 5           | 0.95        | 30                     | 30.00         |
| 6           | 1.00        | 35                     | 35.00         |
| 7           | 1.05        | 18                     | 18.00         |
| 8           | 1.10        | 3                      | 3.00          |

### VITRINITE TYPE DISTRIBUTION

| Vitrinite Type | Frequency (%) |
|----------------|---------------|
| V8             | 2.00          |
| V9             | 42.00         |
| V10            | 53.00         |
| V11            | 3.00          |

Vitrinite

FORDING COAL LIMITED  
Sample PG-88-034

Compo 32

RH # 2136

**BASIC STATISTICS**

|                                      |        |
|--------------------------------------|--------|
| Total Number of Observations.....    | 100    |
| Mean Maximum Reflectance (Romax)...% | 1.00   |
| Standard Error of the Mean.....      | 0.00   |
| Coefficient of Variation.....%       | 4.92   |
| Variance.....                        | .0024  |
| Standard Deviation.....              | .0494  |
| Skewness.....                        | -.2110 |
| Kurtosis.....                        | 2.7560 |

**CELL STATISTICS**

| Cell Number | Lower Limit | Number of Observations | Frequency (%) |
|-------------|-------------|------------------------|---------------|
| 3           | 0.85        | 3                      | 3.00          |
| 4           | 0.90        | 10                     | 10.00         |
| 5           | 0.95        | 28                     | 28.00         |
| 6           | 1.00        | 39                     | 39.00         |
| 7           | 1.05        | 17                     | 17.00         |
| 8           | 1.10        | 3                      | 3.00          |

**VITRINITE TYPE DISTRIBUTION**

| Vitrinite Type | Frequency (%) |
|----------------|---------------|
| V8             | 3.00          |
| V9             | 38.00         |
| V10            | 56.00         |
| V11            | 3.00          |

W  
E  
S  
T  
E  
R  
N  
C  
O  
A  
L  
C  
O  
L  
L  
I  
E  
S  
I  
N  
C  
O  
R  
P  
O  
R  
A  
T  
I  
O  
N

FORDING COAL LIMITED  
Sample PG-88-035

Compa 33  
RH 2136

### BASIC STATISTICS

|                                      |        |
|--------------------------------------|--------|
| Total Number of Observations.....    | 100    |
| Mean Maximum Reflectance (Romax)...% | .98    |
| Standard Error of the Mean.....      | 0.00   |
| Coefficient of Variation.....%       | 4.23   |
| Variance.....                        | .0017  |
| Standard Deviation.....              | .0415  |
| Skewness.....                        | .0685  |
| Kurtosis.....                        | 3.0436 |

### CELL STATISTICS

| Cell Number | Lower Limit | Number of Observations | Frequency (%) |
|-------------|-------------|------------------------|---------------|
| 3           | 0.85        | 3                      | 3.00          |
| 4           | 0.90        | 13                     | 13.00         |
| 5           | 0.95        | 46                     | 46.00         |
| 6           | 1.00        | 31                     | 31.00         |
| 7           | 1.05        | 6                      | 6.00          |
| 8           | 1.10        | 1                      | 1.00          |

### VITRINITE TYPE DISTRIBUTION

| Vitrinite Type | Frequency (%) |
|----------------|---------------|
| V8             | 3.00          |
| V9             | 59.00         |
| V10            | 37.00         |
| V11            | 1.00          |

FORDING COAL LIMITED  
Sample PG-88-036

Compo 33

RH # 2136

### BASIC STATISTICS

|                                      |        |
|--------------------------------------|--------|
| Total Number of Observations.....    | 100    |
| Mean Maximum Reflectance (Romax)...% | 1.13   |
| Standard Error of the Mean.....      | .01    |
| Coefficient of Variation.....%       | 7.59   |
| Variance.....                        | .0074  |
| Standard Deviation.....              | .0859  |
| Skewness.....                        | -.3325 |
| Kurtosis.....                        | 2.4414 |

### CELL STATISTICS

| Cell Number | Lower Limit | Number of Observations | Frequency (%) |
|-------------|-------------|------------------------|---------------|
| 4           | 0.90        | 2                      | 2.00          |
| 5           | 0.95        | 5                      | 5.00          |
| 6           | 1.00        | 11                     | 11.00         |
| 7           | 1.05        | 15                     | 15.00         |
| 8           | 1.10        | 19                     | 19.00         |
| 9           | 1.15        | 20                     | 20.00         |
| 10          | 1.20        | 20                     | 20.00         |
| 11          | 1.25        | 7                      | 7.00          |
| 12          | 1.30        | 1                      | 1.00          |

### VITRINITE TYPE DISTRIBUTION

| Vitrinite Type | Frequency (%) |
|----------------|---------------|
| V9             | 7.00          |
| V10            | 26.00         |
| V11            | 39.00         |
| V12            | 27.00         |
| V13            | 1.00          |



FORDING COAL LIMITED  
Sample PG-88-050

Compo 53

RH 2137

### BASIC STATISTICS

|                                      |        |
|--------------------------------------|--------|
| Total Number of Observations.....    | 100    |
| Mean Maximum Reflectance (Romax)...% | 1.00   |
| Standard Error of the Mean.....      | .01    |
| Coefficient of Variation.....%       | 5.23   |
| Variance.....                        | .0028  |
| Standard Deviation.....              | .0525  |
| Skewness.....                        | .1662  |
| Kurtosis.....                        | 3.0937 |

### CELL STATISTICS

| Cell Number | Lower Limit | Number of Observations | Frequency (%) |
|-------------|-------------|------------------------|---------------|
| 3           | 0.85        | 2                      | 2.00          |
| 4           | 0.90        | 14                     | 14.00         |
| 5           | 0.95        | 29                     | 29.00         |
| 6           | 1.00        | 36                     | 36.00         |
| 7           | 1.05        | 16                     | 16.00         |
| 8           | 1.10        | 2                      | 2.00          |
| 9           | 1.15        | 1                      | 1.00          |

### VITRINITE TYPE DISTRIBUTION

| Vitrinite Type | Frequency (%) |
|----------------|---------------|
| V8             | 2.00          |
| V9             | 43.00         |
| V10            | 52.00         |
| V11            | 3.00          |

Vitrinite Reflectance

FORDING COAL LIMITED  
Sample PG-88-051

Compo 56  
RIT 2137

BASIC STATISTICS

|                                      |        |
|--------------------------------------|--------|
| Total Number of Observations.....    | 100    |
| Mean Maximum Reflectance (Romax)...% | 1.00   |
| Standard Error of the Mean.....      | 0.00   |
| Coefficient of Variation.....%       | 4.63   |
| Variance.....                        | .0021  |
| Standard Deviation.....              | .0462  |
| Skewness.....                        | .0479  |
| Kurtosis.....                        | 2.9763 |

CELL STATISTICS

| Cell Number | Lower Limit | Number of Observations | Frequency (%) |
|-------------|-------------|------------------------|---------------|
| 3           | 0.85        | 1                      | 1.00          |
| 4           | 0.90        | 12                     | 12.00         |
| 5           | 0.95        | 33                     | 33.00         |
| 6           | 1.00        | 41                     | 41.00         |
| 7           | 1.05        | 10                     | 10.00         |
| 8           | 1.10        | 3                      | 3.00          |

VITRINITE TYPE DISTRIBUTION

| Vitrinite Type | Frequency (%) |
|----------------|---------------|
| V8             | 1.00          |
| V9             | 45.00         |
| V10            | 51.00         |
| V11            | 3.00          |

FORDING COAL LIMITED  
Sample PG-88-052

Compo 58  
Rt 2137

### BASIC STATISTICS

|                                      |        |
|--------------------------------------|--------|
| Total Number of Observations.....    | 100    |
| Mean Maximum Reflectance (Romax)...% | 1.15   |
| Standard Error of the Mean.....      | .01    |
| Coefficient of Variation.....%       | 4.65   |
| Variance.....                        | .0029  |
| Standard Deviation.....              | .0537  |
| Skewness.....                        | -.4040 |
| Kurtosis.....                        | 3.0620 |

### CELL STATISTICS

| Cell Number | Lower Limit | Number of Observations | Frequency (%) |
|-------------|-------------|------------------------|---------------|
| 3           | 1.00        | 3                      | 3.00          |
| 4           | 1.05        | 9                      | 9.00          |
| 5           | 1.10        | 27                     | 27.00         |
| 6           | 1.15        | 38                     | 38.00         |
| 7           | 1.20        | 19                     | 19.00         |
| 8           | 1.25        | 4                      | 4.00          |

### VITRINITE TYPE DISTRIBUTION

| Vitrinite Type | Frequency (%) |
|----------------|---------------|
| V10            | 12.00         |
| V11            | 65.00         |
| V12            | 23.00         |

Vitrinite

FORDING COAL LIMITED  
 Sample PG-88-030  
 Compo 22  
 RH # 2138

FORDING COAL LIMITED  
Sample PG-88-030

Compo 22

RH # 2138

**BASIC STATISTICS**

|                                      |        |
|--------------------------------------|--------|
| Total Number of Observations.....    | 100    |
| Mean Maximum Reflectance (Romax)...% | .84    |
| Standard Error of the Mean.....      | .01    |
| Coefficient of Variation.....%       | 6.37   |
| Variance.....                        | .0029  |
| Standard Deviation.....              | .0537  |
| Skewness.....                        | .0061  |
| Kurtosis.....                        | 2.4000 |

**CELL STATISTICS**

| Cell Number | Lower Limit | Number of Observations | Frequency (%) |
|-------------|-------------|------------------------|---------------|
| 3           | 0.70        | 4                      | 4.00          |
| 4           | 0.75        | 12                     | 12.00         |
| 5           | 0.80        | 39                     | 39.00         |
| 6           | 0.85        | 27                     | 27.00         |
| 7           | 0.90        | 15                     | 15.00         |
| 8           | 0.95        | 3                      | 3.00          |

**VITRINITE TYPE DISTRIBUTION**

| Vitrinite Type | Frequency (%) |
|----------------|---------------|
| V7             | 16.00         |
| V8             | 66.00         |
| V9             | 18.00         |

Vitrinite Reflectance

FORDING COAL LIMITED  
Sample PG-88-031

Compo 23

RH 2138

**BASIC STATISTICS**

|                                      |        |
|--------------------------------------|--------|
| Total Number of Observations.....    | 100    |
| Mean Maximum Reflectance (Romax)...% | .99    |
| Standard Error of the Mean.....      | 0.00   |
| Coefficient of Variation.....%       | 4.94   |
| Variance.....                        | .0024  |
| Standard Deviation.....              | .0491  |
| Skewness.....                        | -.1582 |
| Kurtosis.....                        | 2.7286 |

**CELL STATISTICS**

| Cell Number | Lower Limit | Number of Observations | Frequency (%) |
|-------------|-------------|------------------------|---------------|
| 3           | 0.85        | 3                      | 3.00          |
| 4           | 0.90        | 9                      | 9.00          |
| 5           | 0.95        | 37                     | 37.00         |
| 6           | 1.00        | 36                     | 36.00         |
| 7           | 1.05        | 14                     | 14.00         |
| 8           | 1.10        | 1                      | 1.00          |

**VITRINITE TYPE DISTRIBUTION**

| Vitrinite Type | Frequency (%) |
|----------------|---------------|
| V8             | 3.00          |
| V9             | 46.00         |
| V10            | 50.00         |
| V11            | 1.00          |

FORDING COAL LIMITED  
Sample PG-88-032

Comp 26

RH 2138

Vitrinite Reflectance

### BASIC STATISTICS

|                                      |        |
|--------------------------------------|--------|
| Total Number of Observations.....    | 100    |
| Mean Maximum Reflectance (Romax)...% | 1.01   |
| Standard Error of the Mean.....      | 0.00   |
| Coefficient of Variation.....%       | 4.41   |
| Variance.....                        | .0020  |
| Standard Deviation.....              | .0444  |
| Skewness.....                        | -.4193 |
| Kurtosis.....                        | 3.4171 |

### CELL STATISTICS

| Cell Number | Lower Limit | Number of Observations | Frequency (%) |
|-------------|-------------|------------------------|---------------|
| 3           | 0.85        | 3                      | 3.00          |
| 4           | 0.90        | 5                      | 5.00          |
| 5           | 0.95        | 26                     | 26.00         |
| 6           | 1.00        | 48                     | 48.00         |
| 7           | 1.05        | 17                     | 17.00         |
| 8           | 1.10        | 1                      | 1.00          |

### VITRINITE TYPE DISTRIBUTION

| Vitrinite Type | Frequency (%) |
|----------------|---------------|
| V8             | 3.00          |
| V9             | 31.00         |
| V10            | 65.00         |
| V11            | 1.00          |

FORDING COAL LIMITED  
Sample PG-88-060

Compd 141

RH #2139

### BASIC STATISTICS

|                                      |        |
|--------------------------------------|--------|
| Total Number of Observations.....    | 100    |
| Mean Maximum Reflectance (Romax)...% | .90    |
| Standard Error of the Mean.....      | 0.00   |
| Coefficient of Variation.....%       | 4.53   |
| Variance.....                        | .0017  |
| Standard Deviation.....              | .0409  |
| Skewness.....                        | -.3265 |
| Kurtosis.....                        | 3.1071 |

### CELL STATISTICS

| Cell Number | Lower Limit | Number of Observations | Frequency (%) |
|-------------|-------------|------------------------|---------------|
| 3           | 0.75        | 1                      | 1.00          |
| 4           | 0.80        | 6                      | 6.00          |
| 5           | 0.85        | 34                     | 34.00         |
| 6           | 0.90        | 42                     | 42.00         |
| 7           | 0.95        | 16                     | 16.00         |
| 8           | 1.00        | 1                      | 1.00          |

### VITRINITE TYPE DISTRIBUTION

| Vitrinite Type | Frequency (%) |
|----------------|---------------|
| V7             | 1.00          |
| V8             | 40.00         |
| V9             | 58.00         |
| V10            | 1.00          |

Reflectance

100  
90  
80  
70  
60  
50  
40  
30  
20  
10  
0

FORDING COAL LIMITED  
Sample PG-88-061

Compo 143  
RH # 2139

### BASIC STATISTICS

|                                      |        |
|--------------------------------------|--------|
| Total Number of Observations.....    | 100    |
| Mean Maximum Reflectance (Romax)...% | .92    |
| Standard Error of the Mean.....      | 0.00   |
| Coefficient of Variation.....%       | 4.66   |
| Variance.....                        | .0018  |
| Standard Deviation.....              | .0428  |
| Skewness.....                        | -.1671 |
| Kurtosis.....                        | 2.9740 |

### CELL STATISTICS

| Cell Number | Lower Limit | Number of Observations | Frequency (%) |
|-------------|-------------|------------------------|---------------|
| 3           | 0.80        | 6                      | 6.00          |
| 4           | 0.85        | 23                     | 23.00         |
| 5           | 0.90        | 47                     | 47.00         |
| 6           | 0.95        | 21                     | 21.00         |
| 7           | 1.00        | 3                      | 3.00          |

### VITRINITE TYPE DISTRIBUTION

| Vitrinite Type | Frequency (%) |
|----------------|---------------|
| V8             | 29.00         |
| V9             | 68.00         |
| V10            | 3.00          |



FORDING COAL LIMITED  
Sample PG-88=062

Carpo 149  
RIT = 2139

Vitrinite Reflectance

### BASIC STATISTICS

|                                      |        |
|--------------------------------------|--------|
| Total Number of Observations.....    | 100    |
| Mean Maximum Reflectance (Romax)...% | .93    |
| Standard Error of the Mean.....      | 0.00   |
| Coefficient of Variation.....%       | 5.28   |
| Variance.....                        | .0024  |
| Standard Deviation.....              | .0490  |
| Skewness.....                        | -.0751 |
| Kurtosis.....                        | 2.5265 |

### CELL STATISTICS

| Cell Number | Lower Limit | Number of Observations | Frequency (%) |
|-------------|-------------|------------------------|---------------|
| 3           | 0.80        | 5                      | 5.00          |
| 4           | 0.85        | 20                     | 20.00         |
| 5           | 0.90        | 36                     | 36.00         |
| 6           | 0.95        | 29                     | 29.00         |
| 7           | 1.00        | 10                     | 10.00         |

### VITRINITE TYPE DISTRIBUTION

| Vitrinite Type | Frequency (%) |
|----------------|---------------|
| V8             | 25.00         |
| V9             | 65.00         |
| V10            | 10.00         |

FORDING COAL LIMITED  
Sample PG-88-054

Comp 91  
RH 2170

### BASIC STATISTICS

|                                      |        |
|--------------------------------------|--------|
| Total Number of Observations.....    | 100    |
| Mean Maximum Reflectance (Romax)...% | .96    |
| Standard Error of the Mean.....      | 0.00   |
| Coefficient of Variation.....%       | 4.38   |
| Variance.....                        | .0018  |
| Standard Deviation.....              | .0421  |
| Skewness.....                        | -.0355 |
| Kurtosis.....                        | 2.9610 |

### CELL STATISTICS

| Cell Number | Lower Limit | Number of Observations | Frequency (%) |
|-------------|-------------|------------------------|---------------|
| 3           | 0.85        | 7                      | 7.00          |
| 4           | 0.90        | 29                     | 29.00         |
| 5           | 0.95        | 44                     | 44.00         |
| 6           | 1.00        | 17                     | 17.00         |
| 7           | 1.05        | 3                      | 3.00          |

### VITRINITE TYPE DISTRIBUTION

| Vitrinite Type | Frequency (%) |
|----------------|---------------|
| V8             | 7.00          |
| V9             | 73.00         |
| V10            | 20.00         |

FORDING COAL LIMITED  
Sample PG-88-055

Compo 94

RIT 2140

### BASIC STATISTICS

|                                      |        |
|--------------------------------------|--------|
| Total Number of Observations.....    | 100    |
| Mean Maximum Reflectance (Romax)...% | 1.03   |
| Standard Error of the Mean.....      | 0.00   |
| Coefficient of Variation.....%       | 4.63   |
| Variance.....                        | .0023  |
| Standard Deviation.....              | .0475  |
| Skewness.....                        | .1582  |
| Kurtosis.....                        | 3.0881 |

### CELL STATISTICS

| Cell Number | Lower Limit | Number of Observations | Frequency (%) |
|-------------|-------------|------------------------|---------------|
| 3           | 0.90        | 5                      | 5.00          |
| 4           | 0.95        | 19                     | 19.00         |
| 5           | 1.00        | 43                     | 43.00         |
| 6           | 1.05        | 25                     | 25.00         |
| 7           | 1.10        | 7                      | 7.00          |
| 8           | 1.15        | 1                      | 1.00          |

### VITRINITE TYPE DISTRIBUTION

| Vitrinite Type | Frequency (%) |
|----------------|---------------|
| V9             | 24.00         |
| V10            | 68.00         |
| V11            | 8.00          |

FORDING COAL LIMITED  
Sample PG-88-055

Compo 95  
RH 2140

### BASIC STATISTICS

|                                      |        |
|--------------------------------------|--------|
| Total Number of Observations.....    | 100    |
| Mean Maximum Reflectance (Romax)...% | 1.03   |
| Standard Error of the Mean.....      | 0.00   |
| Coefficient of Variation.....%       | 4.60   |
| Variance.....                        | .0022  |
| Standard Deviation.....              | .0472  |
| Skewness.....                        | -.1061 |
| Kurtosis.....                        | 2.7925 |

### CELL STATISTICS

| Cell Number | Lower Limit | Number of Observations | Frequency (%) |
|-------------|-------------|------------------------|---------------|
| 3           | 0.90        | 6                      | 6.00          |
| 4           | 0.95        | 16                     | 16.00         |
| 5           | 1.00        | 46                     | 46.00         |
| 6           | 1.05        | 23                     | 23.00         |
| 7           | 1.10        | 9                      | 9.00          |

### VITRINITE TYPE DISTRIBUTION

| Vitrinite Type | Frequency (%) |
|----------------|---------------|
| V9             | 22.00         |
| V10            | 69.00         |
| V11            | 9.00          |

FORDING COAL LIMITED  
Sample PG-88-057

Compo-97  
RIT 2170

### BASIC STATISTICS

|                                      |        |
|--------------------------------------|--------|
| Total Number of Observations.....    | 100    |
| Mean Maximum Reflectance (Romax)...% | 1.05   |
| Standard Error of the Mean.....      | 0.00   |
| Coefficient of Variation.....%       | 4.39   |
| Variance.....                        | .0021  |
| Standard Deviation.....              | .0463  |
| Skewness.....                        | -.1146 |
| Kurtosis.....                        | 2.7001 |

### CELL STATISTICS

| Cell Number | Lower Limit | Number of Observations | Frequency (%) |
|-------------|-------------|------------------------|---------------|
| 3           | 0.90        | 1                      | 1.00          |
| 4           | 0.95        | 9                      | 9.00          |
| 5           | 1.00        | 34                     | 34.00         |
| 6           | 1.05        | 37                     | 37.00         |
| 7           | 1.10        | 17                     | 17.00         |
| 8           | 1.15        | 2                      | 2.00          |

### VITRINITE TYPE DISTRIBUTION

| Vitrinite Type | Frequency (%) |
|----------------|---------------|
| V9             | 10.00         |
| V10            | 71.00         |
| V11            | 19.00         |

# Vitrinite Reflectance

FORDING COAL LIMITED  
Sample PG-88-154

Compo 442

RH #2142

## BASIC STATISTICS

|                                                  |        |
|--------------------------------------------------|--------|
| Total Number of Observations.....                | 100    |
| Mean Maximum Reflectance (R <sub>max</sub> )...% | .85    |
| Standard Error of the Mean.....                  | .01    |
| Coefficient of Variation.....%                   | 6.00   |
| Variance.....                                    | .0026  |
| Standard Deviation.....                          | .0511  |
| Skewness.....                                    | .1924  |
| Kurtosis.....                                    | 2.7553 |

## CELL STATISTICS

| Cell Number | Lower Limit | Number of Observations | Frequency (%) |
|-------------|-------------|------------------------|---------------|
| 3           | 0.75        | 16                     | 16.00         |
| 4           | 0.80        | 28                     | 28.00         |
| 5           | 0.85        | 36                     | 36.00         |
| 6           | 0.90        | 15                     | 15.00         |
| 7           | 0.95        | 4                      | 4.00          |
| 8           | 1.00        | 1                      | 1.00          |

## VITRINITE TYPE DISTRIBUTION

| Vitrinite Type | Frequency (%) |
|----------------|---------------|
| V7             | 16.00         |
| V8             | 64.00         |
| V9             | 19.00         |
| V10            | 1.00          |

# Vitrinite Reflectance

FORDING COAL LIMITED  
Sample PG-88-155

Compo 444  
RH # 2142

## BASIC STATISTICS

|                                      |        |
|--------------------------------------|--------|
| Total Number of Observations.....    | 100    |
| Mean Maximum Reflectance (Romax)...% | .94    |
| Standard Error of the Mean.....      | .01    |
| Coefficient of Variation.....%       | 6.34   |
| Variance.....                        | .0036  |
| Standard Deviation.....              | .0598  |
| Skewness.....                        | .0474  |
| Kurtosis.....                        | 2.1805 |

## CELL STATISTICS

| Cell Number | Lower Limit | Number of Observations | Frequency (%) |
|-------------|-------------|------------------------|---------------|
| 3           | 0.80        | 4                      | 4.00          |
| 4           | 0.85        | 19                     | 19.00         |
| 5           | 0.90        | 26                     | 26.00         |
| 6           | 0.95        | 27                     | 27.00         |
| 7           | 1.00        | 20                     | 20.00         |
| 8           | 1.05        | 4                      | 4.00          |

## VITRINITE TYPE DISTRIBUTION

| Vitrinite Type | Frequency (%) |
|----------------|---------------|
| V8             | 23.00         |
| V9             | 53.00         |
| V10            | 24.00         |

# Vitrinite Reflectance

FORDING COAL LIMITED  
Sample PG-88-156

Comp# 447

RH #2142

## BASIC STATISTICS

|                                      |        |
|--------------------------------------|--------|
| Total Number of Observations.....    | 100    |
| Mean Maximum Reflectance (Romax)...% | 1.00   |
| Standard Error of the Mean.....      | 0.00   |
| Coefficient of Variation.....%       | 4.64   |
| Variance.....                        | .0022  |
| Standard Deviation.....              | .0465  |
| Skewness.....                        | .0088  |
| Kurtosis.....                        | 2.8805 |

## CELL STATISTICS

| Cell Number | Lower Limit | Number of Observations | Frequency (%) |
|-------------|-------------|------------------------|---------------|
| 3           | 0.85        | 1                      | 1.00          |
| 4           | 0.90        | 12                     | 12.00         |
| 5           | 0.95        | 29                     | 29.00         |
| 6           | 1.00        | 38                     | 38.00         |
| 7           | 1.05        | 19                     | 19.00         |
| 8           | 1.10        | 1                      | 1.00          |

## VITRINITE TYPE DISTRIBUTION

| Vitrinite Type | Frequency (%) |
|----------------|---------------|
| V8             | 1.00          |
| V9             | 41.00         |
| V10            | 57.00         |
| V11            | 1.00          |



# Vitrinite Reflectance

FORDING COAL LIMITED  
Sample PG-88-157

Compo 448

RH# 2142

## BASIC STATISTICS

|                                      |        |
|--------------------------------------|--------|
| Total Number of Observations.....    | 100    |
| Mean Maximum Reflectance (Romax)...% | .94    |
| Standard Error of the Mean.....      | 0.00   |
| Coefficient of Variation.....%       | 5.10   |
| Variance.....                        | .0023  |
| Standard Deviation.....              | .0478  |
| Skewness.....                        | .1132  |
| Kurtosis.....                        | 2.8820 |

## CELL STATISTICS

| Cell Number | Lower Limit | Number of Observations | Frequency (%) |
|-------------|-------------|------------------------|---------------|
| 3           | 0.80        | 2                      | 2.00          |
| 4           | 0.85        | 18                     | 18.00         |
| 5           | 0.90        | 34                     | 34.00         |
| 6           | 0.95        | 35                     | 35.00         |
| 7           | 1.00        | 9                      | 9.00          |
| 8           | 1.05        | 2                      | 2.00          |

## VITRINITE TYPE DISTRIBUTION

| Vitrinite Type | Frequency (%) |
|----------------|---------------|
| V8             | 20.00         |
| V9             | 69.00         |
| V10            | 11.00         |

# Vitrinite Reflectance

FORDING COAL LIMITED  
Sample PG-88-158

Compo 463  
RH # 2143

## BASIC STATISTICS

|                                      |        |
|--------------------------------------|--------|
| Total Number of Observations.....    | 100    |
| Mean Maximum Reflectance (Romax)...% | .87    |
| Standard Error of the Mean.....      | .01    |
| Coefficient of Variation.....%       | 6.11   |
| Variance.....                        | .0028  |
| Standard Deviation.....              | .0532  |
| Skewness.....                        | .3193  |
| Kurtosis.....                        | 3.6738 |

## CELL STATISTICS

| Cell Number | Lower Limit | Number of Observations | Frequency (%) |
|-------------|-------------|------------------------|---------------|
| 3           | 0.75        | 11                     | 11.00         |
| 4           | 0.80        | 17                     | 17.00         |
| 5           | 0.85        | 41                     | 41.00         |
| 6           | 0.90        | 23                     | 23.00         |
| 7           | 0.95        | 6                      | 6.00          |
| 8           | 1.00        | 1                      | 1.00          |
| 9           | 1.05        | 1                      | 1.00          |

## VITRINITE TYPE DISTRIBUTION

| Vitrinite Type | Frequency (%) |
|----------------|---------------|
| V7             | 11.00         |
| V8             | 58.00         |
| V9             | 29.00         |
| V10            | 2.00          |

# Vitrinite Reflectance

FORDING COAL LIMITED  
Sample PG-88-159

Compo 464

RH # 2143

## BASIC STATISTICS

|                                      |        |
|--------------------------------------|--------|
| Total Number of Observations.....    | 100    |
| Mean Maximum Reflectance (Romax)...% | .95    |
| Standard Error of the Mean.....      | 0.00   |
| Coefficient of Variation.....%       | 5.02   |
| Variance.....                        | .0023  |
| Standard Deviation.....              | .0475  |
| Skewness.....                        | .3222  |
| Kurtosis.....                        | 2.5870 |

## CELL STATISTICS

| Cell Number | Lower Limit | Number of Observations | Frequency (%) |
|-------------|-------------|------------------------|---------------|
| 3           | 0.80        | 1                      | 1.00          |
| 4           | 0.85        | 12                     | 12.00         |
| 5           | 0.90        | 39                     | 39.00         |
| 6           | 0.95        | 30                     | 30.00         |
| 7           | 1.00        | 16                     | 16.00         |
| 8           | 1.05        | 2                      | 2.00          |

## VITRINITE TYPE DISTRIBUTION

| Vitrinite Type | Frequency (%) |
|----------------|---------------|
| V8             | 13.00         |
| V9             | 69.00         |
| V10            | 18.00         |

# Vitrinite Reflectance

FORDING COAL LIMITED  
Sample PG-88-160

Compo 466  
RH 2143

## BASIC STATISTICS

|                                      |        |
|--------------------------------------|--------|
| Total Number of Observations.....    | 100    |
| Mean Maximum Reflectance (Romax)...% | .98    |
| Standard Error of the Mean.....      | 0.00   |
| Coefficient of Variation.....%       | 4.29   |
| Variance.....                        | .0018  |
| Standard Deviation.....              | .0419  |
| Skewness.....                        | .0458  |
| Kurtosis.....                        | 2.8659 |

## CELL STATISTICS

| Cell Number | Lower Limit | Number of Observations | Frequency (%) |
|-------------|-------------|------------------------|---------------|
| 3           | 0.85        | 3                      | 3.00          |
| 4           | 0.90        | 22                     | 22.00         |
| 5           | 0.95        | 46                     | 46.00         |
| 6           | 1.00        | 22                     | 22.00         |
| 7           | 1.05        | 7                      | 7.00          |

## VITRINITE TYPE DISTRIBUTION

| Vitrinite Type | Frequency (%) |
|----------------|---------------|
| V8             | 3.00          |
| V9             | 68.00         |
| V10            | 29.00         |

# Vitrinite Reflectance

FORDING COAL LIMITED  
Sample PG-88-161

Compo 468  
RH 2143

## BASIC STATISTICS

|                                      |        |
|--------------------------------------|--------|
| Total Number of Observations.....    | 100    |
| Mean Maximum Reflectance (Romax)...% | .96    |
| Standard Error of the Mean.....      | 0.00   |
| Coefficient of Variation.....%       | 4.93   |
| Variance.....                        | .0023  |
| Standard Deviation.....              | .0475  |
| Skewness.....                        | .3170  |
| Kurtosis.....                        | 3.9674 |

## CELL STATISTICS

| Cell Number | Lower Limit | Number of Observations | Frequency (%) |
|-------------|-------------|------------------------|---------------|
| 3           | 0.85        | 7                      | 7.00          |
| 4           | 0.90        | 26                     | 26.00         |
| 5           | 0.95        | 46                     | 46.00         |
| 6           | 1.00        | 16                     | 16.00         |
| 7           | 1.05        | 4                      | 4.00          |
| 8           | 1.10        | 1                      | 1.00          |

## VITRINITE TYPE DISTRIBUTION

| Vitrinite Type | Frequency (%) |
|----------------|---------------|
| V8             | 7.00          |
| V9             | 72.00         |
| V10            | 20.00         |
| V11            | 1.00          |

# Vitrinite Reflectance

FORDING COAL LIMITED  
Sample PG-88-162

Compo 544

RH # 2145

## BASIC STATISTICS

|                                      |        |
|--------------------------------------|--------|
| Total Number of Observations.....    | 100    |
| Mean Maximum Reflectance (Romax)...% | 1.06   |
| Standard Error of the Mean.....      | .01    |
| Coefficient of Variation.....%       | 5.30   |
| Variance.....                        | .0031  |
| Standard Deviation.....              | .0561  |
| Skewness.....                        | .0036  |
| Kurtosis.....                        | 3.4385 |

## CELL STATISTICS

| Cell Number | Lower Limit | Number of Observations | Frequency (%) |
|-------------|-------------|------------------------|---------------|
| 4           | 0.85        | 1                      | 1.00          |
| 5           | 0.90        | 1                      | 1.00          |
| 6           | 0.95        | 9                      | 9.00          |
| 7           | 1.00        | 32                     | 32.00         |
| 8           | 1.05        | 34                     | 34.00         |
| 9           | 1.10        | 17                     | 17.00         |
| 10          | 1.15        | 5                      | 5.00          |
| 11          | 1.20        | 1                      | 1.00          |

## VITRINITE TYPE DISTRIBUTION

| Vitrinite Type | Frequency (%) |
|----------------|---------------|
| V8             | 1.00          |
| V9             | 10.00         |
| V10            | 66.00         |
| V11            | 22.00         |
| V12            | 1.00          |

# Vitrinite Reflectance

FORDING COAL LIMITED  
Sample PG-88-163

Compo 545  
RH 2145

## BASIC STATISTICS

|                                      |        |
|--------------------------------------|--------|
| Total Number of Observations.....    | 100    |
| Mean Maximum Reflectance (Romax)...% | 1.11   |
| Standard Error of the Mean.....      | 0.00   |
| Coefficient of Variation.....%       | 4.16   |
| Variance.....                        | .0021  |
| Standard Deviation.....              | .0461  |
| Skewness.....                        | -.1788 |
| Kurtosis.....                        | 2.9236 |

## CELL STATISTICS

| Cell Number | Lower Limit | Number of Observations | Frequency (%) |
|-------------|-------------|------------------------|---------------|
| 3           | 1.00        | 11                     | 11.00         |
| 4           | 1.05        | 20                     | 20.00         |
| 5           | 1.10        | 46                     | 46.00         |
| 6           | 1.15        | 20                     | 20.00         |
| 7           | 1.20        | 3                      | 3.00          |

## VITRINITE TYPE DISTRIBUTION

| Vitrinite Type | Frequency (%) |
|----------------|---------------|
| V10            | 31.00         |
| V11            | 66.00         |
| V12            | 3.00          |

# Vitrinite Reflectance

FORDING COAL LIMITED  
Sample PG-88-164

Compo 546

RH 2145

## BASIC STATISTICS

|                                      |        |
|--------------------------------------|--------|
| Total Number of Observations.....    | 100    |
| Mean Maximum Reflectance (Romax)...% | 1.10   |
| Standard Error of the Mean.....      | .01    |
| Coefficient of Variation.....%       | 4.91   |
| Variance.....                        | .0029  |
| Standard Deviation.....              | .0538  |
| Skewness.....                        | -.1427 |
| Kurtosis.....                        | 2.9339 |

## CELL STATISTICS

| Cell Number | Lower Limit | Number of Observations | Frequency (%) |
|-------------|-------------|------------------------|---------------|
| 3           | 0.90        | 1                      | 1.00          |
| 4           | 0.95        | 1                      | 1.00          |
| 5           | 1.00        | 15                     | 15.00         |
| 6           | 1.05        | 32                     | 32.00         |
| 7           | 1.10        | 34                     | 34.00         |
| 8           | 1.15        | 14                     | 14.00         |
| 9           | 1.20        | 3                      | 3.00          |

## VITRINITE TYPE DISTRIBUTION

| Vitrinite Type | Frequency (%) |
|----------------|---------------|
| V9             | 2.00          |
| V10            | 47.00         |
| V11            | 48.00         |
| V12            | 3.00          |



# Vitrinite Reflectance

FORDING COAL LIMITED  
Sample PG-88-165

Compo 547

RH 2145

## BASIC STATISTICS

|                                      |        |
|--------------------------------------|--------|
| Total Number of Observations.....    | 100    |
| Mean Maximum Reflectance (Romax)...% | 1.18   |
| Standard Error of the Mean.....      | .01    |
| Coefficient of Variation.....%       | 4.61   |
| Variance.....                        | .0030  |
| Standard Deviation.....              | .0545  |
| Skewness.....                        | -.1874 |
| Kurtosis.....                        | 3.0377 |

## CELL STATISTICS

| Cell Number | Lower Limit | Number of Observations | Frequency (%) |
|-------------|-------------|------------------------|---------------|
| 3           | 1.00        | 1                      | 1.00          |
| 4           | 1.05        | 7                      | 7.00          |
| 5           | 1.10        | 14                     | 14.00         |
| 6           | 1.15        | 40                     | 40.00         |
| 7           | 1.20        | 23                     | 23.00         |
| 8           | 1.25        | 14                     | 14.00         |
| 9           | 1.30        | 1                      | 1.00          |

## VITRINITE TYPE DISTRIBUTION

| Vitrinite Type | Frequency (%) |
|----------------|---------------|
| V10            | 8.00          |
| V11            | 54.00         |
| V12            | 37.00         |
| V13            | 1.00          |

# Vitrinite Reflectance

FORDING COAL LIMITED  
Sample PG-88-166

Compo 548  
BH 2145

## BASIC STATISTICS

|                                      |        |
|--------------------------------------|--------|
| Total Number of Observations.....    | 100    |
| Mean Maximum Reflectance (Romax)...% | 1.14   |
| Standard Error of the Mean.....      | .01    |
| Coefficient of Variation.....%       | 4.84   |
| Variance.....                        | .0030  |
| Standard Deviation.....              | .0551  |
| Skewness.....                        | -.0394 |
| Kurtosis.....                        | 2.3986 |

## CELL STATISTICS

| Cell Number | Lower Limit | Number of Observations | Frequency (%) |
|-------------|-------------|------------------------|---------------|
| 3           | 1.00        | 4                      | 4.00          |
| 4           | 1.05        | 22                     | 22.00         |
| 5           | 1.10        | 31                     | 31.00         |
| 6           | 1.15        | 25                     | 25.00         |
| 7           | 1.20        | 17                     | 17.00         |
| 8           | 1.25        | 1                      | 1.00          |

## VITRINITE TYPE DISTRIBUTION

| Vitrinite Type | Frequency (%) |
|----------------|---------------|
| V10            | 26.00         |
| V11            | 56.00         |
| V12            | 18.00         |

# Vitrinite Reflectance

FORDING COAL LIMITED  
Sample PG-88-167

Compo 549  
QH 2145

## BASIC STATISTICS

|                                      |         |
|--------------------------------------|---------|
| Total Number of Observations.....    | 100     |
| Mean Maximum Reflectance (Romax)...% | 1.25    |
| Standard Error of the Mean.....      | .01     |
| Coefficient of Variation.....%       | 7.51    |
| Variance.....                        | .0089   |
| Standard Deviation.....              | .0941   |
| Skewness.....                        | -1.8080 |
| Kurtosis.....                        | 8.3729  |

## CELL STATISTICS

| Cell Number | Lower Limit | Number of Observations | Frequency (%) |
|-------------|-------------|------------------------|---------------|
| 5           | 0.80        | 1                      | 1.00          |
| 6           | 0.85        | 1                      | 1.00          |
| 8           | 0.95        | 1                      | 1.00          |
| 10          | 1.05        | 2                      | 2.00          |
| 11          | 1.10        | 5                      | 5.00          |
| 12          | 1.15        | 9                      | 9.00          |
| 13          | 1.20        | 17                     | 17.00         |
| 14          | 1.25        | 27                     | 27.00         |
| 15          | 1.30        | 26                     | 26.00         |
| 16          | 1.35        | 8                      | 8.00          |
| 17          | 1.40        | 3                      | 3.00          |

## VITRINITE TYPE DISTRIBUTION

| Vitrinite Type | Frequency (%) |
|----------------|---------------|
| V8             | 2.00          |
| V9             | 1.00          |
| V10            | 2.00          |
| V11            | 14.00         |
| V12            | 44.00         |
| V13            | 34.00         |
| V14            | 3.00          |

# Vitrinite Reflectance

FORDING COAL LIMITED  
Sample PG-88-168

Comps 550  
RH # 2146

## BASIC STATISTICS

|                                      |        |
|--------------------------------------|--------|
| Total Number of Observations.....    | 100    |
| Mean Maximum Reflectance (Romax)...% | .91    |
| Standard Error of the Mean.....      | .01    |
| Coefficient of Variation.....%       | 5.97   |
| Variance.....                        | .0029  |
| Standard Deviation.....              | .0541  |
| Skewness.....                        | -.2469 |
| Kurtosis.....                        | 3.4009 |

## CELL STATISTICS

| Cell Number | Lower Limit | Number of Observations | Frequency (%) |
|-------------|-------------|------------------------|---------------|
| 3           | 0.75        | 4                      | 4.00          |
| 4           | 0.80        | 8                      | 8.00          |
| 5           | 0.85        | 26                     | 26.00         |
| 6           | 0.90        | 42                     | 42.00         |
| 7           | 0.95        | 15                     | 15.00         |
| 8           | 1.00        | 5                      | 5.00          |

## VITRINITE TYPE DISTRIBUTION

| Vitrinite Type | Frequency (%) |
|----------------|---------------|
| V7             | 4.00          |
| V8             | 34.00         |
| V9             | 57.00         |
| V10            | 5.00          |

# Vitrinite Reflectance

FORDING COAL LIMITED  
Sample PG-88-169

Compo 552  
RH 2146

## BASIC STATISTICS

|                                      |        |
|--------------------------------------|--------|
| Total Number of Observations.....    | 100    |
| Mean Maximum Reflectance (Romax)...% | .96    |
| Standard Error of the Mean.....      | .01    |
| Coefficient of Variation.....%       | 6.27   |
| Variance.....                        | .0036  |
| Standard Deviation.....              | .0601  |
| Skewness.....                        | .2162  |
| Kurtosis.....                        | 3.7780 |

## CELL STATISTICS

| Cell Number | Lower Limit | Number of Observations | Frequency (%) |
|-------------|-------------|------------------------|---------------|
| 4           | 0.80        | 4                      | 4.00          |
| 5           | 0.85        | 9                      | 9.00          |
| 6           | 0.90        | 27                     | 27.00         |
| 7           | 0.95        | 36                     | 36.00         |
| 8           | 1.00        | 19                     | 19.00         |
| 9           | 1.05        | 3                      | 3.00          |
| 10          | 1.10        | 1                      | 1.00          |
| 11          | 1.15        | 1                      | 1.00          |

## VITRINITE TYPE DISTRIBUTION

| Vitrinite Type | Frequency (%) |
|----------------|---------------|
| V8             | 13.00         |
| V9             | 63.00         |
| V10            | 22.00         |
| V11            | 2.00          |

# Vitrinite Reflectance

FORDING COAL LIMITED  
 Sample PG-89-049

Compo 217  
 RH2147 82027-032

## BASIC STATISTICS

|                                      |        |
|--------------------------------------|--------|
| Total Number of Observations.....    | 100    |
| Mean Maximum Reflectance (Romax)...% | .90    |
| Standard Error of the Mean.....      | 0.00   |
| Coefficient of Variation.....%       | 4.74   |
| Variance.....                        | .0018  |
| Standard Deviation.....              | .0427  |
| Skewness.....                        | .2026  |
| Kurtosis.....                        | 2.7612 |

## CELL STATISTICS

| Cell Number | Lower Limit | Number of Observations | Frequency (%) |
|-------------|-------------|------------------------|---------------|
| 3           | 0.80        | 9                      | 9.00          |
| 4           | 0.85        | 43                     | 43.00         |
| 5           | 0.90        | 35                     | 35.00         |
| 6           | 0.95        | 11                     | 11.00         |
| 7           | 1.00        | 2                      | 2.00          |

## VITRINITE TYPE DISTRIBUTION

| Vitrinite Type | Frequency (%) |
|----------------|---------------|
| V8             | 52.00         |
| V9             | 46.00         |
| V10            | 2.00          |

# Vitrinite Reflectance

FORDING COAL LIMITED  
 Sample PG-89-050

Compo 219

RH 2147 82050-058

## BASIC STATISTICS

|                                      |        |
|--------------------------------------|--------|
| Total Number of Observations.....    | 100    |
| Mean Maximum Reflectance (Romax)...% | 1.00   |
| Standard Error of the Mean.....      | .01    |
| Coefficient of Variation.....%       | 6.35   |
| Variance.....                        | .0041  |
| Standard Deviation.....              | .0637  |
| Skewness.....                        | -.1357 |
| Kurtosis.....                        | 2.9071 |

## CELL STATISTICS

| Cell Number | Lower Limit | Number of Observations | Frequency (%) |
|-------------|-------------|------------------------|---------------|
| 4           | 0.80        | 1                      | 1.00          |
| 5           | 0.85        | 3                      | 3.00          |
| 6           | 0.90        | 13                     | 13.00         |
| 7           | 0.95        | 29                     | 29.00         |
| 8           | 1.00        | 30                     | 30.00         |
| 9           | 1.05        | 17                     | 17.00         |
| 10          | 1.10        | 6                      | 6.00          |
| 11          | 1.15        | 1                      | 1.00          |

## VITRINITE TYPE DISTRIBUTION

| Vitrinite Type | Frequency (%) |
|----------------|---------------|
| V8             | 4.00          |
| V9             | 42.00         |
| V10            | 47.00         |
| V11            | 7.00          |

# Vitrinite Reflectance

FORDING COAL LIMITED  
 Sample PG-89-045

Compo 213

RH2148 82079-086

## BASIC STATISTICS

|                                      |        |
|--------------------------------------|--------|
| Total Number of Observations.....    | 100    |
| Mean Maximum Reflectance (Romax)...% | 1.00   |
| Standard Error of the Mean.....      | 0.00   |
| Coefficient of Variation.....%       | 3.54   |
| Variance.....                        | .0013  |
| Standard Deviation.....              | .0356  |
| Skewness.....                        | -.3510 |
| Kurtosis.....                        | 3.0670 |

## CELL STATISTICS

| Cell Number | Lower Limit | Number of Observations | Frequency (%) |
|-------------|-------------|------------------------|---------------|
| 2           | 0.90        | 6                      | 6.00          |
| 3           | 0.95        | 33                     | 33.00         |
| 4           | 1.00        | 50                     | 50.00         |
| 5           | 1.05        | 11                     | 11.00         |

## VITRINITE TYPE DISTRIBUTION

| Vitrinite Type | Frequency (%) |
|----------------|---------------|
| V9             | 39.00         |
| V10            | 61.00         |



# Vitrinite Reflectance

FORDING COAL LIMITED  
 Sample PG-89-046

Compo 214  
 RH 2148 82088-096

## BASIC STATISTICS

|                                      |        |
|--------------------------------------|--------|
| Total Number of Observations.....    | 100    |
| Mean Maximum Reflectance (Romax)...% | 1.09   |
| Standard Error of the Mean.....      | 0.00   |
| Coefficient of Variation.....%       | 3.94   |
| Variance.....                        | .0019  |
| Standard Deviation.....              | .0431  |
| Skewness.....                        | -.2248 |
| Kurtosis.....                        | 3.1436 |

## CELL STATISTICS

| Cell Number | Lower Limit | Number of Observations | Frequency (%) |
|-------------|-------------|------------------------|---------------|
| 3           | 0.95        | 2                      | 2.00          |
| 4           | 1.00        | 9                      | 9.00          |
| 5           | 1.05        | 36                     | 36.00         |
| 6           | 1.10        | 42                     | 42.00         |
| 7           | 1.15        | 11                     | 11.00         |

## VITRINITE TYPE DISTRIBUTION

| Vitrinite Type | Frequency (%) |
|----------------|---------------|
| V9             | 2.00          |
| V10            | 45.00         |
| V11            | 53.00         |

# Vitrinite Reflectance

FORDING COAL LIMITED

Sample PG-89-047

RH 2148

82100-104

Compo 215

## BASIC STATISTICS

|                                      |        |
|--------------------------------------|--------|
| Total Number of Observations.....    | 100    |
| Mean Maximum Reflectance (Romax)...% | 1.13   |
| Standard Error of the Mean.....      | 0.00   |
| Coefficient of Variation.....%       | 3.68   |
| Variance.....                        | .0017  |
| Standard Deviation.....              | .0416  |
| Skewness.....                        | -.0374 |
| Kurtosis.....                        | 3.1072 |

## CELL STATISTICS

| Cell Number | Lower Limit | Number of Observations | Frequency (%) |
|-------------|-------------|------------------------|---------------|
| 3           | 1.00        | 1                      | 1.00          |
| 4           | 1.05        | 18                     | 18.00         |
| 5           | 1.10        | 48                     | 48.00         |
| 6           | 1.15        | 28                     | 28.00         |
| 7           | 1.20        | 4                      | 4.00          |
| 8           | 1.25        | 1                      | 1.00          |

## VITRINITE TYPE DISTRIBUTION

| Vitrinite Type | Frequency (%) |
|----------------|---------------|
| V10            | 19.00         |
| V11            | 76.00         |
| V12            | 5.00          |

# Vitrinite Reflectance

FORDING COAL LIMITED  
 Sample PG-89-048

Compo 216  
 RH2148 82108-112

## BASIC STATISTICS

|                                      |        |
|--------------------------------------|--------|
| Total Number of Observations.....    | 100    |
| Mean Maximum Reflectance (Romax)...% | 1.17   |
| Standard Error of the Mean.....      | 0.00   |
| Coefficient of Variation.....%       | 3.68   |
| Variance.....                        | .0019  |
| Standard Deviation.....              | .0431  |
| Skewness.....                        | -.0200 |
| Kurtosis.....                        | 3.1130 |

## CELL STATISTICS

| Cell Number | Lower Limit | Number of Observations | Frequency (%) |
|-------------|-------------|------------------------|---------------|
| 3           | 1.05        | 4                      | 4.00          |
| 4           | 1.10        | 24                     | 24.00         |
| 5           | 1.15        | 46                     | 46.00         |
| 6           | 1.20        | 21                     | 21.00         |
| 7           | 1.25        | 5                      | 5.00          |

## VITRINITE TYPE DISTRIBUTION

| Vitrinite Type | Frequency (%) |
|----------------|---------------|
| V10            | 4.00          |
| V11            | 70.00         |
| V12            | 26.00         |

# Vitrinite Reflectance

FORDING COAL LIMITED  
Sample PG-88-136

Compo 477  
RH 2076

## BASIC STATISTICS

|                                      |        |
|--------------------------------------|--------|
| Total Number of Observations.....    | 100    |
| Mean Maximum Reflectance (Romax)...% | 1.01   |
| Standard Error of the Mean.....      | .01    |
| Coefficient of Variation.....%       | 5.24   |
| Variance.....                        | .0028  |
| Standard Deviation.....              | .0532  |
| Skewness.....                        | .7057  |
| Kurtosis.....                        | 3.7086 |

## CELL STATISTICS

| Cell Number | Lower Limit | Number of Observations | Frequency (%) |
|-------------|-------------|------------------------|---------------|
| 3           | 0.90        | 5                      | 5.00          |
| 4           | 0.95        | 34                     | 34.00         |
| 5           | 1.00        | 35                     | 35.00         |
| 6           | 1.05        | 18                     | 18.00         |
| 7           | 1.10        | 6                      | 6.00          |
| 8           | 1.15        | 2                      | 2.00          |

## VITRINITE TYPE DISTRIBUTION

| Vitrinite Type | Frequency (%) |
|----------------|---------------|
| V9             | 39.00         |
| V10            | 53.00         |
| V11            | 8.00          |

# Vitrinite Reflectance

FORDING COAL LIMITED  
Sample PG-88-137

Compo 478  
RH # 2076

## BASIC STATISTICS

|                                      |        |
|--------------------------------------|--------|
| Total Number of Observations.....    | 100    |
| Mean Maximum Reflectance (Romax)...% | 1.06   |
| Standard Error of the Mean.....      | .01    |
| Coefficient of Variation.....%       | 5.38   |
| Variance.....                        | .0033  |
| Standard Deviation.....              | .0571  |
| Skewness.....                        | .1137  |
| Kurtosis.....                        | 2.3772 |

## CELL STATISTICS

| Cell Number | Lower Limit | Number of Observations | Frequency (%) |
|-------------|-------------|------------------------|---------------|
| 3           | 0.90        | 1                      | 1.00          |
| 4           | 0.95        | 13                     | 13.00         |
| 5           | 1.00        | 29                     | 29.00         |
| 6           | 1.05        | 29                     | 29.00         |
| 7           | 1.10        | 18                     | 18.00         |
| 8           | 1.15        | 9                      | 9.00          |
| 9           | 1.20        | 1                      | 1.00          |

## VITRINITE TYPE DISTRIBUTION

| Vitrinite Type | Frequency (%) |
|----------------|---------------|
| V9             | 14.00         |
| V10            | 58.00         |
| V11            | 27.00         |
| V12            | 1.00          |

# Vitrinite Reflectance

FORDING COAL LIMITED  
Sample PG-88-138

Compo 481  
QH # 2076

## BASIC STATISTICS

|                                      |        |
|--------------------------------------|--------|
| Total Number of Observations.....    | 100    |
| Mean Maximum Reflectance (Romax)...% | 1.16   |
| Standard Error of the Mean.....      | .01    |
| Coefficient of Variation.....%       | 5.28   |
| Variance.....                        | .0037  |
| Standard Deviation.....              | .0610  |
| Skewness.....                        | .2687  |
| Kurtosis.....                        | 3.3938 |

## CELL STATISTICS

| Cell Number | Lower Limit | Number of Observations | Frequency (%) |
|-------------|-------------|------------------------|---------------|
| 4           | 1.00        | 4                      | 4.00          |
| 5           | 1.05        | 9                      | 9.00          |
| 6           | 1.10        | 29                     | 29.00         |
| 7           | 1.15        | 35                     | 35.00         |
| 8           | 1.20        | 14                     | 14.00         |
| 9           | 1.25        | 7                      | 7.00          |
| 10          | 1.30        | 1                      | 1.00          |
| 11          | 1.35        | 1                      | 1.00          |

## VITRINITE TYPE DISTRIBUTION

| Vitrinite Type | Frequency (%) |
|----------------|---------------|
| V10            | 13.00         |
| V11            | 64.00         |
| V12            | 21.00         |
| V13            | 2.00          |

# Vitrinite Reflectance

FORDING COAL LIMITED  
Sample PG-88-089

Compo 401

RH = 2077

## BASIC STATISTICS

|                                      |        |
|--------------------------------------|--------|
| Total Number of Observations.....    | 100    |
| Mean Maximum Reflectance (Romax)...% | 1.04   |
| Standard Error of the Mean.....      | .01    |
| Coefficient of Variation.....%       | 6.16   |
| Variance.....                        | .0041  |
| Standard Deviation.....              | .0639  |
| Skewness.....                        | .1216  |
| Kurtosis.....                        | 2.5159 |

## CELL STATISTICS

| Cell Number | Lower Limit | Number of Observations | Frequency (%) |
|-------------|-------------|------------------------|---------------|
| 4           | 0.85        | 1                      | 1.00          |
| 5           | 0.90        | 4                      | 4.00          |
| 6           | 0.95        | 18                     | 18.00         |
| 7           | 1.00        | 33                     | 33.00         |
| 8           | 1.05        | 21                     | 21.00         |
| 9           | 1.10        | 19                     | 19.00         |
| 10          | 1.15        | 3                      | 3.00          |
| 11          | 1.20        | 1                      | 1.00          |

## VITRINITE TYPE DISTRIBUTION

| Vitrinite Type | Frequency (%) |
|----------------|---------------|
| V8             | 1.00          |
| V9             | 22.00         |
| V10            | 54.00         |
| V11            | 22.00         |
| V12            | 1.00          |

# Vitrinite Reflectance

FORDING COAL LIMITED  
Sample PG-88-090

Compo #402  
RH # 2077

## BASIC STATISTICS

|                                      |        |
|--------------------------------------|--------|
| Total Number of Observations.....    | 100    |
| Mean Maximum Reflectance (Romax)...% | 1.04   |
| Standard Error of the Mean.....      | 0.00   |
| Coefficient of Variation.....%       | 4.65   |
| Variance.....                        | .0024  |
| Standard Deviation.....              | .0486  |
| Skewness.....                        | .2615  |
| Kurtosis.....                        | 2.8591 |

## CELL STATISTICS

| Cell Number | Lower Limit | Number of Observations | Frequency (%) |
|-------------|-------------|------------------------|---------------|
| 3           | 0.90        | 1                      | 1.00          |
| 4           | 0.95        | 15                     | 15.00         |
| 5           | 1.00        | 38                     | 38.00         |
| 6           | 1.05        | 33                     | 33.00         |
| 7           | 1.10        | 10                     | 10.00         |
| 8           | 1.15        | 3                      | 3.00          |

## VITRINITE TYPE DISTRIBUTION

| Vitrinite Type | Frequency (%) |
|----------------|---------------|
| V9             | 16.00         |
| V10            | 71.00         |
| V11            | 13.00         |



# Vitrinite Reflectance

FORDING COAL LIMITED  
Sample PG-88-091

Compo #405

RH # 2077

## BASIC STATISTICS

|                                      |        |
|--------------------------------------|--------|
| Total Number of Observations.....    | 100    |
| Mean Maximum Reflectance (Romax)...% | 1.13   |
| Standard Error of the Mean.....      | .01    |
| Coefficient of Variation.....%       | 5.39   |
| Variance.....                        | .0037  |
| Standard Deviation.....              | .0607  |
| Skewness.....                        | -.2674 |
| Kurtosis.....                        | 3.2093 |

## CELL STATISTICS

| Cell Number | Lower Limit | Number of Observations | Frequency (%) |
|-------------|-------------|------------------------|---------------|
| 3           | 0.95        | 2                      | 2.00          |
| 4           | 1.00        | 5                      | 5.00          |
| 5           | 1.05        | 23                     | 23.00         |
| 6           | 1.10        | 31                     | 31.00         |
| 7           | 1.15        | 26                     | 26.00         |
| 8           | 1.20        | 10                     | 10.00         |
| 9           | 1.25        | 3                      | 3.00          |

## VITRINITE TYPE DISTRIBUTION

| Vitrinite Type | Frequency (%) |
|----------------|---------------|
| V9             | 2.00          |
| V10            | 28.00         |
| V11            | 57.00         |
| V12            | 13.00         |

# Vitrinite Reflectance

FORDING COAL LIMITED  
Sample PG-88-092

Compo 411  
RH # 2077

## BASIC STATISTICS

|                                      |        |
|--------------------------------------|--------|
| Total Number of Observations.....    | 100    |
| Mean Maximum Reflectance (Romax)...% | 1.25   |
| Standard Error of the Mean.....      | .01    |
| Coefficient of Variation.....%       | 5.11   |
| Variance.....                        | .0041  |
| Standard Deviation.....              | .0640  |
| Skewness.....                        | -.0828 |
| Kurtosis.....                        | 2.7434 |

## CELL STATISTICS

| Cell Number | Lower Limit | Number of Observations | Frequency (%) |
|-------------|-------------|------------------------|---------------|
| 4           | 1.05        | 1                      | 1.00          |
| 5           | 1.10        | 5                      | 5.00          |
| 6           | 1.15        | 14                     | 14.00         |
| 7           | 1.20        | 27                     | 27.00         |
| 8           | 1.25        | 28                     | 28.00         |
| 9           | 1.30        | 18                     | 18.00         |
| 10          | 1.35        | 6                      | 6.00          |
| 11          | 1.40        | 1                      | 1.00          |

## VITRINITE TYPE DISTRIBUTION

| Vitrinite Type | Frequency (%) |
|----------------|---------------|
| V10            | 1.00          |
| V11            | 19.00         |
| V12            | 55.00         |
| V13            | 24.00         |
| V14            | 1.00          |

# Vitrinite Reflectance

FORDING COAL LIMITED  
Sample PG-88-102

Compo 425

RH #2078

## BASIC STATISTICS

|                                      |        |
|--------------------------------------|--------|
| Total Number of Observations.....    | 100    |
| Mean Maximum Reflectance (Romax)...% | 1.05   |
| Standard Error of the Mean.....      | .01    |
| Coefficient of Variation.....%       | 5.36   |
| Variance.....                        | .0031  |
| Standard Deviation.....              | .0561  |
| Skewness.....                        | .0457  |
| Kurtosis.....                        | 3.0876 |

## CELL STATISTICS

| Cell Number | Lower Limit | Number of Observations | Frequency (%) |
|-------------|-------------|------------------------|---------------|
| 4           | 0.85        | 1                      | 1.00          |
| 5           | 0.90        | 2                      | 2.00          |
| 6           | 0.95        | 15                     | 15.00         |
| 7           | 1.00        | 33                     | 33.00         |
| 8           | 1.05        | 27                     | 27.00         |
| 9           | 1.10        | 18                     | 18.00         |
| 10          | 1.15        | 3                      | 3.00          |
| 11          | 1.20        | 1                      | 1.00          |

## VITRINITE TYPE DISTRIBUTION

| Vitrinite Type | Frequency (%) |
|----------------|---------------|
| V8             | 1.00          |
| V9             | 17.00         |
| V10            | 60.00         |
| V11            | 21.00         |
| V12            | 1.00          |

# Vitrinite Reflectance

FORDING COAL LIMITED  
Sample PG-88-103

Compo # 426

RH # 2078

## BASIC STATISTICS

|                                      |        |
|--------------------------------------|--------|
| Total Number of Observations.....    | 100    |
| Mean Maximum Reflectance (Romax)...% | 1.03   |
| Standard Error of the Mean.....      | 0.00   |
| Coefficient of Variation.....%       | 4.84   |
| Variance.....                        | .0025  |
| Standard Deviation.....              | .0499  |
| Skewness.....                        | -.0980 |
| Kurtosis.....                        | 2.5825 |

## CELL STATISTICS

| Cell Number | Lower Limit | Number of Observations | Frequency (%) |
|-------------|-------------|------------------------|---------------|
| 3           | 0.90        | 4                      | 4.00          |
| 4           | 0.95        | 22                     | 22.00         |
| 5           | 1.00        | 31                     | 31.00         |
| 6           | 1.05        | 34                     | 34.00         |
| 7           | 1.10        | 8                      | 8.00          |
| 8           | 1.15        | 1                      | 1.00          |

## VITRINITE TYPE DISTRIBUTION

| Vitrinite Type | Frequency (%) |
|----------------|---------------|
| V9             | 26.00         |
| V10            | 65.00         |
| V11            | 9.00          |

# Vitrinite Reflectance

FORDING COAL LIMITED  
Sample PG-88-104

Compo #427  
RH #2078

## BASIC STATISTICS

|                                      |        |
|--------------------------------------|--------|
| Total Number of Observations.....    | 100    |
| Mean Maximum Reflectance (Romax)...% | 1.16   |
| Standard Error of the Mean.....      | .01    |
| Coefficient of Variation.....%       | 5.00   |
| Variance.....                        | .0034  |
| Standard Deviation.....              | .0580  |
| Skewness.....                        | -.2601 |
| Kurtosis.....                        | 2.5125 |

## CELL STATISTICS

| Cell Number | Lower Limit | Number of Observations | Frequency (%) |
|-------------|-------------|------------------------|---------------|
| 3           | 1.00        | 1                      | 1.00          |
| 4           | 1.05        | 14                     | 14.00         |
| 5           | 1.10        | 22                     | 22.00         |
| 6           | 1.15        | 29                     | 29.00         |
| 7           | 1.20        | 28                     | 28.00         |
| 8           | 1.25        | 6                      | 6.00          |

## VITRINITE TYPE DISTRIBUTION

| Vitrinite Type | Frequency (%) |
|----------------|---------------|
| V10            | 15.00         |
| V11            | 51.00         |
| V12            | 34.00         |

# Vitrinite Reflectance

FORDING COAL LIMITED  
Sample PG-88-105

Compo 428  
RH #2078

## BASIC STATISTICS

|                                      |        |
|--------------------------------------|--------|
| Total Number of Observations.....    | 100    |
| Mean Maximum Reflectance (Romax)...% | 1.15   |
| Standard Error of the Mean.....      | .01    |
| Coefficient of Variation.....%       | 5.31   |
| Variance.....                        | .0037  |
| Standard Deviation.....              | .0612  |
| Skewness.....                        | -.5426 |
| Kurtosis.....                        | 2.9595 |

## CELL STATISTICS

| Cell Number | Lower Limit | Number of Observations | Frequency (%) |
|-------------|-------------|------------------------|---------------|
| 3           | 0.95        | 1                      | 1.00          |
| 4           | 1.00        | 3                      | 3.00          |
| 5           | 1.05        | 16                     | 16.00         |
| 6           | 1.10        | 25                     | 25.00         |
| 7           | 1.15        | 28                     | 28.00         |
| 8           | 1.20        | 25                     | 25.00         |
| 9           | 1.25        | 2                      | 2.00          |

## VITRINITE TYPE DISTRIBUTION

| Vitrinite Type | Frequency (%) |
|----------------|---------------|
| V9             | 1.00          |
| V10            | 19.00         |
| V11            | 53.00         |
| V12            | 27.00         |

# Vitrinite Reflectance

FORDING COAL LIMITED  
Sample PG-88-106

Compo 430  
RH # 2078

### BASIC STATISTICS

|                                      |        |
|--------------------------------------|--------|
| Total Number of Observations.....    | 100    |
| Mean Maximum Reflectance (Romax)...% | 1.24   |
| Standard Error of the Mean.....      | .01    |
| Coefficient of Variation.....%       | 4.80   |
| Variance.....                        | .0036  |
| Standard Deviation.....              | .0597  |
| Skewness.....                        | -.0882 |
| Kurtosis.....                        | 3.9079 |

### CELL STATISTICS

| Cell Number | Lower Limit | Number of Observations | Frequency (%) |
|-------------|-------------|------------------------|---------------|
| 4           | 1.05        | 1                      | 1.00          |
| 5           | 1.10        | 3                      | 3.00          |
| 6           | 1.15        | 15                     | 15.00         |
| 7           | 1.20        | 34                     | 34.00         |
| 8           | 1.25        | 29                     | 29.00         |
| 9           | 1.30        | 16                     | 16.00         |
| 10          | 1.35        | 1                      | 1.00          |
| 11          | 1.40        | 1                      | 1.00          |

### VITRINITE TYPE DISTRIBUTION

| Vitrinite Type | Frequency (%) |
|----------------|---------------|
| V10            | 1.00          |
| V11            | 18.00         |
| V12            | 63.00         |
| V13            | 17.00         |
| V14            | 1.00          |

# Vitrinite Reflectance

FORDING COAL LIMITED  
Sample PG-88-084

Compo 386

RH # 2079

## BASIC STATISTICS

|                                      |        |
|--------------------------------------|--------|
| Total Number of Observations.....    | 100    |
| Mean Maximum Reflectance (Romax)...% | 1.04   |
| Standard Error of the Mean.....      | 0.00   |
| Coefficient of Variation.....%       | 4.29   |
| Variance.....                        | .0020  |
| Standard Deviation.....              | .0445  |
| Skewness.....                        | -.2143 |
| Kurtosis.....                        | 2.6288 |

## CELL STATISTICS

| Cell Number | Lower Limit | Number of Observations | Frequency (%) |
|-------------|-------------|------------------------|---------------|
| 3           | 0.90        | 3                      | 3.00          |
| 4           | 0.95        | 12                     | 12.00         |
| 5           | 1.00        | 40                     | 40.00         |
| 6           | 1.05        | 35                     | 35.00         |
| 7           | 1.10        | 10                     | 10.00         |

## VITRINITE TYPE DISTRIBUTION

| Vitrinite Type | Frequency (%) |
|----------------|---------------|
| V9             | 15.00         |
| V10            | 75.00         |
| V11            | 10.00         |



# Vitrinite Reflectance

FORDING COAL LIMITED  
Sample PG-88-085

Compo 387

RH # 2079

## BASIC STATISTICS

|                                      |        |
|--------------------------------------|--------|
| Total Number of Observations.....    | 100    |
| Mean Maximum Reflectance (Romax)...% | 1.07   |
| Standard Error of the Mean.....      | .01    |
| Coefficient of Variation.....%       | 4.96   |
| Variance.....                        | .0028  |
| Standard Deviation.....              | .0530  |
| Skewness.....                        | -.3807 |
| Kurtosis.....                        | 3.3743 |

## CELL STATISTICS

| Cell Number | Lower Limit | Number of Observations | Frequency (%) |
|-------------|-------------|------------------------|---------------|
| 3           | 0.90        | 3                      | 3.00          |
| 4           | 0.95        | 6                      | 6.00          |
| 5           | 1.00        | 21                     | 21.00         |
| 6           | 1.05        | 34                     | 34.00         |
| 7           | 1.10        | 33                     | 33.00         |
| 8           | 1.15        | 2                      | 2.00          |
| 9           | 1.20        | 1                      | 1.00          |

## VITRINITE TYPE DISTRIBUTION

| Vitrinite Type | Frequency (%) |
|----------------|---------------|
| V9             | 9.00          |
| V10            | 55.00         |
| V11            | 35.00         |
| V12            | 1.00          |

# Vitrinite Reflectance

FORDING COAL LIMITED  
Sample PG-88-086

Compo # 390  
RH # 2079

## BASIC STATISTICS

|                                      |        |
|--------------------------------------|--------|
| Total Number of Observations.....    | 100    |
| Mean Maximum Reflectance (Romax)...% | 1.16   |
| Standard Error of the Mean.....      | .01    |
| Coefficient of Variation.....%       | 4.97   |
| Variance.....                        | .0033  |
| Standard Deviation.....              | .0578  |
| Skewness.....                        | -.4760 |
| Kurtosis.....                        | 3.9883 |

## CELL STATISTICS

| Cell Number | Lower Limit | Number of Observations | Frequency (%) |
|-------------|-------------|------------------------|---------------|
| 4           | 0.95        | 1                      | 1.00          |
| 5           | 1.00        | 3                      | 3.00          |
| 6           | 1.05        | 7                      | 7.00          |
| 7           | 1.10        | 25                     | 25.00         |
| 8           | 1.15        | 37                     | 37.00         |
| 9           | 1.20        | 20                     | 20.00         |
| 10          | 1.25        | 5                      | 5.00          |
| 11          | 1.30        | 2                      | 2.00          |

## VITRINITE TYPE DISTRIBUTION

| Vitrinite Type | Frequency (%) |
|----------------|---------------|
| V9             | 1.00          |
| V10            | 10.00         |
| V11            | 62.00         |
| V12            | 25.00         |
| V13            | 2.00          |

# Vitrinite Reflectance

FORDING COAL LIMITED  
 Sample PG-88-087

Comp 393

RH \* 2079

## BASIC STATISTICS

|                                      |        |
|--------------------------------------|--------|
| Total Number of Observations.....    | 100    |
| Mean Maximum Reflectance (Romax)...% | 1.18   |
| Standard Error of the Mean.....      | .01    |
| Coefficient of Variation.....%       | 4.75   |
| Variance.....                        | .0031  |
| Standard Deviation.....              | .0560  |
| Skewness.....                        | .0358  |
| Kurtosis.....                        | 2.7589 |

## CELL STATISTICS

| Cell Number | Lower Limit | Number of Observations | Frequency (%) |
|-------------|-------------|------------------------|---------------|
| 3           | 1.00        | 1                      | 1.00          |
| 4           | 1.05        | 4                      | 4.00          |
| 5           | 1.10        | 21                     | 21.00         |
| 6           | 1.15        | 35                     | 35.00         |
| 7           | 1.20        | 25                     | 25.00         |
| 8           | 1.25        | 12                     | 12.00         |
| 9           | 1.30        | 2                      | 2.00          |

## VITRINITE TYPE DISTRIBUTION

| Vitrinite Type | Frequency (%) |
|----------------|---------------|
| V10            | 5.00          |
| V11            | 56.00         |
| V12            | 37.00         |
| V13            | 2.00          |

# Vitrinite Reflectance

FORDING COAL LIMITED  
Sample PG-88-088

Compo 396

RH # 2079

## BASIC STATISTICS

|                                      |        |
|--------------------------------------|--------|
| Total Number of Observations.....    | 100    |
| Mean Maximum Reflectance (Romax)...% | 1.22   |
| Standard Error of the Mean.....      | 0.00   |
| Coefficient of Variation.....%       | 4.01   |
| Variance.....                        | .0024  |
| Standard Deviation.....              | .0491  |
| Skewness.....                        | -.2091 |
| Kurtosis.....                        | 2.6646 |

## CELL STATISTICS

| Cell Number | Lower Limit | Number of Observations | Frequency (%) |
|-------------|-------------|------------------------|---------------|
| 3           | 1.10        | 7                      | 7.00          |
| 4           | 1.15        | 18                     | 18.00         |
| 5           | 1.20        | 37                     | 37.00         |
| 6           | 1.25        | 31                     | 31.00         |
| 7           | 1.30        | 7                      | 7.00          |

## VITRINITE TYPE DISTRIBUTION

| Vitrinite Type | Frequency (%) |
|----------------|---------------|
| V11            | 25.00         |
| V12            | 68.00         |
| V13            | 7.00          |

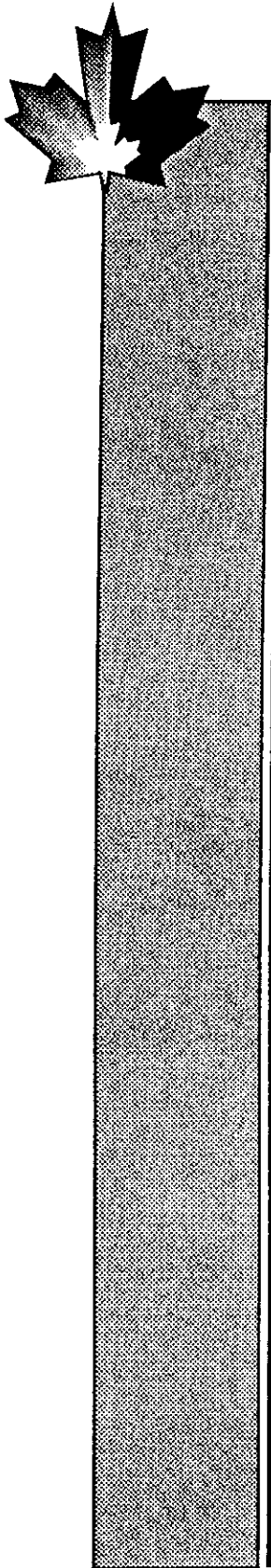

Petrographic Analysis

for

Fording Coal Limited.

Compo 386

SAMPLE IDENTIFICATION

Laboratory number M6701  
Sample PG-88-084  
Est. Ash 9.50% Est. Sulphur 0.40%

RH #2079  
12 upper

PETROGRAPHIC INDICES

Mean Maximum Reflectance.....% 1.04  
Composition Balance Index..... 0.44  
Calculated Strength Index..... 3.69  
Calculated Stability Index..... 43  
Estimated Coke Strength DI 30/15..... 91.3  
Predicted Free Swelling Index..... 8.5 - 9

DISTRIBUTION OF VITRINITE TYPES

V - 9.....% 15  
V - 10.....% 75  
V - 11.....% 10

REACTIVE COMPONENTS

Vitrinite.....% 77.7  
Exinite.....% 0.9  
Reactive Semifusinite.....% 6.2  
Total Reactives.....% 84.8

INERT COMPONENTS

Macrinite.....% 2.7  
Inert Semifusinite.....% 5.9  
Fusinite.....% 0.8  
Inertodetrinite.....% 0.6  
Mineral Matter.....% 5.2  
Total Inerts.....% 15.2

Analysis Completed : October 31, 1988 12:21 PM

David E. Pearson & Associates Ltd.

Organic Petrographers & Geologists

4277 Houlihan Place, Victoria, British Columbia, Canada. V8N 3T2

Telephones (604) 477-2548 & 380-8324 Fax (604) 477-4775

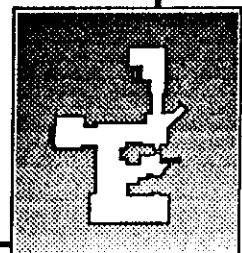

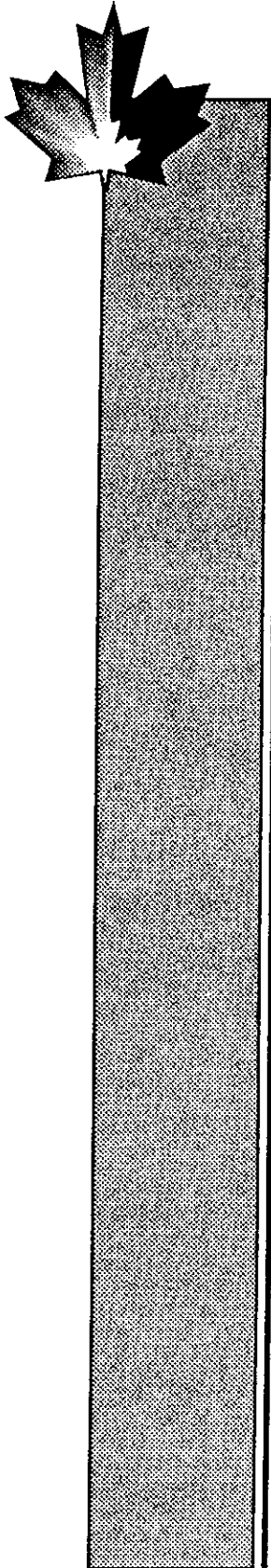

# Petrographic Analysis

for

## Fording Coal Limited.

*Compo 387*

### SAMPLE IDENTIFICATION

Laboratory number M6702

Sample PG-88-085

Est. Ash 9.50% Est. Sulphur 0.40%

*RH #2079*

*12*

### PETROGRAPHIC INDICES

|                                       |         |
|---------------------------------------|---------|
| Mean Maximum Reflectance.....%        | 1.07    |
| Composition Balance Index.....        | 0.49    |
| Calculated Strength Index.....        | 3.93    |
| Calculated Stability Index.....       | 49      |
| Estimated Coke Strength DI 30/15..... | 92.9    |
| Predicted Free Swelling Index.....    | 8.5 - 9 |

### DISTRIBUTION OF VITRINITE TYPES

|              |    |
|--------------|----|
| V - 9.....%  | 9  |
| V - 10.....% | 55 |
| V - 11.....% | 35 |
| V - 12.....% | 1  |

### REACTIVE COMPONENTS

|                             |      |
|-----------------------------|------|
| Vitrinite.....%             | 75.1 |
| Exinite.....%               | 1.4  |
| Reactive Semifusinite.....% | 7.2  |
| Total Reactives.....%       | 83.7 |

### INERT COMPONENTS

|                          |      |
|--------------------------|------|
| Macrinite.....%          | 1.6  |
| Inert Semifusinite.....% | 7.7  |
| Fusinite.....%           | 1.0  |
| Inertodetrinite.....%    | 0.8  |
| Mineral Matter.....%     | 5.2  |
| Total Inerts.....%       | 16.3 |

Analysis Completed : October 31, 1988 12:35 PM

*David E. Pearson & Associates Ltd.*

Organic Petrographers & Geologists

4277 Houlihan Place, Victoria, British Columbia, Canada. V8N 3T2

Telephones (604) 477-2548 & 380-8324 Fax (604) 477-4775

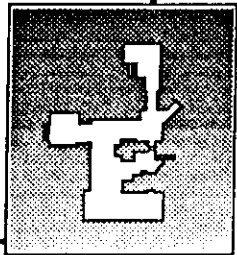



# Petrographic Analysis

for

## Fording Coal Limited.

Compo 390

### SAMPLE IDENTIFICATION

Laboratory number M6703

Sample PG-88-086

Est. Ash 9.50% Est. Sulphur 0.40%

RH 2079

Hupper

### PETROGRAPHIC INDICES

|                                       |      |
|---------------------------------------|------|
| Mean Maximum Reflectance.....%        | 1.16 |
| Composition Balance Index.....        | 1.35 |
| Calculated Strength Index.....        | 4.42 |
| Calculated Stability Index.....       | 56   |
| Estimated Coke Strength DI 30/15..... | 93.8 |
| Predicted Free Swelling Index.....    | 7    |

### DISTRIBUTION OF VITRINITE TYPES

|              |    |
|--------------|----|
| V - 9.....%  | 1  |
| V - 10.....% | 10 |
| V - 11.....% | 62 |
| V - 12.....% | 25 |
| V - 13.....% | 2  |

### REACTIVE COMPONENTS

|                             |      |
|-----------------------------|------|
| Vitrinite.....%             | 52.2 |
| Exinite.....%               | 0.7  |
| Reactive Semifusinite.....% | 14.5 |
| Total Reactives.....%       | 67.4 |

### INERT COMPONENTS

|                          |      |
|--------------------------|------|
| Macrinite.....%          | 2.4  |
| Inert Semifusinite.....% | 21.6 |
| Fusinite.....%           | 2.5  |
| Inertodetrinite.....%    | 0.9  |
| Mineral Matter.....%     | 5.2  |
| Total Inerts.....%       | 32.6 |

Analysis Completed : October 31, 1988 1:48 PM

**David E. Pearson & Associates Ltd.**

Organic Petrographers & Geologists

4277 Houlihan Place, Victoria, British Columbia, Canada. V8N 3T2

Telephones (604) 477-2548 & 380-8324 Fax (604) 477-4775

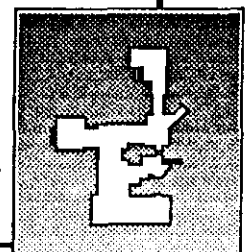



Petrographic Analysis  
for  
**Fording Coal Limited.**

Compo # 393

**SAMPLE IDENTIFICATION** RH → 2079  
Laboratory number M6704 # 11  
Sample PG-88-087  
Est. Ash 9.50% Est. Sulphur 0.40%

**PETROGRAPHIC INDICES**  
Mean Maximum Reflectance.....% 1.18  
Composition Balance Index..... 1.44  
Calculated Strength Index..... 4.49  
Calculated Stability Index..... 56  
Estimated Coke Strength DI 30/15..... 93.8  
Predicted Free Swelling Index..... 7

**DISTRIBUTION OF VITRINITE TYPES**  
V - 10.....% 5  
V - 11.....% 56  
V - 12.....% 37  
V - 13.....% 2

**REACTIVE COMPONENTS**  
Vitrinite.....% 47.5  
Exinite.....% 0.4  
Reactive Semifusinite.....% 18.7  
Total Reactives.....% 66.6

**INERT COMPONENTS**  
Macrinite.....% 2.1  
Inert Semifusinite.....% 22.8  
Fusinite.....% 2.7  
Inertodetrinite.....% 0.6  
Mineral Matter.....% 5.2  
Total Inerts.....% 33.4

Analysis Completed : October 31, 1988 2:59 PM

**David E. Pearson & Associates Ltd.**

Organic Petrographers & Geologists

4277 Houlihan Place, Victoria, British Columbia, Canada. V8N 3T2  
Telephones (604) 477-2548 & 380-8324 Fax (604) 477-4775

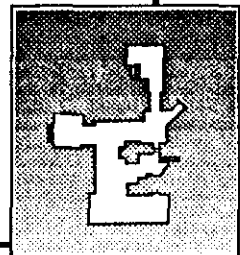



# Vitrinite Reflectance

FORDING COAL LIMITED  
Sample PG-88-099

Compo #419  
RH # 2080

## BASIC STATISTICS

|                                      |        |
|--------------------------------------|--------|
| Total Number of Observations.....    | 100    |
| Mean Maximum Reflectance (Romax)...% | 1.24   |
| Standard Error of the Mean.....      | .01    |
| Coefficient of Variation.....%       | 4.59   |
| Variance.....                        | .0032  |
| Standard Deviation.....              | .0567  |
| Skewness.....                        | .2143  |
| Kurtosis.....                        | 2.6548 |

## CELL STATISTICS

| Cell Number | Lower Limit | Number of Observations | Frequency (%) |
|-------------|-------------|------------------------|---------------|
| 3           | 1.10        | 4                      | 4.00          |
| 4           | 1.15        | 23                     | 23.00         |
| 5           | 1.20        | 28                     | 28.00         |
| 6           | 1.25        | 31                     | 31.00         |
| 7           | 1.30        | 10                     | 10.00         |
| 8           | 1.35        | 4                      | 4.00          |

## VITRINITE TYPE DISTRIBUTION

| Vitrinite Type | Frequency (%) |
|----------------|---------------|
| V11            | 27.00         |
| V12            | 59.00         |
| V13            | 14.00         |

# Vitrinite Reflectance

FORDING COAL LIMITED  
Sample PG-88-100

Compo #420  
RH #2080

## BASIC STATISTICS

|                                      |        |
|--------------------------------------|--------|
| Total Number of Observations.....    | 100    |
| Mean Maximum Reflectance (Romax)...% | 1.25   |
| Standard Error of the Mean.....      | .01    |
| Coefficient of Variation.....%       | 4.15   |
| Variance.....                        | .0027  |
| Standard Deviation.....              | .0520  |
| Skewness.....                        | -.6190 |
| Kurtosis.....                        | 3.3508 |

## CELL STATISTICS

| Cell Number | Lower Limit | Number of Observations | Frequency (%) |
|-------------|-------------|------------------------|---------------|
| 3           | 1.05        | 1                      | 1.00          |
| 4           | 1.10        | 4                      | 4.00          |
| 5           | 1.15        | 8                      | 8.00          |
| 6           | 1.20        | 31                     | 31.00         |
| 7           | 1.25        | 36                     | 36.00         |
| 8           | 1.30        | 19                     | 19.00         |
| 9           | 1.35        | 1                      | 1.00          |

## VITRINITE TYPE DISTRIBUTION

| Vitrinite Type | Frequency (%) |
|----------------|---------------|
| V10            | 1.00          |
| V11            | 12.00         |
| V12            | 67.00         |
| V13            | 20.00         |

# Vitrinite Reflectance

FORDING COAL LIMITED  
Sample PG-88-101

Compo 422  
RH + 2080

## BASIC STATISTICS

|                                      |        |
|--------------------------------------|--------|
| Total Number of Observations.....    | 100    |
| Mean Maximum Reflectance (Romax)...% | 1.32   |
| Standard Error of the Mean.....      | .01    |
| Coefficient of Variation.....%       | 4.76   |
| Variance.....                        | .0039  |
| Standard Deviation.....              | .0628  |
| Skewness.....                        | .0854  |
| Kurtosis.....                        | 3.7099 |

## CELL STATISTICS

| Cell Number | Lower Limit | Number of Observations | Frequency (%) |
|-------------|-------------|------------------------|---------------|
| 4           | 1.15        | 3                      | 3.00          |
| 5           | 1.20        | 7                      | 7.00          |
| 6           | 1.25        | 19                     | 19.00         |
| 7           | 1.30        | 37                     | 37.00         |
| 8           | 1.35        | 21                     | 21.00         |
| 9           | 1.40        | 10                     | 10.00         |
| 10          | 1.45        | 2                      | 2.00          |
| 11          | 1.50        | 1                      | 1.00          |

## VITRINITE TYPE DISTRIBUTION

| Vitrinite Type | Frequency (%) |
|----------------|---------------|
| V11            | 3.00          |
| V12            | 26.00         |
| V13            | 58.00         |
| V14            | 12.00         |
| V15            | 1.00          |

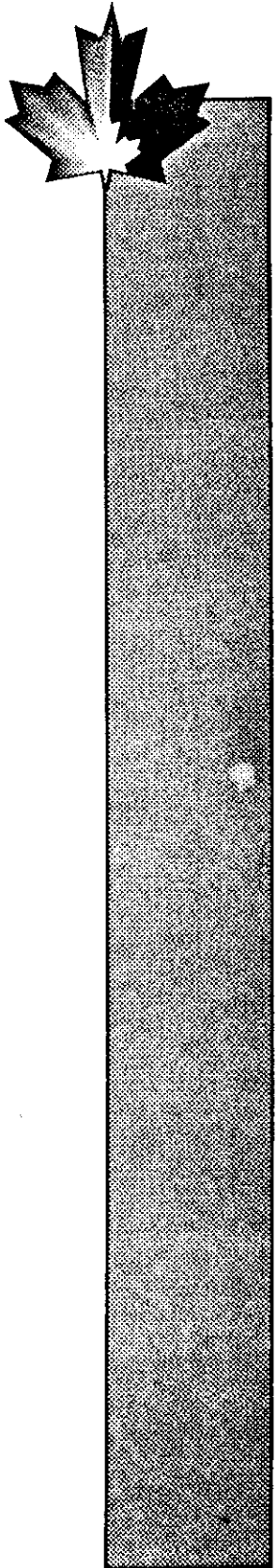

Petrographic Analysis  
for  
**Fording Coal Limited.**

**SAMPLE IDENTIFICATION**

Laboratory number M6980

**PG-88-151**

Ash 18.70% Sulphur 0.69%

*Compo 521*

*RH #2081*

**PETROGRAPHIC INDICES**

|                                       |      |
|---------------------------------------|------|
| Mean Maximum Reflectance.....%        | 1.09 |
| Composition Balance Index.....        | 0.82 |
| Calculated Strength Index.....        | 4.16 |
| Calculated Stability Index.....       | 57   |
| Estimated Coke Strength DI 30/15..... | 93.9 |
| Predicted Free Swelling Index.....    | 8.5  |

**DISTRIBUTION OF VITRINITE TYPES**

|              |    |
|--------------|----|
| V - 9.....%  | 2  |
| V - 10.....% | 53 |
| V - 11.....% | 44 |
| V - 12.....% | 1  |

**REACTIVE COMPONENTS**

|                             |      |
|-----------------------------|------|
| Vitrinite.....%             | 64.1 |
| Exinite.....%               | 1.7  |
| Reactive Semifusinite.....% | 9.7  |
| Total Reactives.....%       | 75.5 |

**INERT COMPONENTS**

|                          |      |
|--------------------------|------|
| Macrinite.....%          | 1.5  |
| Inert Semifusinite.....% | 10.4 |
| Fusinite.....%           | 1.6  |
| Inertodetrinite.....%    | 0.7  |
| Mineral Matter.....%     | 10.3 |
| Total Inerts.....%       | 24.5 |

Analysis Completed : November 28, 1988 8:21 PM

**David E. Pearson & Associates Ltd.**

Organic Petrographers & Geologists

4277 Houlihan Place, Victoria, British Columbia, Canada. V8N 3T2

Telephones (604) 477-2548 & 380-8324 Fax (604) 477-4775

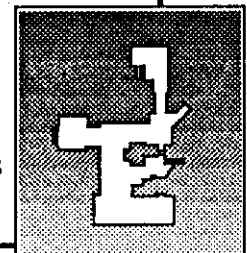

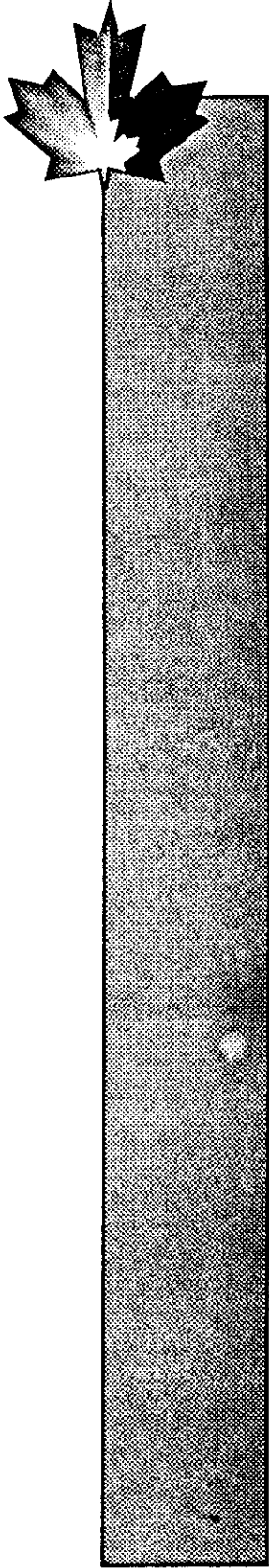

Petrographic Analysis  
for  
**Fording Coal Limited.**

**SAMPLE IDENTIFICATION**

Laboratory number M6981  
PG-88-152  
Ash 17.60% Sulphur 0.47%

*Compo 524*  
*RH # 2081*

**PETROGRAPHIC INDICES**

|                                                   |      |
|---------------------------------------------------|------|
| Mean Maximum Reflectance.....%                    | 1.18 |
| Composition Balance Index.....                    | 1.08 |
| Calculated Strength Index.....                    | 4.58 |
| Calculated Stability Index.....                   | 61   |
| Estimated Coke Strength DI <sub>30/15</sub> ..... | 93.9 |
| Predicted Free Swelling Index.....                | 8    |

**DISTRIBUTION OF VITRINITE TYPES**

|              |    |
|--------------|----|
| V - 10.....% | 6  |
| V - 11.....% | 58 |
| V - 12.....% | 33 |
| V - 13.....% | 3  |

**REACTIVE COMPONENTS**

|                             |      |
|-----------------------------|------|
| Vitrinite.....%             | 53.1 |
| Exinite.....%               | 0.5  |
| Reactive Semifusinite.....% | 18.9 |
| Total Reactives.....%       | 72.5 |

**INERT COMPONENTS**

|                          |      |
|--------------------------|------|
| Macrinite.....%          | 1.5  |
| Inert Semifusinite.....% | 14.8 |
| Fusinite.....%           | 1.0  |
| Inertodetrinite.....%    | 0.6  |
| Mineral Matter.....%     | 9.6  |
| Total Inerts.....%       | 27.5 |

Analysis Completed : November 28, 1988 8:52 PM

**David E. Pearson & Associates Ltd.**

Organic Petrographers & Geologists

4277 Houlihan Place, Victoria, British Columbia, Canada. V8N 3T2  
Telephones (604) 477-2548 & 380-8324 Fax (604) 477-4775

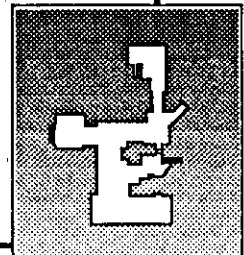

# Vitrinite Reflectance

FORDING COAL LIMITED  
Sample PG-88-149

Compo 515  
QA # 2082

## BASIC STATISTICS

|                                      |        |
|--------------------------------------|--------|
| Total Number of Observations.....    | 100    |
| Mean Maximum Reflectance (Romax)...% | 1.16   |
| Standard Error of the Mean.....      | .01    |
| Coefficient of Variation.....%       | 5.08   |
| Variance.....                        | .0035  |
| Standard Deviation.....              | .0590  |
| Skewness.....                        | -.0048 |
| Kurtosis.....                        | 2.5190 |

## CELL STATISTICS

| Cell Number | Lower Limit | Number of Observations | Frequency (%) |
|-------------|-------------|------------------------|---------------|
| 3           | 1.00        | 3                      | 3.00          |
| 4           | 1.05        | 10                     | 10.00         |
| 5           | 1.10        | 25                     | 25.00         |
| 6           | 1.15        | 31                     | 31.00         |
| 7           | 1.20        | 22                     | 22.00         |
| 8           | 1.25        | 9                      | 9.00          |

## VITRINITE TYPE DISTRIBUTION

| Vitrinite Type | Frequency (%) |
|----------------|---------------|
| V10            | 13.00         |
| V11            | 56.00         |
| V12            | 31.00         |

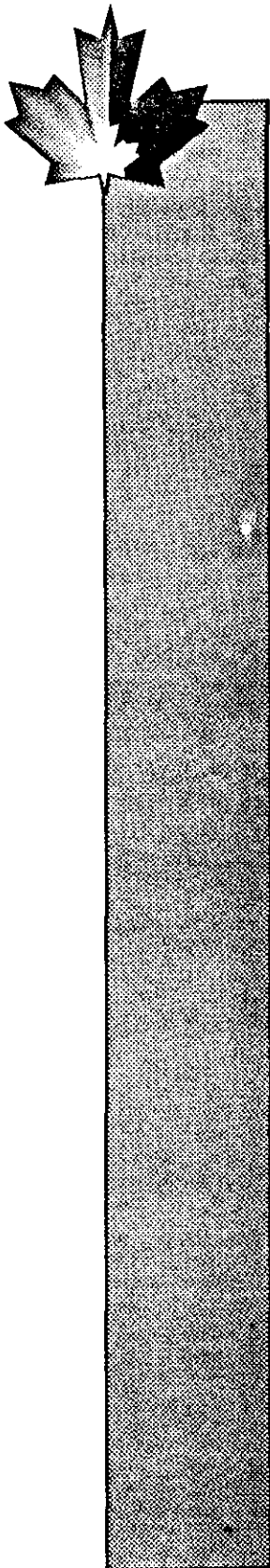

Petrographic Analysis  
for  
**Fording Coal Limited.**

**SAMPLE IDENTIFICATION**

Laboratory number M6979  
**PG-88-150**  
Ash 19.20% Sulphur 0.74%

*Compo 516*  
*RH #2082*

**PETROGRAPHIC INDICES**

|                                       |      |
|---------------------------------------|------|
| Mean Maximum Reflectance.....%        | 1.17 |
| Composition Balance Index.....        | 1.23 |
| Calculated Strength Index.....        | 4.48 |
| Calculated Stability Index.....       | 59   |
| Estimated Coke Strength DI 30/15..... | 93.9 |
| Predicted Free Swelling Index.....    | 8    |

**DISTRIBUTION OF VITRINITE TYPES**

|              |    |
|--------------|----|
| V - 10.....% | 8  |
| V - 11.....% | 63 |
| V - 12.....% | 28 |
| V - 13.....% | 1  |

**REACTIVE COMPONENTS**

|                             |      |
|-----------------------------|------|
| Vitrinite.....%             | 55.3 |
| Exinite.....%               | 0.5  |
| Reactive Semifusinite.....% | 13.7 |
| Total Reactives.....%       | 69.5 |

**INERT COMPONENTS**

|                          |      |
|--------------------------|------|
| Macrinite.....%          | 2.3  |
| Inert Semifusinite.....% | 14.1 |
| Fusinite.....%           | 2.0  |
| Inertodetrinite.....%    | 1.4  |
| Contaminants.....%       | 0.1  |
| Mineral Matter.....%     | 10.6 |
| Total Inerts.....%       | 30.5 |

Analysis Completed : November 14, 1988 12:17 PM

**David E. Pearson & Associates Ltd.**

Organic Petrographers & Geologists  
4277 Houlihan Place, Victoria, British Columbia, Canada. V8N 3T2  
Telephones (604) 477-2548 & 380-8324 Fax (604) 477-4775

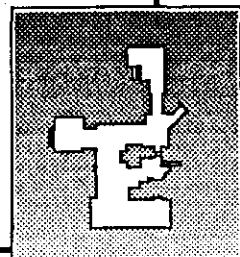

# Vitrinite Reflectance

FORDING COAL LIMITED  
Sample PG-88-133

Compo 469

RH #2083

## BASIC STATISTICS

|                                      |        |
|--------------------------------------|--------|
| Total Number of Observations.....    | 100    |
| Mean Maximum Reflectance (Romax)...% | 1.14   |
| Standard Error of the Mean.....      | .01    |
| Coefficient of Variation.....%       | 4.88   |
| Variance.....                        | .0031  |
| Standard Deviation.....              | .0558  |
| Skewness.....                        | -.0423 |
| Kurtosis.....                        | 2.4046 |

## CELL STATISTICS

| Cell Number | Lower Limit | Number of Observations | Frequency (%) |
|-------------|-------------|------------------------|---------------|
| 3           | 1.00        | 5                      | 5.00          |
| 4           | 1.05        | 16                     | 16.00         |
| 5           | 1.10        | 32                     | 32.00         |
| 6           | 1.15        | 27                     | 27.00         |
| 7           | 1.20        | 18                     | 18.00         |
| 8           | 1.25        | 2                      | 2.00          |

## VITRINITE TYPE DISTRIBUTION

| Vitrinite Type | Frequency (%) |
|----------------|---------------|
| V10            | 21.00         |
| V11            | 59.00         |
| V12            | 20.00         |



# Vitrinite Reflectance

FORDING COAL LIMITED  
Sample PG-88-134

Compo 471  
RH #2083

## BASIC STATISTICS

|                                      |        |
|--------------------------------------|--------|
| Total Number of Observations.....    | 100    |
| Mean Maximum Reflectance (Romax)...% | 1.16   |
| Standard Error of the Mean.....      | 0.00   |
| Coefficient of Variation.....%       | 3.63   |
| Variance.....                        | .0018  |
| Standard Deviation.....              | .0419  |
| Skewness.....                        | .2692  |
| Kurtosis.....                        | 3.3645 |

## CELL STATISTICS

| Cell Number | Lower Limit | Number of Observations | Frequency (%) |
|-------------|-------------|------------------------|---------------|
| 3           | 1.05        | 6                      | 6.00          |
| 4           | 1.10        | 33                     | 33.00         |
| 5           | 1.15        | 44                     | 44.00         |
| 6           | 1.20        | 14                     | 14.00         |
| 7           | 1.25        | 3                      | 3.00          |

## VITRINITE TYPE DISTRIBUTION

| Vitrinite Type | Frequency (%) |
|----------------|---------------|
| V10            | 6.00          |
| V11            | 77.00         |
| V12            | 17.00         |

# Vitrinite Reflectance

FORDING COAL LIMITED  
Sample PG-88-135

Compo 473

RH #2083

## BASIC STATISTICS

|                                      |        |
|--------------------------------------|--------|
| Total Number of Observations.....    | 100    |
| Mean Maximum Reflectance (Romax)...% | 1.24   |
| Standard Error of the Mean.....      | 0.00   |
| Coefficient of Variation.....%       | 4.02   |
| Variance.....                        | .0025  |
| Standard Deviation.....              | .0498  |
| Skewness.....                        | .2175  |
| Kurtosis.....                        | 2.8836 |

## CELL STATISTICS

| Cell Number | Lower Limit | Number of Observations | Frequency (%) |
|-------------|-------------|------------------------|---------------|
| 3           | 1.10        | 1                      | 1.00          |
| 4           | 1.15        | 22                     | 22.00         |
| 5           | 1.20        | 29                     | 29.00         |
| 6           | 1.25        | 38                     | 38.00         |
| 7           | 1.30        | 8                      | 8.00          |
| 8           | 1.35        | 2                      | 2.00          |

## VITRINITE TYPE DISTRIBUTION

| Vitrinite Type | Frequency (%) |
|----------------|---------------|
| V11            | 23.00         |
| V12            | 67.00         |
| V13            | 10.00         |

# Vitrinite Reflectance

FORDING COAL LIMITED  
Sample PG-88-107

Compo A34  
RH # 2084

## BASIC STATISTICS

|                                      |        |
|--------------------------------------|--------|
| Total Number of Observations.....    | 100    |
| Mean Maximum Reflectance (Romax)...% | 1.29   |
| Standard Error of the Mean.....      | 0.00   |
| Coefficient of Variation.....%       | 3.14   |
| Variance.....                        | .0017  |
| Standard Deviation.....              | .0407  |
| Skewness.....                        | -.2300 |
| Kurtosis.....                        | 2.7855 |

## CELL STATISTICS

| Cell Number | Lower Limit | Number of Observations | Frequency (%) |
|-------------|-------------|------------------------|---------------|
| 2           | 1.20        | 13                     | 13.00         |
| 3           | 1.25        | 34                     | 34.00         |
| 4           | 1.30        | 43                     | 43.00         |
| 5           | 1.35        | 10                     | 10.00         |

## VITRINITE TYPE DISTRIBUTION

| Vitrinite Type | Frequency (%) |
|----------------|---------------|
| V12            | 47.00         |
| V13            | 53.00         |

# Vitrinite Reflectance

**FORDING COAL LIMITED**  
**Sample PG-88-108**

Compo 435

RH # 2084

### BASIC STATISTICS

|                                      |        |
|--------------------------------------|--------|
| Total Number of Observations.....    | 100    |
| Mean Maximum Reflectance (Romax)...% | 1.33   |
| Standard Error of the Mean.....      | .01    |
| Coefficient of Variation.....%       | 4.46   |
| Variance.....                        | .0035  |
| Standard Deviation.....              | .0594  |
| Skewness.....                        | -.3465 |
| Kurtosis.....                        | 2.9729 |

### CELL STATISTICS

| Cell Number | Lower Limit | Number of Observations | Frequency (%) |
|-------------|-------------|------------------------|---------------|
| 3           | 1.15        | 1                      | 1.00          |
| 4           | 1.20        | 7                      | 7.00          |
| 5           | 1.25        | 19                     | 19.00         |
| 6           | 1.30        | 27                     | 27.00         |
| 7           | 1.35        | 33                     | 33.00         |
| 8           | 1.40        | 10                     | 10.00         |
| 9           | 1.45        | 3                      | 3.00          |

### VITRINITE TYPE DISTRIBUTION

| Vitrinite Type | Frequency (%) |
|----------------|---------------|
| V11            | 1.00          |
| V12            | 26.00         |
| V13            | 60.00         |
| V14            | 13.00         |

# Vitrinite Reflectance

FORDING COAL LIMITED  
Sample PG-88-093

Compo #412  
RH #2085

## BASIC STATISTICS

|                                      |        |
|--------------------------------------|--------|
| Total Number of Observations.....    | 100    |
| Mean Maximum Reflectance (Romax)...% | 1.15   |
| Standard Error of the Mean.....      | .01    |
| Coefficient of Variation.....%       | 5.83   |
| Variance.....                        | .0045  |
| Standard Deviation.....              | .0669  |
| Skewness.....                        | .2178  |
| Kurtosis.....                        | 3.8825 |

## CELL STATISTICS

| Cell Number | Lower Limit | Number of Observations | Frequency (%) |
|-------------|-------------|------------------------|---------------|
| 4           | 0.95        | 2                      | 2.00          |
| 5           | 1.00        | 4                      | 4.00          |
| 6           | 1.05        | 17                     | 17.00         |
| 7           | 1.10        | 29                     | 29.00         |
| 8           | 1.15        | 22                     | 22.00         |
| 9           | 1.20        | 22                     | 22.00         |
| 10          | 1.25        | 2                      | 2.00          |
| 11          | 1.30        | 1                      | 1.00          |
| 12          | 1.35        | 1                      | 1.00          |

## VITRINITE TYPE DISTRIBUTION

| Vitrinite Type | Frequency (%) |
|----------------|---------------|
| V9             | 2.00          |
| V10            | 21.00         |
| V11            | 51.00         |
| V12            | 24.00         |
| V13            | 2.00          |

# Vitrinite Reflectance

FORDING COAL LIMITED  
Sample PG-88-094

Compo 414  
RH # 2085

## BASIC STATISTICS

|                                      |        |
|--------------------------------------|--------|
| Total Number of Observations.....    | 100    |
| Mean Maximum Reflectance (Romax)...% | 1.28   |
| Standard Error of the Mean.....      | .01    |
| Coefficient of Variation.....%       | 4.85   |
| Variance.....                        | .0038  |
| Standard Deviation.....              | .0619  |
| Skewness.....                        | -.4517 |
| Kurtosis.....                        | 3.3092 |

## CELL STATISTICS

| Cell Number | Lower Limit | Number of Observations | Frequency (%) |
|-------------|-------------|------------------------|---------------|
| 3           | 1.10        | 4                      | 4.00          |
| 4           | 1.15        | 6                      | 6.00          |
| 5           | 1.20        | 18                     | 18.00         |
| 6           | 1.25        | 30                     | 30.00         |
| 7           | 1.30        | 32                     | 32.00         |
| 8           | 1.35        | 8                      | 8.00          |
| 9           | 1.40        | 2                      | 2.00          |

## VITRINITE TYPE DISTRIBUTION

| Vitrinite Type | Frequency (%) |
|----------------|---------------|
| V11            | 10.00         |
| V12            | 48.00         |
| V13            | 40.00         |
| V14            | 2.00          |

# Vitrinite Reflectance

FORDING COAL LIMITED  
Sample PG-88-095

Compa 417  
RH \* 2085

## BASIC STATISTICS

|                                      |        |
|--------------------------------------|--------|
| Total Number of Observations.....    | 100    |
| Mean Maximum Reflectance (Romax)...% | 1.34   |
| Standard Error of the Mean.....      | .01    |
| Coefficient of Variation.....%       | 4.66   |
| Variance.....                        | .0039  |
| Standard Deviation.....              | .0623  |
| Skewness.....                        | -.4847 |
| Kurtosis.....                        | 2.9915 |

## CELL STATISTICS

| Cell Number | Lower Limit | Number of Observations | Frequency (%) |
|-------------|-------------|------------------------|---------------|
| 3           | 1.15        | 2                      | 2.00          |
| 4           | 1.20        | 6                      | 6.00          |
| 5           | 1.25        | 14                     | 14.00         |
| 6           | 1.30        | 30                     | 30.00         |
| 7           | 1.35        | 32                     | 32.00         |
| 8           | 1.40        | 14                     | 14.00         |
| 9           | 1.45        | 2                      | 2.00          |

## VITRINITE TYPE DISTRIBUTION

| Vitrinite Type | Frequency (%) |
|----------------|---------------|
| V11            | 2.00          |
| V12            | 20.00         |
| V13            | 62.00         |
| V14            | 16.00         |

# Vitrinite Reflectance

FORDING COAL LIMITED  
Sample PG-88-096

Comp 418

RH 2085

## BASIC STATISTICS

|                                      |        |
|--------------------------------------|--------|
| Total Number of Observations.....    | 100    |
| Mean Maximum Reflectance (Romax)...% | 1.36   |
| Standard Error of the Mean.....      | .01    |
| Coefficient of Variation.....%       | 3.88   |
| Variance.....                        | .0028  |
| Standard Deviation.....              | .0527  |
| Skewness.....                        | -.5295 |
| Kurtosis.....                        | 4.7475 |

## CELL STATISTICS

| Cell Number | Lower Limit | Number of Observations | Frequency (%) |
|-------------|-------------|------------------------|---------------|
| 4           | 1.15        | 1                      | 1.00          |
| 5           | 1.20        | 1                      | 1.00          |
| 6           | 1.25        | 10                     | 10.00         |
| 7           | 1.30        | 22                     | 22.00         |
| 8           | 1.35        | 44                     | 44.00         |
| 9           | 1.40        | 19                     | 19.00         |
| 10          | 1.45        | 2                      | 2.00          |
| 11          | 1.50        | 1                      | 1.00          |

## VITRINITE TYPE DISTRIBUTION

| Vitrinite Type | Frequency (%) |
|----------------|---------------|
| V11            | 1.00          |
| V12            | 11.00         |
| V13            | 66.00         |
| V14            | 21.00         |
| V15            | 1.00          |



# Vitrinite Reflectance

FORDING COAL LIMITED  
Sample PG-88-147

Compo 513  
RH + 2086

## BASIC STATISTICS

|                                      |        |
|--------------------------------------|--------|
| Total Number of Observations.....    | 100    |
| Mean Maximum Reflectance (Romax)...% | 1.26   |
| Standard Error of the Mean.....      | .01    |
| Coefficient of Variation.....%       | 4.97   |
| Variance.....                        | .0040  |
| Standard Deviation.....              | .0629  |
| Skewness.....                        | .0768  |
| Kurtosis.....                        | 3.6530 |

## CELL STATISTICS

| Cell Number | Lower Limit | Number of Observations | Frequency (%) |
|-------------|-------------|------------------------|---------------|
| 4           | 1.05        | 1                      | 1.00          |
| 5           | 1.10        | 1                      | 1.00          |
| 6           | 1.15        | 13                     | 13.00         |
| 7           | 1.20        | 18                     | 18.00         |
| 8           | 1.25        | 37                     | 37.00         |
| 9           | 1.30        | 20                     | 20.00         |
| 10          | 1.35        | 7                      | 7.00          |
| 11          | 1.40        | 2                      | 2.00          |
| 12          | 1.45        | 1                      | 1.00          |

## VITRINITE TYPE DISTRIBUTION

| Vitrinite Type | Frequency (%) |
|----------------|---------------|
| V10            | 1.00          |
| V11            | 14.00         |
| V12            | 55.00         |
| V13            | 27.00         |
| V14            | 3.00          |

# Vitrinite Reflectance

FORDING COAL LIMITED  
Sample PG-88-148

Compo 514  
RH # 2086

## BASIC STATISTICS

|                                      |        |
|--------------------------------------|--------|
| Total Number of Observations.....    | 100    |
| Mean Maximum Reflectance (Romax)...% | 1.34   |
| Standard Error of the Mean.....      | 0.00   |
| Coefficient of Variation.....%       | 3.65   |
| Variance.....                        | .0024  |
| Standard Deviation.....              | .0490  |
| Skewness.....                        | .1214  |
| Kurtosis.....                        | 2.7044 |

## CELL STATISTICS

| Cell Number | Lower Limit | Number of Observations | Frequency (%) |
|-------------|-------------|------------------------|---------------|
| 3           | 1.20        | 2                      | 2.00          |
| 4           | 1.25        | 15                     | 15.00         |
| 5           | 1.30        | 35                     | 35.00         |
| 6           | 1.35        | 31                     | 31.00         |
| 7           | 1.40        | 15                     | 15.00         |
| 8           | 1.45        | 2                      | 2.00          |

## VITRINITE TYPE DISTRIBUTION

| Vitrinite Type | Frequency (%) |
|----------------|---------------|
| V12            | 17.00         |
| V13            | 66.00         |
| V14            | 17.00         |

# Vitrinite Reflectance

FORDING COAL LIMITED  
Sample PG-88-142

Compo 493

RH #2087

## BASIC STATISTICS

|                                      |        |
|--------------------------------------|--------|
| Total Number of Observations.....    | 100    |
| Mean Maximum Reflectance (Romax)...% | 1.08   |
| Standard Error of the Mean.....      | .01    |
| Coefficient of Variation.....%       | 5.84   |
| Variance.....                        | .0040  |
| Standard Deviation.....              | .0629  |
| Skewness.....                        | .0097  |
| Kurtosis.....                        | 3.0133 |

## CELL STATISTICS

| Cell Number | Lower Limit | Number of Observations | Frequency (%) |
|-------------|-------------|------------------------|---------------|
| 3           | 0.90        | 3                      | 3.00          |
| 4           | 0.95        | 4                      | 4.00          |
| 5           | 1.00        | 26                     | 26.00         |
| 6           | 1.05        | 27                     | 27.00         |
| 7           | 1.10        | 26                     | 26.00         |
| 8           | 1.15        | 11                     | 11.00         |
| 9           | 1.20        | 3                      | 3.00          |

## VITRINITE TYPE DISTRIBUTION

| Vitrinite Type | Frequency (%) |
|----------------|---------------|
| V9             | 7.00          |
| V10            | 53.00         |
| V11            | 37.00         |
| V12            | 3.00          |

# Vitrinite Reflectance

FORDING COAL LIMITED  
Sample PG-88-143

Compo 497  
RH #2087

## BASIC STATISTICS

|                                      |        |
|--------------------------------------|--------|
| Total Number of Observations.....    | 100    |
| Mean Maximum Reflectance (Romax)...% | 1.15   |
| Standard Error of the Mean.....      | .01    |
| Coefficient of Variation.....%       | 5.34   |
| Variance.....                        | .0038  |
| Standard Deviation.....              | .0613  |
| Skewness.....                        | -.2816 |
| Kurtosis.....                        | 3.0068 |

## CELL STATISTICS

| Cell Number | Lower Limit | Number of Observations | Frequency (%) |
|-------------|-------------|------------------------|---------------|
| 4           | 0.95        | 1                      | 1.00          |
| 5           | 1.00        | 7                      | 7.00          |
| 6           | 1.05        | 11                     | 11.00         |
| 7           | 1.10        | 25                     | 25.00         |
| 8           | 1.15        | 33                     | 33.00         |
| 9           | 1.20        | 18                     | 18.00         |
| 10          | 1.25        | 4                      | 4.00          |
| 11          | 1.30        | 1                      | 1.00          |

## VITRINITE TYPE DISTRIBUTION

| Vitrinite Type | Frequency (%) |
|----------------|---------------|
| V9             | 1.00          |
| V10            | 18.00         |
| V11            | 58.00         |
| V12            | 22.00         |
| V13            | 1.00          |

# Vitrinite Reflectance

FORDING COAL LIMITED  
Sample PG-88-144

Comp 500  
RH #2087

## BASIC STATISTICS

|                                      |        |
|--------------------------------------|--------|
| Total Number of Observations.....    | 100    |
| Mean Maximum Reflectance (Romax)...% | 1.23   |
| Standard Error of the Mean.....      | .01    |
| Coefficient of Variation.....%       | 5.08   |
| Variance.....                        | .0039  |
| Standard Deviation.....              | .0622  |
| Skewness.....                        | .2269  |
| Kurtosis.....                        | 3.5275 |

## CELL STATISTICS

| Cell Number | Lower Limit | Number of Observations | Frequency (%) |
|-------------|-------------|------------------------|---------------|
| 4           | 1.05        | 2                      | 2.00          |
| 5           | 1.10        | 10                     | 10.00         |
| 6           | 1.15        | 14                     | 14.00         |
| 7           | 1.20        | 38                     | 38.00         |
| 8           | 1.25        | 25                     | 25.00         |
| 9           | 1.30        | 6                      | 6.00          |
| 10          | 1.35        | 4                      | 4.00          |
| 11          | 1.40        | 1                      | 1.00          |

## VITRINITE TYPE DISTRIBUTION

| Vitrinite Type | Frequency (%) |
|----------------|---------------|
| V10            | 2.00          |
| V11            | 24.00         |
| V12            | 63.00         |
| V13            | 10.00         |
| V14            | 1.00          |

# Vitrinite Reflectance

FORDING COAL LIMITED  
Sample PG-88-145

Compo 502  
RH # 2087

## BASIC STATISTICS

|                                      |        |
|--------------------------------------|--------|
| Total Number of Observations.....    | 100    |
| Mean Maximum Reflectance (Romax)...% | 1.33   |
| Standard Error of the Mean.....      | .01    |
| Coefficient of Variation.....%       | 4.26   |
| Variance.....                        | .0032  |
| Standard Deviation.....              | .0565  |
| Skewness.....                        | -.2808 |
| Kurtosis.....                        | 2.5226 |

## CELL STATISTICS

| Cell Number | Lower Limit | Number of Observations | Frequency (%) |
|-------------|-------------|------------------------|---------------|
| 3           | 1.15        | 2                      | 2.00          |
| 4           | 1.20        | 6                      | 6.00          |
| 5           | 1.25        | 20                     | 20.00         |
| 6           | 1.30        | 32                     | 32.00         |
| 7           | 1.35        | 27                     | 27.00         |
| 8           | 1.40        | 12                     | 12.00         |
| 9           | 1.45        | 1                      | 1.00          |

## VITRINITE TYPE DISTRIBUTION

| Vitrinite Type | Frequency (%) |
|----------------|---------------|
| V11            | 2.00          |
| V12            | 26.00         |
| V13            | 59.00         |
| V14            | 13.00         |

# Vitrinite Reflectance

FORDING COAL LIMITED  
Sample PG-88-146

Compo 503

RH # 2087

## BASIC STATISTICS

|                                      |        |
|--------------------------------------|--------|
| Total Number of Observations.....    | 100    |
| Mean Maximum Reflectance (Romax)...% | 1.32   |
| Standard Error of the Mean.....      | .01    |
| Coefficient of Variation.....%       | 4.11   |
| Variance.....                        | .0030  |
| Standard Deviation.....              | .0544  |
| Skewness.....                        | -.5109 |
| Kurtosis.....                        | 3.9640 |

## CELL STATISTICS

| Cell Number | Lower Limit | Number of Observations | Frequency (%) |
|-------------|-------------|------------------------|---------------|
| 3           | 1.15        | 2                      | 2.00          |
| 4           | 1.20        | 6                      | 6.00          |
| 5           | 1.25        | 16                     | 16.00         |
| 6           | 1.30        | 39                     | 39.00         |
| 7           | 1.35        | 31                     | 31.00         |
| 8           | 1.40        | 4                      | 4.00          |
| 9           | 1.45        | 2                      | 2.00          |

## VITRINITE TYPE DISTRIBUTION

| Vitrinite Type | Frequency (%) |
|----------------|---------------|
| V11            | 2.00          |
| V12            | 22.00         |
| V13            | 70.00         |
| V14            | 6.00          |

# Vitrinite Reflectance

FORDING COAL LIMITED  
Sample PG-88-140

Compo 485

RH #2088

## BASIC STATISTICS

|                                      |        |
|--------------------------------------|--------|
| Total Number of Observations.....    | 100    |
| Mean Maximum Reflectance (Romax)...% | 1.11   |
| Standard Error of the Mean.....      | 0.00   |
| Coefficient of Variation.....%       | 4.40   |
| Variance.....                        | .0024  |
| Standard Deviation.....              | .0490  |
| Skewness.....                        | .2188  |
| Kurtosis.....                        | 2.7847 |

## CELL STATISTICS

| Cell Number | Lower Limit | Number of Observations | Frequency (%) |
|-------------|-------------|------------------------|---------------|
| 3           | 0.95        | 1                      | 1.00          |
| 4           | 1.00        | 6                      | 6.00          |
| 5           | 1.05        | 32                     | 32.00         |
| 6           | 1.10        | 32                     | 32.00         |
| 7           | 1.15        | 22                     | 22.00         |
| 8           | 1.20        | 6                      | 6.00          |
| 9           | 1.25        | 1                      | 1.00          |

## VITRINITE TYPE DISTRIBUTION

| Vitrinite Type | Frequency (%) |
|----------------|---------------|
| V9             | 1.00          |
| V10            | 38.00         |
| V11            | 54.00         |
| V12            | 7.00          |



# Vitrinite Reflectance

FORDING COAL LIMITED  
Sample PG-88-141

Compo 488

RH #2088

## BASIC STATISTICS

|                                      |        |
|--------------------------------------|--------|
| Total Number of Observations.....    | 100    |
| Mean Maximum Reflectance (Romax)...% | 1.17   |
| Standard Error of the Mean.....      | .01    |
| Coefficient of Variation.....%       | 5.13   |
| Variance.....                        | .0036  |
| Standard Deviation.....              | .0600  |
| Skewness.....                        | -.2108 |
| Kurtosis.....                        | 2.8322 |

## CELL STATISTICS

| Cell Number | Lower Limit | Number of Observations | Frequency (%) |
|-------------|-------------|------------------------|---------------|
| 3           | 1.00        | 2                      | 2.00          |
| 4           | 1.05        | 10                     | 10.00         |
| 5           | 1.10        | 20                     | 20.00         |
| 6           | 1.15        | 28                     | 28.00         |
| 7           | 1.20        | 32                     | 32.00         |
| 8           | 1.25        | 7                      | 7.00          |
| 9           | 1.30        | 1                      | 1.00          |

## VITRINITE TYPE DISTRIBUTION

| Vitrinite Type | Frequency (%) |
|----------------|---------------|
| V10            | 12.00         |
| V11            | 48.00         |
| V12            | 39.00         |
| V13            | 1.00          |

# Vitrinite Reflectance

FORDING COAL LIMITED

Sample PG-89-010

RH 2089

83018-022

Compo 030

## BASIC STATISTICS

|                                      |        |
|--------------------------------------|--------|
| Total Number of Observations.....    | 100    |
| Mean Maximum Reflectance (Romax)...% | 1.26   |
| Standard Error of the Mean.....      | 0.00   |
| Coefficient of Variation.....%       | 3.95   |
| Variance.....                        | .0025  |
| Standard Deviation.....              | .0500  |
| Skewness.....                        | -.1796 |
| Kurtosis.....                        | 2.9994 |

## CELL STATISTICS

| Cell Number | Lower Limit | Number of Observations | Frequency (%) |
|-------------|-------------|------------------------|---------------|
| 3           | 1.10        | 1                      | 1.00          |
| 4           | 1.15        | 6                      | 6.00          |
| 5           | 1.20        | 26                     | 26.00         |
| 6           | 1.25        | 40                     | 40.00         |
| 7           | 1.30        | 20                     | 20.00         |
| 8           | 1.35        | 7                      | 7.00          |

## VITRINITE TYPE DISTRIBUTION

| Vitrinite Type | Frequency (%) |
|----------------|---------------|
| V11            | 7.00          |
| V12            | 66.00         |
| V13            | 27.00         |

# Vitrinite Reflectance

FORDING COAL LIMITED

Sample PG-89-011

RH 2089

83451, 452

83024, 025,

Compo 031

## BASIC STATISTICS

|                                      |        |
|--------------------------------------|--------|
| Total Number of Observations.....    | 100    |
| Mean Maximum Reflectance (Romax)...% | 1.22   |
| Standard Error of the Mean.....      | .01    |
| Coefficient of Variation.....%       | 4.94   |
| Variance.....                        | .0036  |
| Standard Deviation.....              | .0604  |
| Skewness.....                        | -.2100 |
| Kurtosis.....                        | 3.0616 |

## CELL STATISTICS

| Cell Number | Lower Limit | Number of Observations | Frequency (%) |
|-------------|-------------|------------------------|---------------|
| 3           | 1.05        | 2                      | 2.00          |
| 4           | 1.10        | 6                      | 6.00          |
| 5           | 1.15        | 21                     | 21.00         |
| 6           | 1.20        | 36                     | 36.00         |
| 7           | 1.25        | 22                     | 22.00         |
| 8           | 1.30        | 11                     | 11.00         |
| 9           | 1.35        | 2                      | 2.00          |

## VITRINITE TYPE DISTRIBUTION

| Vitrinite Type | Frequency (%) |
|----------------|---------------|
| V10            | 2.00          |
| V11            | 27.00         |
| V12            | 58.00         |
| V13            | 13.00         |

# Vitrinite Reflectance

FORDING COAL LIMITED

Sample PG-89-030

RH 2089

83466-71

Compo 036

## BASIC STATISTICS

|                                      |        |
|--------------------------------------|--------|
| Total Number of Observations.....    | 100    |
| Mean Maximum Reflectance (Romax)...% | 1.32   |
| Standard Error of the Mean.....      | 0.00   |
| Coefficient of Variation.....%       | 3.47   |
| Variance.....                        | .0021  |
| Standard Deviation.....              | .0458  |
| Skewness.....                        | -.4492 |
| Kurtosis.....                        | 3.3355 |

## CELL STATISTICS

| Cell Number | Lower Limit | Number of Observations | Frequency (%) |
|-------------|-------------|------------------------|---------------|
| 3           | 1.15        | 1                      | 1.00          |
| 4           | 1.20        | 4                      | 4.00          |
| 5           | 1.25        | 22                     | 22.00         |
| 6           | 1.30        | 43                     | 43.00         |
| 7           | 1.35        | 27                     | 27.00         |
| 8           | 1.40        | 3                      | 3.00          |

## VITRINITE TYPE DISTRIBUTION

| Vitrinite Type | Frequency (%) |
|----------------|---------------|
| V11            | 1.00          |
| V12            | 26.00         |
| V13            | 70.00         |
| V14            | 3.00          |

# Vitrinite Reflectance

FORDING COAL LIMITED

Compa 065

Sample PG-89-022

RH 2090 E3027-040

## BASIC STATISTICS

|                                      |        |
|--------------------------------------|--------|
| Total Number of Observations.....    | 100    |
| Mean Maximum Reflectance (Romax)...% | 1.21   |
| Standard Error of the Mean.....      | 0.00   |
| Coefficient of Variation.....%       | 3.93   |
| Variance.....                        | .0023  |
| Standard Deviation.....              | .0476  |
| Skewness.....                        | -.0671 |
| Kurtosis.....                        | 3.3444 |

## CELL STATISTICS

| Cell Number | Lower Limit | Number of Observations | Frequency (%) |
|-------------|-------------|------------------------|---------------|
| 3           | 1.05        | 1                      | 1.00          |
| 4           | 1.10        | 3                      | 3.00          |
| 5           | 1.15        | 35                     | 35.00         |
| 6           | 1.20        | 36                     | 36.00         |
| 7           | 1.25        | 21                     | 21.00         |
| 8           | 1.30        | 4                      | 4.00          |

## VITRINITE TYPE DISTRIBUTION

| Vitrinite Type | Frequency (%) |
|----------------|---------------|
| V10            | 1.00          |
| V11            | 38.00         |
| V12            | 57.00         |
| V13            | 4.00          |

# Vitrinite Reflectance

FORDING COAL LIMITED

Compo 066

Sample PG-89-023 RH2090 E3043-045

## BASIC STATISTICS

|                                      |        |
|--------------------------------------|--------|
| Total Number of Observations.....    | 100    |
| Mean Maximum Reflectance (Romax)...% | 1.24   |
| Standard Error of the Mean.....      | .01    |
| Coefficient of Variation.....%       | 4.30   |
| Variance.....                        | .0029  |
| Standard Deviation.....              | .0535  |
| Skewness.....                        | -.0880 |
| Kurtosis.....                        | 2.8561 |

## CELL STATISTICS

| Cell Number | Lower Limit | Number of Observations | Frequency (%) |
|-------------|-------------|------------------------|---------------|
| 3           | 1.10        | 6                      | 6.00          |
| 4           | 1.15        | 13                     | 13.00         |
| 5           | 1.20        | 32                     | 32.00         |
| 6           | 1.25        | 31                     | 31.00         |
| 7           | 1.30        | 14                     | 14.00         |
| 8           | 1.35        | 4                      | 4.00          |

## VITRINITE TYPE DISTRIBUTION

| Vitrinite Type | Frequency (%) |
|----------------|---------------|
| V11            | 19.00         |
| V12            | 63.00         |
| V13            | 18.00         |

# Vitrinite Reflectance

FORDING COAL LIMITED

Compo 067

Sample PG-89-024 RH2090 83049,050, 83476,477

## BASIC STATISTICS

|                                      |        |
|--------------------------------------|--------|
| Total Number of Observations.....    | 100    |
| Mean Maximum Reflectance (Romax)...% | 1.24   |
| Standard Error of the Mean.....      | .01    |
| Coefficient of Variation.....%       | 4.27   |
| Variance.....                        | .0028  |
| Standard Deviation.....              | .0530  |
| Skewness.....                        | -.2150 |
| Kurtosis.....                        | 2.9107 |

## CELL STATISTICS

| Cell Number | Lower Limit | Number of Observations | Frequency (%) |
|-------------|-------------|------------------------|---------------|
| 3           | 1.10        | 5                      | 5.00          |
| 4           | 1.15        | 12                     | 12.00         |
| 5           | 1.20        | 41                     | 41.00         |
| 6           | 1.25        | 26                     | 26.00         |
| 7           | 1.30        | 15                     | 15.00         |
| 8           | 1.35        | 1                      | 1.00          |

## VITRINITE TYPE DISTRIBUTION

| Vitrinite Type | Frequency (%) |
|----------------|---------------|
| V11            | 17.00         |
| V12            | 67.00         |
| V13            | 16.00         |

# Vitrinite Reflectance

FORDING COAL LIMITED

Sample PG-89-025 R#2090 83485-489

Compo 068

## BASIC STATISTICS

|                                      |        |
|--------------------------------------|--------|
| Total Number of Observations.....    | 100    |
| Mean Maximum Reflectance (Romax)...% | 1.26   |
| Standard Error of the Mean.....      | .01    |
| Coefficient of Variation.....%       | 5.00   |
| Variance.....                        | .0040  |
| Standard Deviation.....              | .0631  |
| Skewness.....                        | -.5204 |
| Kurtosis.....                        | 4.0794 |

## CELL STATISTICS

| Cell Number | Lower Limit | Number of Observations | Frequency (%) |
|-------------|-------------|------------------------|---------------|
| 4           | 1.00        | 1                      | 1.00          |
| 6           | 1.10        | 2                      | 2.00          |
| 7           | 1.15        | 10                     | 10.00         |
| 8           | 1.20        | 25                     | 25.00         |
| 9           | 1.25        | 31                     | 31.00         |
| 10          | 1.30        | 24                     | 24.00         |
| 11          | 1.35        | 6                      | 6.00          |
| 12          | 1.40        | 1                      | 1.00          |

## VITRINITE TYPE DISTRIBUTION

| Vitrinite Type | Frequency (%) |
|----------------|---------------|
| V10            | 1.00          |
| V11            | 12.00         |
| V12            | 56.00         |
| V13            | 30.00         |
| V14            | 1.00          |



# Vitrinite Reflectance

FORDING COAL LIMITED  
 Sample PG-89-026

Comp 070

RH2090 83496-500

## BASIC STATISTICS

|                                      |        |
|--------------------------------------|--------|
| Total Number of Observations.....    | 100    |
| Mean Maximum Reflectance (Romax)...% | 1.27   |
| Standard Error of the Mean.....      | 0.00   |
| Coefficient of Variation.....%       | 3.85   |
| Variance.....                        | .0024  |
| Standard Deviation.....              | .0491  |
| Skewness.....                        | -.0091 |
| Kurtosis.....                        | 2.9630 |

## CELL STATISTICS

| Cell Number | Lower Limit | Number of Observations | Frequency (%) |
|-------------|-------------|------------------------|---------------|
| 3           | 1.15        | 5                      | 5.00          |
| 4           | 1.20        | 27                     | 27.00         |
| 5           | 1.25        | 33                     | 33.00         |
| 6           | 1.30        | 29                     | 29.00         |
| 7           | 1.35        | 4                      | 4.00          |
| 8           | 1.40        | 2                      | 2.00          |

## VITRINITE TYPE DISTRIBUTION

| Vitrinite Type | Frequency (%) |
|----------------|---------------|
| V11            | 5.00          |
| V12            | 60.00         |
| V13            | 33.00         |
| V14            | 2.00          |

# Vitrinite Reflectance

FORDING COAL LIMITED

Sample PG-89-028

RH2091 8326-132

Compo 076

## BASIC STATISTICS

|                                      |        |
|--------------------------------------|--------|
| Total Number of Observations.....    | 100    |
| Mean Maximum Reflectance (Romax)...% | 1.07   |
| Standard Error of the Mean.....      | 0.00   |
| Coefficient of Variation.....%       | 4.61   |
| Variance.....                        | .0024  |
| Standard Deviation.....              | .0494  |
| Skewness.....                        | .1551  |
| Kurtosis.....                        | 2.7435 |

## CELL STATISTICS

| Cell Number | Lower Limit | Number of Observations | Frequency (%) |
|-------------|-------------|------------------------|---------------|
| 3           | 0.95        | 8                      | 8.00          |
| 4           | 1.00        | 20                     | 20.00         |
| 5           | 1.05        | 41                     | 41.00         |
| 6           | 1.10        | 21                     | 21.00         |
| 7           | 1.15        | 9                      | 9.00          |
| 8           | 1.20        | 1                      | 1.00          |

## VITRINITE TYPE DISTRIBUTION

| Vitrinite Type | Frequency (%) |
|----------------|---------------|
| V9             | 8.00          |
| V10            | 61.00         |
| V11            | 30.00         |
| V12            | 1.00          |

# Vitrinite Reflectance

**FORDING COAL LIMITED**

Sample PG-89-029

R#2091

83145-150

62977-982

Compo 078

## BASIC STATISTICS

|                                      |        |
|--------------------------------------|--------|
| Total Number of Observations.....    | 100    |
| Mean Maximum Reflectance (Romax)...% | 1.16   |
| Standard Error of the Mean.....      | .01    |
| Coefficient of Variation.....%       | 4.89   |
| Variance.....                        | .0032  |
| Standard Deviation.....              | .0567  |
| Skewness.....                        | -.0974 |
| Kurtosis.....                        | 3.1690 |

## CELL STATISTICS

| Cell Number | Lower Limit | Number of Observations | Frequency (%) |
|-------------|-------------|------------------------|---------------|
| 3           | 1.00        | 3                      | 3.00          |
| 4           | 1.05        | 8                      | 8.00          |
| 5           | 1.10        | 27                     | 27.00         |
| 6           | 1.15        | 33                     | 33.00         |
| 7           | 1.20        | 23                     | 23.00         |
| 8           | 1.25        | 4                      | 4.00          |
| 9           | 1.30        | 2                      | 2.00          |

## VITRINITE TYPE DISTRIBUTION

| Vitrinite Type | Frequency (%) |
|----------------|---------------|
| V10            | 11.00         |
| V11            | 60.00         |
| V12            | 27.00         |
| V13            | 2.00          |

# Vitrinite Reflectance

FORDING COAL LIMITED

Compo 056

Sample PG-89-017

R#12092 82986-988

## BASIC STATISTICS

|                                      |        |
|--------------------------------------|--------|
| Total Number of Observations.....    | 100    |
| Mean Maximum Reflectance (Romax)...% | 1.07   |
| Standard Error of the Mean.....      | .01    |
| Coefficient of Variation.....%       | 4.85   |
| Variance.....                        | .0027  |
| Standard Deviation.....              | .0520  |
| Skewness.....                        | -.3970 |
| Kurtosis.....                        | 4.1860 |

## CELL STATISTICS

| Cell Number | Lower Limit | Number of Observations | Frequency (%) |
|-------------|-------------|------------------------|---------------|
| 3           | 0.90        | 2                      | 2.00          |
| 4           | 0.95        | 4                      | 4.00          |
| 5           | 1.00        | 21                     | 21.00         |
| 6           | 1.05        | 42                     | 42.00         |
| 7           | 1.10        | 23                     | 23.00         |
| 8           | 1.15        | 7                      | 7.00          |
| 9           | 1.20        | 1                      | 1.00          |

## VITRINITE TYPE DISTRIBUTION

| Vitrinite Type | Frequency (%) |
|----------------|---------------|
| V9             | 6.00          |
| V10            | 63.00         |
| V11            | 30.00         |
| V12            | 1.00          |

# Vitrinite Reflectance

FORDING COAL LIMITED

Sample PG-89-018

RH 2092

82991 - 929  
83000 - 006

Comp 057

## BASIC STATISTICS

|                                      |        |
|--------------------------------------|--------|
| Total Number of Observations.....    | 100    |
| Mean Maximum Reflectance (Romax)...% | 1.15   |
| Standard Error of the Mean.....      | .01    |
| Coefficient of Variation.....%       | 5.58   |
| Variance.....                        | .0041  |
| Standard Deviation.....              | .0640  |
| Skewness.....                        | -.1151 |
| Kurtosis.....                        | 3.2673 |

## CELL STATISTICS

| Cell Number | Lower Limit | Number of Observations | Frequency (%) |
|-------------|-------------|------------------------|---------------|
| 4           | 0.95        | 1                      | 1.00          |
| 5           | 1.00        | 5                      | 5.00          |
| 6           | 1.05        | 12                     | 12.00         |
| 7           | 1.10        | 36                     | 36.00         |
| 8           | 1.15        | 22                     | 22.00         |
| 9           | 1.20        | 20                     | 20.00         |
| 10          | 1.25        | 3                      | 3.00          |
| 11          | 1.30        | 1                      | 1.00          |

## VITRINITE TYPE DISTRIBUTION

| Vitrinite Type | Frequency (%) |
|----------------|---------------|
| V9             | 1.00          |
| V10            | 17.00         |
| V11            | 58.00         |
| V12            | 23.00         |
| V13            | 1.00          |

# Vitrinite Reflectance

FORDING COAL LIMITED  
 Sample PG-89-006

Compo 014

RH3093 81627-632

## BASIC STATISTICS

|                                      |        |
|--------------------------------------|--------|
| Total Number of Observations.....    | 100    |
| Mean Maximum Reflectance (Romax)...% | 1.10   |
| Standard Error of the Mean.....      | 0.00   |
| Coefficient of Variation.....%       | 4.11   |
| Variance.....                        | .0020  |
| Standard Deviation.....              | .0450  |
| Skewness.....                        | .0935  |
| Kurtosis.....                        | 2.5766 |

## CELL STATISTICS

| Cell Number | Lower Limit | Number of Observations | Frequency (%) |
|-------------|-------------|------------------------|---------------|
| 3           | 0.95        | 1                      | 1.00          |
| 4           | 1.00        | 14                     | 14.00         |
| 5           | 1.05        | 38                     | 38.00         |
| 6           | 1.10        | 30                     | 30.00         |
| 7           | 1.15        | 16                     | 16.00         |
| 8           | 1.20        | 1                      | 1.00          |

## VITRINITE TYPE DISTRIBUTION

| Vitrinite Type | Frequency (%) |
|----------------|---------------|
| V9             | 1.00          |
| V10            | 52.00         |
| V11            | 46.00         |
| V12            | 1.00          |

# Vitrinite Reflectance

FORDING COAL LIMITED  
 Sample PG-89-007

Compo 016

RH2093 81646-670

## BASIC STATISTICS

|                                      |        |
|--------------------------------------|--------|
| Total Number of Observations.....    | 100    |
| Mean Maximum Reflectance (Romax)...% | 1.16   |
| Standard Error of the Mean.....      | 0.00   |
| Coefficient of Variation.....%       | 3.95   |
| Variance.....                        | .0021  |
| Standard Deviation.....              | .0458  |
| Skewness.....                        | -.1035 |
| Kurtosis.....                        | 2.7696 |

## CELL STATISTICS

| Cell Number | Lower Limit | Number of Observations | Frequency (%) |
|-------------|-------------|------------------------|---------------|
| 3           | 1.05        | 10                     | 10.00         |
| 4           | 1.10        | 29                     | 29.00         |
| 5           | 1.15        | 40                     | 40.00         |
| 6           | 1.20        | 18                     | 18.00         |
| 7           | 1.25        | 3                      | 3.00          |

## VITRINITE TYPE DISTRIBUTION

| Vitrinite Type | Frequency (%) |
|----------------|---------------|
| V10            | 10.00         |
| V11            | 69.00         |
| V12            | 21.00         |

# Vitrinite Reflectance

FORDING COAL LIMITED  
 Sample PG-89-001

Compo 001  
 RA 2151 81776-787

## BASIC STATISTICS

|                                      |        |
|--------------------------------------|--------|
| Total Number of Observations.....    | 100    |
| Mean Maximum Reflectance (Romax)...% | 1.09   |
| Standard Error of the Mean.....      | 0.00   |
| Coefficient of Variation.....%       | 4.59   |
| Variance.....                        | .0025  |
| Standard Deviation.....              | .0499  |
| Skewness.....                        | -.3283 |
| Kurtosis.....                        | 2.8926 |

## CELL STATISTICS

| Cell Number | Lower Limit | Number of Observations | Frequency (%) |
|-------------|-------------|------------------------|---------------|
| 3           | 0.95        | 6                      | 6.00          |
| 4           | 1.00        | 14                     | 14.00         |
| 5           | 1.05        | 37                     | 37.00         |
| 6           | 1.10        | 35                     | 35.00         |
| 7           | 1.15        | 7                      | 7.00          |
| 8           | 1.20        | 1                      | 1.00          |

## VITRINITE TYPE DISTRIBUTION

| Vitrinite Type | Frequency (%) |
|----------------|---------------|
| V9             | 6.00          |
| V10            | 51.00         |
| V11            | 42.00         |
| V12            | 1.00          |



# Vitrinite Reflectance

FORDING COAL LIMITED Compo 061  
 Sample PG-89-019 RH2152 83285-295

### BASIC STATISTICS

|                                      |        |
|--------------------------------------|--------|
| Total Number of Observations.....    | 100    |
| Mean Maximum Reflectance (Romax)...% | 1.12   |
| Standard Error of the Mean.....      | 0.00   |
| Coefficient of Variation.....%       | 3.52   |
| Variance.....                        | .0016  |
| Standard Deviation.....              | .0394  |
| Skewness.....                        | -.2652 |
| Kurtosis.....                        | 2.5600 |

### CELL STATISTICS

| Cell Number | Lower Limit | Number of Observations | Frequency (%) |
|-------------|-------------|------------------------|---------------|
| 3           | 1.00        | 3                      | 3.00          |
| 4           | 1.05        | 21                     | 21.00         |
| 5           | 1.10        | 47                     | 47.00         |
| 6           | 1.15        | 28                     | 28.00         |
| 7           | 1.20        | 1                      | 1.00          |

### VITRINITE TYPE DISTRIBUTION

| Vitrinite Type | Frequency (%) |
|----------------|---------------|
| V10            | 24.00         |
| V11            | 75.00         |
| V12            | 1.00          |

# Vitrinite Reflectance

FORDING COAL LIMITED  
 Sample PG-89-020

83298-300 Comp 062  
 RH2152 81851-860

## BASIC STATISTICS

|                                      |        |
|--------------------------------------|--------|
| Total Number of Observations.....    | 100    |
| Mean Maximum Reflectance (Romax)...% | 1.21   |
| Standard Error of the Mean.....      | 0.00   |
| Coefficient of Variation.....%       | 3.82   |
| Variance.....                        | .0021  |
| Standard Deviation.....              | .0462  |
| Skewness.....                        | -.4446 |
| Kurtosis.....                        | 3.3262 |

## CELL STATISTICS

| Cell Number | Lower Limit | Number of Observations | Frequency (%) |
|-------------|-------------|------------------------|---------------|
| 3           | 1.05        | 2                      | 2.00          |
| 4           | 1.10        | 7                      | 7.00          |
| 5           | 1.15        | 30                     | 30.00         |
| 6           | 1.20        | 40                     | 40.00         |
| 7           | 1.25        | 19                     | 19.00         |
| 8           | 1.30        | 2                      | 2.00          |

## VITRINITE TYPE DISTRIBUTION

| Vitrinite Type | Frequency (%) |
|----------------|---------------|
| V10            | 2.00          |
| V11            | 37.00         |
| V12            | 59.00         |
| V13            | 2.00          |

# Vitrinite Reflectance

FORDING COAL LIMITED  
 Sample PG-89-021

Comp 064

RH2152 81870-873

## BASIC STATISTICS

|                                      |        |
|--------------------------------------|--------|
| Total Number of Observations.....    | 100    |
| Mean Maximum Reflectance (Romax)...% | 1.27   |
| Standard Error of the Mean.....      | .01    |
| Coefficient of Variation.....%       | 4.41   |
| Variance.....                        | .0031  |
| Standard Deviation.....              | .0559  |
| Skewness.....                        | -.4981 |
| Kurtosis.....                        | 3.6580 |

## CELL STATISTICS

| Cell Number | Lower Limit | Number of Observations | Frequency (%) |
|-------------|-------------|------------------------|---------------|
| 3           | 1.10        | 3                      | 3.00          |
| 4           | 1.15        | 5                      | 5.00          |
| 5           | 1.20        | 22                     | 22.00         |
| 6           | 1.25        | 41                     | 41.00         |
| 7           | 1.30        | 25                     | 25.00         |
| 8           | 1.35        | 4                      | 4.00          |

## VITRINITE TYPE DISTRIBUTION

| Vitrinite Type | Frequency (%) |
|----------------|---------------|
| V11            | 8.00          |
| V12            | 63.00         |
| V13            | 29.00         |

# Vitrinite Reflectance

FORDING COAL LIMITED  
Sample PG-89-013

Compo 048

RH2153 81832-836

## BASIC STATISTICS

|                                      |        |
|--------------------------------------|--------|
| Total Number of Observations.....    | 100    |
| Mean Maximum Reflectance (Romax)...% | 1.06   |
| Standard Error of the Mean.....      | 0.00   |
| Coefficient of Variation.....%       | 4.60   |
| Variance.....                        | .0024  |
| Standard Deviation.....              | .0486  |
| Skewness.....                        | .0098  |
| Kurtosis.....                        | 2.5706 |

## CELL STATISTICS

| Cell Number | Lower Limit | Number of Observations | Frequency (%) |
|-------------|-------------|------------------------|---------------|
| 3           | 0.90        | 1                      | 1.00          |
| 4           | 0.95        | 7                      | 7.00          |
| 5           | 1.00        | 36                     | 36.00         |
| 6           | 1.05        | 33                     | 33.00         |
| 7           | 1.10        | 20                     | 20.00         |
| 8           | 1.15        | 3                      | 3.00          |

## VITRINITE TYPE DISTRIBUTION

| Vitrinite Type | Frequency (%) |
|----------------|---------------|
| V9             | 8.00          |
| V10            | 69.00         |
| V11            | 23.00         |

# Vitrinite Reflectance

FORDING COAL LIMITED  
 Sample PG-89-014

Compo 049

RH2153 81840-847

## BASIC STATISTICS

|                                      |        |
|--------------------------------------|--------|
| Total Number of Observations.....    | 100    |
| Mean Maximum Reflectance (Romax)...% | 1.06   |
| Standard Error of the Mean.....      | .01    |
| Coefficient of Variation.....%       | 5.25   |
| Variance.....                        | .0031  |
| Standard Deviation.....              | .0558  |
| Skewness.....                        | .4560  |
| Kurtosis.....                        | 4.0455 |

## CELL STATISTICS

| Cell Number | Lower Limit | Number of Observations | Frequency (%) |
|-------------|-------------|------------------------|---------------|
| 3           | 0.90        | 2                      | 2.00          |
| 4           | 0.95        | 6                      | 6.00          |
| 5           | 1.00        | 28                     | 28.00         |
| 6           | 1.05        | 41                     | 41.00         |
| 7           | 1.10        | 15                     | 15.00         |
| 8           | 1.15        | 6                      | 6.00          |
| 9           | 1.20        | 2                      | 2.00          |

## VITRINITE TYPE DISTRIBUTION

| Vitrinite Type | Frequency (%) |
|----------------|---------------|
| V9             | 8.00          |
| V10            | 69.00         |
| V11            | 21.00         |
| V12            | 2.00          |

# Vitrinite Reflectance

FORDING COAL LIMITED  
Sample PG-89-015

Compo 053  
RH2153 E3316-323

## BASIC STATISTICS

|                                      |        |
|--------------------------------------|--------|
| Total Number of Observations.....    | 100    |
| Mean Maximum Reflectance (Romax)...% | 1.21   |
| Standard Error of the Mean.....      | .01    |
| Coefficient of Variation.....%       | 4.70   |
| Variance.....                        | .0032  |
| Standard Deviation.....              | .0567  |
| Skewness.....                        | .0101  |
| Kurtosis.....                        | 2.5729 |

## CELL STATISTICS

| Cell Number | Lower Limit | Number of Observations | Frequency (%) |
|-------------|-------------|------------------------|---------------|
| 3           | 1.05        | 2                      | 2.00          |
| 4           | 1.10        | 13                     | 13.00         |
| 5           | 1.15        | 29                     | 29.00         |
| 6           | 1.20        | 27                     | 27.00         |
| 7           | 1.25        | 25                     | 25.00         |
| 8           | 1.30        | 3                      | 3.00          |
| 9           | 1.35        | 1                      | 1.00          |

## VITRINITE TYPE DISTRIBUTION

| Vitrinite Type | Frequency (%) |
|----------------|---------------|
| V10            | 2.00          |
| V11            | 42.00         |
| V12            | 52.00         |
| V13            | 4.00          |

# Vitrinite Reflectance

FORDING COAL LIMITED

Compo 054

Sample PG-89-016 RH2153 81801-808, 83325

## BASIC STATISTICS

|                                      |        |
|--------------------------------------|--------|
| Total Number of Observations.....    | 100    |
| Mean Maximum Reflectance (Romax)...% | 1.19   |
| Standard Error of the Mean.....      | 0.00   |
| Coefficient of Variation.....%       | 3.82   |
| Variance.....                        | .0021  |
| Standard Deviation.....              | .0453  |
| Skewness.....                        | -.2603 |
| Kurtosis.....                        | 2.6456 |

## CELL STATISTICS

| Cell Number | Lower Limit | Number of Observations | Frequency (%) |
|-------------|-------------|------------------------|---------------|
| 3           | 1.05        | 2                      | 2.00          |
| 4           | 1.10        | 18                     | 18.00         |
| 5           | 1.15        | 35                     | 35.00         |
| 6           | 1.20        | 37                     | 37.00         |
| 7           | 1.25        | 8                      | 8.00          |

## VITRINITE TYPE DISTRIBUTION

| Vitrinite Type | Frequency (%) |
|----------------|---------------|
| V10            | 2.00          |
| V11            | 53.00         |
| V12            | 45.00         |

# Vitrinite Reflectance

FORDING COAL LIMITED  
 Sample PG-89-037

Compd 086

RH2155 E:1690-692

## BASIC STATISTICS

|                                      |        |
|--------------------------------------|--------|
| Total Number of Observations.....    | 100    |
| Mean Maximum Reflectance (Romax)...% | 1.07   |
| Standard Error of the Mean.....      | 0.00   |
| Coefficient of Variation.....%       | 4.25   |
| Variance.....                        | .0020  |
| Standard Deviation.....              | .0452  |
| Skewness.....                        | .1210  |
| Kurtosis.....                        | 2.9023 |

## CELL STATISTICS

| Cell Number | Lower Limit | Number of Observations | Frequency (%) |
|-------------|-------------|------------------------|---------------|
| 3           | 0.95        | 7                      | 7.00          |
| 4           | 1.00        | 27                     | 27.00         |
| 5           | 1.05        | 42                     | 42.00         |
| 6           | 1.10        | 19                     | 19.00         |
| 7           | 1.15        | 5                      | 5.00          |

## VITRINITE TYPE DISTRIBUTION

| Vitrinite Type | Frequency (%) |
|----------------|---------------|
| V9             | 7.00          |
| V10            | 69.00         |
| V11            | 24.00         |



# Vitrinite Reflectance

FORDING COAL LIMITED  
 Sample PG-89-035

Comp 079

RH 2156 81727-733, 735-739

## BASIC STATISTICS

|                                      |        |
|--------------------------------------|--------|
| Total Number of Observations.....    | 100    |
| Mean Maximum Reflectance (Romax)...% | 1.16   |
| Standard Error of the Mean.....      | .01    |
| Coefficient of Variation.....%       | 4.61   |
| Variance.....                        | .0029  |
| Standard Deviation.....              | .0536  |
| Skewness.....                        | .0014  |
| Kurtosis.....                        | 2.6910 |

## CELL STATISTICS

| Cell Number | Lower Limit | Number of Observations | Frequency (%) |
|-------------|-------------|------------------------|---------------|
| 3           | 1.00        | 1                      | 1.00          |
| 4           | 1.05        | 13                     | 13.00         |
| 5           | 1.10        | 23                     | 23.00         |
| 6           | 1.15        | 34                     | 34.00         |
| 7           | 1.20        | 24                     | 24.00         |
| 8           | 1.25        | 4                      | 4.00          |
| 9           | 1.30        | 1                      | 1.00          |

## VITRINITE TYPE DISTRIBUTION

| Vitrinite Type | Frequency (%) |
|----------------|---------------|
| V10            | 14.00         |
| V11            | 57.00         |
| V12            | 28.00         |
| V13            | 1.00          |

# Vitrinite Reflectance

FORDING COAL LIMITED  
 Sample PG-89-036

Compo 081

RH 2156 81743-746

## BASIC STATISTICS

|                                      |        |
|--------------------------------------|--------|
| Total Number of Observations.....    | 100    |
| Mean Maximum Reflectance (Romax)...% | 1.18   |
| Standard Error of the Mean.....      | 0.00   |
| Coefficient of Variation.....%       | 4.13   |
| Variance.....                        | .0024  |
| Standard Deviation.....              | .0489  |
| Skewness.....                        | .0233  |
| Kurtosis.....                        | 3.1015 |

## CELL STATISTICS

| Cell Number | Lower Limit | Number of Observations | Frequency (%) |
|-------------|-------------|------------------------|---------------|
| 3           | 1.00        | 1                      | 1.00          |
| 4           | 1.05        | 1                      | 1.00          |
| 5           | 1.10        | 18                     | 18.00         |
| 6           | 1.15        | 42                     | 42.00         |
| 7           | 1.20        | 26                     | 26.00         |
| 8           | 1.25        | 11                     | 11.00         |
| 9           | 1.30        | 1                      | 1.00          |

## VITRINITE TYPE DISTRIBUTION

| Vitrinite Type | Frequency (%) |
|----------------|---------------|
| V10            | 2.00          |
| V11            | 60.00         |
| V12            | 37.00         |
| V13            | 1.00          |

# Vitrinite Reflectance

FORDING COAL LIMITED  
 Sample PG-89-038

Compd 087

R# 215781952-956

## BASIC STATISTICS

|                                      |        |
|--------------------------------------|--------|
| Total Number of Observations.....    | 100    |
| Mean Maximum Reflectance (Romax)...% | 1.18   |
| Standard Error of the Mean.....      | 0.00   |
| Coefficient of Variation.....%       | 4.00   |
| Variance.....                        | .0022  |
| Standard Deviation.....              | .0473  |
| Skewness.....                        | .3167  |
| Kurtosis.....                        | 2.9692 |

## CELL STATISTICS

| Cell Number | Lower Limit | Number of Observations | Frequency (%) |
|-------------|-------------|------------------------|---------------|
| 3           | 1.05        | 2                      | 2.00          |
| 4           | 1.10        | 21                     | 21.00         |
| 5           | 1.15        | 36                     | 36.00         |
| 6           | 1.20        | 31                     | 31.00         |
| 7           | 1.25        | 9                      | 9.00          |
| 8           | 1.30        | 1                      | 1.00          |

## VITRINITE TYPE DISTRIBUTION

| Vitrinite Type | Frequency (%) |
|----------------|---------------|
| V10            | 2.00          |
| V11            | 57.00         |
| V12            | 40.00         |
| V13            | 1.00          |

# Vitrinite Reflectance

FORDING COAL LIMITED

Sample PG-89-027 RH2158 83327-331

Compo 073

## BASIC STATISTICS

|                                      |        |
|--------------------------------------|--------|
| Total Number of Observations.....    | 100    |
| Mean Maximum Reflectance (Romax)...% | 1.13   |
| Standard Error of the Mean.....      | .01    |
| Coefficient of Variation.....%       | 4.69   |
| Variance.....                        | .0028  |
| Standard Deviation.....              | .0531  |
| Skewness.....                        | -.0651 |
| Kurtosis.....                        | 2.5416 |

## CELL STATISTICS

| Cell Number | Lower Limit | Number of Observations | Frequency (%) |
|-------------|-------------|------------------------|---------------|
| 3           | 1.00        | 5                      | 5.00          |
| 4           | 1.05        | 23                     | 23.00         |
| 5           | 1.10        | 26                     | 26.00         |
| 6           | 1.15        | 35                     | 35.00         |
| 7           | 1.20        | 9                      | 9.00          |
| 8           | 1.25        | 2                      | 2.00          |

## VITRINITE TYPE DISTRIBUTION

| Vitrinite Type | Frequency (%) |
|----------------|---------------|
| V10            | 28.00         |
| V11            | 61.00         |
| V12            | 11.00         |

# Vitrinite Reflectance

FORDING COAL LIMITED  
 Sample PG-89-039

Compo 089

RH 2159 81901 - 910

## BASIC STATISTICS

|                                      |        |
|--------------------------------------|--------|
| Total Number of Observations.....    | 100    |
| Mean Maximum Reflectance (Romax)...% | 1.14   |
| Standard Error of the Mean.....      | 0.00   |
| Coefficient of Variation.....%       | 4.04   |
| Variance.....                        | .0021  |
| Standard Deviation.....              | .0461  |
| Skewness.....                        | .1314  |
| Kurtosis.....                        | 2.5634 |

## CELL STATISTICS

| Cell Number | Lower Limit | Number of Observations | Frequency (%) |
|-------------|-------------|------------------------|---------------|
| 3           | 1.00        | 1                      | 1.00          |
| 4           | 1.05        | 18                     | 18.00         |
| 5           | 1.10        | 32                     | 32.00         |
| 6           | 1.15        | 33                     | 33.00         |
| 7           | 1.20        | 15                     | 15.00         |
| 8           | 1.25        | 1                      | 1.00          |

## VITRINITE TYPE DISTRIBUTION

| Vitrinite Type | Frequency (%) |
|----------------|---------------|
| V10            | 19.00         |
| V11            | 65.00         |
| V12            | 16.00         |

# Vitrinite Reflectance

FORDING COAL LIMITED  
 Sample PG-89-008

RH 2161 83206-209

Compo 026

## BASIC STATISTICS

|                                      |        |
|--------------------------------------|--------|
| Total Number of Observations.....    | 100    |
| Mean Maximum Reflectance (Romax)...% | 1.30   |
| Standard Error of the Mean.....      | 0.00   |
| Coefficient of Variation.....%       | 3.45   |
| Variance.....                        | .0020  |
| Standard Deviation.....              | .0448  |
| Skewness.....                        | -.1739 |
| Kurtosis.....                        | 3.3951 |

## CELL STATISTICS

| Cell Number | Lower Limit | Number of Observations | Frequency (%) |
|-------------|-------------|------------------------|---------------|
| 3           | 1.15        | 3                      | 3.00          |
| 4           | 1.20        | 6                      | 6.00          |
| 5           | 1.25        | 37                     | 37.00         |
| 6           | 1.30        | 39                     | 39.00         |
| 7           | 1.35        | 13                     | 13.00         |
| 8           | 1.40        | 2                      | 2.00          |

## VITRINITE TYPE DISTRIBUTION

| Vitrinite Type | Frequency (%) |
|----------------|---------------|
| V11            | 3.00          |
| V12            | 43.00         |
| V13            | 52.00         |
| V14            | 2.00          |

# Vitrinite Reflectance

FORDING COAL LIMITED  
 Sample PG-89-009

Compo 029

RH2161 83235-237

## BASIC STATISTICS

|                                      |        |
|--------------------------------------|--------|
| Total Number of Observations.....    | 100    |
| Mean Maximum Reflectance (Romax)...% | 1.37   |
| Standard Error of the Mean.....      | .01    |
| Coefficient of Variation.....%       | 4.36   |
| Variance.....                        | .0036  |
| Standard Deviation.....              | .0598  |
| Skewness.....                        | -.1147 |
| Kurtosis.....                        | 2.7543 |

## CELL STATISTICS

| Cell Number | Lower Limit | Number of Observations | Frequency (%) |
|-------------|-------------|------------------------|---------------|
| 3           | 1.20        | 2                      | 2.00          |
| 4           | 1.25        | 8                      | 8.00          |
| 5           | 1.30        | 22                     | 22.00         |
| 6           | 1.35        | 36                     | 36.00         |
| 7           | 1.40        | 22                     | 22.00         |
| 8           | 1.45        | 9                      | 9.00          |
| 9           | 1.50        | 1                      | 1.00          |

## VITRINITE TYPE DISTRIBUTION

| Vitrinite Type | Frequency (%) |
|----------------|---------------|
| V12            | 10.00         |
| V13            | 58.00         |
| V14            | 31.00         |
| V15            | 1.00          |

# Vitrinite Reflectance

FORDING COAL LIMITED Compo 008  
 Sample PG-89-004 RH 2162 83351-366

### BASIC STATISTICS

|                                      |        |
|--------------------------------------|--------|
| Total Number of Observations.....    | 100    |
| Mean Maximum Reflectance (Romax)...% | 1.17   |
| Standard Error of the Mean.....      | .01    |
| Coefficient of Variation.....%       | 4.55   |
| Variance.....                        | .0028  |
| Standard Deviation.....              | .0531  |
| Skewness.....                        | -.1054 |
| Kurtosis.....                        | 3.0066 |

### CELL STATISTICS

| Cell Number | Lower Limit | Number of Observations | Frequency (%) |
|-------------|-------------|------------------------|---------------|
| 3           | 1.00        | 2                      | 2.00          |
| 4           | 1.05        | 8                      | 8.00          |
| 5           | 1.10        | 23                     | 23.00         |
| 6           | 1.15        | 43                     | 43.00         |
| 7           | 1.20        | 14                     | 14.00         |
| 8           | 1.25        | 10                     | 10.00         |

### VITRINITE TYPE DISTRIBUTION

| Vitrinite Type | Frequency (%) |
|----------------|---------------|
| V10            | 10.00         |
| V11            | 66.00         |
| V12            | 24.00         |



# Vitrinite Reflectance

FORDING COAL LIMITED

Sample PG-89-005

RH2162

83375,76

83371-374

Compo 012

## BASIC STATISTICS

|                                      |        |
|--------------------------------------|--------|
| Total Number of Observations.....    | 100    |
| Mean Maximum Reflectance (Romax)...% | 1.24   |
| Standard Error of the Mean.....      | .01    |
| Coefficient of Variation.....%       | 4.29   |
| Variance.....                        | .0028  |
| Standard Deviation.....              | .0530  |
| Skewness.....                        | .5178  |
| Kurtosis.....                        | 3.0988 |

## CELL STATISTICS

| Cell Number | Lower Limit | Number of Observations | Frequency (%) |
|-------------|-------------|------------------------|---------------|
| 3           | 1.10        | 3                      | 3.00          |
| 4           | 1.15        | 18                     | 18.00         |
| 5           | 1.20        | 40                     | 40.00         |
| 6           | 1.25        | 25                     | 25.00         |
| 7           | 1.30        | 10                     | 10.00         |
| 8           | 1.35        | 4                      | 4.00          |

## VITRINITE TYPE DISTRIBUTION

| Vitrinite Type | Frequency (%) |
|----------------|---------------|
| V11            | 21.00         |
| V12            | 65.00         |
| V13            | 14.00         |

# Vitrinite Reflectance

FORDING COAL LIMITED  
 Sample PG-89-002

Compo 003  
 RH2163 83177-193

## BASIC STATISTICS

|                                      |        |
|--------------------------------------|--------|
| Total Number of Observations.....    | 100    |
| Mean Maximum Reflectance (Romax)...% | 1.19   |
| Standard Error of the Mean.....      | 0.00   |
| Coefficient of Variation.....%       | 3.51   |
| Variance.....                        | .0017  |
| Standard Deviation.....              | .0418  |
| Skewness.....                        | -.1824 |
| Kurtosis.....                        | 2.7278 |

## CELL STATISTICS

| Cell Number | Lower Limit | Number of Observations | Frequency (%) |
|-------------|-------------|------------------------|---------------|
| 3           | 1.05        | 1                      | 1.00          |
| 4           | 1.10        | 11                     | 11.00         |
| 5           | 1.15        | 43                     | 43.00         |
| 6           | 1.20        | 38                     | 38.00         |
| 7           | 1.25        | 7                      | 7.00          |

## VITRINITE TYPE DISTRIBUTION

| Vitrinite Type | Frequency (%) |
|----------------|---------------|
| V10            | 1.00          |
| V11            | 54.00         |
| V12            | 45.00         |

# Vitrinite Reflectance

FORDING COAL LIMITED  
 Sample PG-89-003

Compo 007  
 RH2164 83151-154

## BASIC STATISTICS

|                                      |        |
|--------------------------------------|--------|
| Total Number of Observations.....    | 100    |
| Mean Maximum Reflectance (Romax)...% | 1.28   |
| Standard Error of the Mean.....      | .01    |
| Coefficient of Variation.....%       | 4.10   |
| Variance.....                        | .0028  |
| Standard Deviation.....              | .0526  |
| Skewness.....                        | .0002  |
| Kurtosis.....                        | 2.8070 |

## CELL STATISTICS

| Cell Number | Lower Limit | Number of Observations | Frequency (%) |
|-------------|-------------|------------------------|---------------|
| 3           | 1.15        | 5                      | 5.00          |
| 4           | 1.20        | 21                     | 21.00         |
| 5           | 1.25        | 38                     | 38.00         |
| 6           | 1.30        | 22                     | 22.00         |
| 7           | 1.35        | 13                     | 13.00         |
| 8           | 1.40        | 1                      | 1.00          |

## VITRINITE TYPE DISTRIBUTION

| Vitrinite Type | Frequency (%) |
|----------------|---------------|
| V11            | 5.00          |
| V12            | 59.00         |
| V13            | 35.00         |
| V14            | 1.00          |

# Vitrinite Reflectance

FORDING COAL LIMITED

Compo 043

Sample PG-89-012 RH2165 63401-412

## BASIC STATISTICS

|                                      |        |
|--------------------------------------|--------|
| Total Number of Observations.....    | 100    |
| Mean Maximum Reflectance (Romax)...% | 1.20   |
| Standard Error of the Mean.....      | 0.00   |
| Coefficient of Variation.....%       | 4.00   |
| Variance.....                        | .0023  |
| Standard Deviation.....              | .0481  |
| Skewness.....                        | -.1964 |
| Kurtosis.....                        | 2.6070 |

## CELL STATISTICS

| Cell Number | Lower Limit | Number of Observations | Frequency (%) |
|-------------|-------------|------------------------|---------------|
| 3           | 1.05        | 1                      | 1.00          |
| 4           | 1.10        | 14                     | 14.00         |
| 5           | 1.15        | 27                     | 27.00         |
| 6           | 1.20        | 37                     | 37.00         |
| 7           | 1.25        | 20                     | 20.00         |
| 8           | 1.30        | 1                      | 1.00          |

## VITRINITE TYPE DISTRIBUTION

| Vitrinite Type | Frequency (%) |
|----------------|---------------|
| V10            | 1.00          |
| V11            | 41.00         |
| V12            | 57.00         |
| V13            | 1.00          |

# Vitrinite Reflectance

FORDING COAL LIMITED  
Sample PG-89-040

Comp 097  
RH 2167 82003-013

## BASIC STATISTICS

|                                      |        |
|--------------------------------------|--------|
| Total Number of Observations.....    | 100    |
| Mean Maximum Reflectance (Romax)...% | 1.18   |
| Standard Error of the Mean.....      | 0.00   |
| Coefficient of Variation.....%       | 3.79   |
| Variance.....                        | .0020  |
| Standard Deviation.....              | .0446  |
| Skewness.....                        | -.1849 |
| Kurtosis.....                        | 3.1632 |

## CELL STATISTICS

| Cell Number | Lower Limit | Number of Observations | Frequency (%) |
|-------------|-------------|------------------------|---------------|
| 3           | 1.00        | 1                      | 1.00          |
| 4           | 1.05        | 2                      | 2.00          |
| 5           | 1.10        | 21                     | 21.00         |
| 6           | 1.15        | 39                     | 39.00         |
| 7           | 1.20        | 32                     | 32.00         |
| 8           | 1.25        | 5                      | 5.00          |

## VITRINITE TYPE DISTRIBUTION

| Vitrinite Type | Frequency (%) |
|----------------|---------------|
| V10            | 3.00          |
| V11            | 60.00         |
| V12            | 37.00         |

# Vitrinite Reflectance

FORDING COAL LIMITED

Sample PG-89-041

Compo 100  
RH 2167 B2023 - 025

## BASIC STATISTICS

|                                      |        |
|--------------------------------------|--------|
| Total Number of Observations.....    | 100    |
| Mean Maximum Reflectance (Romax)...% | 1.19   |
| Standard Error of the Mean.....      | 0.00   |
| Coefficient of Variation.....%       | 3.45   |
| Variance.....                        | .0017  |
| Standard Deviation.....              | .0411  |
| Skewness.....                        | -.0518 |
| Kurtosis.....                        | 2.4085 |

## CELL STATISTICS

| Cell Number | Lower Limit | Number of Observations | Frequency (%) |
|-------------|-------------|------------------------|---------------|
| 2           | 1.10        | 16                     | 16.00         |
| 3           | 1.15        | 35                     | 35.00         |
| 4           | 1.20        | 39                     | 39.00         |
| 5           | 1.25        | 10                     | 10.00         |

## VITRINITE TYPE DISTRIBUTION

| Vitrinite Type | Frequency (%) |
|----------------|---------------|
| V11            | 51.00         |
| V12            | 49.00         |