

VOLUME II

PRELIMINARY REPORT

ON

NANAIMO COAL BASIN

VANCOUVER ISLAND

92 F 1

for

NETHERLAND PACIFIC MINES INC.

VANCOUVER, BRITISH COLUMBIA

OPEN FILE

PREPARED BY:

MICHELE P. CURCIO
COAL CONSULTANT
WEST VANCOUVER, B.C.

SEPTEMBER, 1979

(2)

792

VOLUME II

TABLE OF CONTENTS

- POCKET 1 - PROPERTY & LOCATION - MAP #1 ✓
- POCKET 2 - STRUCTURE - MAP #2 ✓
STRUCTURE - MAP #3
- POCKET 3 - DRILL HOLE LOCATION - MAP #4
& PROPOSED EXPLORATION - MAP #5
- POCKET 4 - WORKED OUT MINES - MAP #6 ✓
WORKED OUT MINES - MAP #7 ✓
- POCKET 5 - OLD MINE WORKED PLANS ✓
8 MAPS AS SHOWN ON MAPS 6 & 7 ✓
- POCKET 6 - STRUCTURE PROFILE
COWICHAN LAKE TO GABRIOLA ISLAND - MAP #8 ✓

- STRUCTURE PROFILE
COMOX TO NANAIMO BASIN - MAP #8 ✓
- POCKET 7 - PROPERTY OUTLINE AND SURFACE OWNERSHIP - MAP #9 ✓
PROPERTY OUTLINE AND SURFACE OWNERSHIP - MAP #10 ✓
- POCKET 8 - DRILL SECTION - WOLF MOUNTAIN - MAP #11 ✓
- POCKET 9 - DRILL SECTIONS AS SHOWN ON
MAPS 4 & 5 - MAP #12 ✓

NETHERLANDS PACIFIC MINING CO. INC.
VANCOUVER, B.C.

NANAIMO COAL FIELDS LICENCE AREA - LOCATION MAP

SCALE: 2 cm = 1 km

792 (2) (11)

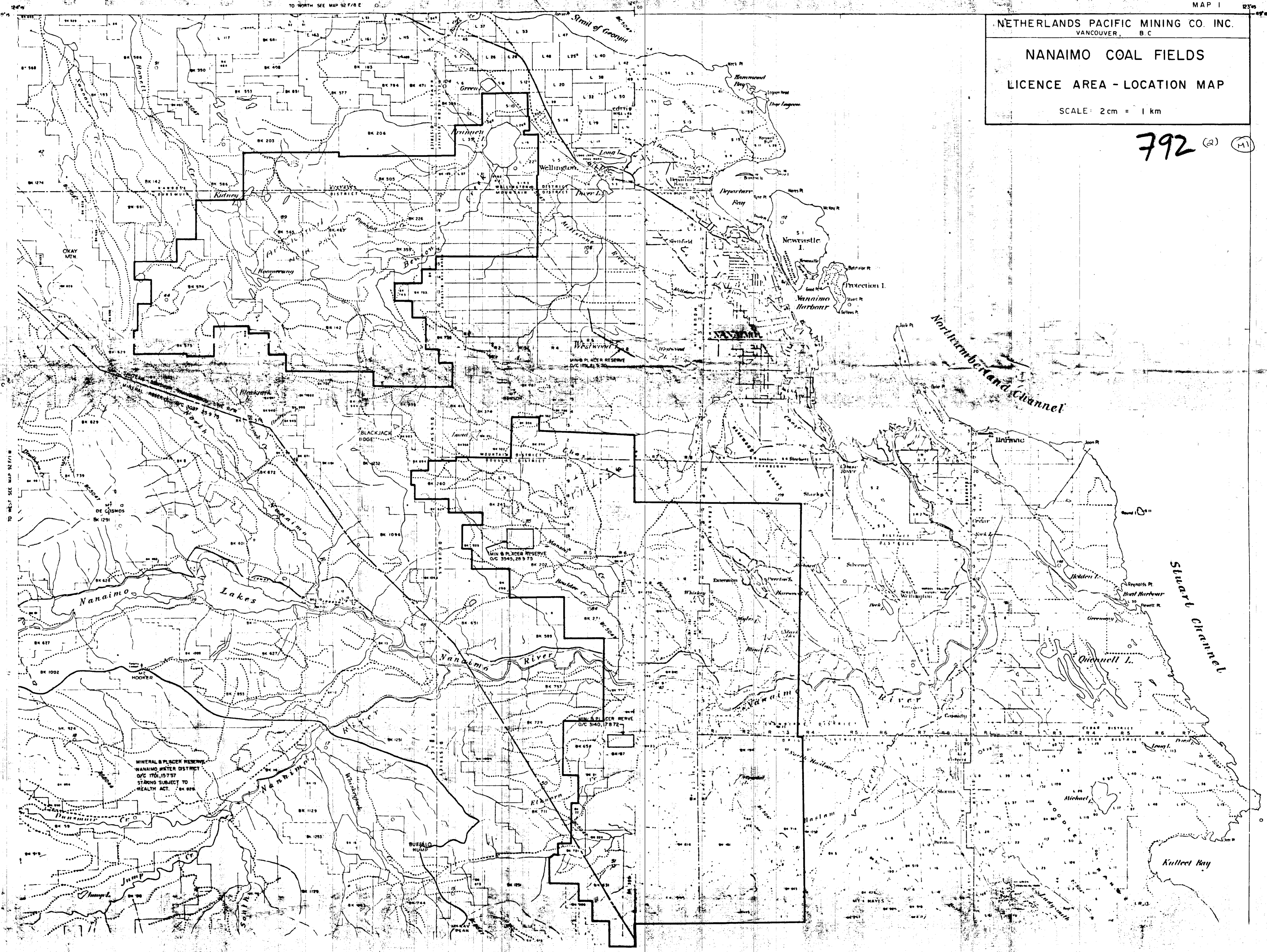

LEGEND
 BOUNDARY OF LICENCE AREA
 BOUNDARY OF DISTRICTS
 BOUNDARY OF PARCELS
 BOUNDARY OF MINERAL RESERVE
 BOUNDARY OF WATER RESERVE
 BOUNDARY OF ROAD
 BOUNDARY OF RAILWAY
 BOUNDARY OF CANAL
 BOUNDARY OF DAM
 BOUNDARY OF TUNNEL
 BOUNDARY OF BRIDGE
 BOUNDARY OF FERRY
 BOUNDARY OF BOAT LIFT
 BOUNDARY OF PIER
 BOUNDARY OF WHARF
 BOUNDARY OF DOCK
 BOUNDARY OF QUAY
 BOUNDARY OF BARRAGE
 BOUNDARY OF LOCK
 BOUNDARY OF WEIR
 BOUNDARY OF DAM
 BOUNDARY OF TUNNEL
 BOUNDARY OF BRIDGE
 BOUNDARY OF FERRY
 BOUNDARY OF BOAT LIFT
 BOUNDARY OF PIER
 BOUNDARY OF WHARF
 BOUNDARY OF DOCK
 BOUNDARY OF QUAY
 BOUNDARY OF BARRAGE
 BOUNDARY OF LOCK
 BOUNDARY OF WEIR

C 92 G

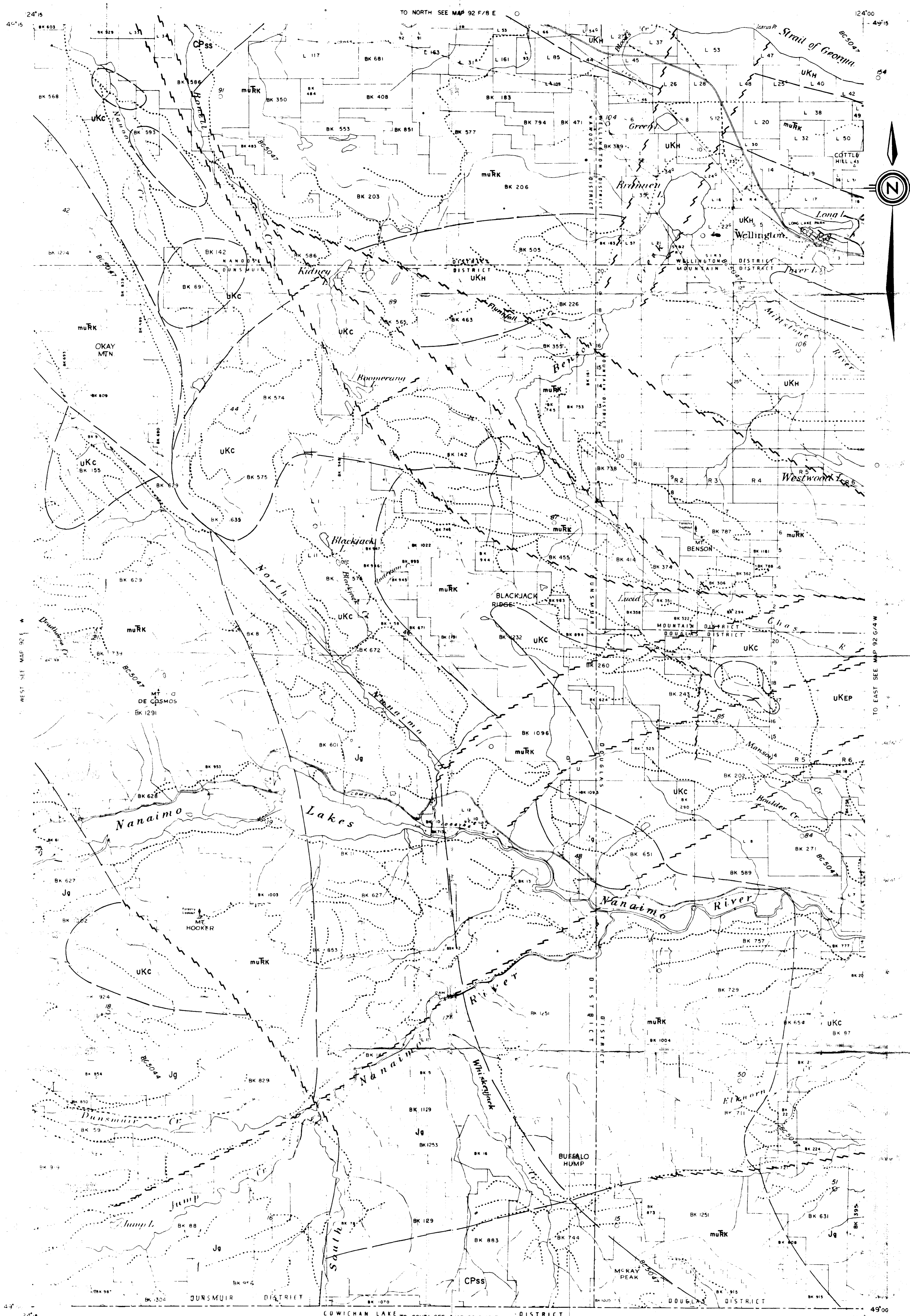

LEGEND

- INTERNATIONAL BOUNDARY
- PROVINCIAL BOUNDARY
- PARK BOUNDARY
- HEIGHT OF LAND
- LOT BOUNDARY SURVEYED
- 50 FT BOUNDARY UNSURVEYED OR UNCERTAIN
- LOT NUMBER
- SURVEYED RIGHT OF WAY
- RAILWAY
- ABANDONED RAILWAY
- HIGHWAY MAIN OR ALONG SECTION LINES
- OTHER ROADS
- TRAIL
- POWER TRANSMISSION LINE
- PIPELINE
- CULTIVATED AREA
- EDGE OF LOGGING OR BURN

- BRIDGE
- TUNNEL
- BUILDING
- FENCE
- CUTTING
- EMBANKMENT
- CLIFF OR STEEP BANK
- EDGE OF DROP
- LOW RIDGE
- BOUNDARY OF SWAMP FLAT GLACIER ETC
- IRRIGATION CANAL OR FLUME
- TRIANGULATION STATION
- SURVEY MONUMENT
- AIR PHOTO CENTRES
- FLIGHT NUMBERS
- STREAM
- WATER
- WATER
- WATER

- CPSS Sicker Group
- muRK Karmutsen Formation
- Jg Island Intrusions and Westcoast Complex
- UKC, UKG Nanaimo Group

792 MAP 2

NETHERLANDS PACIFIC MINING CO. INC.
VANCOUVER B.C.

NANAIMO COAL FIELDS (M2)
WEST HALF
STRUCTURE

SCALE: 1 inch = 1/2 mile

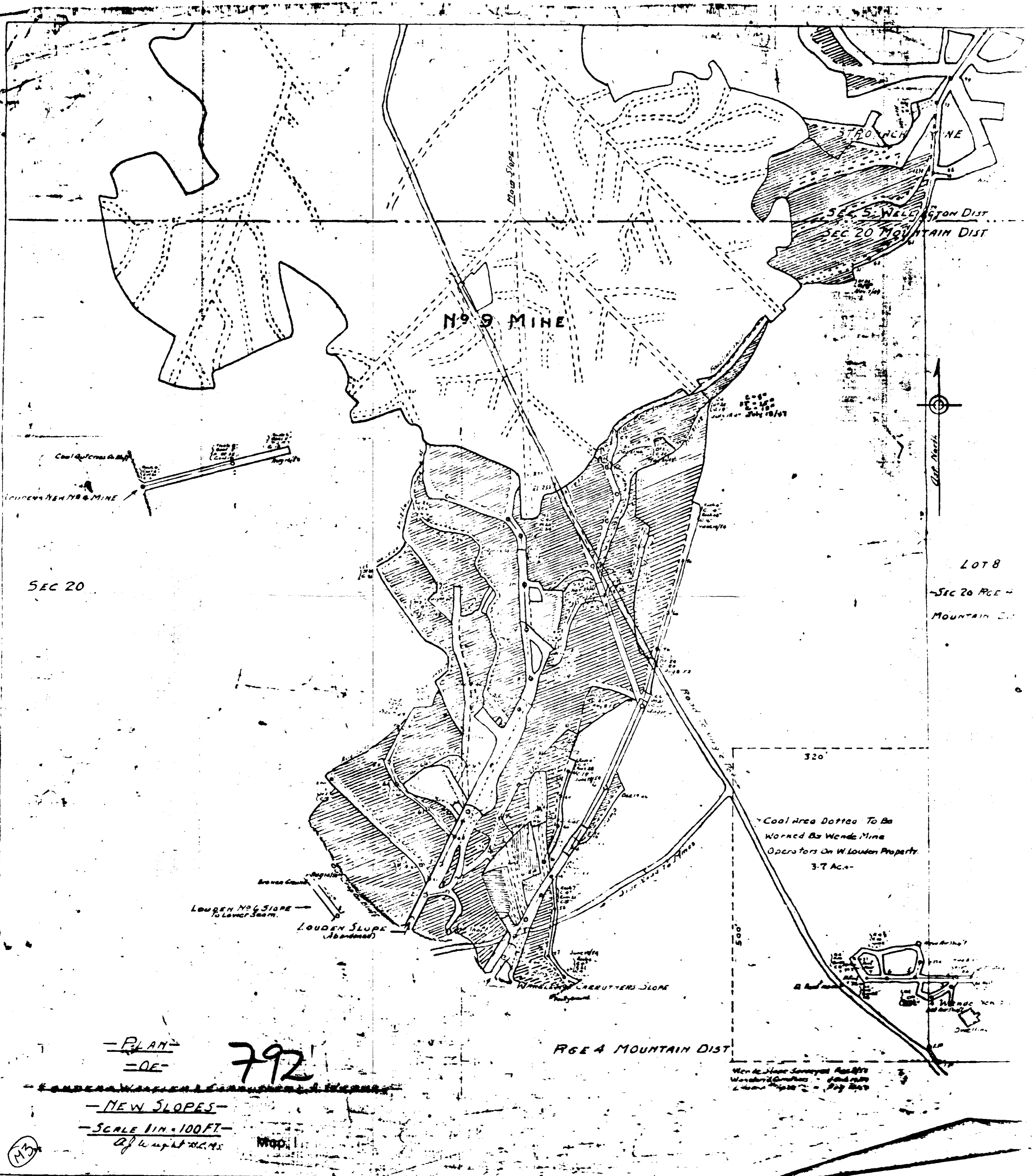

N^o 9 MINE

SEC 5 WELLSINGTON DIST
SEC 20 MOUNTAIN DIST

SEC 20

LOT 8

SEC 20 RGE 4
MOUNTAIN DIST

Coal Area Dotted To Be
Worked By Wende Mine
Operators On W. Loudon Property.
3.7 Ac.

LOUDEM N^o 6 SLOPE
To Lower Seam.

LOUDEM SLOPE
(Abandoned)

WINDY SLOPE
(Abandoned)

RGE 4 MOUNTAIN DIST

PLAN
=OE-

792

NEW SLOPES

SCALE 1 IN. = 100 FT.

of weight 21.25

Map

M3

Wende Mine Surveyed 1885
Wende Mine 1885
Loudon 1885

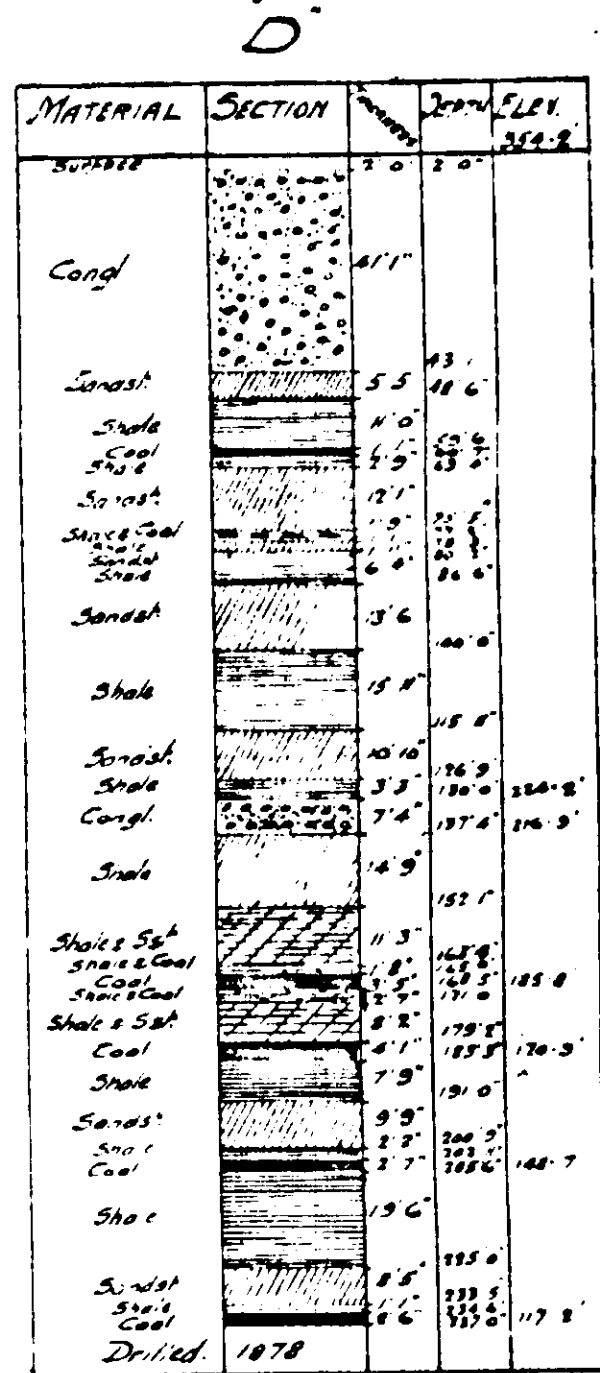
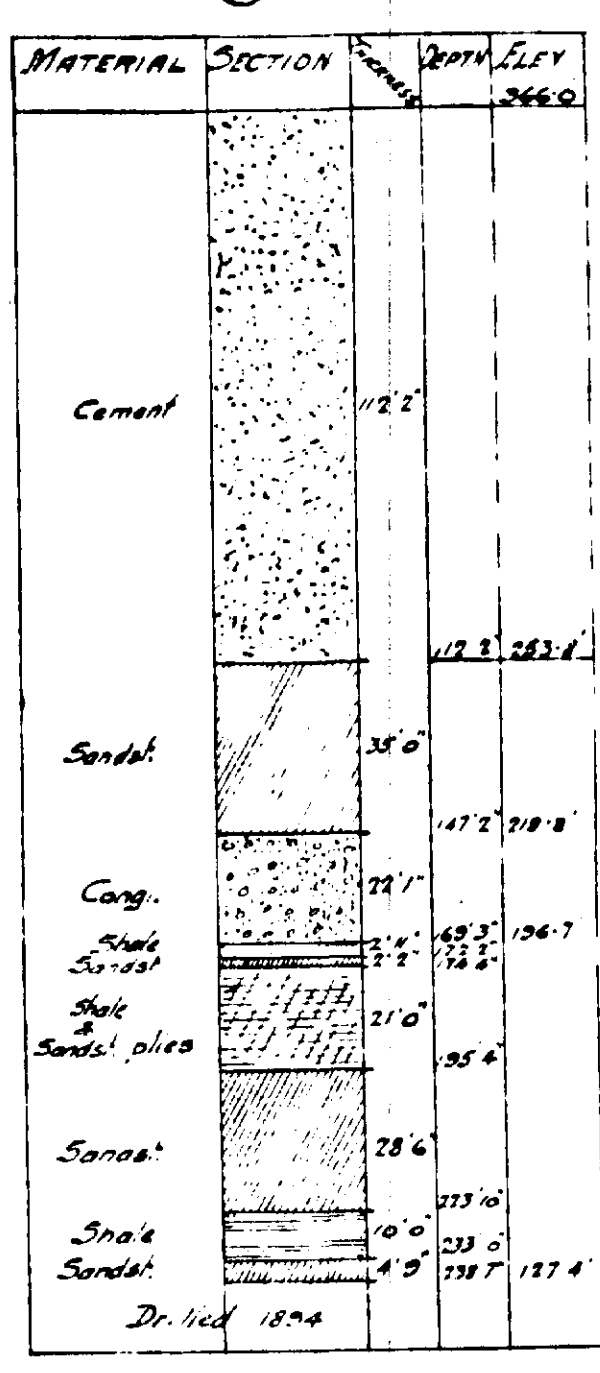
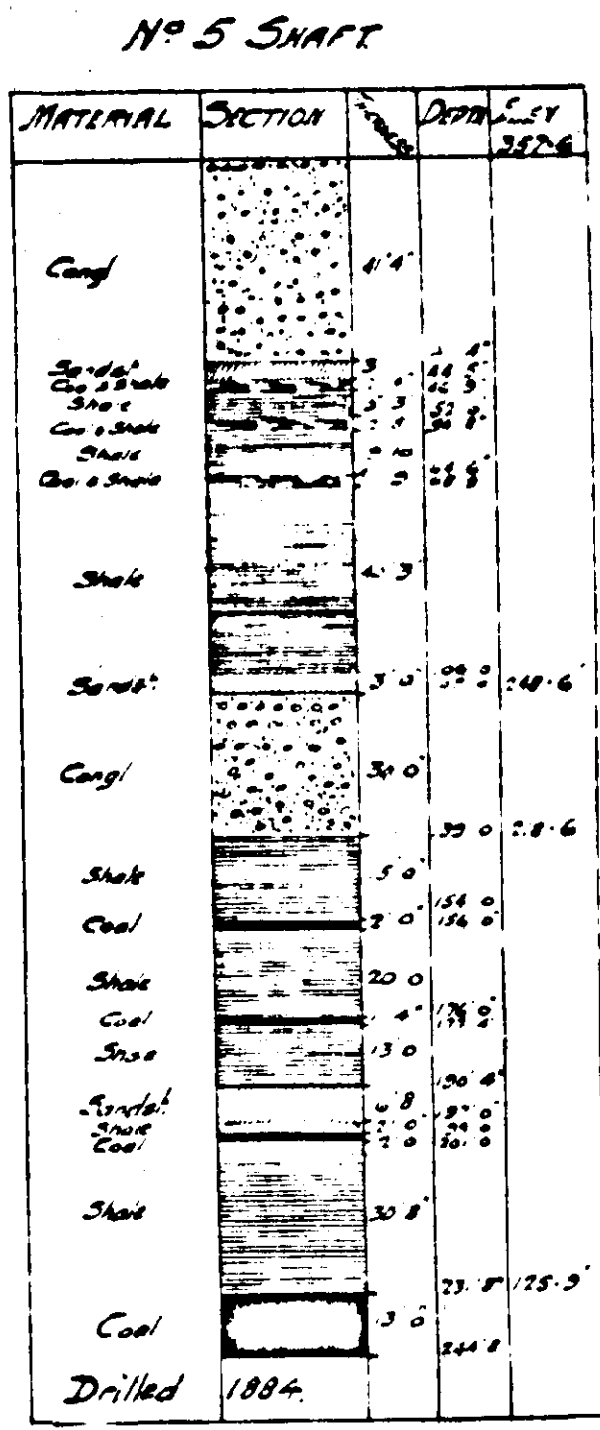
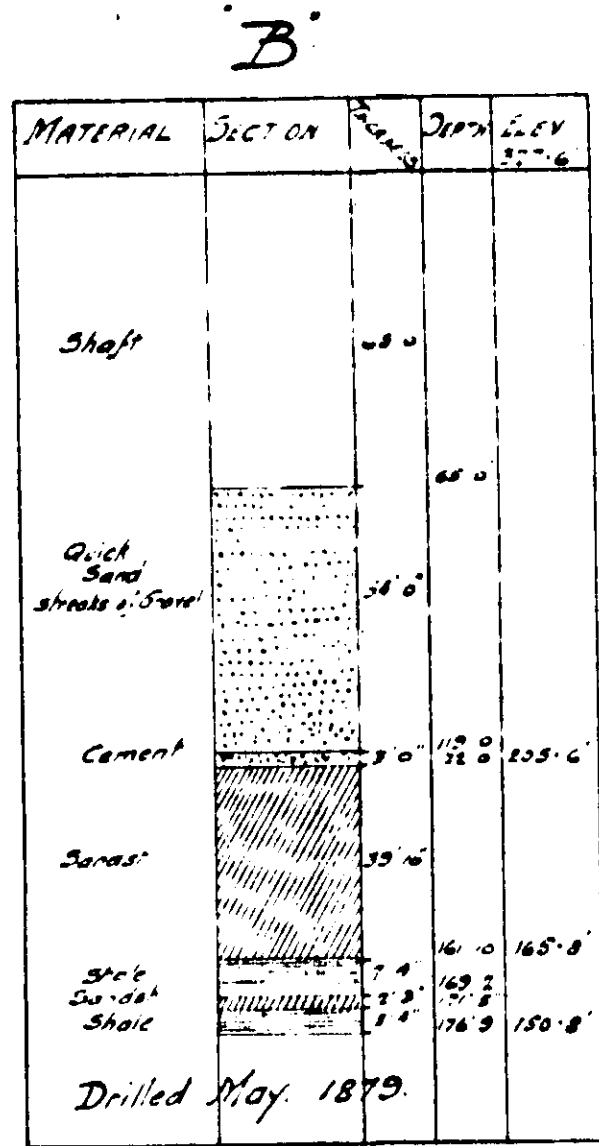
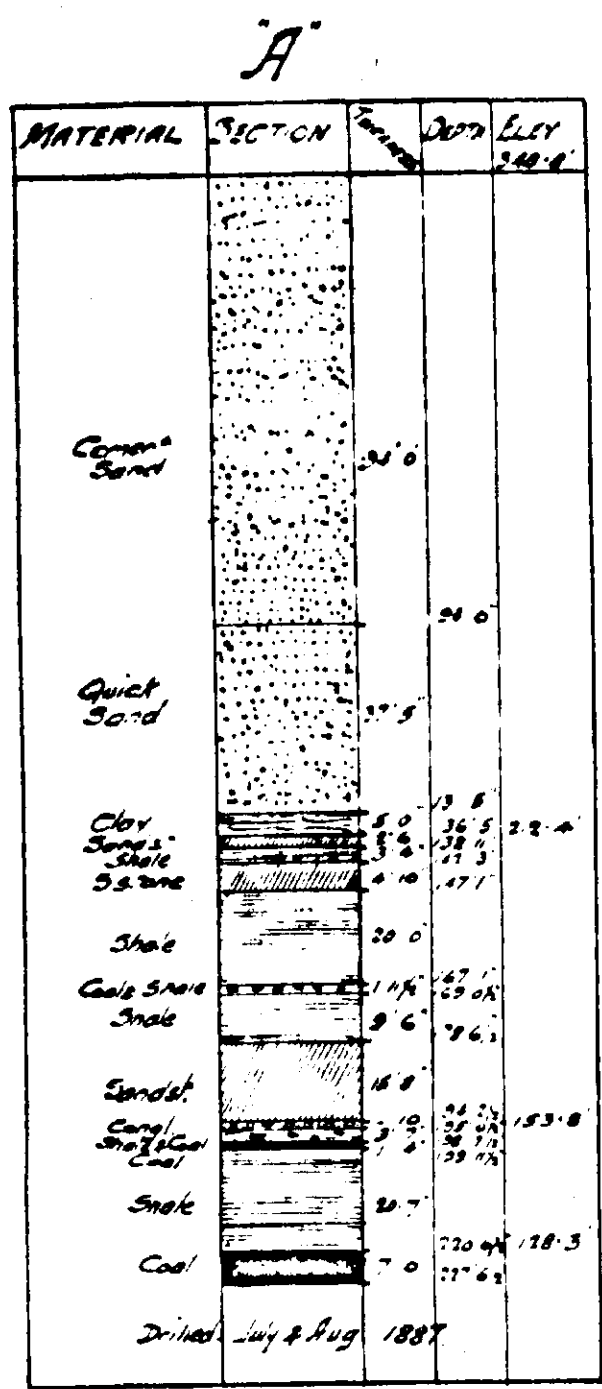

BORE HOLE SECTIONS
Scale: 1" = 40'

Note
Bore Holes Lettered for purposes of this Plan only;
DESCRIPTIONS AS SHOWN ON ORIGINAL PLAN
A - Junction Bore opp. Machine Shops
B - No 3 at J. Dunsmuir's House
C - No 3 near Presbyterian Church
D - No 2 Diver Lake

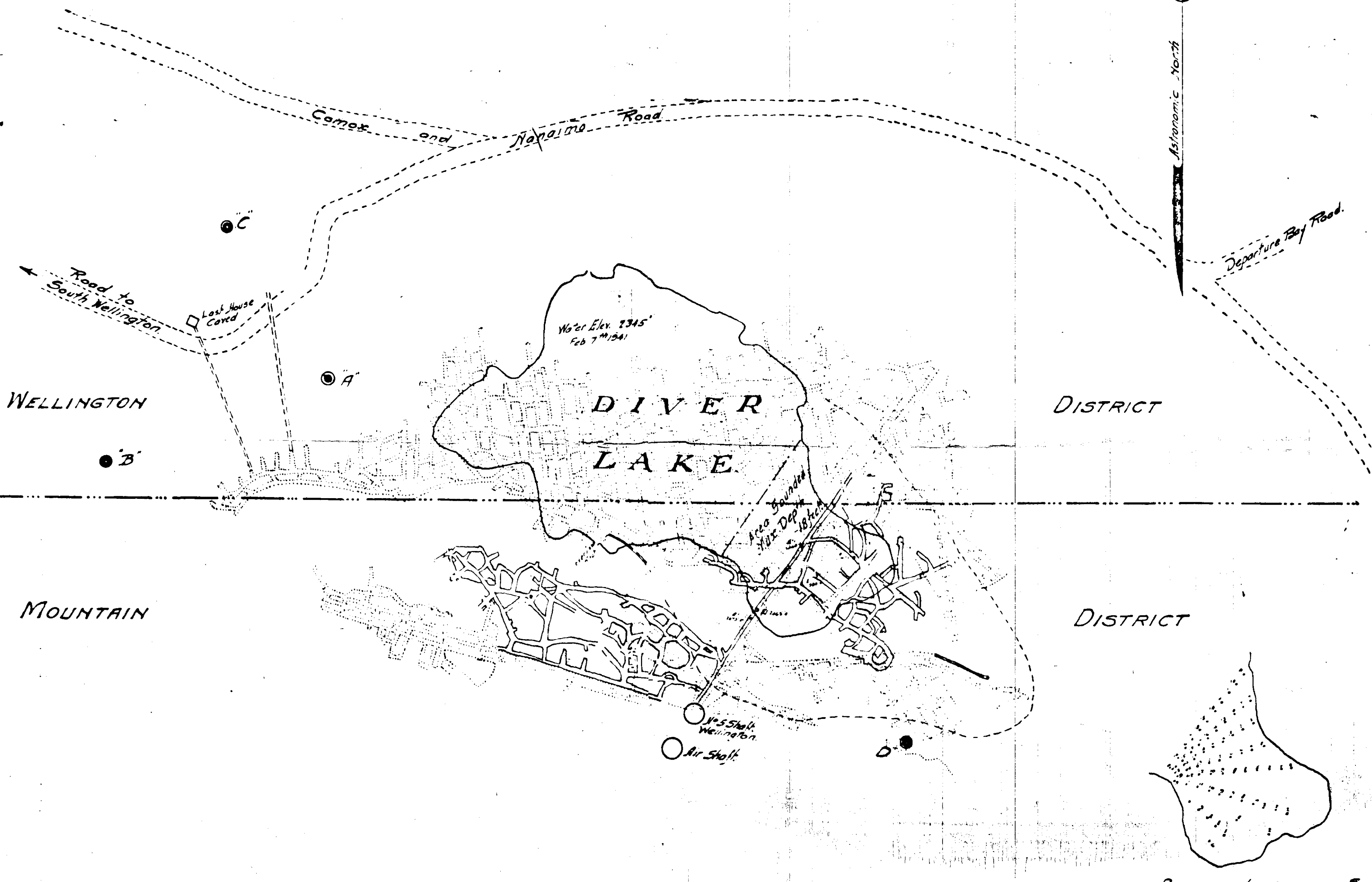

PORTION OF LAKE SHOWING SOUNDINGS
Depths in feet.

Elevations reduced to Datum 2000 feet below Sea Level.
Old workings of No 5 Wellington Mine shown by Dotted Lines
Present workings from Northfield Mine - - - - - Solid - - -

792

Canadian Collieries (C) Ltd
Engineering Dept
Vancouver, B.C.
Feb'y 6th 1941

PLAN
 OF THE WORKINGS OF
 N^o 1 SLOPE ADIT LEVEL
 AND
 N^{os} 1 2 3 4 5 & 6 SHAFTS.
 -REDUCED FROM ORIGINAL PLANS.
 WELLINGTON & MOUNTAIN DISTRICTS.
 Scale 500 feet to Inch

9D

792

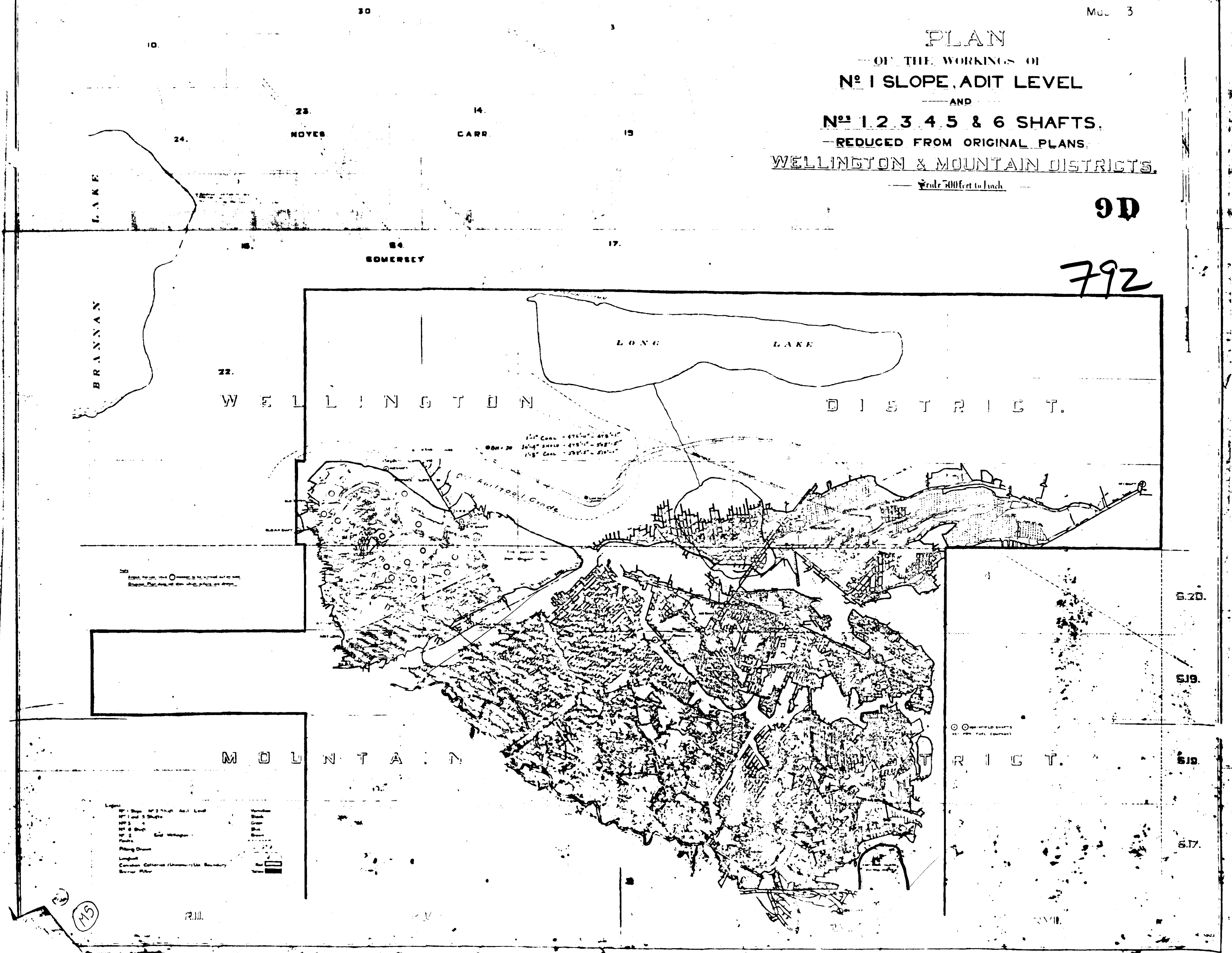

W E L L I N G T O N D I S T R I C T .

M O U N T A I N D I S T R I C T .

S.20.

S.19.

S.18.

S.17.

- Legend symbols and descriptions:
- Shaft
- Adit Level
- Railroad Grade
- Boundary
- Contour Lines
- Water
- Buildings
- Roads
- Fences
- Trees
- Hills
- Valleys
- Rivers
- Lakes
- Swamps
- Marshes
- Pastures
- Cultivated Land
- Uncultivated Land
- Forest
- Open Land
- Water
- Buildings
- Roads
- Fences
- Trees
- Hills
- Valleys
- Rivers
- Lakes
- Swamps
- Marshes
- Pastures
- Cultivated Land
- Uncultivated Land
- Forest
- Open Land

WORLD SHAFTS
 BY THE PAPEL COMPANY

R.III.

MS

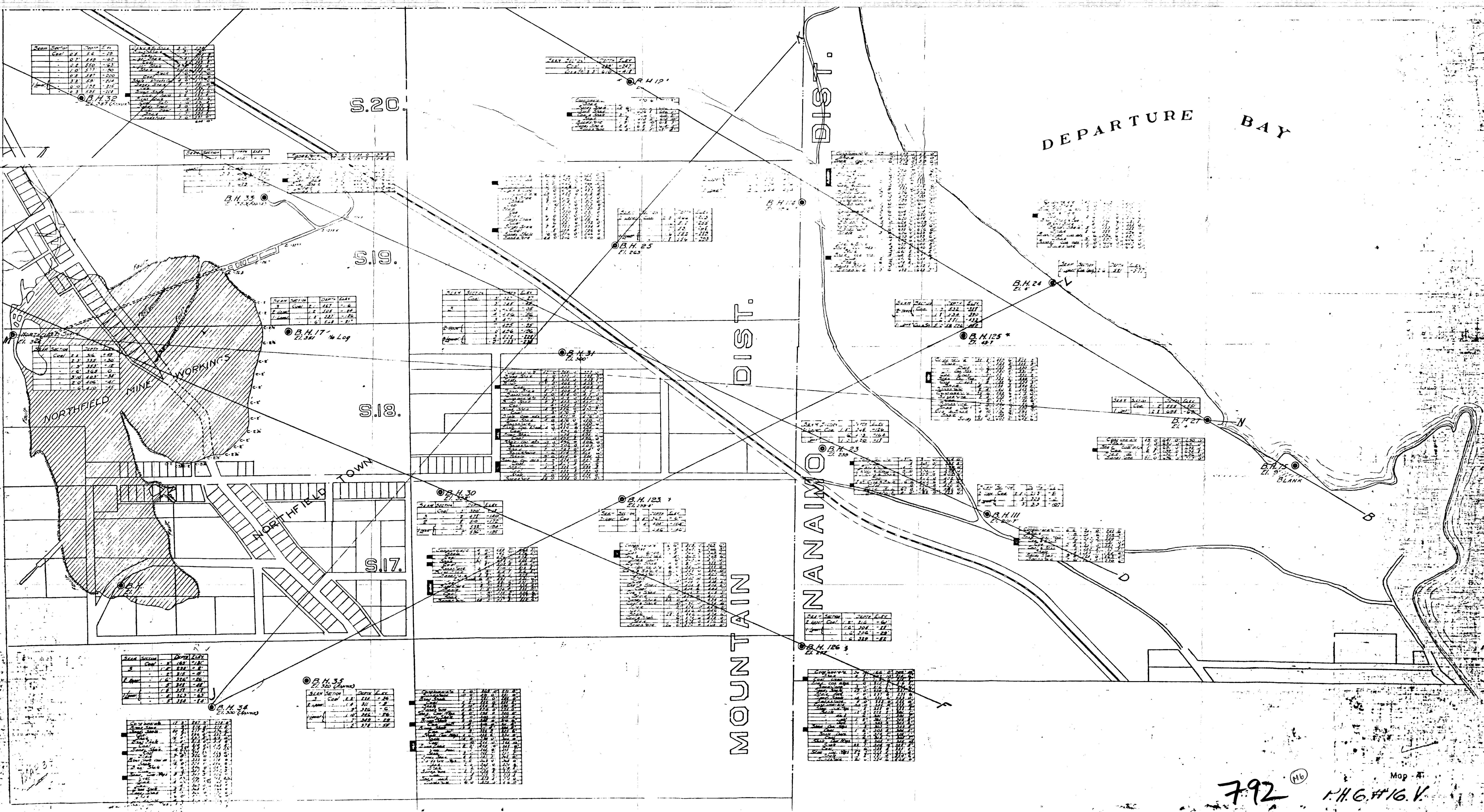

792 (MB) P.H.G.#16.V

Map #

- CANADIAN COLLIERIES (DUNSMUIR) L^{TD} -

- PLAN OF EXTENSION PROSPECT MINE -

- SITUATE IN SEC. 14, RANGE 2, CRANBERRY DISTRICT, V.I. -

- Scale 1" = 100' -

Plan abandoned July 18th 1947

Datum 2000 feet below Mean Sea Level of Ledyard Pt., B.C.

Geoffrey James Blair
B.C. Mine Surveyor

Canadian Collieries (Dunsmuir) Ltd.
Engineering Dept.
Victoria, B.C. Jan. 22, 1947.



CRANBERRY DIST.

SEC. 14

RGE. 1

SEC. 18

RGE. 2

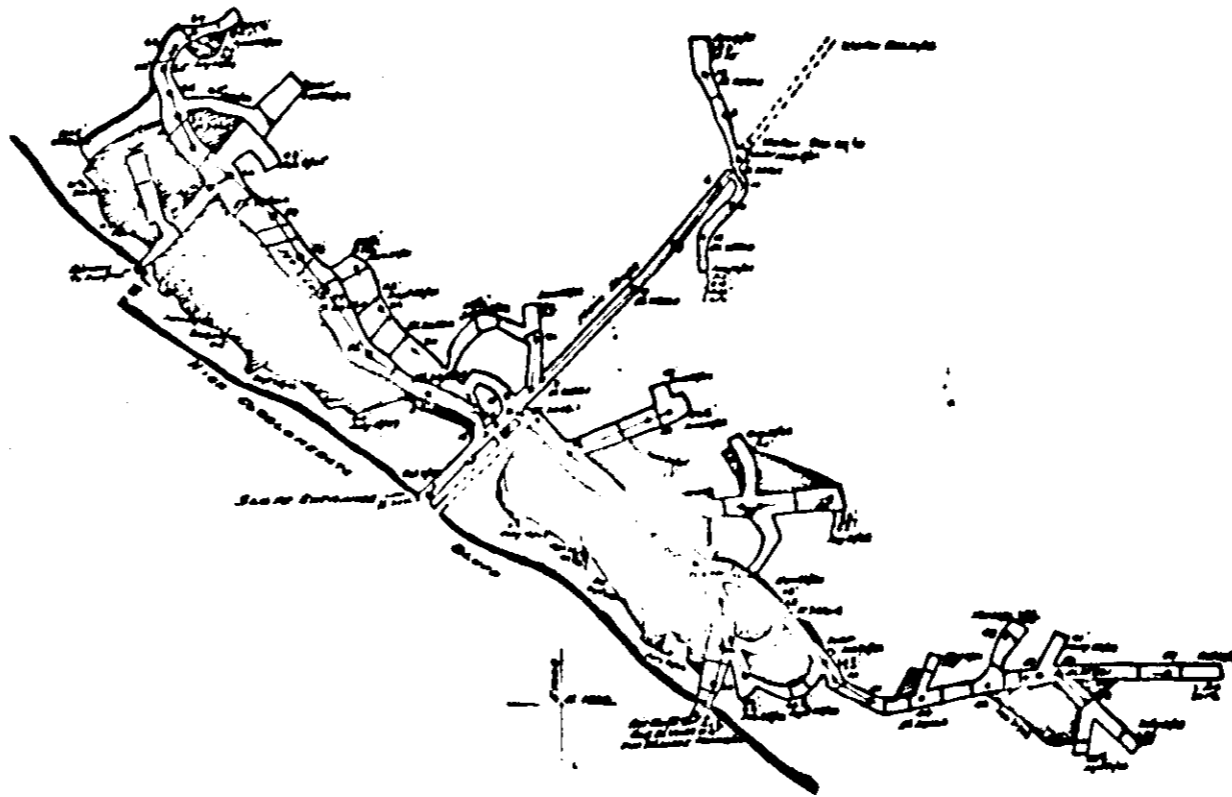

Map 6

EXTENSION PROSPECT
ABANDONMENT PLAN
1947

792

M7

- CANADIAN COLLIERIES (DUNSMUIR) L^{td} -

- PLAN OF EXTENSION PROSPECT MINE -

- SITUATE IN SEC. 14, RANGE 2, CRANBERRY DISTRICT, V.I. -

- Scale - 1" = 100' -

Mine abandoned July 18th 1947

Depth 2000 feet below Mean Sea Level of Ladysmith, B.C.

Geological Map
B.C. Mine Survey

Canadian Collieries (Dunsmuir) Ltd.
Engineering Dept.
Victoria, B.C. Sept. 22, 1947.

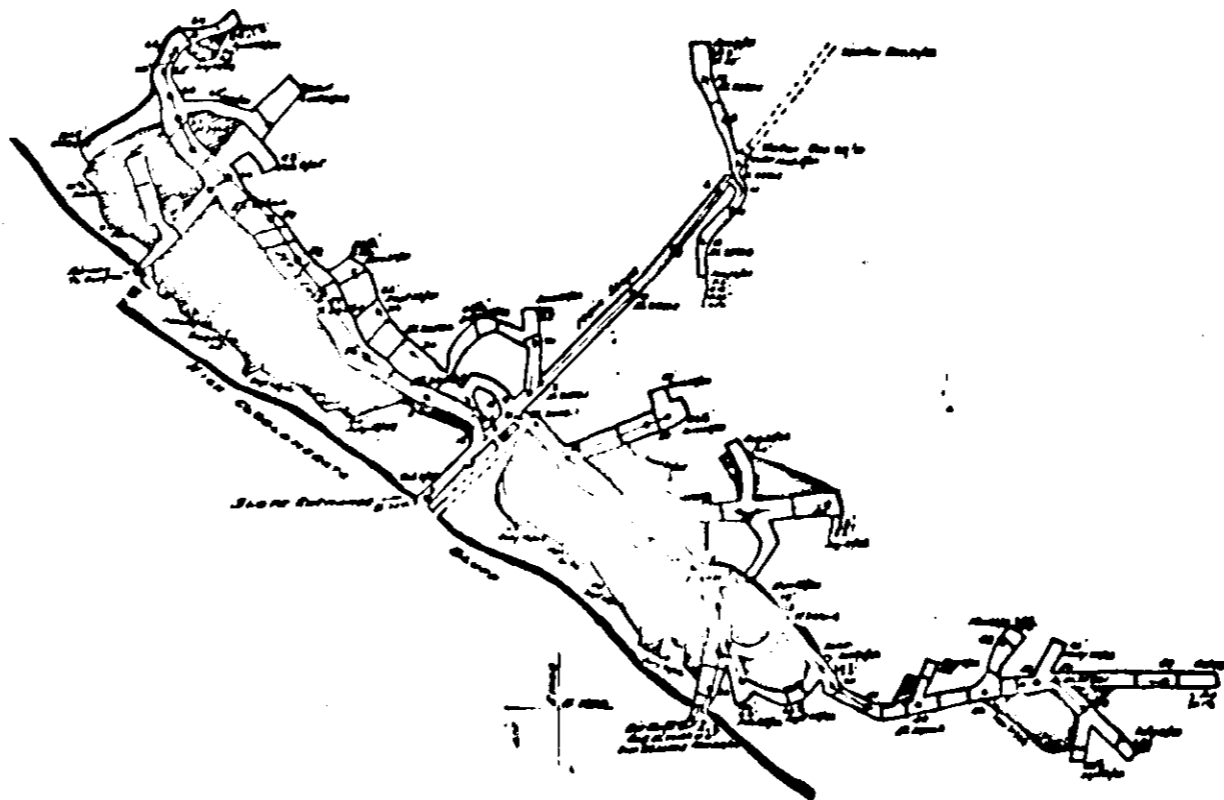

CRANBERRY DIST.

SEC. 14

RGE 1

SEC. 13

RGE. 2

792

Map 6

EXTENSION PROSPECT
ABANDONMENT PLAN
1947.

(M8)



STREET NAME

STREET NAME

STREET NAME

STREET NAME

STREET NAME

792

Map 5

(M9)

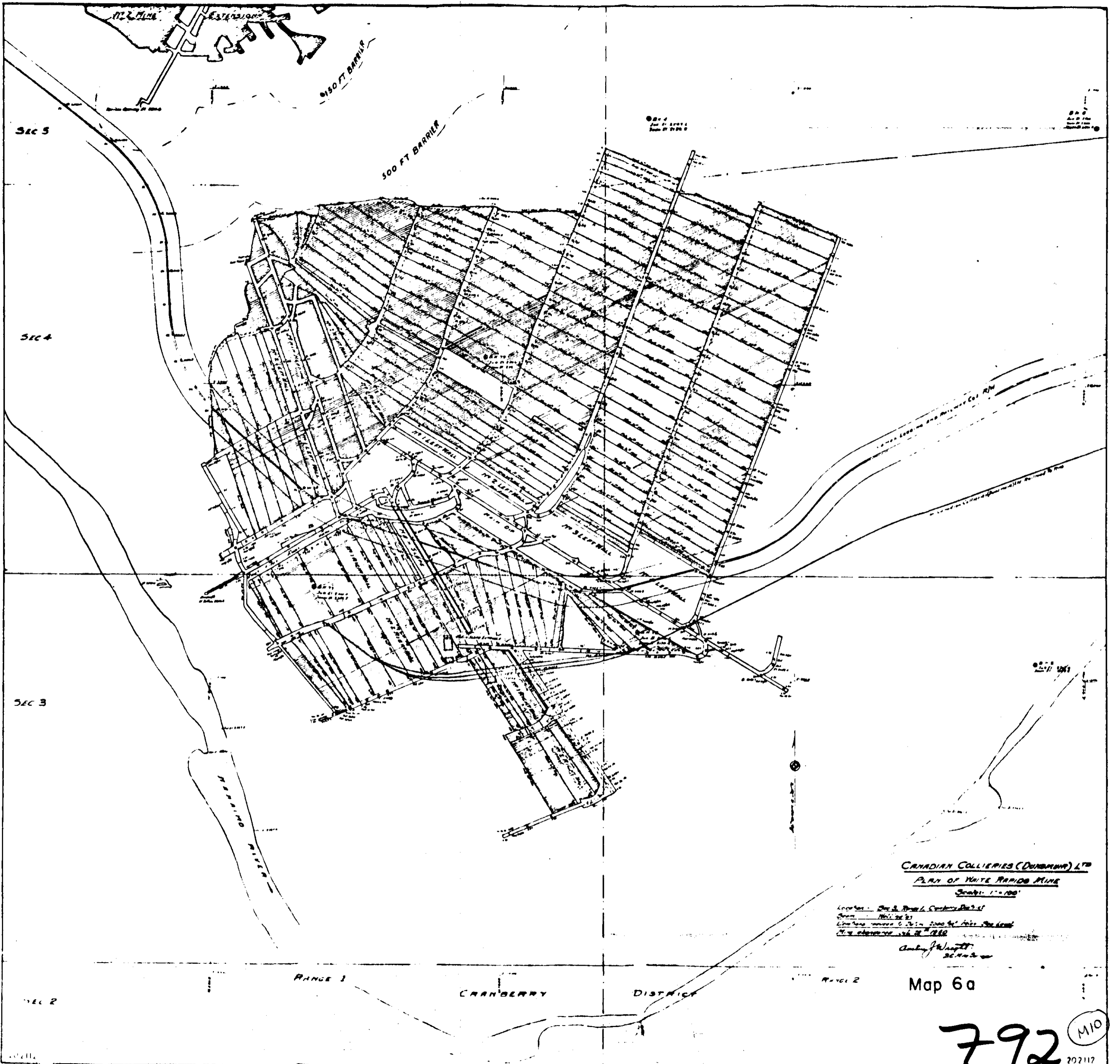

CANADIAN COLLIERIES (DURHAM) LTD.
 PLAN OF WHITE RAPIDS MINE
 Scale: 1" = 100'

Location: Sec. 3, Range 1, Cranberry Dist.
 Open: 1881
 Shaft No. 1: 2000 ft. deep
 Shaft No. 2: 1200 ft. deep
 Shaft No. 3: 1000 ft. deep
 Shaft No. 4: 1000 ft. deep
 Shaft No. 5: 1000 ft. deep
 Shaft No. 6: 1000 ft. deep
 Shaft No. 7: 1000 ft. deep
 Shaft No. 8: 1000 ft. deep
 Shaft No. 9: 1000 ft. deep
 Shaft No. 10: 1000 ft. deep

Amby J. Wright
 20/10/20

Map 6a

792 M10
 202117

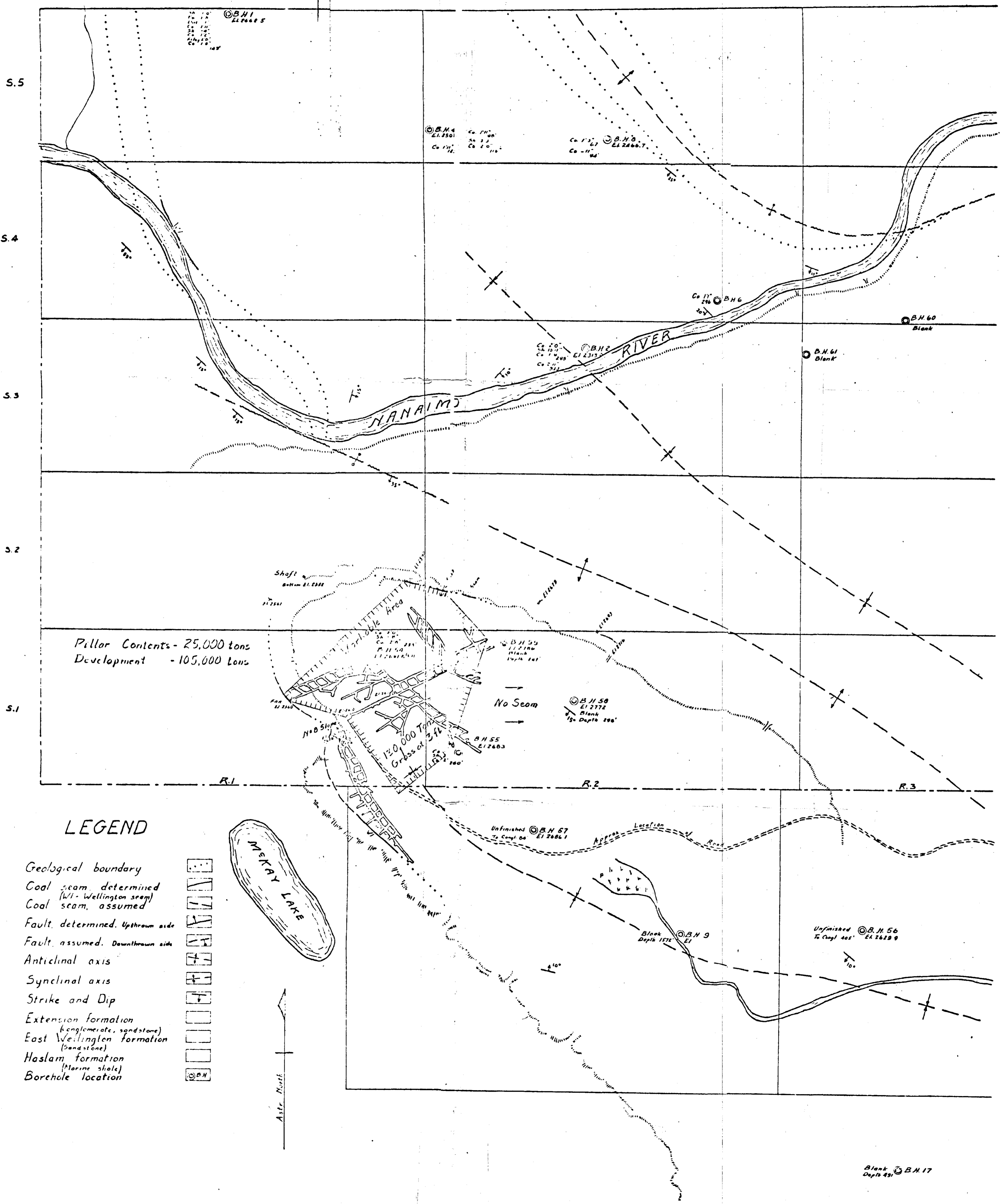

LEGEND

- Geological boundary
- Coal seam, determined (W/- Wellington seam)
- Coal seam, assumed
- Fault, determined, Upthrown side
- Fault, assumed, Downthrown side
- Anticlinal axis
- Synclinal axis
- Strike and Dip
- Extension formation (conglomerate, sandstone)
- East Wellington formation (Sandstone)
- Haslam formation (Marine shale)
- Borehole location

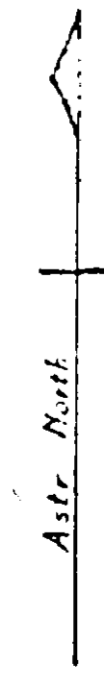
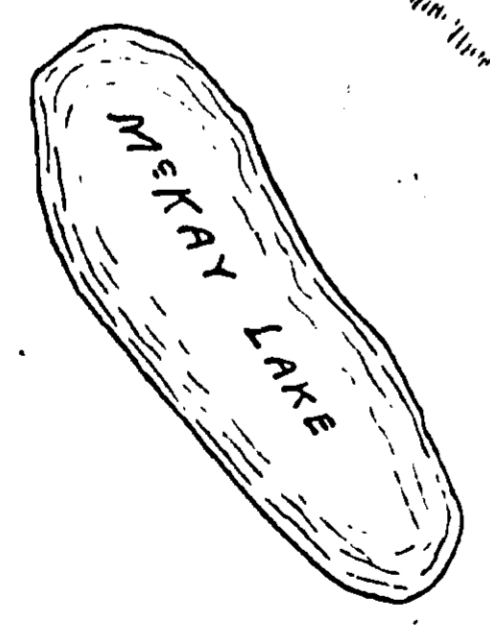

L 5

56

No 2 Mine Workings

B.N. 1
Surf. El. 2662.5
Depth 143.3'
Floor El. 2519.2

55

Surface Opening 1' El. 2513.2

54

Coal 28 @ B.N. 79
Surf. El. 2506.3
Depth 185.2'
Floor El. 2321.1

53

Coal 33 @ B.N. 17
Surf. El. 1401.2
Depth 196.11'
Floor El. 2205.1

Coal 25 @ B.N. 78
Surf. El. 2416.6
Depth 206.3'
Floor El. 2210.3

Coal 21A @ B.N. 2
Surf. El. 2513.0
Depth 225.2'
Floor El. 1987.8

Coal 1 @ B.N. 6
Surf. El. 2308.5
Depth 7.0'
Floor El. 2291.5

Area for Tonnage Calculation = 58 Acres
Estimated Tonnage = 410,000 Long Tons

R I

R II

PLAN

SHOWING AREA OF PROPOSED DEVELOPMENT OF WELLINGTON SEAM
IN CRANBERRY DISTRICT.

Scale: 1" = 400'

Seam Contours shown — 2200 —
Contour Interval 20'
Datum 2000' below M.S.L.

Map 8

Canadian Collieries (B) Ltd
Engineering Dept
Cumberland, B.C.
Nov 4th 1943

792

M12

NANRIMO DISTRICT SECTION 4.

MOUNTAIN DIST
SEC 1

SEC 20.

DISTRICT.

DOUGLAS
SEC 19
R VIII

CRANBERRY DISTRICT

5' Cont. 132-137
4' Cont. 137-141
3' S.S. 141-145
2' Cont. 145-148

792

(M13)

WESTERN FUEL CORPORATION OF CANADA LTD.

PLAN

HAREWOOD MINE

SCALE 1:50,000

CONTOUR INTERVAL 50 FT.
CROSS SECTION OF MINE
GENERAL MINING PLAN
MAY 1950

Jan 29/50
J. R. Byer
Supt. Mine

Approved 2nd February 1950

WESTERN FUEL CORPORATION OF CANADA LTD.
MINE ENGINEERING DEPARTMENT
1000-10th Avenue S.E.
CALGARY, ALBERTA

Map II

SEC. 2
CRANBERRY DISTRICT
MOUNTAIN VIEW

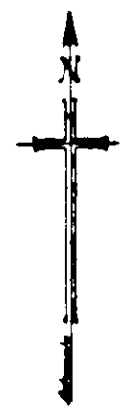

SEC. 1

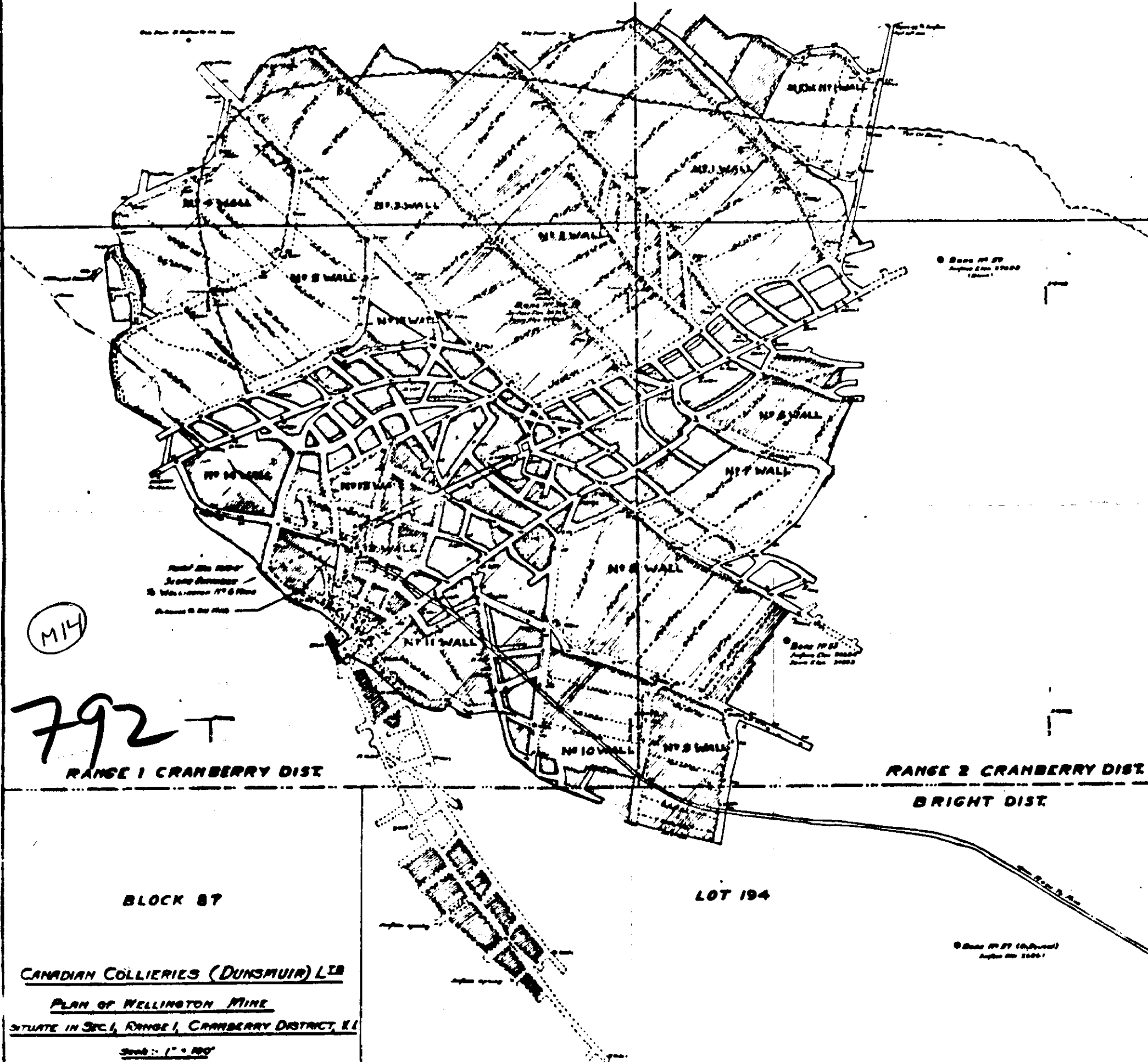

M14

792 T

RANGE 1 CRANBERRY DIST

RANGE 2 CRANBERRY DIST

BRIGHT DIST

BLOCK 87

LOT 194

CANADIAN COLLIERIES (DUNSMUIR) LTD

PLAN OF WELLINGTON MINE

SITUATE IN SEC. 1, RANGE 1, CRANBERRY DISTRICT, B.C.

Scale: 1" = 100'

Plan obtained under 11th 1914

datum 1000 feet below Mean Sea Level of Victoria, B.C.

Map 9

202136

Geological Survey of Canada
B.C. Mine Survey

WELLINGTON MINE
ADJUSTMENT PLAN
1944

202136

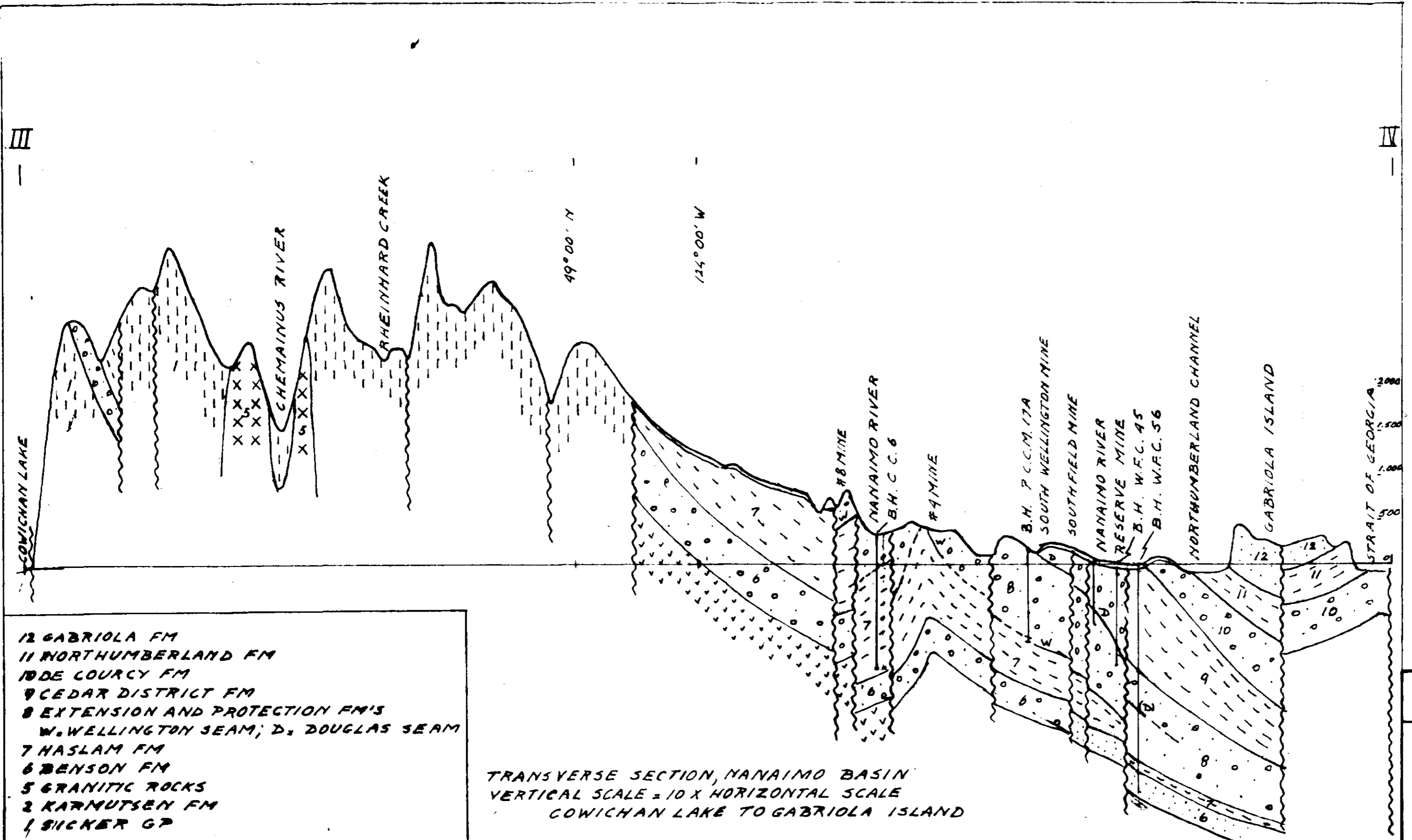

- 12 GABRIOLA FM
- 11 NORTHUMBERLAND FM
- 10 DE COURCY FM
- 9 CEDAR DISTRICT FM
- 8 EXTENSION AND PROTECTION FM'S
W. WELLINGTON SEAM; D. DOUGLAS SEAM
- 7 HASLAM FM
- 6 BENSON FM
- 5 GRANITIC ROCKS
- 2 KARNUTSEN FM
- 1 SICKER GP

TRANSVERSE SECTION, NANAIMO BASIN
 VERTICAL SCALE = 10 X HORIZONTAL SCALE
 COWICHAN LAKE TO GABRIOLA ISLAND

792

MAP 8

NETHERLANDS PACIFIC MINING CO. INC.
 VANCOUVER, B. C.

NANAIMO COAL FIELDS (M15)

STRUCTURE PROFILES

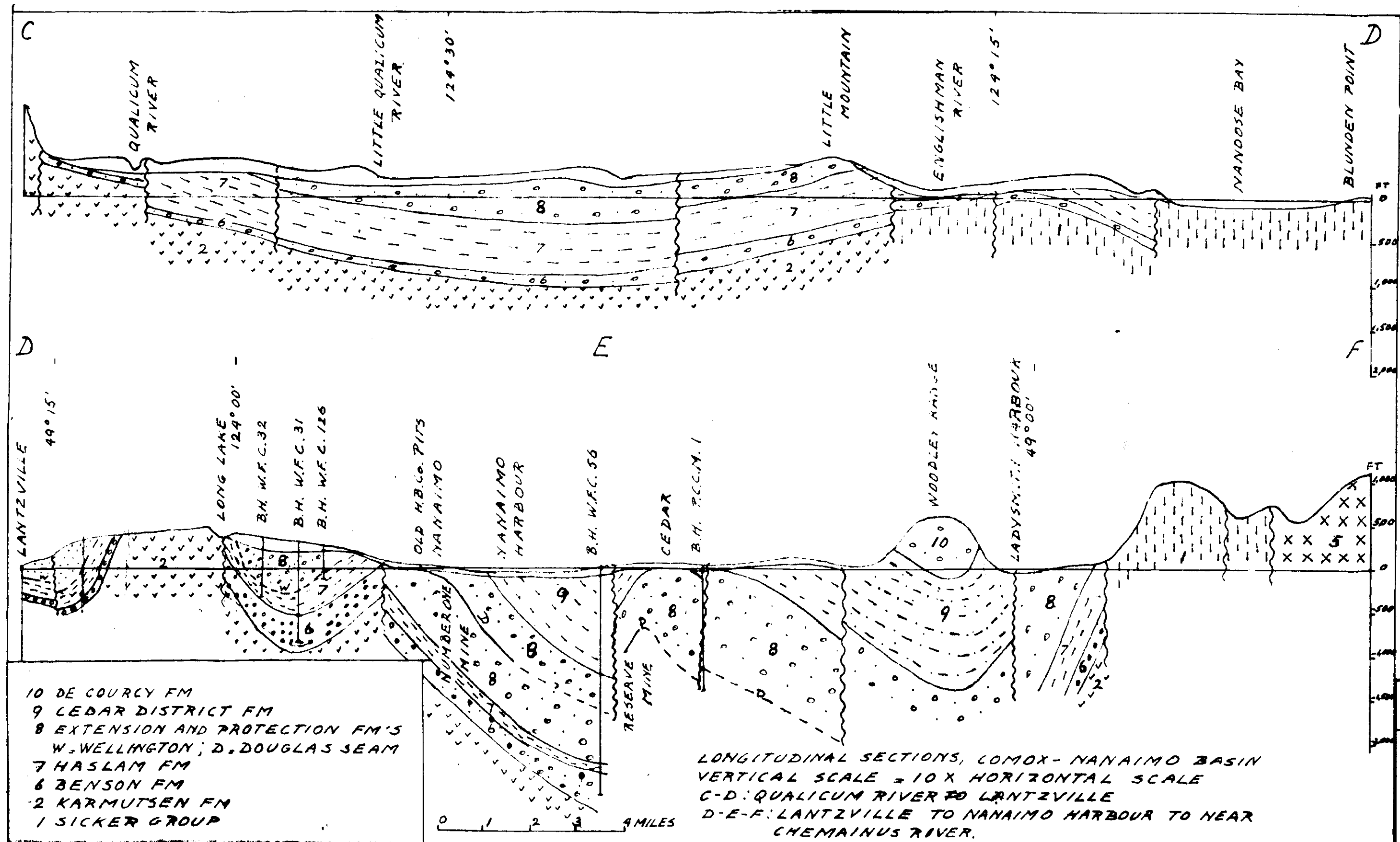

NETHERLANDS PACIFIC MINING CO. INC.
VANCOUVER, B. C.

NANAIMO COAL FIELDS M1b

STRUCTURE PROFILES

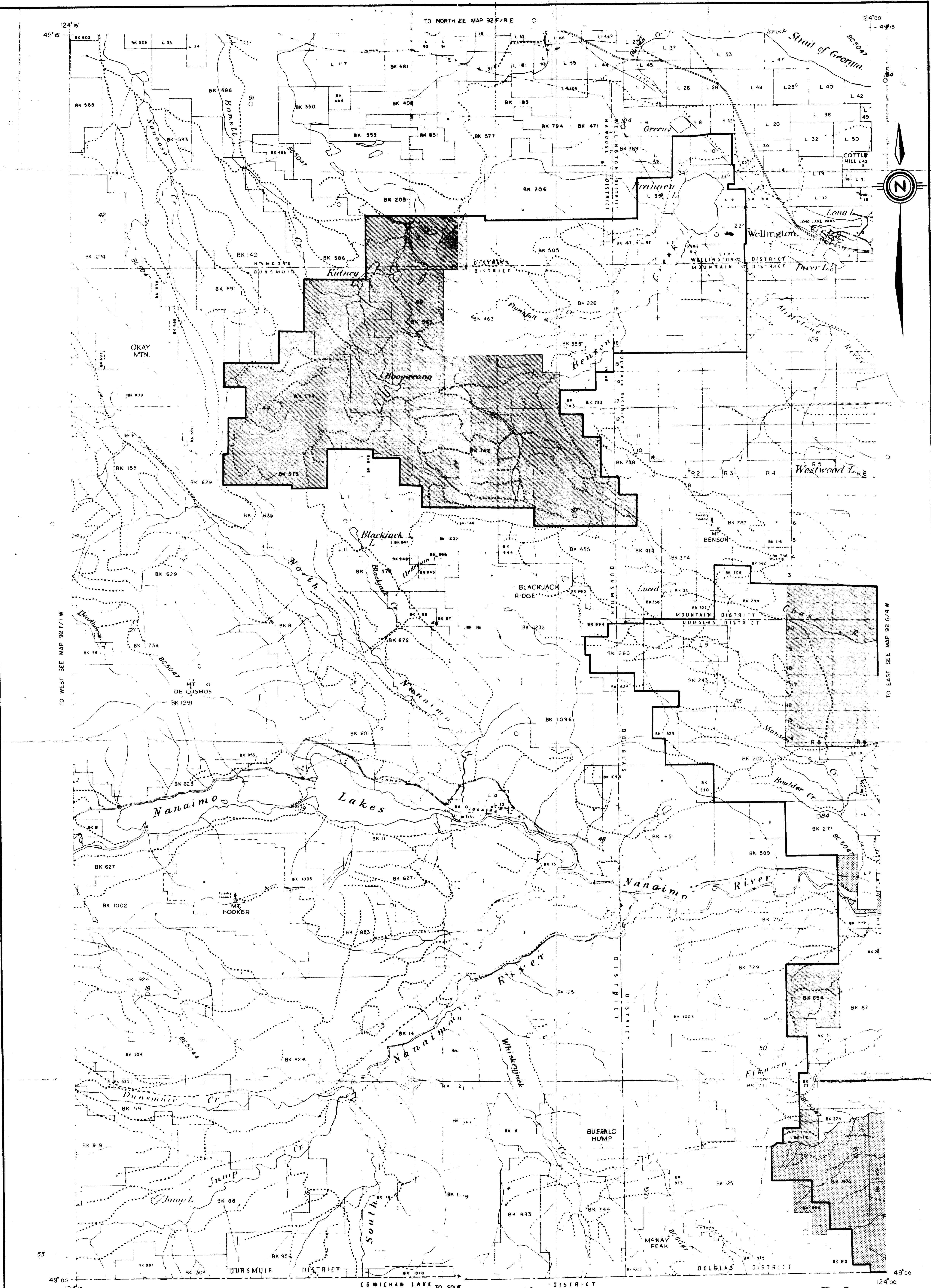

MAP 92 F/1 E

LEGEND

- | | | |
|---------------------------------------|--------------------------------------|--------|
| INTERNATIONAL BOUNDARY | BRIDGE | TUNNEL |
| PROVINCIAL BOUNDARY | BUILDING | |
| PARK BOUNDARY | FENCE | |
| HEIGHT OF LAND | CUTTING | |
| LOT BOUNDARY SURVEYED | EMBANKMENT | |
| 500' BOUNDARY UNSURVEYED OR UNCERTAIN | CLIFF OR STEEP BANK | |
| LOT NUMBER | EDGE OF DROP | |
| SURVEYED RIGHT-OF-WAY | LOW RIDGE | |
| RAILWAY | BOUNDARY OF SWAMP FLAT, GLACIER ETC. | |
| ABANDONED RAILWAY | IRRIGATION CANAL OR FLUME | |
| HIGHWAY, MAIN OR ALONG SECTION LINES | TRIANGULATION STATION | |
| OTHER ROADS | SURVEY MONUMENT | |
| TRAIL | AIR PHOTO CENTRES | |
| POWER TRANSMISSION LINE | FLIGHT NUMBERS | |
| PIPELINE | STREAM, PERMANENT | |
| CULTIVATED AREA | STREAM, INTERMITTENT OR DRY | |
| EDGE OF LOSING OR BURM | CITY OR MUNICIPAL BOUNDARY | |

Netherlands Pacific Mining Co. Inc.
MacMillan Bloedel Limited
Crown Zellerbach Canada Limited

792

MAP 9
NETHERLANDS PACIFIC MINING CO. INC.
VANCOUVER, B.C.

NANAIMO COAL FIELDS
WEST HALF

PROPERTY OUTLINE & SURFACE OWNERSHIP

SCALE 1 inch = 1/2 mile

124°00
49°15

123°45
49°15

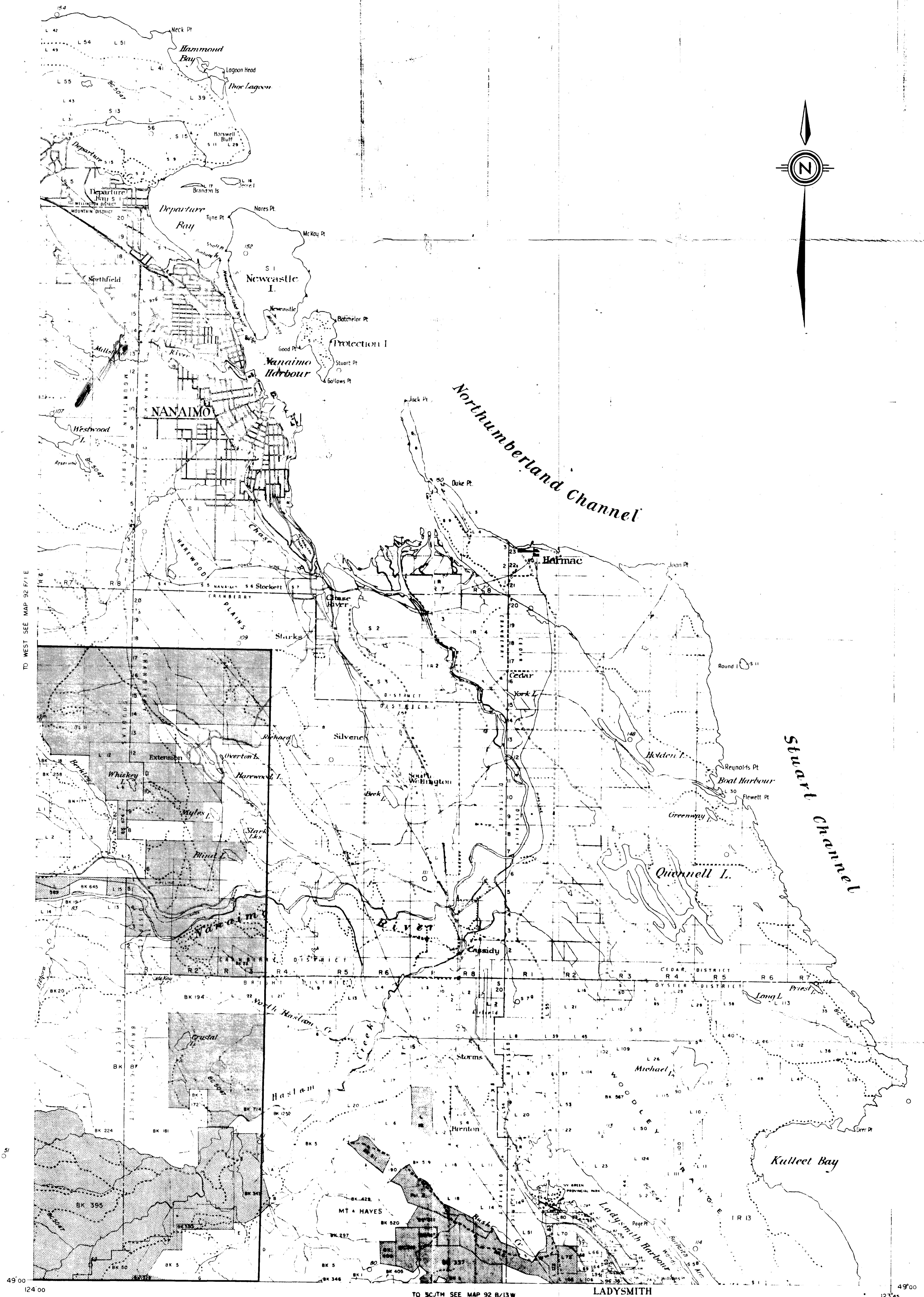
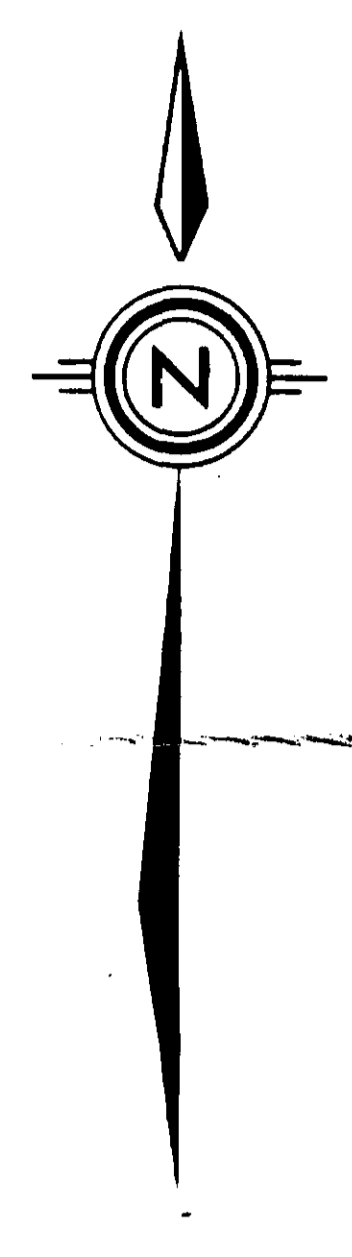

TO WEST SEE MAP 92 F/1 E

TO SOUTH SEE MAP 92 B/13 W

LADYSMITH

LEGEND

- INTERNATIONAL BOUNDARY
- PROVINCIAL BOUNDARY
- PARK BOUNDARY
- HEIGHT OF LAND
- LOT BOUNDARY SURVEYED
- LOT BOUNDARY UNSURVEYED OR UNCERTAIN
- LOT NUMBER
- SURVEYED RIGHT-OF-WAY
- RAILWAY
- ABANDONED RAILWAY
- HIGHWAY, MAIN OR ALONG SECTION LINES
- OTHER ROADS
- TRAIL
- POWER TRANSMISSION LINE
- PIPELINE
- CULTIVATED AREA
- EDGE OF LOGGING OR BURN
- as at date of photography
- BRIDGE
- TUNNEL
- BUILDING
- FENCE
- CUTTING
- EMBANKMENT
- CLIFF OR STEEP BANK
- EDGE OF DROP
- LOW RIDGE
- BOUNDARY OF SWAMP FLAT GLACIER ETC.
- IRRIGATION CANAL OR FLUME
- TRIANGULATION STATION
- SURVEY MONUMENT
- AIR PHOTO CENTRES
- FLIGHT NUMBERS
- STREAM, PERMANENT, INTERMITTENT OR DRY
- CITY OR MUNICIPAL BOUNDARY

Netherlands Pacific Mining Co. Inc.
 MacMillan Bloedel Limited
 Crown Zellerbach Canada Limited

792

MAP 10

NETHERLANDS PACIFIC MINING CO. INC
VANCOUVER, B.C.

NANAIMO COAL FIELDS (M18)
 EAST HALF
 PROPERTY OUTLINE & SURFACE OWNERSHIP

SCALE: 1 inch = 1/2 mile

MAP 92 G/4 W

'D

D'

EL.

BH 138

EL 677'

700' —

600' —

500' —

400' —

300' —

200' —

100' —

BH 136

EL. 500'

BH 135

EL 400'

Coal

Coal

Coal

154'

Coal

Coal

305'

585'

o/c
o/c

792

M19

SECTION THROUGH DRILL HOLES 135, 136 & 138

WOLF MOUNTAIN AREA

VANCOUVER ISLAND, BRITISH COLUMBIA

Horizontal Scale : 1" = 400'

Vertical Scale : 1" = 100'

MAP II

SECTION A - A'

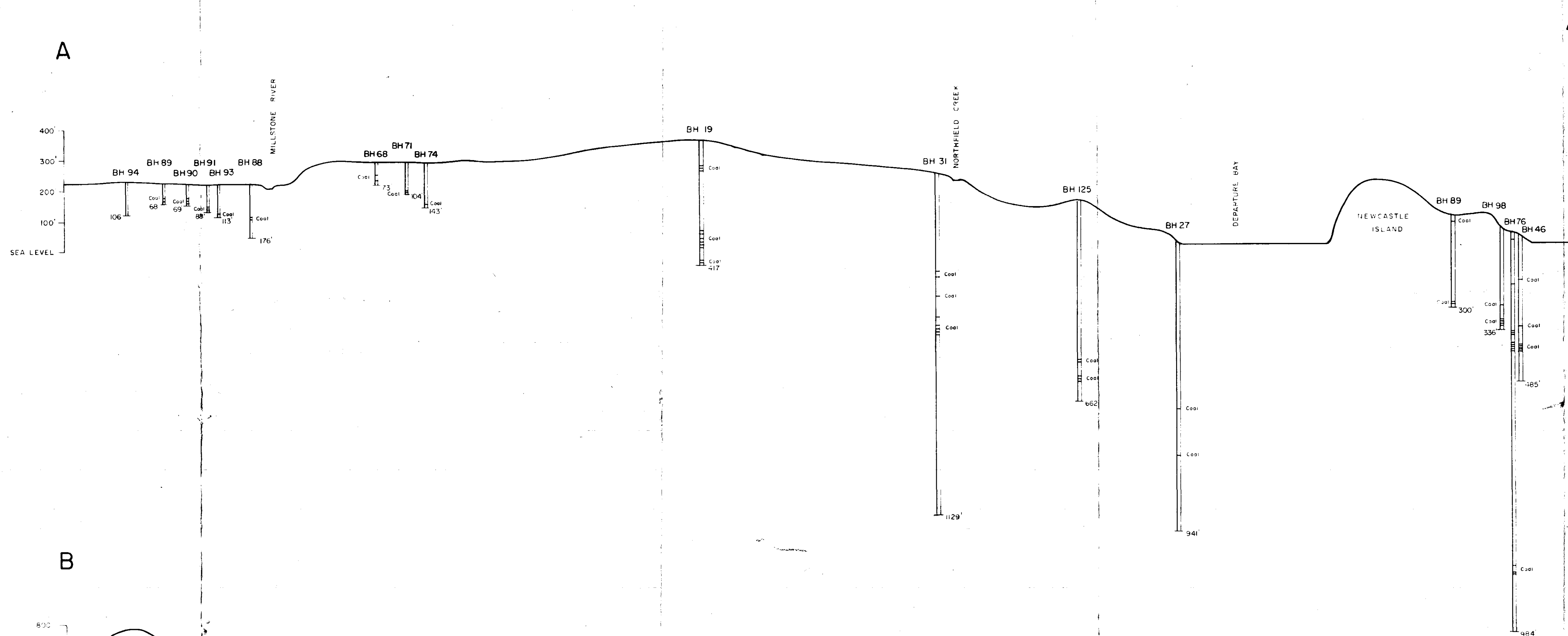

SECTION B - B'

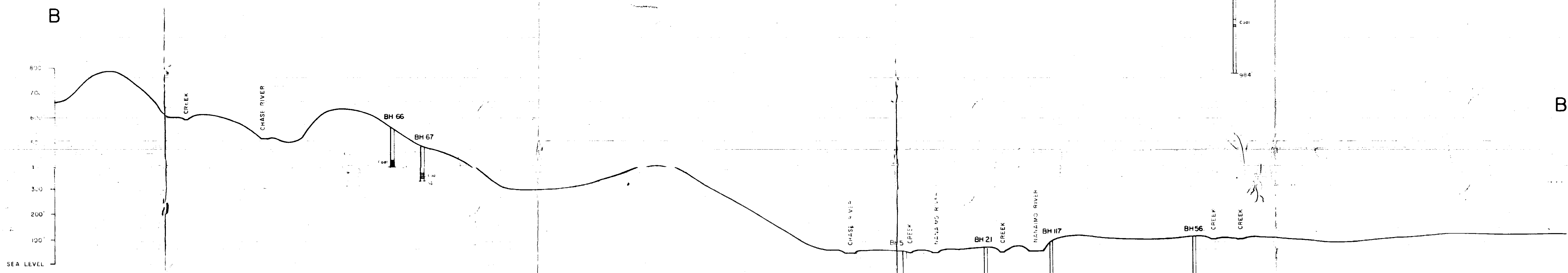

SECTION C - C'

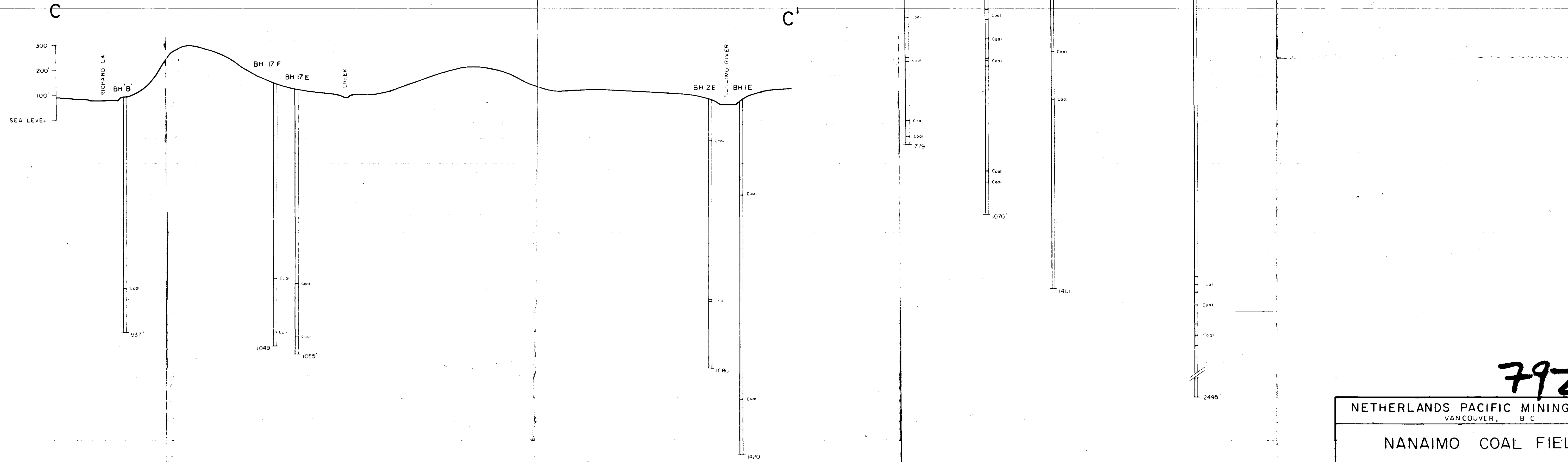

792

MAP 12

NETHERLANDS PACIFIC MINING CO. INC.
VANCOUVER, B.C.

NANAIMO COAL FIELDS

DRILL SECTIONS: A-A, B-B, C-C

HOR SCALE 1 inch = 1/4 mile
VER SCALE 1 inch = 200 feet