

**BRITISH COLUMBIA**  
**PROSPECTORS ASSISTANCE PROGRAM**  
**MINISTRY OF ENERGY AND MINES**  
**GEOLOGICAL SURVEY BRANCH**

PROGRAM YEAR: 1994/95

REPORT #: PAP 94-24

NAME: FLORENCE NIDDERY

**BRITISH COLUMBIA  
PROSPECTORS ASSISTANCE PROGRAM  
PROSPECTING REPORT FORM (continued)**

**B. TECHNICAL REPORT**

- \* One technical report to be completed for each project area
- \* Refer to Program Requirements/Regulations, section 15, 16 and 17
- \* If work was performed on claims a copy of the applicable assessment report may be submitted in lieu of the supporting data (see section 16) required with this TECHNICAL REPORT

Name FLORENCE NIDDERY Reference Number 94-95 P 76

**LOCATION/COMMODITIES**

Project Area (as listed in Part A.) NIDD MTN. Minfile No. if applicable \_\_\_\_\_

Location of Project Area NTS 82E/SW. Lat 49° 19' N Long 119° 13' W.

Description of Location and Access The Nidd consist of 4 2 Post claims located in the Nisqually M.D. approx. 25 km of logging road and 5 km. of trail east of C.K. Falls. East of Vaseaux Creek and north of Summit Creek.

Main Commodities Searched For Gold - silver.

Known Mineral Occurrences in Project Area Gold Property at Verner Meadows, North of Camp McKinsey and Belcham Property.

**WORK PERFORMED**

1. Conventional Prospecting (area) 13 days prospecting sampling claim staking
2. Geological Mapping (hectares/scale) \_\_\_\_\_
3. Geochemical (type and no. of samples) 16 - Rocks 16 - silt
4. Geophysical (type and line km) 2500 Metres line cutting (base grid) claim staking
5. Physical Work (type and amount) 17 days trail cutting - clearing
6. Drilling (no. holes, size, depth in m, total m) \_\_\_\_\_
7. Other (specify) \_\_\_\_\_

**SIGNIFICANT RESULTS (if any)**

Commodities Gold - Claim Name Nidd 1-3-4.

Location (show on map) Lat \_\_\_\_\_ Long \_\_\_\_\_ Elevation \_\_\_\_\_

Best assay/sample type Several good indications of both rock and silt samples. Refer to enclosed assay results.

Description of mineralization, host rocks, anomalies massive pyrochlore in quartz veins and phase deposits in granite rocks of the Shewan Complex, adjacent to Nelson Batholith and Knaresford rocks.

Supporting data must be submitted with this TECHNICAL REPORT.

**BRITISH COLUMBIA  
PROSPECTORS ASSISTANCE PROGRAM  
PROSPECTING REPORT FORM (continued)**

**B. TECHNICAL REPORT**

- \* One technical report to be completed for each project area
- \* Refer to Program Requirements/Regulations, section 15, 16 and 17
- \* If work was performed on claims a copy of the applicable assessment report may be submitted in lieu of the supporting data (see section 16) required with this TECHNICAL REPORT

Name FLORENCE NINDERY Reference Number 94-95 P 76

**LOCATION/COMMODITIES**

Project Area (as listed in Part A.) Allenckle - Lynx Minfile No. if applicable \_\_\_\_\_

Location of Project Area NTS 83E 16W Lat 49' 23' N Long 119' 21' W.

Description of Location and Access The Lynx consist of 6-2 Past claims located in the Coaymas M.D. 18 km east of Ok Falls B.C. Access is via a well maintained gravel logging road.

Main Commodities Searched For Copper Silver gold Platinum and Palladium.

Known Mineral Occurrences in Project Area Gold Property is south of Lynx Group.

**WORK PERFORMED**

1. Conventional Prospecting (area) 11 days prospecting & sampling.
2. Geological Mapping (hectares/scale) \_\_\_\_\_
3. Geochemical (type and no. of samples) 13 rock and core samples.
4. Geophysical (type and line km) 1000 metres wire cutting.
5. Physical Work (type and amount) 5 days road work - cutting and
6. Drilling (no. holes, size, depth in m, total m) thinning.
7. Other (specify) \_\_\_\_\_

**SIGNIFICANT RESULTS (if any)**

Commodities Gold Claim Name Lynx #2

Location (show on map) Lat \_\_\_\_\_ Long \_\_\_\_\_ Elevation Approx. 5,000'

Best assay/sample type Refer to assay # 138458 map enclosed.

Description of mineralization, host rocks, anomalies The claims cover Copper Silver gold Platinum and Palladium mineralization in coarse grained alkali porphyritic mafic/diabase. Tertiary serpentinite in Coaymas intrusions.

Supporting data must be submitted with this TECHNICAL REPORT.

**BRITISH COLUMBIA  
PROSPECTORS ASSISTANCE PROGRAM  
PROSPECTING REPORT FORM (continued)**

**B. TECHNICAL REPORT**

- One technical report to be completed for each project area
- Refer to Program Requirements/Regulations, section 15, 16 and 17
- If work was performed on claims a copy of the applicable assessment report may be submitted in lieu of the supporting data (see section 16) required with this TECHNICAL REPORT

Name FLORENCE NIDDERY Reference Number 94-95 P 76

**LOCATION/COMMODITIES**

Project Area (as listed in Part A.) ARROW LAKE <sup>KIM CLAIMS</sup> Minfile No. if applicable \_\_\_\_\_

Location of Project Area NTS 82 E / 9 E Lat 4' 11 N Long 118' 10 W.

Description of Location and Access The Kim consist of 2-2 Past mineral claims, located in the Trail Creek M.D. approx. 25 miles south of Edgewood BC. Access is via a gravel logging road.

Main Commodities Searched For Gold - Silver

Known Mineral Occurrences in Project Area Franklin Camp - Union Lightning Peak

**WORK PERFORMED**

1. Conventional Prospecting (area) 5 days prospecting - sampling
2. Geological Mapping (hectares/scale) \_\_\_\_\_
3. Geochemical (type and no. of samples) 2 rock samples
4. Geophysical (type and line km) \_\_\_\_\_
5. Physical Work (type and amount) Claim staking
6. Drilling (no. holes, size, depth in m, total m) \_\_\_\_\_
7. Other (specify) \_\_\_\_\_

**SIGNIFICANT RESULTS (if any)**

Commodities Ag - Au Claim Name Kim # 1

Location (show on map) Lat \_\_\_\_\_ Long \_\_\_\_\_ Elevation \_\_\_\_\_

Best assay/sample type 3.9 ppm Ag 200 ppb Au

Description of mineralization, host rocks, anomalies The predominant rock unit underlying the area is the Goryell intrusion consisting of syenite, monzonite, shonkinite and granite. The main focus was on a large epithemal banded quartz vein and other quartz veins.

Supporting data must be submitted with this TECHNICAL REPORT.

**BRITISH COLUMBIA  
PROSPECTORS ASSISTANCE PROGRAM  
PROSPECTING REPORT FORM (continued)**

**B. TECHNICAL REPORT**

- One technical report to be completed for each project area
- Refer to Program Requirements/Regulations, section 15, 16 and 17
- If work was performed on claims a copy of the applicable assessment report may be submitted in lieu of the supporting data (see section 16) required with this TECHNICAL REPORT

Name FLORENCE NIDDERY Reference Number 94-95 P 76

**LOCATION/COMMODITIES**

Project Area (as listed in Part A.) McKINNEY & Chase Minfile No. if applicable \_\_\_\_\_

Location of Project Area NTS 82E/SW 82E/NW Lat \_\_\_\_\_ Long \_\_\_\_\_

Description of Location and Access McKinney is located east of Chase B.C. via a paved and gravel road. The Chase project is located east of Chase B.C. approx. 7 or 8 miles.

Main Commodities Searched For Gold at Camp McKinney and Lead and opal at Chase B.C.

Known Mineral Occurrences in Project Area \_\_\_\_\_

**WORK PERFORMED**

1. Conventional Prospecting (area) 2 days prospecting at Chase 1 day at McKinney
2. Geological Mapping (hectares/scale) \_\_\_\_\_
3. Geochemical (type and no. of samples) \_\_\_\_\_
4. Geophysical (type and line km) \_\_\_\_\_
5. Physical Work (type and amount) \_\_\_\_\_
6. Drilling (no. holes, size, depth in m, total m) \_\_\_\_\_
7. Other (specify) \_\_\_\_\_

**SIGNIFICANT RESULTS (if any)**

Commodities \_\_\_\_\_ Claim Name \_\_\_\_\_

Location (show on map) Lat \_\_\_\_\_ Long \_\_\_\_\_ Elevation \_\_\_\_\_

Best assay/sample type Found several Thunder eggs and grades at Chase. Nothing very significant at McKinney yet.

Description of mineralization, host rocks, anomalies Found known quartz occurrences. Chase project is situated on Squibay Mtn. in basaltic lava and minor rhyolitic lava.

Supporting data must be submitted with this TECHNICAL REPORT.

FOX 4  
5501(6)  
5N x 4W

FOX 2  
3104(6)  
(5N x 4E)

54770 33805  
33806 33804

FOX 1  
6093  
(10)

FOX 3  
3105(6)  
(5B x 4W)

FOX 1  
3103(6)  
(5S x 4E)

ALLENDALE  
LAKE

— ROAD  
X Samples (349 av. ppb.)  
(138458)

LYNX 3 1422 (7)	LYNX 4 1423 (7)
LYNX 1 15423	LYNX 2 15424
LYNX 6 604323M	LYNX 5 604322M

DUKE 2 1 3461 (7)	DUKE 2 2 3462 (7)
DUKE 4 3464 (7)	DUKE 3 3463 (7)

MOON 4 1403(6)	MOON 5 1402(6)
-------------------	-------------------

POWER 1  
3013(9)  
4N x 4W

POWER 2  
3014(9)  
4N x 4E

12000A

120093

OK FALL

89(2)5

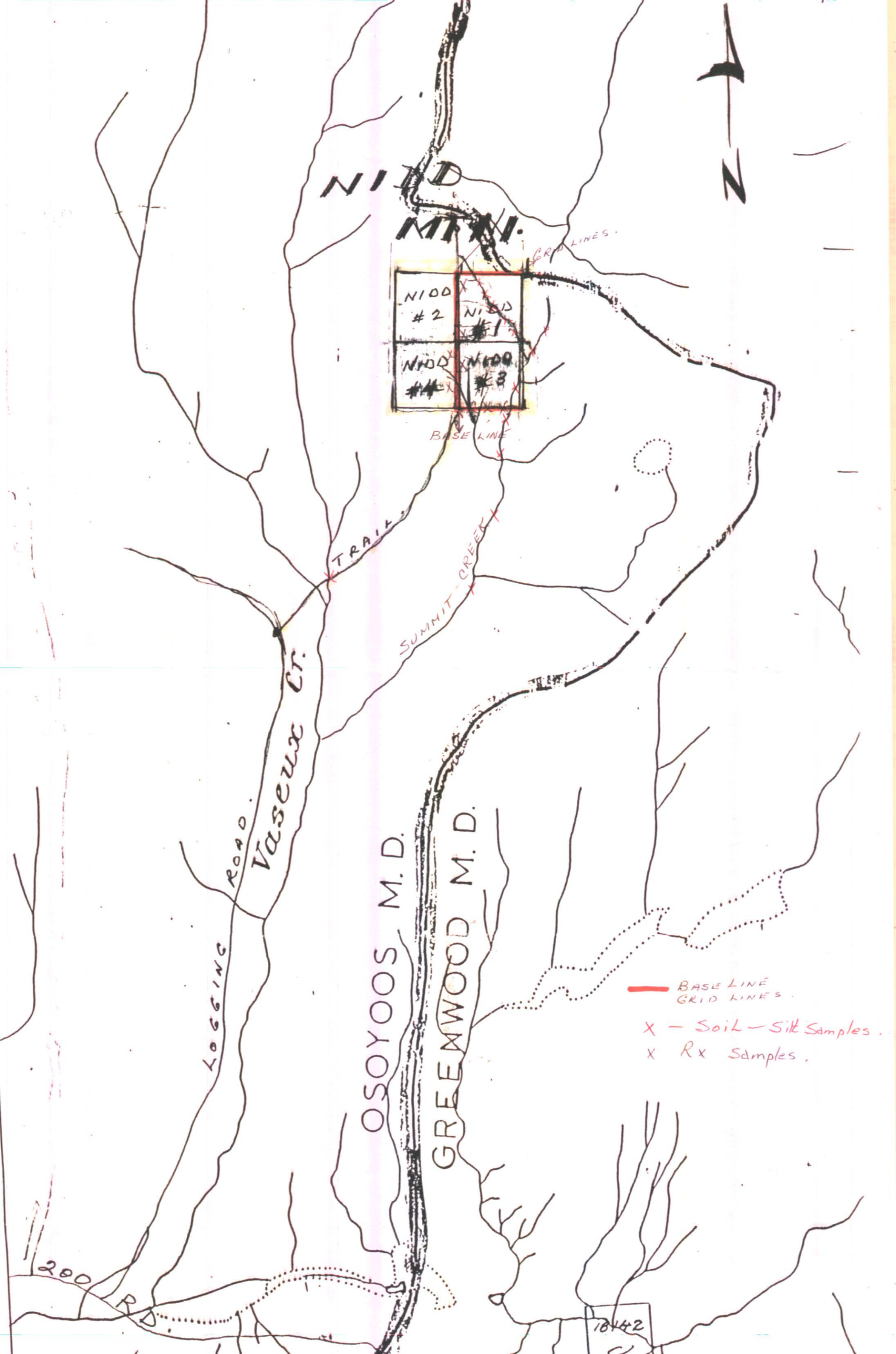

N100  
M.D.

N100 #2  
N100 #1  
N100 #4  
N100 #3

BASE LINE

TRAILS

SUMMIT CREEK

LOGGING ROAD  
Vaseux Cr.

OSOYOOS M.D.

GREENWOOD M.D.

— BASE LINE  
GRID LINES

X - Soil - Silt Samples

X Rx Samples

10142

Trail Creek 82E9E

LOCATOR'S SWITCH STAMP  
 (SUB) RECORDER'S INFORMATION  
 CLAIM NAMES: Kim #1 & #2  
 RECORD NUMBERS: 329388/389  
 MINING DIVISION: TRAIL CREEK  
 MAP NUMBER: 82E9E  
 MINERAL TITLES BEING  
 DRAFTING INFORMATION  
 DATE COMPLETED: Johnston  
 INITIALS:

Creek

Lake

645733M  
 KIM #1  
 KIM #2  
 645734M

Logging Rd

ARROW

+ PLACER  
CONDITIONS  
1961  
UR

JUL 27 '94 10:52 GOLD.COM NELSON\_354-6467

MAP 82E9E TENURES 329388/389



# CERTIFICATE OF ANALYSIS- ETK-500

31-Aug-94

**Florence Niddery**  
 Box 130  
 Okanagan Falls, B.C.  
 V0H 1R0

**ECO-TECH LABORATORIES LTD.**  
 10041 East Trans Canada Highway  
 KAMLOOPS, B.C.  
 V2C 2J3

Phone: 604-573-5700  
 Fax : 604-573-4557

4 Soil samples received July 28, 1994

*Values in ppm unless otherwise reported*

Et #.	Tag #	Au ppb	Ag	As	Ba	Br	Ca %	Ce	Co	Cr	Cs	Eu	Fe %	Hf	Hg	Ir ppb	La	Lu	Mo	Na	Nd	Ni	Rb	
Nidd - 1	138451	8	<5	3	760	22	4	70	8	35	3	1.8	2.73	7.9	<1	<5	46	0.53	5	19900	36	<50	49	
" "	2	138452	24	<5	4	900	55	4	67	9	43	<2	1.7	2.86	8.6	<1	<5	38	0.71	22	19900	29	<50	47
" "	3	138453	21	<5	3	850	55	4	73	10	36	3	1.6	3.15	9.1	<1	<5	32	0.56	9	20300	27	<50	54
" "	4	138457	17	<5	2	1200	14	3	140	9	49	2	3.1	3.51	9.4	<1	<5	91	0.67	<5	22900	67	110	79

31-Aug-94

Florence Niddery ETK600

ECO-TECH LABORATORIES LTD.

Et #.	Tag #	Sb	Sc	Se	Sr %	Sm	Sn %	Ta	Tb	Th	U	W	Yb	Zn
1	138451	0.4	9.7	<5	<.05	5.5	<.01	<1	<.5	9.9	9	<.4	3.24	415
2	138452	0.5	12	<5	0.09	5.3	<.01	2	1.0	9.2	34	<.4	3.78	348
3	138453	0.4	12	<5	<.05	5	<.01	<1	0.8	8.8	15	<.4	3.34	363
4	138457	0.3	13	<5	0.12	10	<.01	<1	1.3	20	14	5	3.97	137

  
ECO-TECH LABORATORIES LTD.  
Frank J. Pezzotti, A.Sc.T.  
B.C. Certified Assayer

# CERTIFICATE OF ANALYSIS- ETK-499

31-Aug-94

Florence Nidderly  
 Box 130  
 Okanagan Falls, B.C.  
 VOH 1R0

ECO-TECH LABORATORIES LTD  
 10041 East Trans Canada Highway  
 KAMLOOPS, B.C.  
 V2C 2J3

Phone: 604-573-5700  
 Fax : 804-573-4557

3 Rock samples received July 28, 1994

*Values in ppm unless otherwise reported*

Et #.	Tag #	Au ppb	Ag	As	Ba	Br	Ca %	Ce	Co	Cr	Cs	Eu	Fe %	Hf	Hg	Ir ppb	La	Lu	Mo	Na	Nd	Ni	Rb
Nidd-1	138454	112.0	<5	3.00	310	2	10	29	14	460	<2	0.9	3.97	2.6	<1	<5	15	0.37	7	7850	9	150	<30
LWNX-2	138455	61	<5	3.00	1100	<1	3	150	160	160	<2	2.4	9.67	17	<1	<5	110	0.21	15	32800	36	200	47
LWNX-3	138456	51	<5	<2	3800	<1	<1	360	76	270	<2	7.4	4.35	15	<1	<5	230	0.19	12	25200	150	<50	<30

31-Aug-94

Florence Nidderly ETK499

ECO-TECH LABORATORIES LTD

Et #.	Tag #	Sb	Sc	Se	Sr %	Sm	Sn %	Ta	Tb	Th	U	W	Yb	Zn
1	138454	1.5	11	<5	0.05	2.4	<.01	<1	0.5	4.3	3.4	<4	2.32	174
2	138455	<.2	2.8	9	0.26	4.1	<.01	5	<.5	17	13	<4	1.09	112
3	138456	<.2	5.8	<5	0.66	17	<.01	6	<.5	67	7.1	<4	1.06	230

  
ECO-TECH LABORATORIES LTD.  
Frank J. Pezzotti, A.Sc.T.  
B.C. Certified Assayer

# CERTIFICATE OF ANALYSIS- ETK-531

12-Sep-94

Florence Niddery  
 Box 130  
 Okanagan Falls, B.C.  
 V0H 1R0

**ECO-TECH LABORATORIES LTD.**  
 10041 East Trans Canada Highway  
 KAMLOOPS, B.C.  
 V2C 2J3

Phone: 604-573-5700  
 Fax : 604-573-4557

6 Rock samples received August 4, 1994

*Values in ppm unless otherwise reported*

Et #.	Tag #	Au ppb	Ag	As	Ba	Br	Ca %	Ce	Co	Cr	Cs	Eu	Fe %	Hf	Hg	Ir ppb	La	Lu	Mo	Na	Nd	Ni	Rb
Lynx1	138458	349	<5	<2	1400	<1	<1	230	8	87	9	2.7	1.46	29	<5	<5	170	0.27	<5	36600	54	<58	110
Nidd2	138459	392	<5	<2	820	1	2	27	6	270	<2	1	1.96	3.6	<5	<5	14	0.35	11	20600	15	<50	<30
Lynx3	138460	<5	<5	4	1400	<1	<1	470	10	65	<2	3.3	2.09	<5	<5	<5	280	0.22	10	32500	150	<64	140
Lynx4	138461	65	<5	<2	1200	<1	<2	730	10	34	<2	5.6	2.33	5.1	<5	<5	410	0.6	<5	23900	250	<86	130
Lynx5	138463	18	<5	<2	1100	<1	<2	1100	<5	46	<2	7	1.59	6.8	<5	<5	640	0.87	<5	34000	310	<110	150
Kim 6	138464	200	6	<2	100	<1	<1	9	<5	210	<2	<2	0.25	<5	<5	<5	5	<0.05	15	<500	<5	<50	<30

12-Sep-94

Florence Niddery ETK531

ECO-TECH LABORATORIES LTD.

Et #.	Tag #	Sb	Sc	Se	Sr %	Sm	Sn %	Ta	Tb	Th	U	W	Yb	Zn
1	138458	<.2	1.1	<5	0.45	4.6	<.03	<1	<.5	48	9.5	<4	1.30	487
2	138459	0.4	6.5	<5	<.05	2.3	<.03	<1	<.5	3.9	<.5	<4	2.02	125
3	138460	<.2	1.5	<5	<.05	14	<.03	<1	<.5	120	<.7	<4	1.86	<50
4	138461	<.2	9.6	<5	<.05	27	<.03	<1	3.1	33	8.9	<4	1.57	<50
5	138463	<.2	2.5	<5	<.05	34	<.03	<2	<.5	170	14	<4	4.56	<50
6	138464	1.3	0.3	<5	<.05	0.3	<.03	<1	<.5	1.3	<.5	<4	<.05	<50

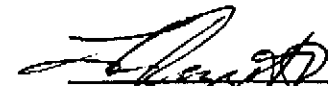

ECO-TECH LABORATORIES LTD.  
Frank J. Pezzotti, A.Sc.T.  
B.C. Certified Assayer

14-Sep-94

ECO-TECH LABORATORIES LTD.

10041 East Trans Canada Highway  
KAMLOOPS, B.C.  
V2C 2J3

Phone: 604-573-5700  
Fax : 604-573-4557

FLORENCE NIDDERY ETK 676  
Box 130  
Okanagan Falls, B.C.  
V0H 1R0

10 Rock samples received August 31, 1994

Values in ppm unless otherwise reported

Et #.	Tag #	Ag	Al %	As	Ba	Bi	Ca %	Cd	Co	Cr	Cu	Fe %	La	Mg %	Mn	Mo	Na %	Ni	P	Pb	Sb	Sn	Sr	Ti %	U	V	W	Y	Zn
Nidd 1	138472	<2	1.19	10	30	<5	2.17	<1	11	327	64	2.39	20	0.42	702	36	0.05	35	540	32	<5	140	54	0.12	<10	30	<10	6	84
" " 2	138473	<2	0.67	<5	30	<5	0.13	<1	7	229	40	1.43	<10	0.44	257	11	0.01	19	70	28	<5	100	<1	0.03	<10	19	<10	<1	37
LYNX-3	138474	<2	1.67	<5	225	<5	2.40	<1	34	107	155	5.43	130	1.98	546	42	0.08	49	4480	26	15	<20	268	0.28	<10	121	<10	11	105
" " 4	138475	<2	2.20	<5	125	<5	1.93	<1	39	75	304	5.85	130	2.10	762	<1	0.08	39	3840	30	20	<20	702	0.31	<10	135	<10	11	142
" " 5	138476	<2	2.63	10	165	<5	1.99	<1	40	88	635	6.46	190	2.83	697	<1	0.09	44	4700	32	25	<20	317	0.31	<10	176	<10	18	141
" " 6	138477	<2	0.85	<5	115	<5	0.97	<1	10	75	105	2.55	110	0.81	335	2	0.06	12	2400	28	5	<20	123	0.08	<10	61	<10	7	64
" " 7	138478	<2	1.89	<5	180	<5	3.67	<1	24	60	176	4.44	150	1.93	816	<1	0.04	29	4060	30	20	<20	1349	0.22	<10	97	<10	14	123
Nidd 8	138479	<2	0.68	<5	285	5	0.49	<1	15	219	54	2.47	<10	0.60	412	5	0.05	33	200	10	5	80	18	0.12	<10	57	<10	<1	31
" " 9	138481	<2	0.25	5	45	<5	0.34	<1	4	85	21	1.75	<10	0.04	107	14	0.03	5	760	16	<5	40	29	0.10	<10	42	<10	3	23
" " 10	Mck	<2	0.52	5	20	<5	0.22	<1	5	409	18	1.49	<10	0.32	441	21	0.01	18	310	4	<5	200	<1	<0.01	<10	18	<10	<1	21

QC DATA

Repeat:

1	138472	<2	1.10	10	25	<5	1.95	<1	10	298	57	2.18	20	0.39	650	33	0.05	33	520	36	<5	130	45	0.10	<10	26	<10	4	74
---	--------	----	------	----	----	----	------	----	----	-----	----	------	----	------	-----	----	------	----	-----	----	----	-----	----	------	-----	----	-----	---	----

Standard : 1991

		1.0	1.80	70	155	<5	1.74	<1	20	65	85	4.12	<10	0.93	669	<1	0.02	26	670	26	10	<20	56	0.12	<10	80	<10	6	78
--	--	-----	------	----	-----	----	------	----	----	----	----	------	-----	------	-----	----	------	----	-----	----	----	-----	----	------	-----	----	-----	---	----

XLS/Kmisc#6  
df/671

  
ECO-TECH LABORATORIES LTD.  
Frank J. Pezzotti, A.Sc.T  
B.C. Certified Assayer

12-Sep-94

ECO-TECH LABORATORIES LTD.  
 Vangeochem Labs  
 10041 East Trans Canada Highway  
 KAMLOOPS, B.C.  
 V2C 2J3

FLORENCE NIDDERY ETK 677  
 Box 130  
 Okanagan Falls, B.C.  
 V0H 1R0

Phone: 604-573-5700  
 Fax : 604-573-4557

11 SOIL samples received August 31, 1994

Values in ppm unless otherwise reported

Et #.	Tag #	Au ppb	Ag	Al %	As	Ba	Bi	Ca %	Cd	Co	Cr	Cu	Fe %	La	Mg %	Mn	Mo	Na %	Ni	P	Pb	Sb	Sn	Sr	Ti %	U	V	W	Y	Zn
1	138417	<5	1.0	1.90	<5	120	<5	1.36	<1	12	28	158	2.33	10	0.43	640	<1	0.02	28	580	64	<5	<20	41	0.09	<10	42	<10	12	278
Nidderly 2	138465	<5	0.2	2.31	<5	165	<5	1.18	<1	12	19	43	2.26	<10	0.31	718	<1	0.03	14	520	42	<5	<20	39	0.13	<10	39	<10	10	259
Nidderly 3	138466	<5	0.6	1.65	<5	125	<5	1.02	<1	15	22	139	2.52	<10	0.46	640	<1	0.02	21	550	22	<5	<20	31	0.10	<10	50	<10	12	192
" 4	138467	<5	0.8	1.80	<5	135	<5	1.34	<1	11	22	133	2.15	<10	0.37	365	2	0.02	25	630	22	5	<20	37	0.09	<10	44	<10	11	230
" 5	138468	<5	1.2	1.97	<5	155	<5	1.70	<1	10	19	161	1.92	10	0.28	443	5	0.02	33	860	18	5	<20	47	0.07	<10	34	<10	13	222
" 6	138469	<5	0.4	2.18	<5	165	<5	1.25	<1	14	31	101	2.76	<10	0.51	823	<1	0.02	40	640	22	5	<20	46	0.13	<10	47	<10	12	284
" 7	138470	<5	<.2	1.34	<5	95	<5	0.82	<1	13	27	51	3.07	<10	0.48	567	<1	0.01	28	580	18	5	<20	29	0.09	<10	53	<10	8	186
" 8	138482	<5	0.2	2.76	10	70	5	0.93	<1	5	6	16	1.07	<10	0.16	74	<1	0.04	9	550	22	<5	<20	44	0.11	<10	18	<10	10	118
" 9	138483	<5	0.8	2.68	5	250	<5	1.64	<1	9	20	26	2.47	60	0.34	2381	8	0.02	9	1440	24	5	<20	113	0.06	<10	55	<10	23	141
" 10	138484	<5	<.2	1.37	<5	110	5	0.45	<1	10	13	13	2.53	20	0.38	310	<1	0.01	7	580	14	<5	<20	69	0.11	<10	59	<10	9	80
" 11	138485	<5	<.2	0.60	<5	55	5	0.42	<1	6	7	4	1.63	20	0.27	349	<1	<.01	3	710	10	<5	<20	68	0.07	<10	31	<10	7	33

QC DATA

Repeat:

1	138417		0.8	1.90	<5	125	<5	1.32	<1	12	26	154	2.38	10	0.43	636	<1	0.02	29	600	60	<5	<20	43	0.09	<10	43	<10	12	278
---	--------	--	-----	------	----	-----	----	------	----	----	----	-----	------	----	------	-----	----	------	----	-----	----	----	-----	----	------	-----	----	-----	----	-----

Standard : 1991

			1.0	2.00	70	180	<5	1.89	1	21	69	82	4.27	<10	0.99	696	<1	0.01	29	690	24	<5	<20	64	0.10	<10	88	<10	8	82
--	--	--	-----	------	----	-----	----	------	---	----	----	----	------	-----	------	-----	----	------	----	-----	----	----	-----	----	------	-----	----	-----	---	----

XLS/Kmisc#6  
 df/675

  
 ECO-TECH LABORATORIES LTD.  
 Frank J. Pezzotti, A.Sc.T  
 B.C. Certified Assayer





ASSAYING  
GEOCHEMISTRY  
ANALYTICAL CHEMISTRY  
ENVIRONMENTAL TESTING

10041 E. Trans Canada Hwy., R.R. #2, Kamloops, B.C. V2C 2J3 Phone (604) 573-5700  
Fax (604) 573-4557

**CERTIFICATE OF ANALYSIS ETK 676**

Florence Nidderly  
Box 130  
Okanagan Falls, B.C.  
V0H 1R0

9-Sep-94

10 Rock samples received August 31, 1994

ET #.	Tag #	Au ppb	Pd ppb	Pt ppb
1	138472	<5	-	-
2	138473	<5	-	-
3	138474	<5	<5	<5
4	138475	<5	<5	<5
5	138476	55	<5	<5
6	138477	20	<5	<5
7	138478	5	<5	<5
8	138479	5	-	-
9	138481	5	-	-
10	Mck	20	-	-

  
 ECO-TECH LABORATORIES LTD.  
 Frank J. Pezzotti, A.Sc.T.  
 B.C. Certified Assayer

XLS/Kmisc#6



GEOCHEMICAL ANALYSIS CERTIFICATE



B.C. Ministry of Energy (Lab) File # 94-3099

Analytical Sciences Lab, Victoria BC V8V 1X4 Submitted by: Ray Lett

SAMPLE#	Mo	Cu	Pb	Zn	Ag	Ni	Co	Mn	Fe	As	U	Au	Th	Sr	Cd	Sb	Bi	V	Ca	P	La	Cr	Mg	Ba	Ti	B	Al	Na	K	W	AL**
	ppm	ppm	ppm	ppm	ppm	ppm	ppm	ppm	%	ppm	ppm	ppm	ppm	ppm	ppm	ppm	ppm	ppm	%	%	ppm	ppm	%	ppm	%	%	%	%	ppm	ppm	
48815 Church	7	31	17	6	3.9	2	82	36	.28	3	5	<2	4	6	<2	<2	<2	3	.03	.008	7	4	.01	7	<.01	<2	.08	<.01	.05	405	3
49191	165	423	2472	3640	35.6	188	11	687	4.18	211	30	<2	4	116	12.6	249	<2	16	2.17	.048	<2	58	1.39	26	<.01	<2	.22	.01	.06	9	208
49192	4	51	50	104	.7	203	145	4308	11.47	115	<5	<2	<2	130	<2	4	<2	41	1.49	.061	3	60	1.16	18	<.01	<2	.68	.01	.15	32	16
49193	<1	1	10	38	<.1	3	82	392	1.13	<2	7	<2	24	18	<2	<2	<2	18	.26	.018	16	5	.25	69	.08	<2	.67	.07	.22	950	4
49194	<1	14	23	43	.1	51	62	932	1.74	3	<5	<2	<2	489	<2	<2	<2	13	4.27	.013	3	32	1.01	28	<.01	<2	.90	.01	.04	680	2
49195	15	120	18	411	2.3	104	23	1100	5.38	26	<5	<2	<2	36	7.6	<2	<2	76	.61	.030	<2	29	.34	46	.07	<2	.81	.09	.30	205	17
49198	6	38	12	105	.6	24	94	212	3.06	28	<5	<2	<2	33	.6	3	<2	27	.42	.049	2	11	.98	61	.10	<2	1.37	.10	.38	171	7
49197	<1	11	7	31	.3	4	48	861	6.77	5	<5	<2	<2	35	1.2	<2	<2	90	2.15	.005	5	1	.61	33	.01	<2	.73	<.01	<.01	679	1
49198	<1	2	2	83	.3	4	4	1893	.15	1	<5	<2	<2	775	1.8	<2	<2	<2	38.23	.002	<2	1	.07	12	<.01	<2	.02	<.01	<.01	41	7
RE 49198	<1	2	<2	79	.2	4	4	1858	.15	4	<5	<2	<2	760	1.7	<2	<2	<2	37.37	.002	<2	1	.08	12	<.01	<2	.02	<.01	<.01	39	6
49199	11	43	5	372	.9	21	37	226	3.93	46	<5	<2	<2	85	4.5	4	<2	50	1.34	.032	2	17	.73	37	.07	<2	2.24	.28	.29	241	6
49200	9	43	9	112	.7	24	86	246	3.46	26	<5	<2	<2	53	.8	2	<2	30	.88	.044	2	14	.98	57	.10	<2	1.76	.17	.42	149	11
49201	5	42	10	109	.7	23	83	210	3.38	27	<5	<2	<2	53	.7	3	<2	30	.67	.043	2	12	.96	55	.10	<2	1.74	.16	.39	147	10
49202	2	38	4	84	.2	16	128	140	3.18	90	<5	<2	4	21	.6	<2	<2	8	.39	.021	3	3	.40	64	.05	<2	.74	.04	.18	620	9
49203	3	46	5	27	.2	18	123	118	3.67	392	<9	<2	2	42	<.2	3	<2	18	.57	.030	2	7	.63	51	.06	<2	1.29	.09	.17	1059	7
49204	2	19	<2	69	.1	8	100	179	1.78	384	<5	<2	5	28	.4	2	<2	4	.58	.016	4	3	.28	57	.04	2	.67	.05	.14	980	7
STANDARD C/AU-R	20	68	42	125	7.3	74	37	1103	4.16	42	19	7	36	52	19.2	14	19	62	.50	.097	40	62	.91	185	.09	34	1.97	.06	.15	13	473

ICP - .500 GRAM SAMPLE IS DIGESTED WITH 3ML 3-1-2 HCL-HNO3-H2O AT 95 DEG. C FOR ONE HOUR AND IS DILUTED TO 10 ML WITH WATER. THIS LEACH IS PARTIAL FOR MW FE SR CA P LA CR MG BA TI B W AND LIMITED FOR NA K AND AL. ASSAY RECOMMENDED FOR ROCK AND CORE SAMPLES IF CU PB ZN AS > 1%, AG > 30 PPM & AU > 1000 PPB. SAMPLE TYPE: ROCK PULP AU\*\* ANALYSIS BY FA/ICP FROM 10 GM SAMPLE. Samples beginning 'RE' are duplicate samples.

DATE RECEIVED: SEP 12 1994 DATE REPORT MAILED: *Sept 14/94* SIGNED BY: *C. Toy* D. TOYE, C. LEONG, J. WANG; CERTIFIED B.C. ASSAYERS

SEP 14 1994 15:50 PP HOME LHS 604 253 1716 TO 16049520081 P.02 02