

BRITISH COLUMBIA
PROSPECTORS ASSISTANCE PROGRAM
MINISTRY OF ENERGY AND MINES
GEOLOGICAL SURVEY BRANCH

PROGRAM YEAR: 1995/1996

REPORT #: PAP 95-4

NAME: PETER GOODMAN

BRITISH COLUMBIA
PROSPECTORS ASSISTANCE PROGRAM
PROSPECTING REPORT FORM (continued)

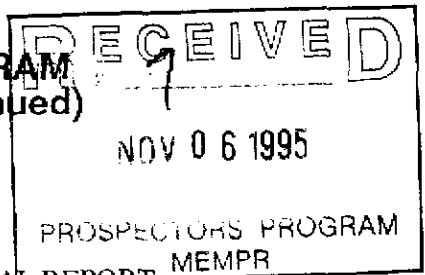

B. TECHNICAL REPORT

- * One technical report to be completed for each project area
- * Refer to Program Requirements/Regulations, section 15, 16 and 17
- * If work was performed on claims a copy of the applicable assessment report may be submitted in lieu of the supporting data (see section 16) required with this TECHNICAL REPORT

Name Peter Goodman Reference Number 95/96 P007

LOCATION/COMMODITIES

Project Area (as listed in Part A.) _____ Minfile No. if applicable _____

Location of Project Area NTS 92H7/6 Lat 49°27 Long 121° 00

Description of Location and Access Claims on Jim Kelly Creek and Toulameen River
access via logging road 29 kms from Coquihalla toll booth

Main Commodities Searched For Au Pt

Known Mineral Occurrences in Project Area Area has a history of mineralization and
has been worked in the past.

WORK PERFORMED

1. Conventional Prospecting (area) 8 claims and surrounding areas
2. Geological Mapping (hectares/scale) _____
3. Geochemical (type and no. of samples) _____
4. Geophysical (type and line km) _____
5. Physical Work (type and amount) Test pits as well as hand work on creek and river
6. Drilling (no. holes, size, depth in m, total m) _____
7. Other (specify) _____

SIGNIFICANT RESULTS (if any)

Commodities Au PT Claim Name Zowie

Location (show on map) Lat _____ Long _____ Elevation _____

Best assay/sample type 20.82 g/t Ag 3.07 g/t PT. Black sands

Description of mineralization, host rocks, anomalies All AU and PT recovered was from
gravel deposits. Black sands were present in all samples. All creek
samples contained varying amounts of coarse magnetite. Vein material
consisted of iron/copper pyrite and quartz. Garnets were common.

Supporting data must be submitted with this TECHNICAL REPORT.

WORK PROGRAM/RESULTS

P. Goodman

Program Commenced: May 19, 1995
Program Terminated: Oct. 06, 1995

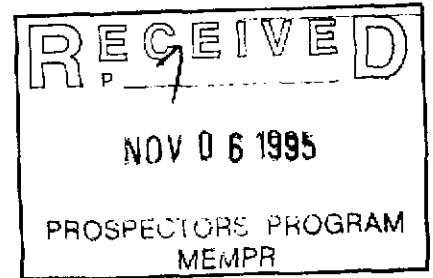

Objectives: To verify findings of previous owner and follow up on results of mag. survey. To locate AU and PT in sufficient amounts and grades to sustain an ongoing operation.

Program: The program consisted of two main thrusts:

1) To dig a number of test pits. To verify previous assays and check results of A. Mag. Survey. Test pits were dug at various locations using a M/F 300 with backhoe attachment. Random samples (10 buckets of material) were then run over a sluice and panned. Promising looking cons were then sent to Ecotech in Kamloops for assay. In all pits clay was encountered at depths of 4'-8'. In the case of Pit #5 a wall of extremely hard clay was encountered and we could not get through it or get below it. It was not possible in any instance to dig through the clay.

2) To check gravels on Jim Kelly Creek and the Toulameen River by means of panning and hand shovelling materials along stream and river as well as any tributaries and draws. Jim Kelly Creek was extensively tested. Hand digging and panning as well as a highbanker were used to test creek gravels as well as Toulameen River gravels.

Well over 800 man hours were expended on the above program.

Equipment:

Massey Ferguson 300 loader
c/w backhoe attachment

wash plant and sluice
2" pump
3" pump

sluice
wheel (for recovery)
highbanker
4x4 Pickup
chainsaw
generator

Accommodation
1992 36.5 ft. Prowler
Regal 5th wheel trailer

Equipment Rental:

192 hours @ \$75.00 = \$14 400.00
No charge made for any equipment except loader/backhoe

Results:

Pit 1	Dug pit/holding pond. Ran 25 b/h buckets each day for six days through wash plant. This was one of Gordon's hot spots. Results very disappointing: less than .7 gms AU.
Pit 2	Ran 10 buckets material (.8 cuft) over sluice panner cons and sent for assay. Results: 7.23 gms/ton; 4.36 PT g/t
Pit 3	Ran 10 buckets (.8 cuft) and sent for assay. Results: .10 g/t AU ; .03 PT
Pit 4	10 buckets (.8 cuft) sent for assay. Results: 3.09 g/t PT; .03 g/t AU
Pit 5	Mainly clay. No visible AU. Low blk sands. No assay.
Pit 6	Ran 10 buckets. Sent for assay. Results: 20.82 g/t AU; 3.07 g/t PT
Pit 7	10 buckets (.8 cuft) Assay results: .03 g/t AU
Pit 8	10 buckets Assay results: .8 g/t AU
Pit 9	10 buckets Assay results: 2.2 g/t AU
Pit 10	10 buckets Assay results: .2 g/t AU
Pit 11/12	Ran 6 buckets over sluice. Results: 3 large flakes gold; 12 small colours

Jim Kelly Creek: Sunny I, II, III, IV

Work on Sunny I consisted of sampling creek gravels at two locations. A total of 5.1 gms AU and 4.1 gms PT were recovered from both sites. The AU and PT were fairly coarse and, according to geologist Gary Bysouth, had not travelled far.

Work on Sunny II consisted of testing creek gravels as well as testing several draws. A total of 2.5 gms AU and 1.3 gms PT were recovered. Again AU and PT was fairly coarse.

Work on Sunny III and IV consisted of sampling creek gravels and dry diggings. Very fine flour gold in very small amounts were recovered. Heavy magnetite was encountered on Zowie 1 and 2 and Sunny 1 and 2. Most AU and PT recovery on Jim Kelly Creek was associated with magnetite recovery.

Toulameen River

Work on the Adam II and Adam I consisted of testing river gravels as well as dry diggings including testing several old pits. With one exception there was very little in the way of values. One area on the river

resulted in 13-15 small colours per pan over a 100-150' area.

A meeting with geologist Gary Bysouth resulted in a better overview of the area. He believes the area near the mouth of Jim Kelly Creek is an alluvial fan and the gravel in our pits was just dumped there as there is little sign of layering. He was impressed by the gold out of Jim Kelly Creek and also by some quartz crystals we had found. He stated that he wanted to know where we had located the crystals as there was a good chance that mineralization could also occur in the same area.

Mr. Bysouth stated his beliefs that we should concentrate on checking out the clay contact and should be checking along Jim Kelly Creek for gravel deposits not previously worked. He also stated it would be beneficial to get below the clay and check for values.

Conclusions

Efforts to verify results by previous owner (G. Hurren) were very disappointing. In almost all cases a check of previous assays were negative. These results were duplicated on the adjoining claims as well (Hurren/Tangas) now owned by A. Welbourn.

On the plus side, the results of Pits #6, 11, and 12 clearly indicate the potential for a large volume of gravel carrying economic amounts of AU and PT. A test program will be conducted next year. The area to be worked is open ground with no trees.

The coarse AU and PT found on lower Jim Kelly Creek bears further investigation. The values seem to stop at a point on the creek and we will try to ascertain the source of the mineralisation next year. The large quartz crystals and massive sulphide mineralisation located (but not shown on the map for obvious reasons) will be further investigated and should result in additional staking next year.

Respectfully submitted,

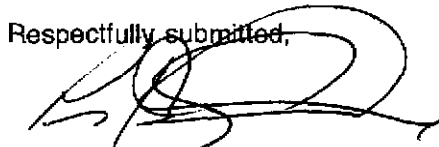

Peter Goodman
FMC 136185



ASSAYING
GEOCHEMISTRY
ANALYTICAL CHEMISTRY
ENVIRONMENTAL TESTING

10041 E. Trans Canada Hwy., R.R. #2, Kamloops, B.C. V2C 6T4 Phone (604) 573-5700
Fax (604) 573-4557

CERTIFICATE OF ASSAY AK 95-711

P. GOODMAN
General Delivery
MERRITT, B.C.
V0R 2M0

13-Sep-95

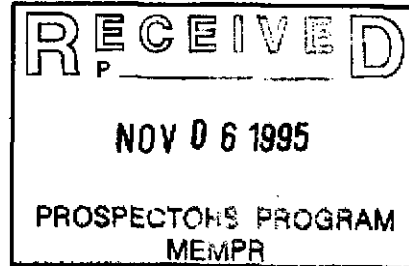

6 Black Sand samples received August 25, 1995
PROJECT #: None Given

ET #.	Tag #	Au (g/t)	Au (oz/t)	Pt (g/t)	Pt (oz/t)
1	Black Sand #3	<.03	<.001	2.94	0.088
4	Pit #3b	8.56	0.250	-	-

QC DATA:

Repeat:

1	Black Sand #3	<.03	<.001	3.09	0.090
---	---------------	------	-------	------	-------

Standard:

STD-L		1.82	0.053	-	-
-------	--	------	-------	---	---

XLS/Kmisc#5

Eco-TECH LABORATORIES LTD.
Frank J. Pezzotti, A.Sc.T.
B.C. Certified Assayer

Eco Tech gave all assays over phone
however only showed 2 on written sheet



ASSAYING
GEOCHEMISTRY
ANALYTICAL CHEMISTRY
ENVIRONMENTAL TESTING

10041 E. Trans Canada Hwy., R.R. #2, Kamloops, B.C. V2C 2J3 Phone (604) 573-5700
Fax (604) 573-4557

CERTIFICATE OF ASSAY AK 95-442

P. GOODMAN
General Delivery
MERRITT, B.C.
V0R 2M0

25-Jul-95

2 Black Sand samples received July 13, 1995
Project #: None Given

ET #.	Tag #	Au (g/t)	Au (oz/t)	Pt (g/t)	Pt (oz/t)
1	Black Sand #1	7.23	0.211	4.36	0.127
2	Black Sand #2	0.10	0.003	<.03	<.001

QC DATA:

Standard:
STD-L

2.08 0.061 - -

XLS/Kmisc#4

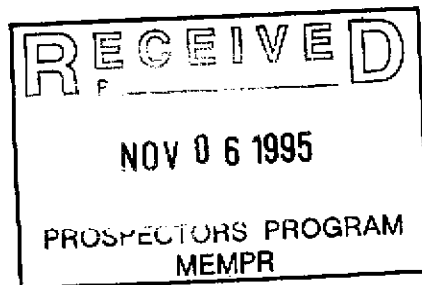



ECO-TECH LABORATORIES LTD.
Frank J. Pezzotti, A.Sc.T.
B.C. Certified Assayer

07/14/95

11:55

604 573 4557

ECO-TECH LAB.

001/00



H03-625-3605

ASSAYING
GEOCHEMISTRY
ANALYTICAL CHEMISTRY
ENVIRONMENTAL TESTING

10041 E. Trans Canada Hwy., R.R. #2, Kamloops, B.C. V2C 2J3 Phone (604) 573-5700
Fax (604) 573-4557

CERTIFICATE OF ASSAY AK 95-427

D.J. WELBOURN
BOX 207 - CLARESHOLM
ALBERTA
T0L 0T0

14-Jul-95

2 ROCK/SAND samples received July 11, 1995
PROJECT #: None given

ET #.	Tag #	Au (g/t)	Au (oz/t)
1	Peter (rock)	<.03	<.001
2	Culvert 1 (blk sand)	<.03	<.001

*SENT IN
JOINTLY WITH
D. WELBOURN*

FEED FAX THIS END

FAX

To: *D. J. Welbourn*

Dept: _____

Fax No.: _____

No. of Pages: *2*

From: *Sandy*

Date: *July 14*

Company: _____

Fax No.: _____

Comments: *427-408*

ECO-TECH LABORATORIES LTD.
Frank J. Pezzotti, A.Sc.T.
B.C. Certified Assayer

XLS/95kmisc



ASSAYING
GEOCHEMISTRY
ANALYTICAL CHEMISTRY
ENVIRONMENTAL TESTING

10041 E. Trans Canada Hwy., R.R. #2, Kamloops, B.C. V2C 6T4, Phone (604) 573-5700
Fax (604) 573-4557

CERTIFICATE OF ASSAY AK 95-537

W.G. WELBOURN
c/o BOX 207 - CLARESHOLM
ALBERTA
T0L 0T0

16-Aug-95

2 Black Sand samples received July 31, 1995
PROJECT #: None Given
SHIPMENT #: None Given

METALLIC SCREEN ASSAY

ET #.	Tag #	Au (g/t)	Au (oz/t)	Pt (g/t)	Pt (oz/t)
1	Zowie I <i>Air 6</i>	20.82	0.807	3.07	0.090
2	#1 *	4.25	0.124	2.98	0.087

QC DATA:

Repeat:

1	Zowie I	-	-	1.73	0.050
---	---------	---	---	------	-------

*DELIVERED TO LAB
BY WELBOURN*

ECO-TECH LABORATORIES LTD.

Frank J. Pezzotti, A.Sc.T.
B.C. Certified Assayer

XLS/95kmisc#5

** is this #3?
#3 was mailed with Zowie*



TESTING GRAVELS

JIM KELLY CREEK

MASSEY FERGUSON

300 LOADER

W BACKHOE

ATTACHMENT



PIT # 3
TYPICAL OF
PITS AUG

CLAY WALL
PIT # 3



PIT # 1 (AFTER RECLAMATION)
LARGEST PIT & ALL
MATERIAL RUN THRU
WASH PLANT.

ALL PITS FILLED IN &
SEEDED.

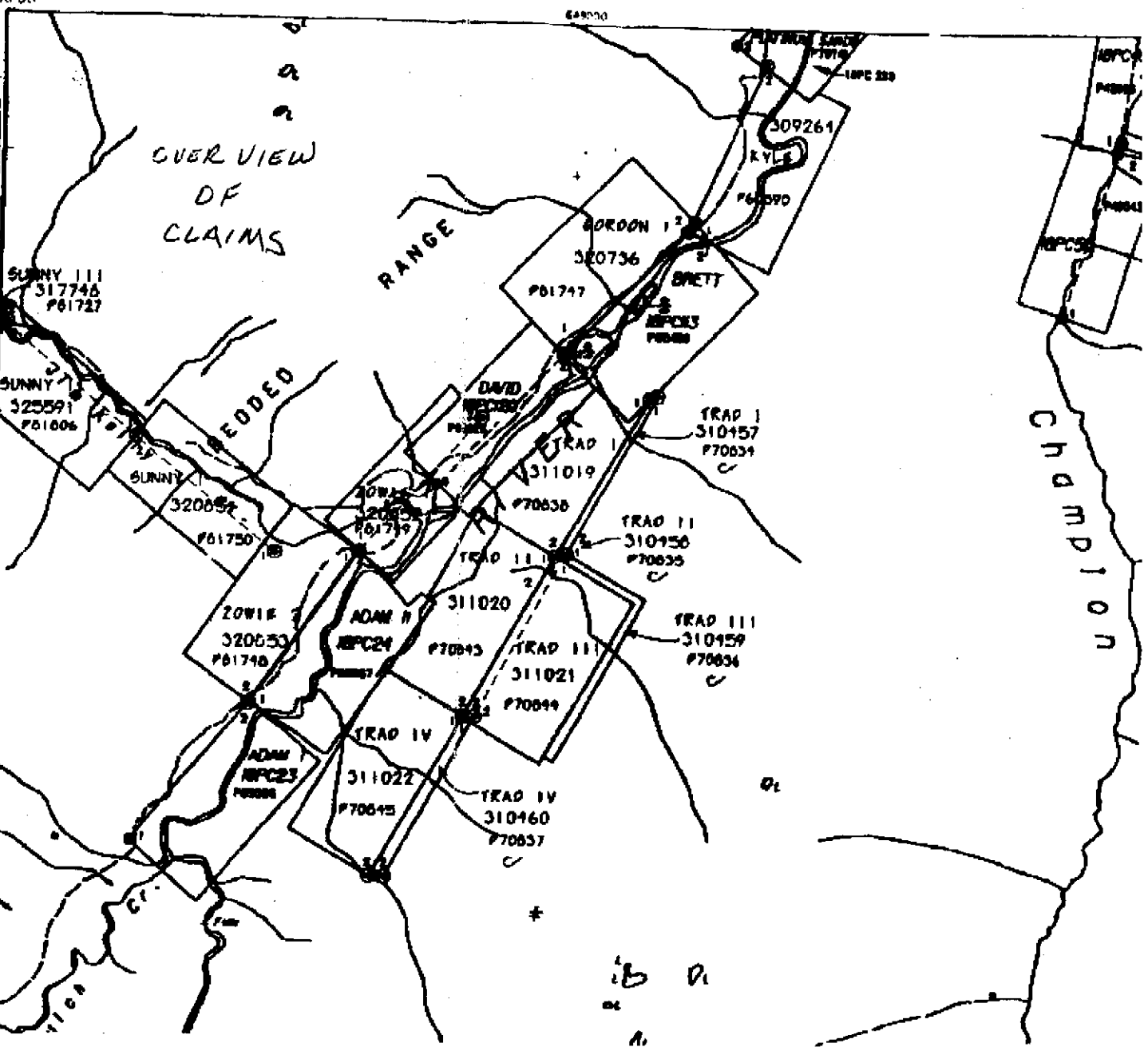
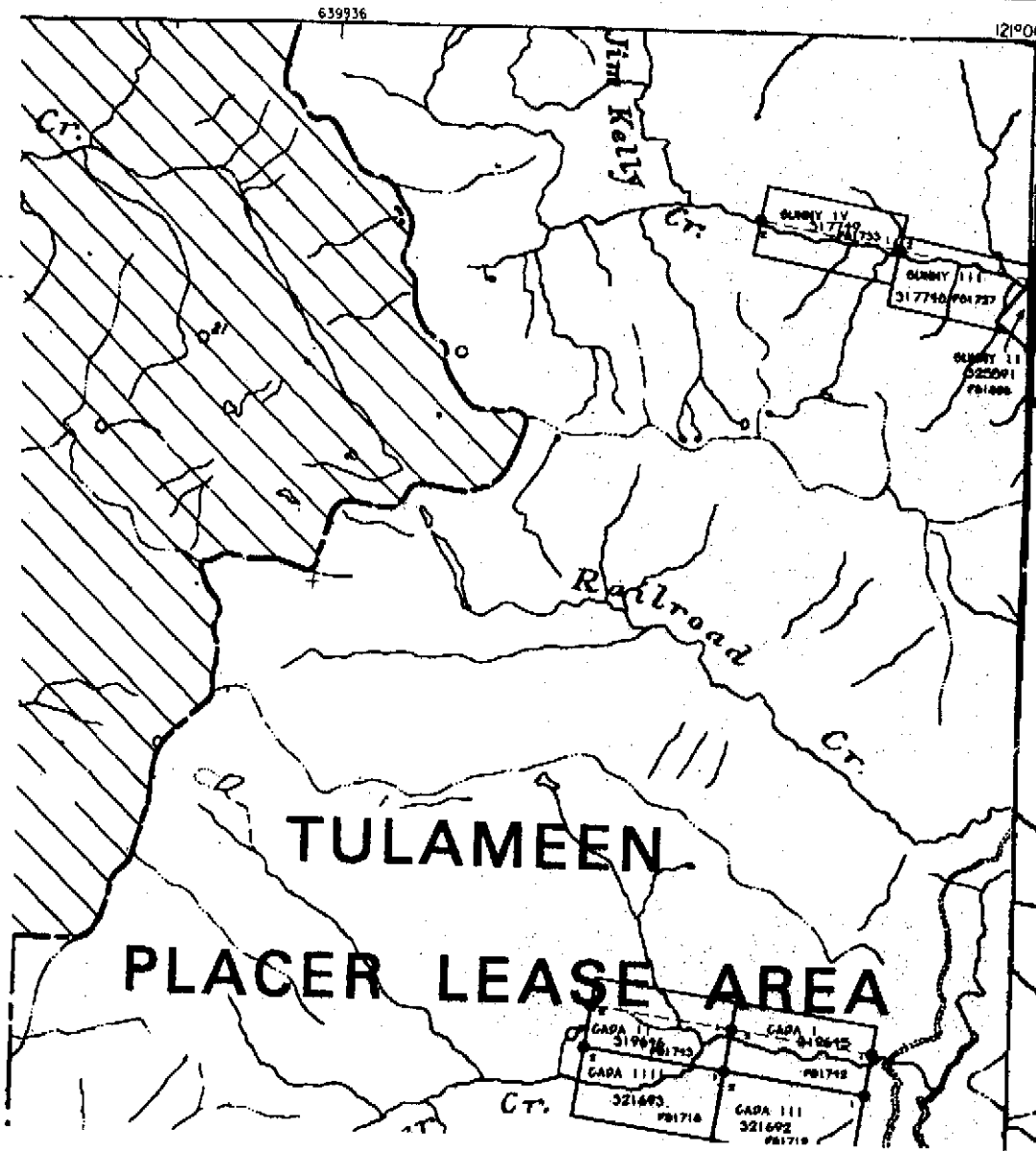

111
740
1727

MAP REF
0924/7

PITS ⊕

**GRAVEL
TEST
AREAS**

ALL LOCATIONS
APPROXIMATE !!

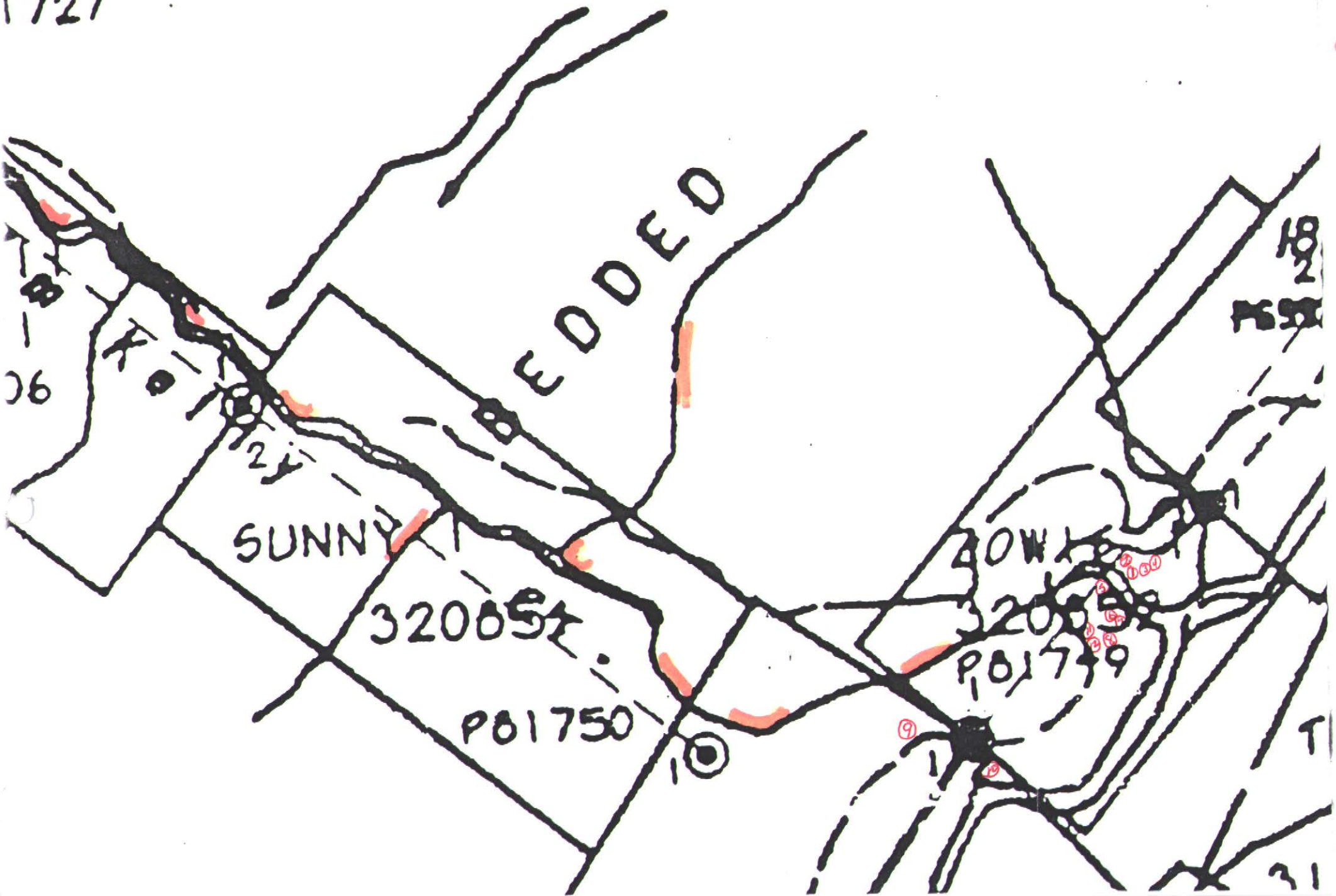

18
21
PB 550

31

MAP REF
092H/7

GRAVEL
TEST
AREAS

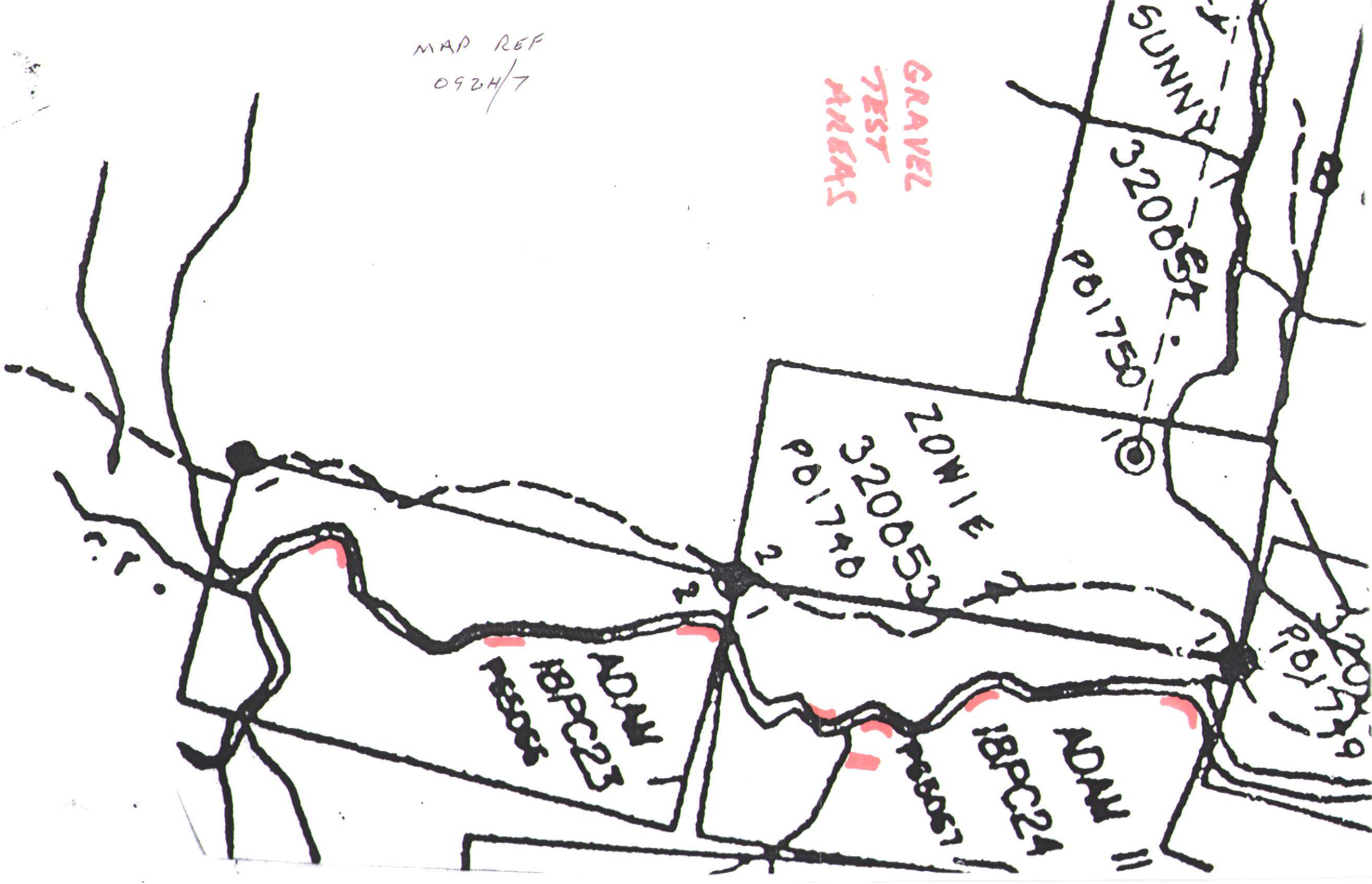

MAP REF
• 092406E

GRAVEL
TEST
AREAS

OTHER AREAS
OF EXPLORATION

