

BRITISH COLUMBIA
PROSPECTORS ASSISTANCE PROGRAM
MINISTRY OF ENERGY AND MINES
GEOLOGICAL SURVEY BRANCH

PROGRAM YEAR: 1996/1997

REPORT #: PAP 96-28

NAME: ADRIAN LAPRISE

GEOLOGICAL REPORT
ON
PLACER MINING CLAIM
322604

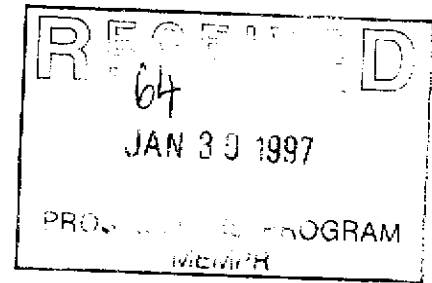

INGRAM LAKES NORTH OF WELLS B.C.
CARIBOO
NTS 94H/4E

BY ADRIAN LAPRISE

JANUARY 15, 1997

TABLE OF CONTENTS

INTRODUCTION	1
AREA LOCATION AND ACCESS	1
GENERAL GEOLOGICAL AND TOPOGRAPHY	1
TYPE OF DEPOSITS	1-2
METHOD OF EXPLORATION	2
CONCLUSION AND RECOMMENDATION	2
PROPERTY LOCATION MAPS	3-6
REFERENCES	7
STATEMENT OF QUALIFICATION	8
PICTURES	9-11
1996 SUMMARY OF PLACER EXPLORIZATION	12
PART A, SUMMARY OF PROSPECTING ACTIVITY	13
DAILY REPORTS DIARY	14-15
PART B, TECHNICAL REPORT	16
ASSAY REPORT	17
MAGNETOMETER READINGS	INSERT

INTRODUCTION:

THIS REPORT DESCRIBES THE RESULTS OF THE GEOPHYSICAL AND PROSPECTING PROGRAM UNDERTAKEN BY ADRIAN LAPRISE IN JUNE THROUGH SEPTEMBER, 1996 TO ASSESS THE PRECIOUS METAL POTENTIAL OF A PLACER CLAIM NEAR WELLS, B.C.

THE PROPERTY IS OWNED BY ADRIAN LAPRISE, BOX 13, WELLS, B.C. VOK2R0. ELECTRONIC MAPPING WAS FORMULATED BY MICHAEL WHEATON OF ITT INTERNATIONAL INC.

LOCATION & ACCESS:

THE CLAIM IS LOCATED APPROXIMATELY 9 KM NORTH OF WELLS, B.C. IT IS ACCESSIBLE BY TRUCK VIA THE BOWRON LAKE ROAD AND WEST ONTO 2200 ROAD ONE MILE NORTH OF 9 MILE LAKE. AN EASY ACCESS OFF THE 2200 ROAD, ON A FOREST SERVICE ROAD WILL GAIN ACCESS TO THE BACK PORTION OF THE CLAIM.

GENERAL GEOLOGICAL & TOPOGRAPHY:

THE MAJOR PART OF THE CLAIM IS COVERED BY FOREST AND OVERBURDEN WITH THREE CONNECTING LAKES AT THE BASE OF TWO SISTERS MOUNTAINS IN BIG VALLEY. THE AREAS ROCKS ARE OF THE CAMBRIAN CARIBOO GROUP AND MISSISSIPPIAN SLIDE MOUNTAIN GROUP. THERE IS THE SNOWSHOE FORMATION OUTCROPPING ON CORNISH MOUNTAIN SOUTHWEST OF THE PROPERTY AND TWO SISTERS MOUNTAINS TO THE EAST.

BIG VALLEY CREEK RUNS NORTH THROUGH THE VALLEY WITH SEVERAL CREEKS THAT DRAIN INTO IT. SUGAR CREEK, 9 MILE CREEK, CAFE CREEK, ALL KNOWN TO HAVE PRODUCED GOOD PLACER GOLD SINCE 1865.

THE PROPERTY CONSISTS OF A TWO POST CLAIM WITH THREE LAKES ADJOINING EACH OTHER AND THE CLAIM IS IN GOOD STANDING. THERE IS EVIDENCE OF TEST PITS FROM PAST YEARS BUT NO RECORDS OF ANY RESULTS. THERE IS NO RECORD OF ANY MECHANICAL EQUIPMENT EVER BEING USED ON THE PROPERTY.

TYPE OF DEPOSITS:

GOLD PLACERS IN THE AREA ARE ANVUELL DEPOSITS. THE GOLD BEARING GRAVELS LAY LARGELY ON FALSE BEDROCK AND BEDROCK, AS THE CASE AT EIGHT MILE LAKE SOUTHEAST OF THE PROPERTY.

AFTER TWO YEARS OF EXTENSIVE RESEARCH AND INTERVIEWS WITH LOCAL PLACER MINERS WHO HAVE CLAIMS IN THE BIG VALLEY AREA FROM EIGHT MILE LAKE NORTH TO SUGAR CREEK, IT APPEARS THAT FAVORABLE AND PROFITABLE RESULTS IN PLACER OPERATIONS IS OBTAINED. IT IS VERY POSSIBLE THAT THE DEPOSITS OF GOLD FOUND AT EIGHT MILE LAKE PERSISTS UP THE VALLEY FOR SEVERAL KM AND THAT THERE ARE LARGE AMOUNTS OF GOLD PAY STREAKS ON BEDROCK.

AFTER SEVERAL REVIEWS OF TEST PITS OVER TWO YEARS, GOLD FOUND IN THE LARGER BOULDERS BELOW THE ANVUELL GRAVELS AT DEPTHS OF 10-16 METERS.

METHOD OF EXPLORATION:

THE PROPERTY WAS LAID OUT ON A GRID WITH A BASELINE. EVERY 20 METERS A LOCATE POINT WAS PICKED TO START AN EXTENSIVE MAGNETOMETER SURVEY OF THE PROPERTY, WITH ALL READINGS RECORDED FOR FUTURE GEOLOGICAL MAPPING AND EVALUATION. AFTER ALL READINGS WERE RECORDED, THEY WERE STORED IN A MEMORY LOCK OF THE 856G MAGNETOMETER. THE READINGS WERE ALSO TRANSCRIBED IN A NOTEBOOK FOR BACKUP. THE 856G MAGNETOMETER WAS THEN COUPLED WITH A COMPUTER AND PRINTER TO RETRIEVE ALL DATA COLLECTED FOR MAPPING AND EVALUATION.

A WIDE OVERVIEW WAS TAKEN OF THE CLAIM BY MYSELF AND MR. AL BOLDUC, A LONG KNOWN PROSPECTOR IN THE WELLS AREA. ALL TECHNICAL REPORTS FROM THE AREA WERE REVIEWED, ALONG WITH OTHER PROPERTIES WITHIN THE AREA, AND 80 TEST SITES WERE SELECTED. OUT OF THE 80 SITES, 30 WERE SELECTED FOR TESTING. THIRTY ONE CUBIC YARDS WERE REMOVED FROM THE SURFACE. ONE 5 GALLON PAIL OF SOIL WAS COLLECTED FROM EACH TEST PIT. THE 5 GALLON PAILS WERE SLICED TO CONCENTRATES AND DRIED, READY TO BE BAGGED FOR ASSAY.

SOIL SAMPLES WERE SENT TO VANCOUVER, B.C. AND ASSAYED BY ACME ANALYTICAL LABS WITH REASONABLE RESULTS EXCEPT FOR FIVE TEST PITS.

AFTER ALL TESTING WAS ACCOMPLISHED, EACH TEST PIT WAS BACKFILLED WITH TOP SOIL TO COVER THE HOLE. EACH PIT WAS RESEEDED WITH RYE GRASS. ONE PEAR TREE WAS ALSO PLANTED.

CONCLUSION AND RECOMMENDATIONS:

IT IS RECOMMENDED THAT PLACER TESTING OF SAMPLES WITH A VOLUME OF 10 CUBIC YARDS BE PERFORMED. THE RESULTS OF THE MAGNETOMETER SURVEY BEING USED IN CONJUNCTION WITH APPLIED GROUND IMAGING BY USING A STRATAGEM EH4 PLOTTER TO MAP THE BEDROCK AT THE BOTTOM OF THE VALLEY SO THE MORE FAVORABLE LOCATIONS CAN BE DETERMINED FOR FUTURE DRILL SITES.



97
in file of
original sample
anal of concentrates
sent for assay 97

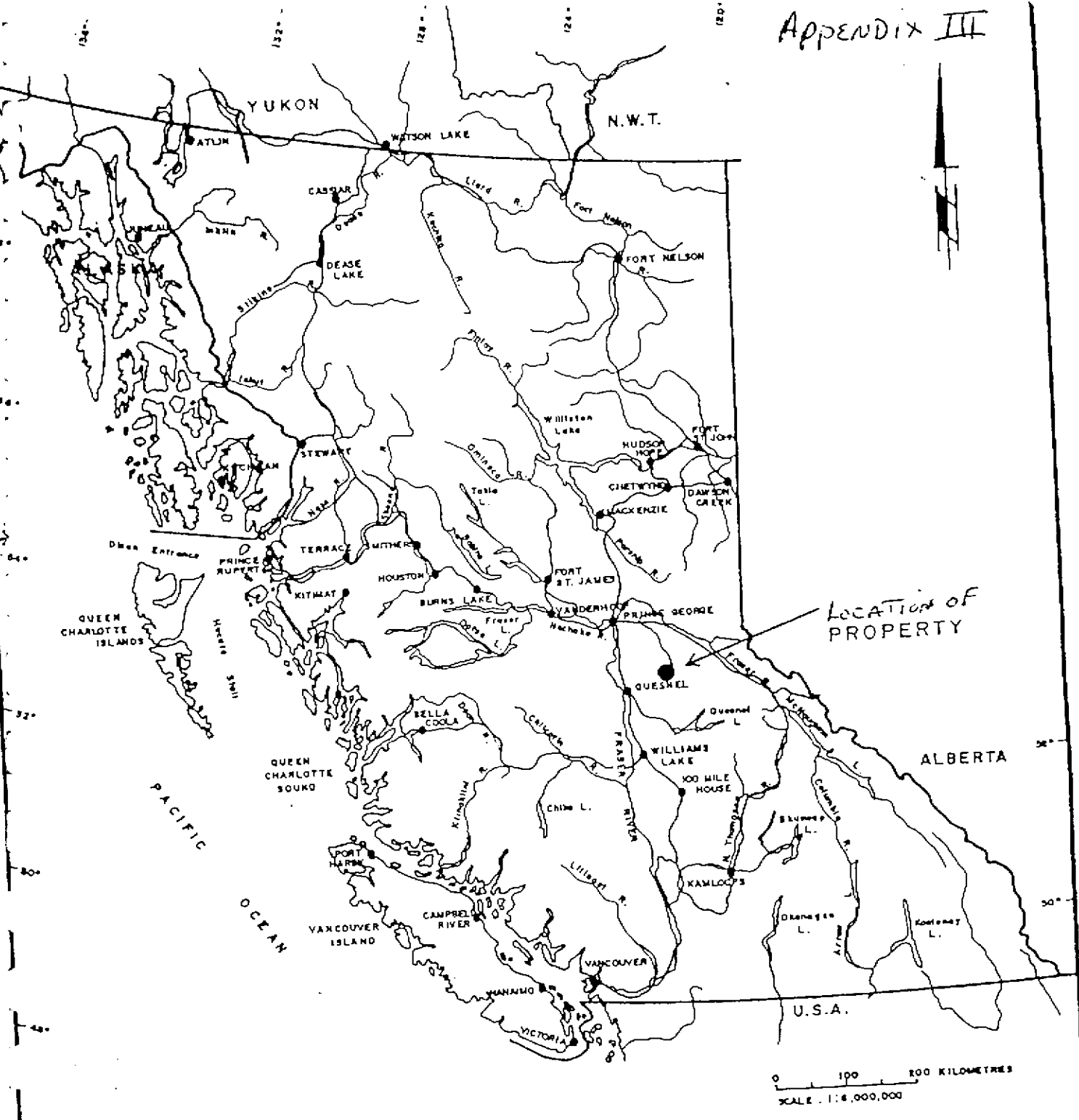

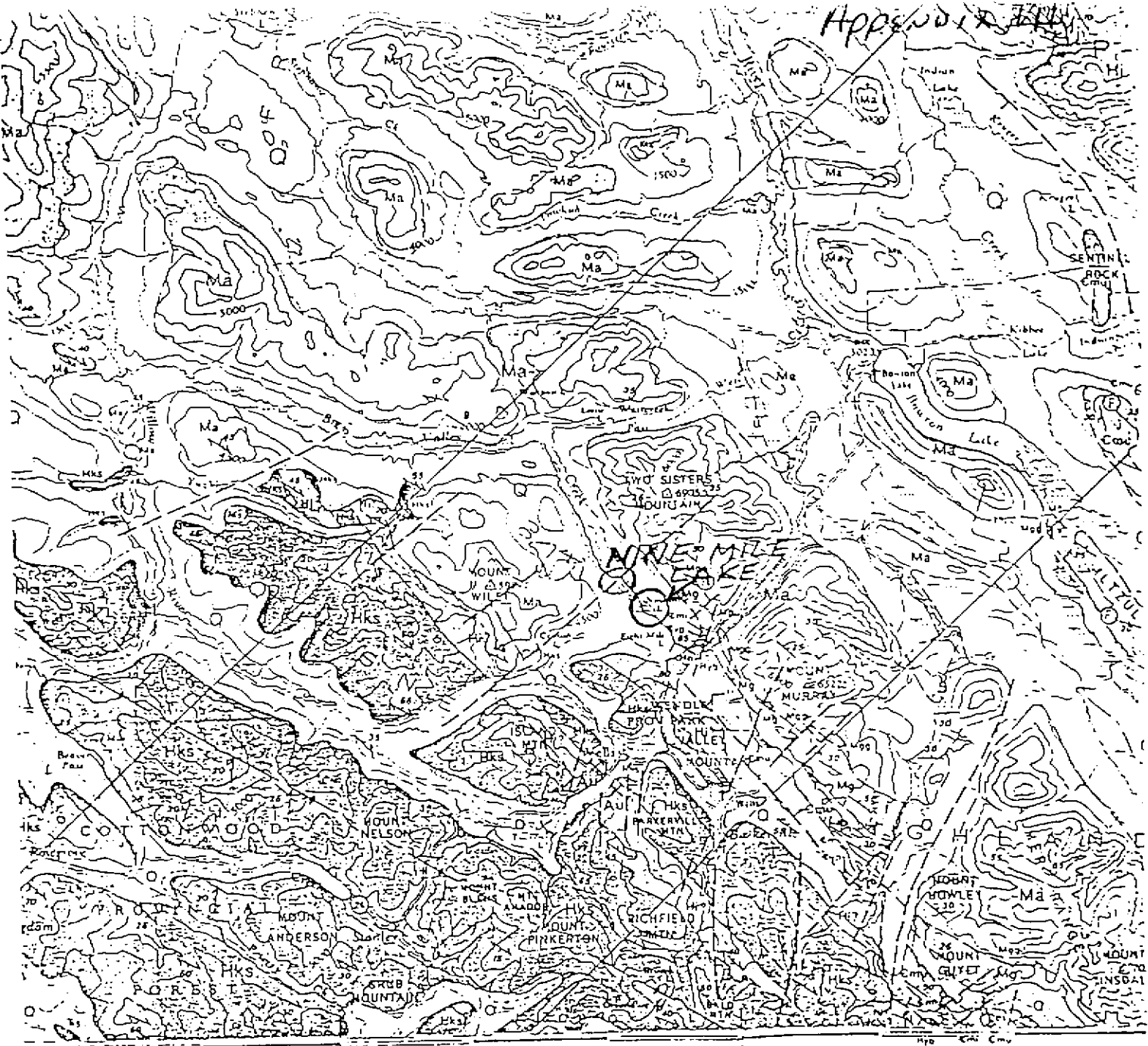



APPENDIX III





Geology by R.B. Campbell, 1966, 1967 and by E.W. Mountjoy, 1957

- 
CUNNINGHAM FORMATION: limestone, dolostone, shale, phyllite
- 
ISAAC FORMATION: phyllite, argillite, schist and shale, minor siltstone, feldspathic sandstone and conglomerate, limestone
- 
KAZA GROUP (Hk) AND SNOWSHOE FORMATION (Hks)
 Hk: feldspathic sandstone and granite conglomerate, locally micaceous and schistose; argillite, phyllite and schist.
 Hks: minor conglomerate, limestone, and marble. Hks; Snowshoe Formation interpreted as part of Kaza Group

- 
 geological contact (defined, approximate or assumed, covered)
- 
 bedding (horizontal, inclined, vertical, overturned)
- 
 cleavage and schistosity (inclined, vertical)
- 
 fault (defined, approximate or assumed)
- 
 fault or reverse fault (defined, approximate or assumed) with triangle on downthrown side
- 
 fault or reverse fault (defined, approximate or assumed) with triangle in direction of dip

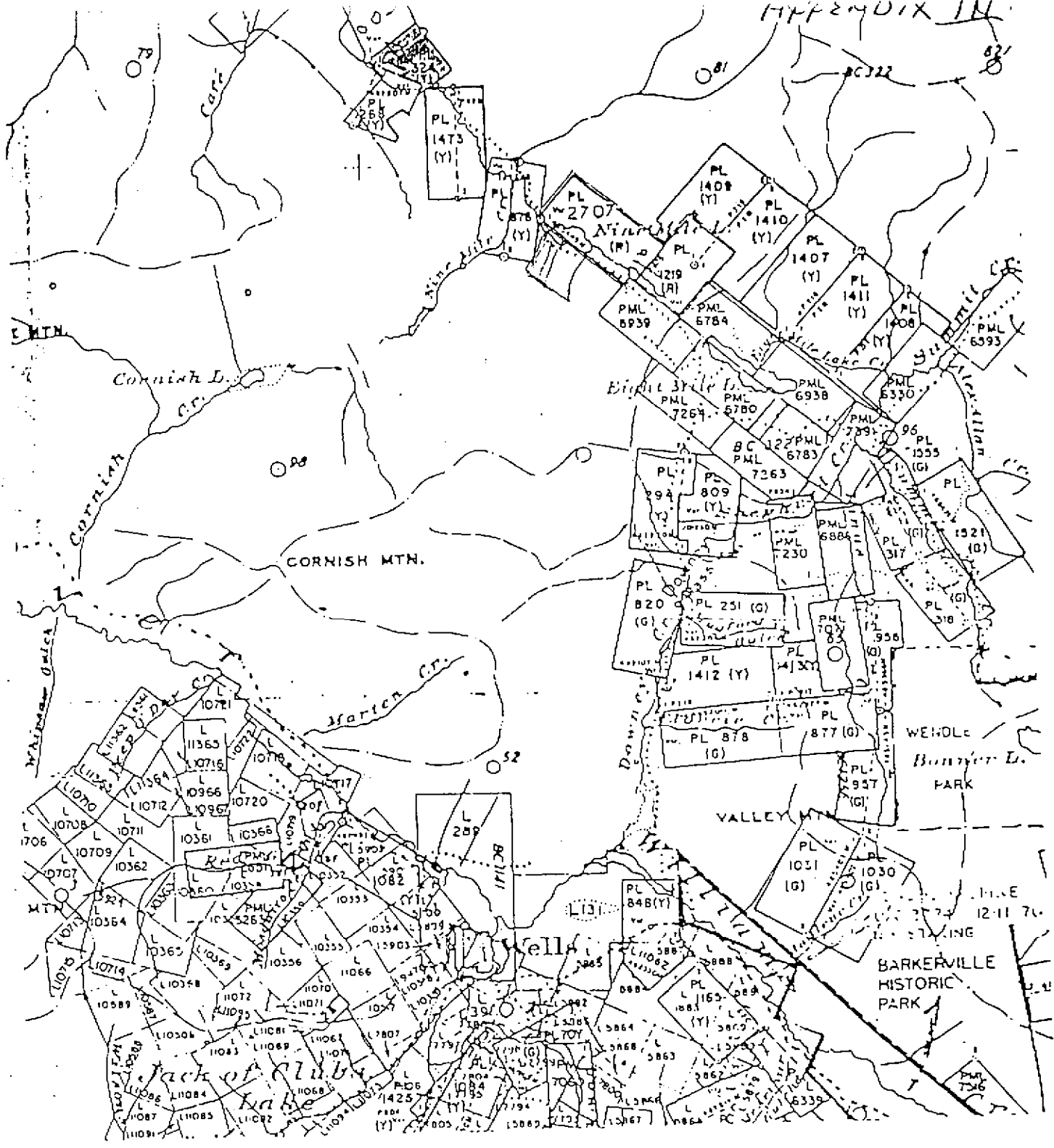

1:25,000
12-11-70

BARKERVILLE
HISTORIC
PARK

Wainwright
Mainway

Cornish D.

CORNISH MTN.

Wheeler Cr.

BC 111

Barkerville

VALLEY MTN.

Wheeler
Barker L.
PARK

10700
10701
10702
10703
10704
10705
10706
10707
10708
10709
10710
10711
10712
10713
10714
10715
10716
10717
10718
10719
10720
10721
10722
10723
10724
10725
10726
10727
10728
10729
10730
10731
10732
10733
10734
10735
10736
10737
10738
10739
10740
10741
10742
10743
10744
10745
10746
10747
10748
10749
10750
10751
10752
10753
10754
10755
10756
10757
10758
10759
10760
10761
10762
10763
10764
10765
10766
10767
10768
10769
10770
10771
10772
10773
10774
10775
10776
10777
10778
10779
10780
10781
10782
10783
10784
10785
10786
10787
10788
10789
10790
10791
10792
10793
10794
10795
10796
10797
10798
10799
10800

Jack of Clubs
Kabe

PL 848 (Y)

PL 1031 (G)

PL 1030 (G)

PL 1030 (G)

10700
10701
10702
10703
10704
10705
10706
10707
10708
10709
10710
10711
10712
10713
10714
10715
10716
10717
10718
10719
10720
10721
10722
10723
10724
10725
10726
10727
10728
10729
10730
10731
10732
10733
10734
10735
10736
10737
10738
10739
10740
10741
10742
10743
10744
10745
10746
10747
10748
10749
10750
10751
10752
10753
10754
10755
10756
10757
10758
10759
10760
10761
10762
10763
10764
10765
10766
10767
10768
10769
10770
10771
10772
10773
10774
10775
10776
10777
10778
10779
10780
10781
10782
10783
10784
10785
10786
10787
10788
10789
10790
10791
10792
10793
10794
10795
10796
10797
10798
10799
10800

11080
11081
11082
11083
11084
11085
11086
11087
11088
11089
11090
11091
11092
11093
11094
11095
11096
11097
11098
11099
11100
11101
11102
11103
11104
11105
11106
11107
11108
11109
11110
11111
11112
11113
11114
11115
11116
11117
11118
11119
11120
11121
11122
11123
11124
11125
11126
11127
11128
11129
11130
11131
11132
11133
11134
11135
11136
11137
11138
11139
11140
11141
11142
11143
11144
11145
11146
11147
11148
11149
11150
11151
11152
11153
11154
11155
11156
11157
11158
11159
11160
11161
11162
11163
11164
11165
11166
11167
11168
11169
11170
11171
11172
11173
11174
11175
11176
11177
11178
11179
11180
11181
11182
11183
11184
11185
11186
11187
11188
11189
11190
11191
11192
11193
11194
11195
11196
11197
11198
11199
11200

11080
11081
11082
11083
11084
11085
11086
11087
11088
11089
11090
11091
11092
11093
11094
11095
11096
11097
11098
11099
11100
11101
11102
11103
11104
11105
11106
11107
11108
11109
11110
11111
11112
11113
11114
11115
11116
11117
11118
11119
11120
11121
11122
11123
11124
11125
11126
11127
11128
11129
11130
11131
11132
11133
11134
11135
11136
11137
11138
11139
11140
11141
11142
11143
11144
11145
11146
11147
11148
11149
11150
11151
11152
11153
11154
11155
11156
11157
11158
11159
11160
11161
11162
11163
11164
11165
11166
11167
11168
11169
11170
11171
11172
11173
11174
11175
11176
11177
11178
11179
11180
11181
11182
11183
11184
11185
11186
11187
11188
11189
11190
11191
11192
11193
11194
11195
11196
11197
11198
11199
11200

BARKERVILLE PLACER LEASE AREA AND PLACER CLAIM AREA NO.4

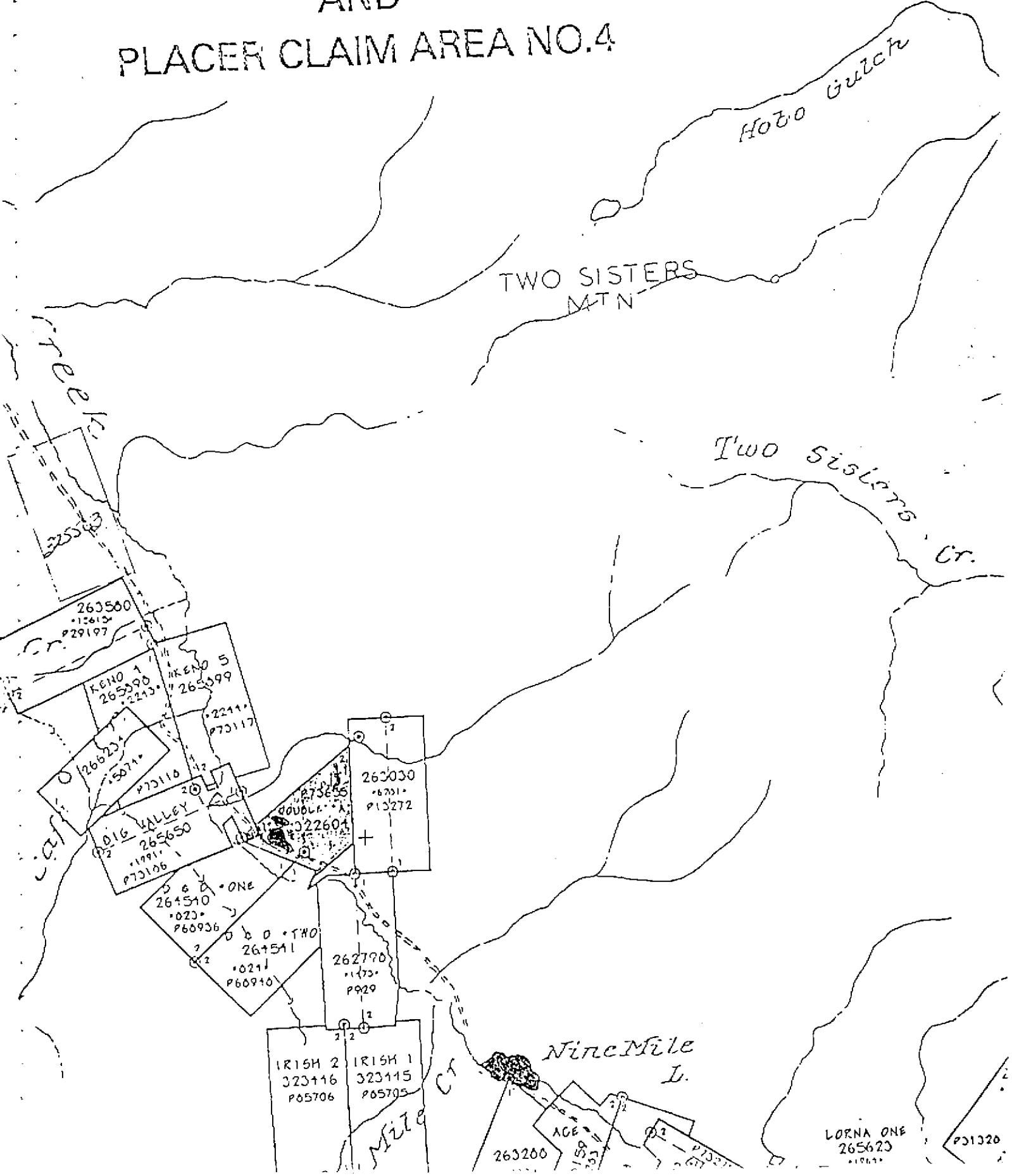

REFERENCES:

STRUIK, L.C. (1986)

IMBRICATED TERRAINS OF THE CARIBOO GOLD BELT WITH CORRELATIONS AND IMPLICATIONS FOR TECTONICS IN SOUTHEASTERN BRITISH COLUMBIA C.J.E.S. VOL 23, NO 8 AUGUST 1986 PAGE 1047-1061

VICTOR M. LEVSON/TIMOTHY R. GILES

GEOLOGY OF TERTIARY AND QUATERNARY GOLD BEARING PLACERS IN THE CARIBOO REGION BULLETIN 89 (93A, B, G, H)

K.C. McTAGGART/J. KNIGHT

GEOCHEMISTRY OF LODE AND PLACER GOLD OF THE CARIBOO DISTRICT B.C. OPEN FILE 1993-30

STATEMENT OF QUALIFICATION

I HAVE BEEN PROSPECTING FOR OVER TWENTY YEARS IN WESTERN CANADA AND IN THE WESTERN UNITED STATES. I AM SELF TAUGHT WITH EXTENSIVE FIELD WORK AND COURSES IN GEOLOGY. OTHER TRAINING HAS BEEN TAUGHT TO ME BY MR. AL BOLDUC OF WELLS, B.C. WHO HAS TAUGHT MINING FOR YEARS. HE IS AN EXPERT WHEN IT COMES TO MINING AND FIELD TECHNIQUES.

MY INTENTION IS TO BECOME A FULLY QUALIFIED GEOLOGIST. I HOLD MEMBERSHIP IN THE AMERICAN GOLD PROSPECTORS ASSOCIATION AND WOULD LIKE TO BE A MEMBER OF THE B.C. PROFESSIONAL ENGINEERS AND GEOSCIENTISTS, WHEN I QUALIFY.

SINCERELY,

A large, stylized handwritten signature in black ink, appearing to read 'Adrian Laprise', written over the typed name.

ADRIAN LAPRISE



MAGNETOMETER
FLAG
LINE



MAGNETOMETER
TEST



MAGNETOMETER
TEST



CHECK
SOILS



TEST PIT
FLAG



TEST PIT
SAMPLES.



TEST PIT



DRY
CONCENTRATES



BAG
CONCENTRATE



TOP SOIL
TEST PITS



SEED TEST
PITS



PLANT PEAR
TREE.



1996 SUMMARY OF PLACER EXPLORATION IN NORTHEAST-CENTRAL B.C.

Properties: Placer Claim 332604
(Placer Lease, Placer Claim or Tenure No.)

Owner/Operator: ADRIAN LARRISE

Please circle or complete the information below as appropriate:

General location: Wells-Barkerville Quesnel/Hixon/Likely/Germansen Landing/Manson Creek

Other: _____ Name of Creek or River: _____

Did you work on the above property this calendar year? Yes No Work in progress
If yes, please complete the following. If work is in progress at this time, please estimate totals for the calendar year.

- Exploration budget for the property or properties (in round figures): \$29,000⁰⁰ - \$31,000⁰⁰
- Drilling: Yes No Type _____ Number of holes _____ Total length _____ metres
- Percussion drilling: Number of holes _____ Total length _____ metres
- Trenching: Number of trenches _____ Total length _____ metres
- Test pits: No Yes Size 1 CU METRE Number 30
- Geochemistry: No Yes Type _____ Geological Mapping: No Yes
- Geophysics: Type _____ line-kilometres _____; Type _____ line-kilometres _____
- Linecutting/grid preparation: No Yes 12 metres
- Other work (e.g., bulk sample): TEST PITS COVERED WITH TOP SOIL AND RESEDED WITH RYE GRASS.

Overall, the results were: Disappointing Mixed Encouraging

Do you plan to be back on this property next year? Yes No

If yes, what type of work program do you propose? APPLIED GROUND IMAGING

Additional comments: (age and type of host material; underlying bedrock; fineness of gold recovered; new finds, drill intersections, best assays, comments on geology, etc): Please use the back of this page or additional sheets if required.
SEE ATTACHED REPORT.

Signed [Signature] Phone 503-789-0971

**BRITISH COLUMBIA
PROSPECTORS ASSISTANCE PROGRAM
PROSPECTING REPORT FORM (continued)**

B. TECHNICAL REPORT

- One technical report to be completed for each project area.
- Refer to Program Requirements/Regulations, section 15, 16 and 17.
- If work was performed on claims a copy of the applicable assessment report may be submitted in lieu of the supporting data (see section 16) required with this TECHNICAL REPORT.

Name ADRIAN LAPRISE Reference Number 96/97 P-64

LOCATION/COMMODITIES

Project Area (as listed in Part A) PROPERTY 322604 MINFILE No. if applicable _____
Location of Project Area NTS 93H-04E Lat 53/10'N Long 121/35W
Description of Location and Access 9 KM FROM WELLS, BC. ON.
7200 RD. 1 KM ABOVE 9 MILE LAKE.

Main Commodities Searched For AU + AG.

Known Mineral Occurrences in Project Area _____

WORK PERFORMED

1. Conventional Prospecting (area) 50 Ha
2. Geological Mapping (hectares/scale) 50 Ha. 30 METER INTERVALS.
3. Geochemical (type and no. of samples) SOIL 30
4. Geophysical (type and line km) _____
5. Physical Work (type and amount) TEST PITS 30
6. Drilling (no., holes, size, depth in m, total m) _____
7. Other (specify) TAP SOIL TO COVER TEST PITS & RESEED WITH RYEGRASS.

SIGNIFICANT RESULTS

Commodities Au. Claim Name DOUBLE "A"
Location (show on map) Lat 53/10'N Long 121/35W Elevation 7200
Best assay/sample type SEE ATTACHED REPORT.

Description of mineralization, host rocks, anomalies SEE ATTACHED REPORT.



ASSAY CERTIFICATE



Adrian LaPrise File # 96-5891
 5710 S.E. Jennings Road, Portland OR U.S.A. 97267

SAMPLE#	Au+Ag mg	SAMPLE wt. gm
1	2.091	1.7
2	.100	6.2
3	.211	4.4
4	.143	9.6
5	1.014	31.5
6	1.198	14.5
7	.861	16.9
8	.761	15.0
9	2.727	16.5
10	.549	18.9
11	1.534	15.6
12	.657	5.6
13	.100	22.7
14	.601	11.1
15	.872	18.9
16	.990	20.6
17	1.371	10.8
18	.392	21.5
19	.100	28.7
20	.391	21.9
21	.459	21.9
22	.268	25.8
23	.788	26.8
24	.364	18.7
25	3.196	15.1
26	.100	17.6
27	.440	20.0
28	1.376	26.4
29	.100	30.1
30	.283	31.1

What does this mean in terms of g/t or g/oz of original sample??

AG** & AU** BY FIRE ASSAY FROM TOTAL SAMPLE. (Total precious metal)
 - SAMPLE TYPE: PAN CONC.

DATE RECEIVED: NOV 8 1996 DATE REPORT MAILED: Nov 22/96 SIGNED BY: *C. Leong* .D.TOYE, C.LEONG, J.WANG; CERTIFIED B.C. ASSAYERS

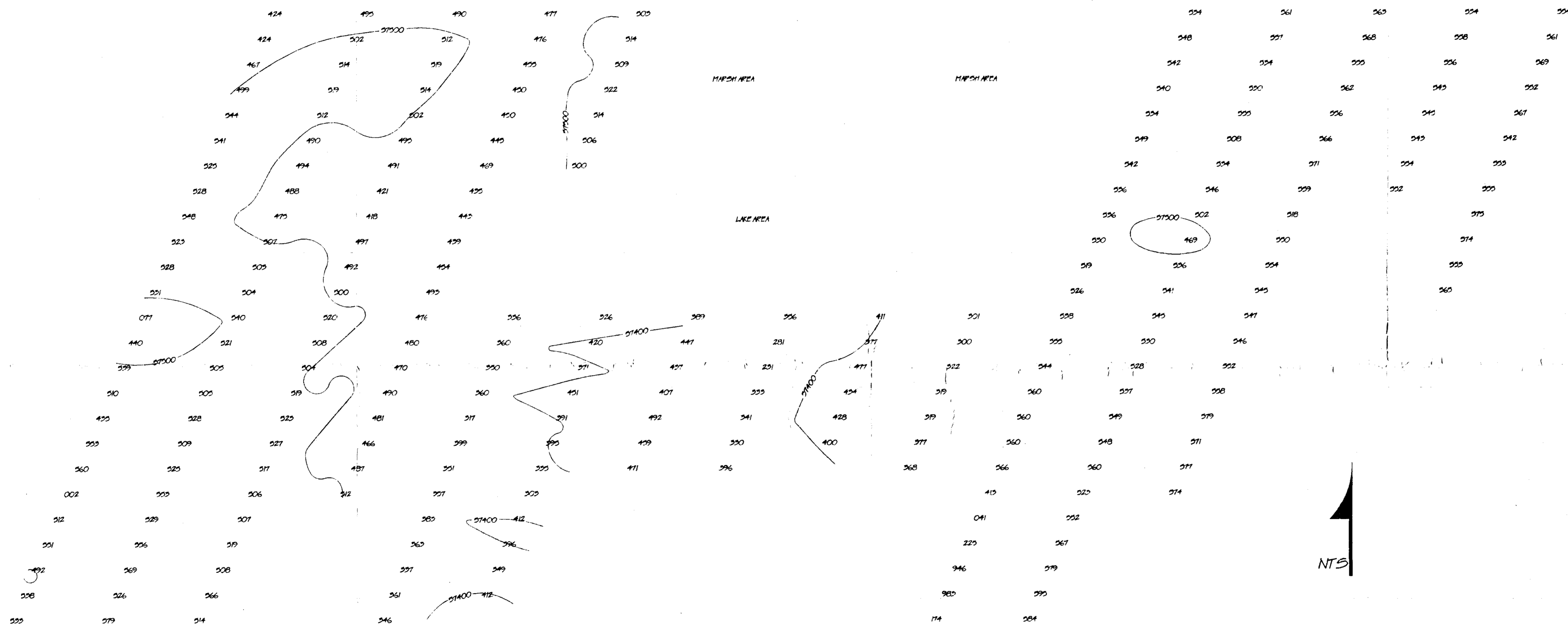

INGRAM LAKES CLAIM
 Adrian Laprise
 P.O. Box 13
 Wells, B.C. -- V0K2R0 9b28 ①

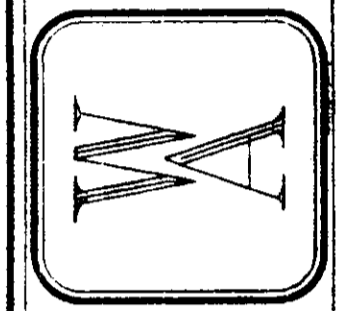

WHEATON & ASSOCIATES
 CAD DESIGN & DRAFTING
 9751 TALBERT SE CLACKAMAS, OREGON 97015 (503) 653-6190

REVISIONS	Comments

Job No 97001
 Date 1/29/97
 Drawn By TWA
 Ck By
 Ck By
 1
 of 1 Sheets